

Soft Case Instruction

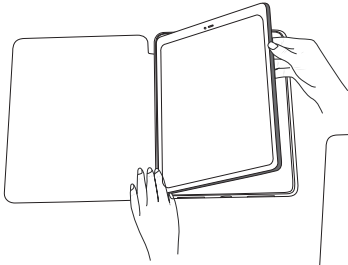

Quick installation

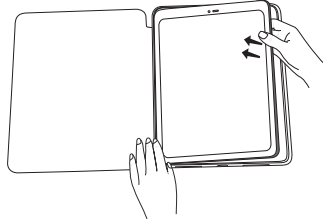

Remove easily

1 Quick Installation / Remove Easily

Line up the left side of your device with the case, snap them into the case, then snap the right side into place.

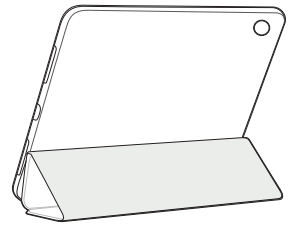
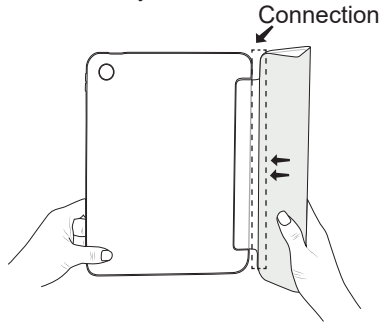
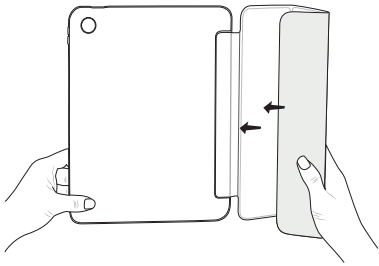

1 Front cover fold

First, place the case horizontally with the back facing up, then fold the front cover outward along the crease.

2 Fold cover into triangle

The front cover folds backward to form a triangle, you will hear a 'click', then the front cover will form a stable triangular bracket.

3 Rest tablet against stand

Stable support, provides two different stand position for your tablet, easily adjust your iPad to the comfortable angles.

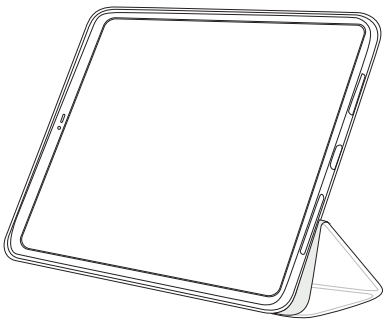

Viewing Angle

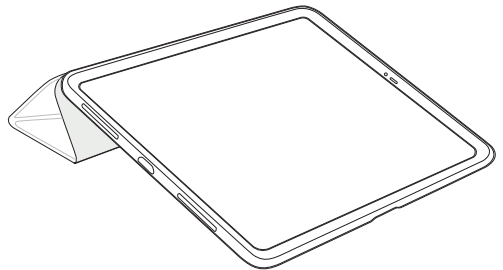

Typing Angle