

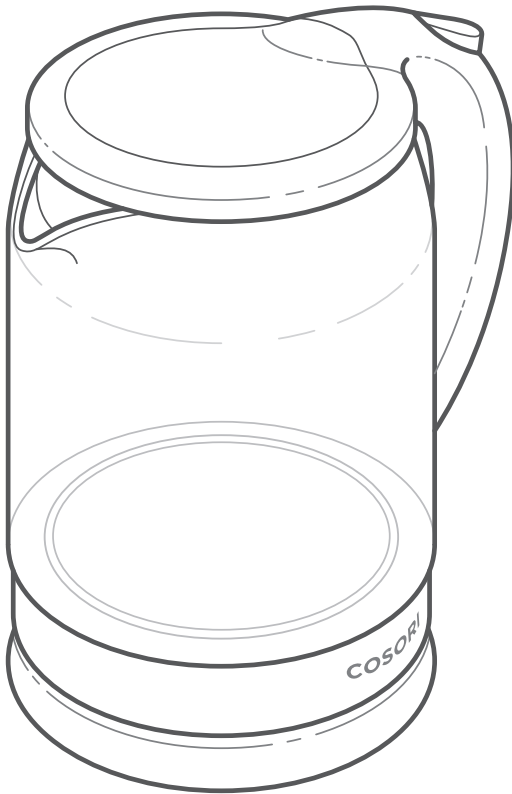

Electric Glass Kettle

Model No.: C0171-GK



Questions or Concerns?

Mon - Fri 9:00 AM - 5:00 PM PST

support@cosori.com | (888) 402-1684

WITH HEARTFELT THANKS

Thank you for purchasing a new **CO171-GK Original Electric Glass Kettle**. We're excited to see what you'll serve up!

We're looking forward to preparing many fresh meals with you. When we say "with you," we mean it—our helpful Customer Support Team is ready to answer questions at **support@cosori.com**. We're here to lend an ear to your questions and concerns (or your joy over a successful recipe). Happy cooking!

Table of Contents

Package Contents	4
Specifications	4
Keeping Things Safe	5
Getting to Know Your Kettle	7
How Does It Work?	8
• Before First Use	8
• Boiling Water	9
Care & Maintenance	10
• General Cleaning	10
• Descaling the Kettle	10
Warranty Information	11
Customer Support	12

Package Contents

- 1 x CO171-GK Original Electric Glass Kettle
- 1 x Power Base
- 1 x User Manual

Specifications

Voltage	120V / 60Hz
Rated Power	1500W
Capacity	1.8 qt (1.7 L)

KEEPING THINGS SAFE

IMPORTANT SAFEGUARDS: Please read, understand, and comply with all the instructions provided in this manual before using this device. Failure to comply with the instructions given in this manual and/or using this device in ways other than the ones mentioned in this manual may result in serious injury and/or damage to the product.

General Safety

Read all instructions in this manual before using the product.

CAUTION!

- **DO NOT** touch the base or the glass portions of the kettle while the appliance is operating or immediately after operation. These components will be hot and may cause burns or other personal injury.
 - **DO NOT** fill the kettle above the MAX line. Doing so may cause the water to boil over during operation and may result in scalding.
 - Always handle with care when there is hot water inside the kettle. Failure to do so may result in burns or scalding.
-
- Only use this appliance for its intended purpose as described in this manual.
 - Use the appliance with the specified voltage (120V / 60Hz).
-
- **DO NOT** allow children to use or play with this appliance. Always keep this kettle and its components out of reach from children.
 - **DO NOT** use the kettle if the kettle is malfunctioning, if it is broken or chipped, or if the power cord or plug is damaged in any way. Immediately discontinue use and contact Customer Support (page 12).
 - Always unplug the kettle while it is not in use.
 - This appliance is for indoor use ONLY.

Use & Care

- Always place the kettle on a dry, flat surface.
- **DO NOT** place the kettle on or near heat sources such as stove tops, ovens, radiators, etc.
- This appliance is only meant to boil water. **DO NOT** put any other liquids inside the kettle.
- **DO NOT** turn on the kettle while the lid is open.
- **DO NOT** cover the opening of the kettle while it is operating. Doing so may result in damage to the kettle.

KEEPING THINGS SAFE (cont.)

- **DO NOT** cover the slits near the **On/Off Switch**. Doing so will prevent the kettle from operating properly.
- This appliance implements a dry-run safety feature. If there is no water inside the kettle during operation, it will automatically turn off to prevent the heating plate from overheating. If the kettle overheats, fill it with cold water and wait 2 minutes before resuming use.
- Always empty and clean the kettle after each use. If necessary, descale the kettle by following the instructions in **Descaling the Kettle** (page 10).
- **DO NOT** immerse the kettle or base in water or other liquids.
- **DO NOT** attempt to repair this appliance if it is broken. Doing so may result in further damage or personal injury and will void your warranty.
- **DO NOT** attempt to use this kettle or its base with other components from other electric kettle brands. Doing so will void your warranty.

**SAVE THESE
INSTRUCTIONS**

GETTING TO KNOW YOUR KETTLE

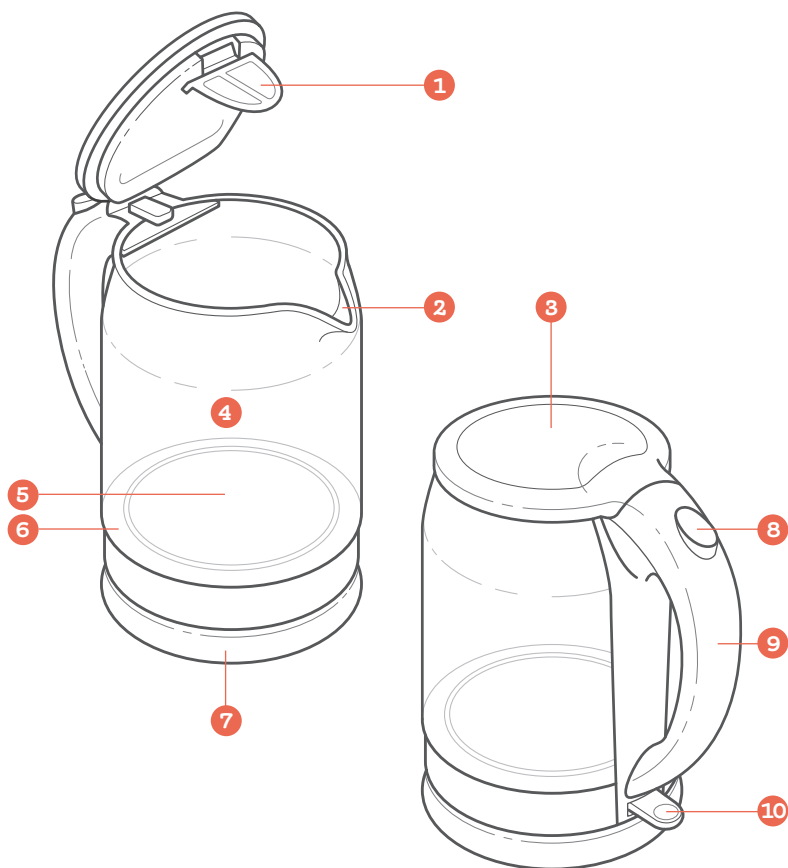

- | | |
|------------------|-----------------------|
| 1. Filter | 6. Indicator Light |
| 2. Spout | 7. Power Base |
| 3. Lid | 8. Lid Release Button |
| 4. Kettle | 9. Handle |
| 5. Heating Plate | 10. On/Off Switch |

HOW DOES IT WORK?

Before First Use

CAUTION!

DO NOT remove the glass kettle from the package if it is broken. Contact Customer Support immediately to replace your kettle.

This process is meant to test if the kettle is working properly. **DO NOT** drink the water that was boiled during this initial test.

1. Remove all parts from the package and carefully inspect each part.
2. Completely unravel the power cable, then place the power base on a flat, level surface.
3. Press the **Lid Release Button** to open the lid. [\[Figure 1.1\]](#)
4. Fill the kettle with water to the MAX line then close the lid. Place the kettle onto the power base and plug the power base into a powered electrical outlet. [\[Figure 1.2\]](#)
5. Press the **On/Off Switch** to turn on the kettle. The blue indicator light will turn on. [\[Figure 1.3\]](#)
6. The kettle will automatically turn off once it has finished boiling the water. Allow it to cool for at least 5 minutes, then pour out the water.

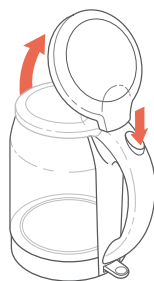

Figure 1.1

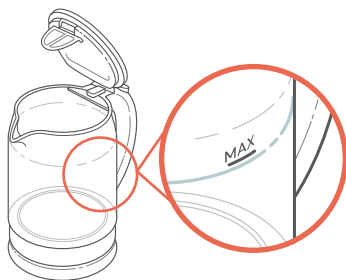

Figure 1.2

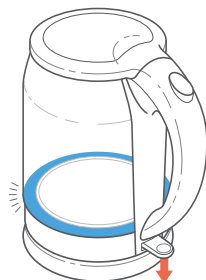

Figure 1.3

Boiling Water

DO NOT attempt to boil other liquids in this appliance. This kettle is only suitable for boiling water.

1. Press the **Lid Release Button** to open the lid.
2. Fill the kettle to the desired level. Remember to not go above the **MAX** line. [Figure 2.1]
3. Close the lid and place the kettle onto the power base. Connect the plug to a powered electrical outlet. [Figure 2.2]
4. Press the **On/Off Switch** to turn on the kettle. The blue indicator light will turn on. The kettle will automatically turn off once it has finished boiling the water. [Figure 2.3]

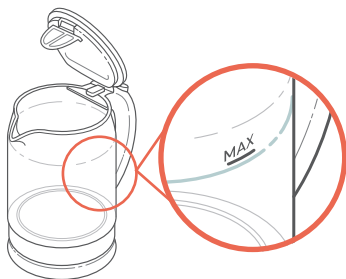

Figure 2.1

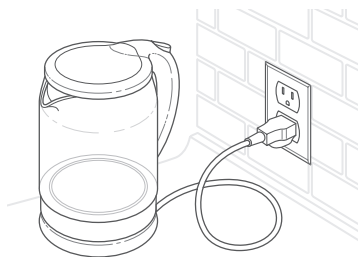

Figure 2.2

NOTE:

- You can stop the heating process at any time by pressing the **On/Off Switch** while the kettle is operating.
- **DO NOT** attempt to boil other liquids in this appliance. This kettle is only suitable for boiling water.
- Make sure to fill the kettle with water to at least the "0.50L" line. Failure to do so may cause the heating plate to overheat.
- If the kettle overheats, fill it with cold water and wait 2 minutes before resuming use.

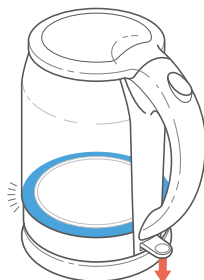

Figure 2.3

CARE & MAINTENANCE

General Cleaning

It is recommended to clean the kettle after each use.

1. Unplug the power base from the electrical outlet.
2. Allow the kettle to completely cool, then pour out any remaining water.
3. Wash the kettle with warm, soapy water. Dry it thoroughly with a clean, dry cloth.

Descaling the Kettle

It is important to descale the kettle at least once a week if it is being used frequently. Descaling removes any mineral deposits that have built up inside the kettle. Always descale the kettle after it has been stored for long periods of time or before storing it.

1. Unplug the power base from the electrical outlet.
2. Allow the kettle to completely cool, then pour out any remaining water.
3. Wipe the interior of the kettle with a soft cloth to remove any excess moisture.
4. Fill the kettle with 4 cups of distilled vinegar and 2 cups of water.
5. Place the kettle onto the power base, then plug the power base into an electrical outlet.
6. Boil the solution in the kettle 2-3 times.
7. Pour out the solution, rinse the kettle with clean water, and dry with a soft cloth.

WARRANTY INFORMATION

Product	Original Electric Glass Kettle
Model Number	CO171-GK
Warranty Period	1 year
<i>For your own reference, we strongly recommend that you record your order number and date of purchase.</i>	
Order Number	
Date of Purchase	

Cosori warrants all products to be of the highest quality in material, craftsmanship, and service, effective from the date of purchase to the end of the warranty period.

Cosori will replace any product found to be defective due to manufacturer flaws based on eligibility. Refunds are available within the first 30 days of purchase. Refunds are only available to the original purchaser of the product. This warranty extends only to personal use and does not extend to any product that has been used for commercial, rental, or any other use in which the product is not intended for. There are no warranties other than the warranties expressly set forth with each product.

This warranty is non-transferrable. Cosori is not responsible in any way for any damages, losses, or inconveniences caused by equipment failure or by user negligence, abuse, or use noncompliant with the user manual or any additional safety

or usage warnings included in the product packaging and manual.

This warranty does not apply to the following:

- Damage due to abuse, accident, alteration, misuse, tampering, or vandalism.
- Improper or inadequate maintenance.
- Damage in return transit.
- Unsupervised use by children under 18 years of age.

Cosori and its subsidiaries assume no liability for damage caused by the use of the product other than for its intended use or as instructed in the user manual. Some states do not allow this exclusion or limitation of incidental or consequential losses so the foregoing disclaimer may not apply to you. This warranty gives you specific legal rights and you may also have other rights which may vary from state to state.

ALL EXPRESSED AND IMPLIED WARRANTIES, INCLUDING THE WARRANTY OF MERCHANTABILITY, ARE LIMITED TO THE PERIOD OF THE LIMITED WARRANTY.

WARRANTY INFORMATION (cont.)

Additional 1-Year Warranty

You can extend your 1-year warranty by an additional year. Log onto www.cosori.com/warranty and enter your order number (e.g., from Amazon or Houzz) to register your new product for the extended warranty. If you are unable to provide the order number for your product, please type a short note in the order number field along with the date you received your product.

Defective Products & Returns

Should your product prove defective within the specified warranty period, please contact Customer Support via support@cosori.com with your order number. Once our Customer Support Team has approved your request, please return the unit with a copy of your invoice and order number.

CUSTOMER SUPPORT

Should you encounter any issues or have any questions regarding your new product, feel free to contact our helpful Customer Support Team. Your satisfaction is our goal!

Customer Support

Cosori Corporation

1202 N. Miller St., Ste. A
Anaheim, CA 92806

Email: support@cosori.com

Toll-Free: (888) 402-1684

Support Hours

Monday - Friday

9:00am - 5:00pm PST

* Please have your order invoice and confirmation number ready before contacting Customer Support.

SHOW US WHAT YOU'RE MAKING

We hope this has been helpful to you. We can't wait to see your beautiful results, and we think you'll want to share glam shots! Others already in the community await your uploads—just pick your platform of choice below. Snap, tag, and hashtag away, Cosori chef!

#iCookCosori



@cosoricooks



Cosori Appliances

Considering what to cook? Many recipe ideas are available, both from us and the Cosori community.

More Cosori Products

Lastly, if you're happy with this glass kettle, the fun doesn't stop here. Check out www.cosori.com for the full line of all our beautiful and thoughtfully designed cookware. They might be right at home in your kitchen, too!

COSORI