



DOOR MIRROR

I

OPERATING MANUAL

DOOR MIRRORS
AND WALL MIRRORS

■ Explain

- Please read the instruction carefully before using.
- Before assembly compare the contents with list to make sure the package includes all the parts.
- Make sure the wall can bear the weight of the mirror.
- Do not use string or chain to hang the products.
- Please keep your property away during the installation to avoid any damage.
- Intended for residential use only.

Care Advice

- a. Before using, wipe with a dry and clean cloth.
- b. Check all the screws and bolts are tight every three months or as needed.
- c. Clean with glass cleaner or detergent.

Parts List

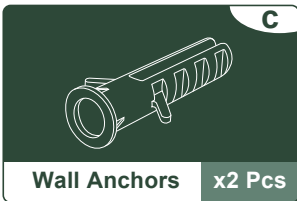
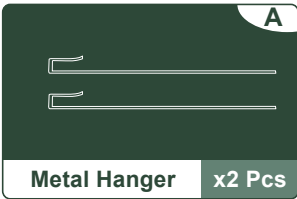
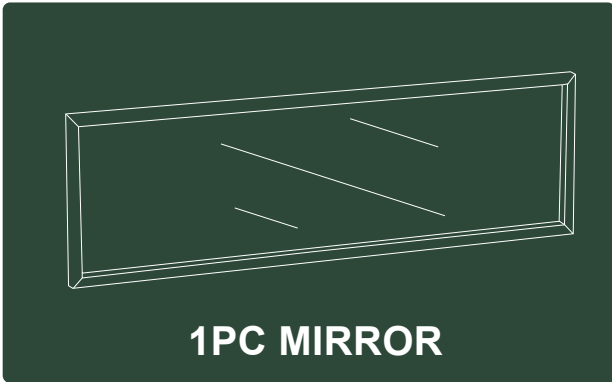

Tools Required (Not Provided)



■ Option 1

Installation steps for hanging on the door
requires accessories A and B

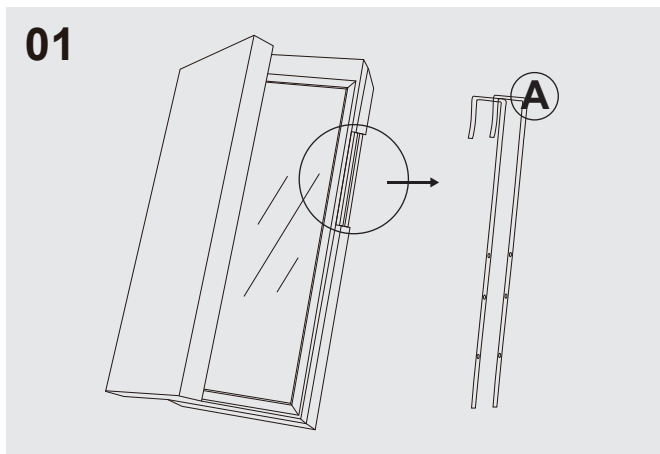

Find the A metal hangers on the side of the package.

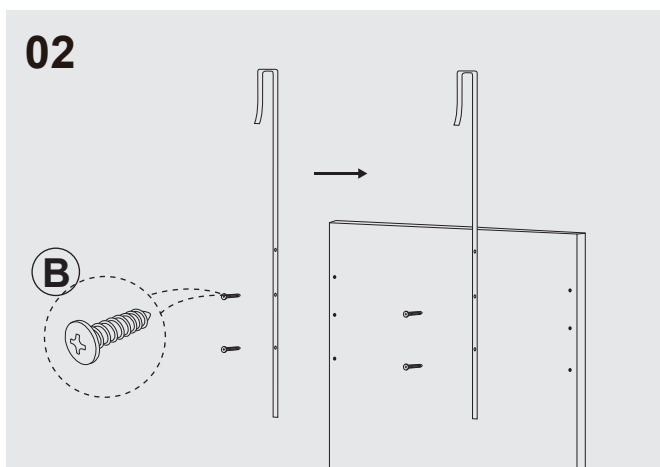

Screw the B short screws into the marked holes.

03

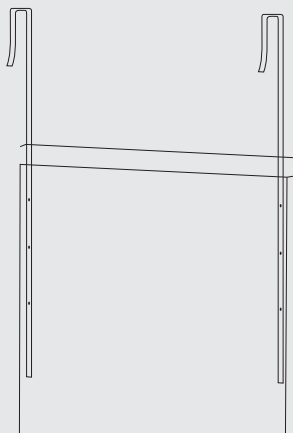

04

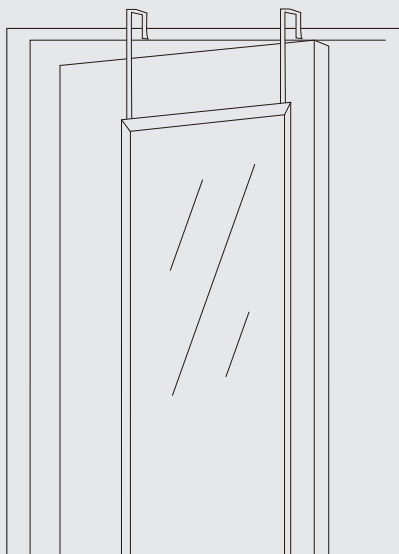

Hang the assembled mirror on the door.

■ Option 2

Installation steps for wall-mounted
requires accessories C and D

01

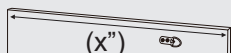
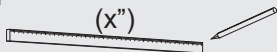

Measure the distance
between the mirror hooks
and measure the same
size on the wall.

02

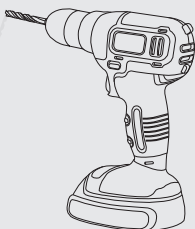

Drill holes in the measured position
with a drill.

03

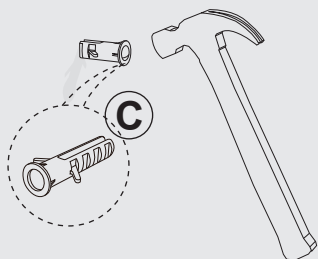

Drive C wall anchors into the holes
in the wall.

04

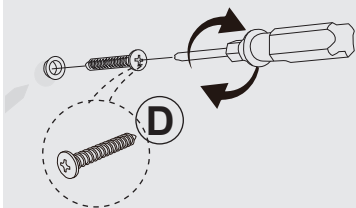

Drive D long screws into the C wall
anchors.

05

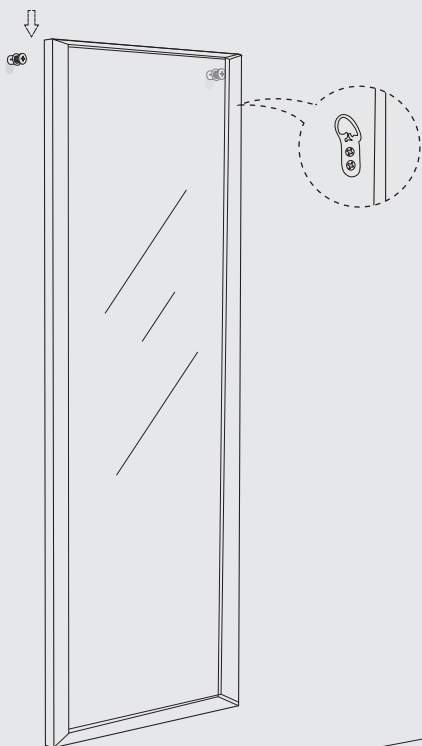

Hang the mirror on the wall with hooks .

