

AROMA®

Hot H2O X-Press™ Electric Water Kettle

Instruction Manual



www.AromaCo.com

AWK-115S

Congratulations on your purchase of the Aroma® Hot H2O X-Press™ Kettle. This handy appliance provides more speed and convenience than traditional stovetop kettles, not to mention the increased safety features! The compact, cordless body is finished in polished stainless steel and made to blend seamlessly and stylishly into your kitchen.

This product was designed with your safety in mind. Features such as cordless pouring and the 360° swivel base, which allows left or right-handed gripping, are designed to remove many of the dangers and inconveniences associated with other kettles. Other safety features include the easy-grip handle, stay-cool handles and base, drip-free pouring spout and automatic-shut off with boil dry protection. Gone are the days when forgotten kettles caused steam damage to cabinets or posed fire risks by boiling dry. The Hot H2O X-Press™ turns off automatically once the water has boiled and will not operate when empty.

For maximum convenience, your new Hot H2O X-Press™ is equipped with a removable mesh decalcification filter to help remove mineral impurities from your water. In addition, the heating element is concealed – leaving it unexposed to mineral build up. To further fight scale, it is best to always use distilled water in the kettle, and to follow the cleaning and maintenance instructions in this manual. With proper use and maintenance, your new electric kettle will steam through pot after pot of hot water for years to come!

Published By:

Aroma Housewares Co.
6469 Flanders Drive
San Diego, CA 92121
U.S.A.
1-800-276-6286
www.aromaco.com

© 2008 Aroma Housewares Company All rights reserved.

IMPORTANT SAFEGUARDS

Basic safety precautions should always be followed when using electrical appliances, including the following:

1. Read all instructions before using the appliance.
2. Do not touch hot surfaces. Use handles or knobs. Metal surfaces become extremely hot.
3. To prevent against electrical hazards, do not immerse cord, plug or kettle in water or any other liquid. See instructions for cleaning.
4. Close supervision is necessary when any appliance is used by or near children.
5. Always unplug appliance from outlet when not in use and before cleaning. Allow to cool before cleaning and handling.
6. Do not operate appliance with a damaged cord or plug, or after appliance malfunctions or is dropped or damaged in any manner. Return the appliance to an authorized service facility for examination, repair or electrical/mechanical adjustment.
7. The use of accessory attachments not recommended by the appliance manufacturer may cause injuries.
8. Do not use outdoors.
9. Do not let cord hang over edge of table or counter or touch hot surfaces.
10. Do not place kettle on or near a hot gas or electric burner or in a heated oven.
11. To disconnect, turn any control to the "OFF" position, then remove the plug.
12. Do not use kettle for anything other than its intended use.
13. The power base must only be used with the provided kettle.
14. Only use the kettle to heat water. No other liquids should be placed inside the kettle.
15. Do not unscrew any screws on the kettle or power base or attempt to disassemble them in any way.
16. Do not move kettle during heating process.
17. This appliance is for household use only.
18. Do not immerse this appliance or any of its parts, other than the removable filter, in water.
19. Scalding may occur if the lid is removed during the brewing cycle.

SAVE THESE INSTRUCTIONS

SHORT CORD INSTRUCTIONS

1. A short power-supply cord is provided to reduce the risks resulting from becoming entangled in or tripping over a longer cord.
2. Longer extension cords are available and may be used if care is exercised in their use.
3. If a longer extension cord is used:
 - a. The marked electrical rating of the extension cord should be at least as great as the electrical rating of the appliance.
 - b. The longer cord should be arranged so that it will not drape over the countertop or tabletop where it can be pulled by children or tripped over unintentionally.



POLARIZED PLUG

This appliance has a polarized plug (one blade is wider than the other); follow the instructions below:

To reduce the risk of electric shock, this plug is intended to fit into a polarized outlet only one way. If the plug does not fit fully into the outlet, reverse the plug. If it still does not fit, contact a qualified electrician. Do not attempt to modify the plug in any way.

If the supply cord is damaged, it must be replaced by the manufacturer, its service agent or a similarly qualified person in order to avoid a hazard.

This appliance is for household use only.

PARTS IDENTIFICATION

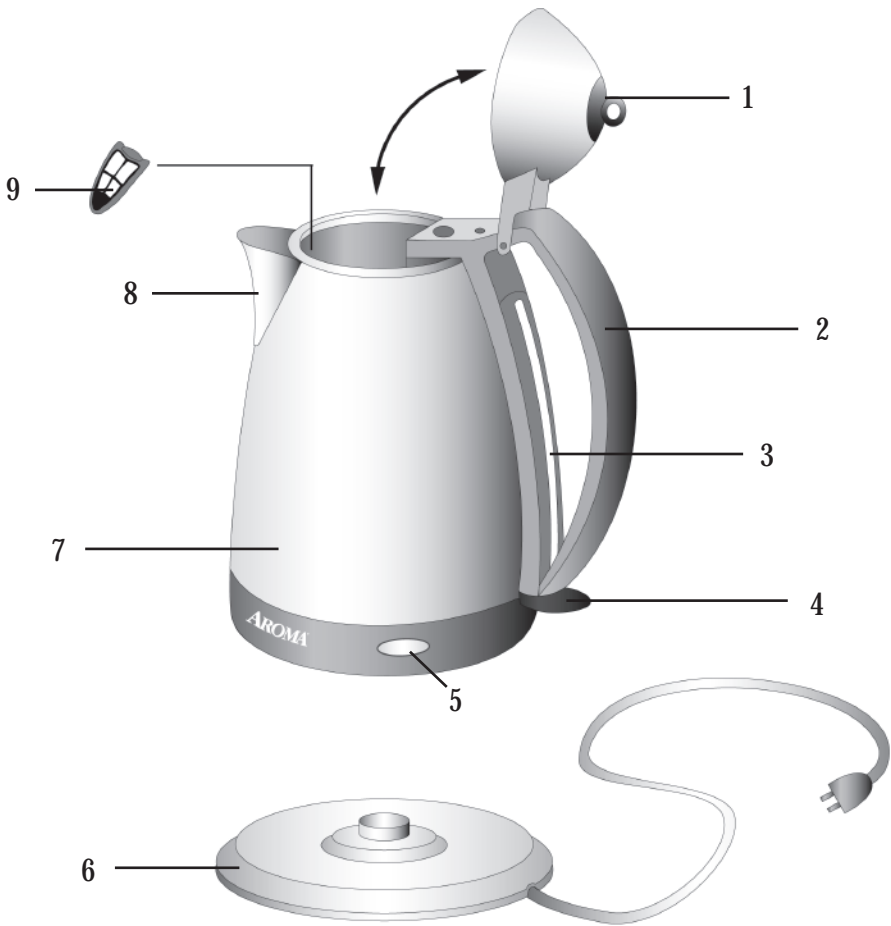

1. Kettle Lid
2. Easy-Grip Handle
3. Water Level Indicator
4. Power Switch
5. Power Indicator Light
6. Power Base
7. Kettle Body
8. Spout
9. Removable Decalcification Filter

USING YOUR WATER KETTLE

Before First Use:

Before using for the first time, it is recommended to clean the interior of the kettle thoroughly. Please follow the procedure below before using the kettle:

1. Remove all packing materials and make sure that product is received in good condition.
2. Taking care to keep the electrical components on the exterior of the kettle dry, wipe out the interior of the kettle with a damp, soapy cloth. If your hand will not fit inside the kettle, swish warm, soapy water around in the interior of the kettle with the lid closed.
3. Rinse out the inside of the kettle thoroughly with water.
4. Remove the decalcification filter (see diagram on page 5 for instructions). Wash filter in warm, soapy water. Rinse and dry thoroughly before placing back in the unit.
5. With a damp cloth, gently wipe off the exterior of the kettle. Do not wipe off electrical components. This may cause damage to the unit.
6. Dry all parts completely.
7. It is also recommended to run your kettle through one boiling cycle before using it to consume beverages. Following the instructions in the "**Boiling Water**" section below, boil one kettle of water. When water has boiled, pour it out and rinse the inside of the kettle once more. Your kettle is now ready for use.

BOILING WATER:

1. Place power base on a sturdy, level surface.
2. Make sure that the removable filter is properly inserted. See diagram on page 5 for instructions on inserting the filter.
3. Open the kettle lid and fill with water through lid opening. Do not fill past the "MAX" line on the water level indicator. Use distilled water when possible for best taste and to minimize mineral build-up in the kettle. **Never fill kettle with any liquid other than water.**
4. Close the lid until it locks securely into place.
5. Making sure the kettle and power base are completely dry and sitting on a level, sturdy surface, place the kettle onto the power base and plug cord into a wall outlet.
6. Press down on the power switch located on the base of the handle to begin the boiling process. The red indicator light will illuminate.
7. Never open lid while water is boiling.
8. Once the water has boiled, the kettle will release the power switch. The power indicator light will turn off, and the unit will automatically shut off.
9. Lift the kettle off the power base before pouring, using the easy-grip handle. Take care not to touch the stainless steel body, as it will be hot.
10. After pouring, make sure the bottom of the kettle and the power base are dry before placing kettle on the power base.
11. When not in use, pour out any unused water and unplug the power base from the wall outlet.

USING YOUR WATER KETTLE

REMOVING & INSERTING THE FILTER

To remove the filter:

1. Do not attempt to remove the filter until the unit has cooled completely. Open the lid.
2. Grasp the angled tab on top of the filter and pull upward. The filter should slide out easily.
3. Wash and rinse the filter, then replace.

To insert the filter:

1. Do not attempt to insert the filter until the unit has cooled completely. Open the lid.
2. Grasping the filter at the angled tab, slide the filter into the clamps on the inside of the spout until filter clicks into place.
3. Kettle is ready for use.

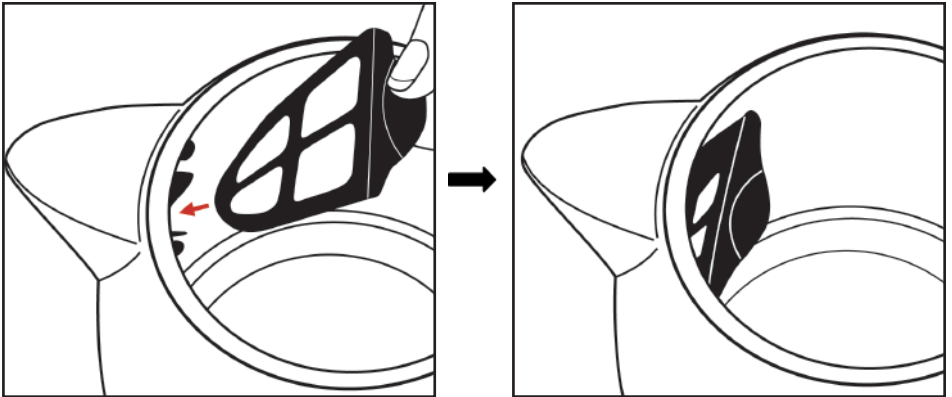

HOW TO CLEAN

1. Always unplug unit and allow to cool completely before cleaning.
2. Wipe the exterior of the kettle with a clean, damp cloth, taking care to avoid electrical components. Use a soft cloth to dry.
3. To clean the interior of the kettle, use a soft sponge and soapy water to gently scrub. If your hand will not fit inside the kettle, swish warm, soapy water around the inside of the kettle with the lid closed. Rinse thoroughly with water.
4. The filter can be removed for cleaning (see diagram on page 5 for instructions). Never attempt to remove the filter when the kettle is hot or contains hot water. Wash filter in warm, soapy water. Rinse and dry thoroughly before placing back in the unit.

Caution



- Never attempt to disassemble the kettle or power base.
- Never immerse the kettle, cord, plug or power base in water. Always take care not to allow electrical components to come into contact with water.
- Do not use abrasive cleaners or scouring pads of any kind on the kettle or power base. This will cause damage to the finish and may create a risk of electric shock.

REMOVING MINERAL DEPOSITS

Hard water can leave mineral deposits that create scale build-up on the interior of the kettle. To avoid this build-up, it is best to always use distilled water. If mineral deposits do occur, follow the instructions below to remove them.

1. Fill the kettle halfway with water and bring to a boil.
2. Add one cup of white vinegar. Let the mixture soak overnight or for at least 6 hours.
3. Empty the mixture and rinse out the kettle.
4. Refill the kettle with water only. Bring to a boil and empty again.
5. Repeat as needed.

TROUBLESHOOTING

PROBLEM	SOLUTION
<p>The kettle and indicator light do not work when the power switch is down.</p>	<ul style="list-style-type: none"> • Make sure the kettle is seated properly on the power base and that the base is connected to a functioning electrical outlet. • If problem persists, please contact our customer service department toll-free at (800) 276-6286.
<p>The water is boiling, but the power switch and indicator light do not turn off.</p>	<ul style="list-style-type: none"> • The auto-shut off function will not operate properly if the lid is not completely closed. Allow kettle to cool, then check to see that the lid is properly locked into place. • If problem persists, please contact our customer service department toll-free at (800) 276-6286.
<p>The power switch won't depress and the kettle will not turn on.</p>	<ul style="list-style-type: none"> • Make sure that the kettle is seated properly on the power base and that the base is connected to a functioning electrical outlet. • Water or debris on the bottom of the kettle or on the power base may interfere with the functioning of the kettle. Be sure that the base of the kettle and the power base are dry and free of debris. • If problem persists, please contact our customer service department toll-free at (800) 276-6286.
<p>There are mineral deposits on the interior of the kettle.</p>	<ul style="list-style-type: none"> • A certain amount of scale build-up is normal after long periods of use and is caused by minerals contained in hard water. The best way to prevent mineral deposits is to always use distilled water in the kettle. • To remove deposits, try filling the kettle with water and adding a few slices of lemon, then boil. If this does not work, please see the section on page 6 entitled "<i>Removing Mineral Deposits.</i>"

LIMITED WARRANTY

Aroma Housewares Company warrants this product free from defects in material and workmanship for one year from provable date of purchase in the continental United States.

Within this warranty period, Aroma Housewares Company will repair or replace, at its option, defective parts at no charge, provided the product is returned, freight prepaid with proof of purchase and U.S. \$10.00 for shipping and handling charges payable to Aroma Housewares Company. Before returning an item, please call the toll free number below for a return authorization number. Allow 2-4 weeks for return shipping.

This warranty does not cover improper installation, misuse, abuse or neglect on the part of the owner. Warranty is also invalid in any case that the product is taken apart or serviced by an unauthorized service station.

This warranty gives you specific legal rights, which may vary from state to state, and does not cover areas outside the United States.

AROMA HOUSEWARES COMPANY
6469 Flanders Drive
San Diego, California 92121
1-800-276-6286
M-F, 8:30 AM - 5:00 PM, Pacific Time
Website: www.aromaco.com