

How to use Gosund with AP Mode

AP Mode

1. Choose Socket (Wi-Fi) :

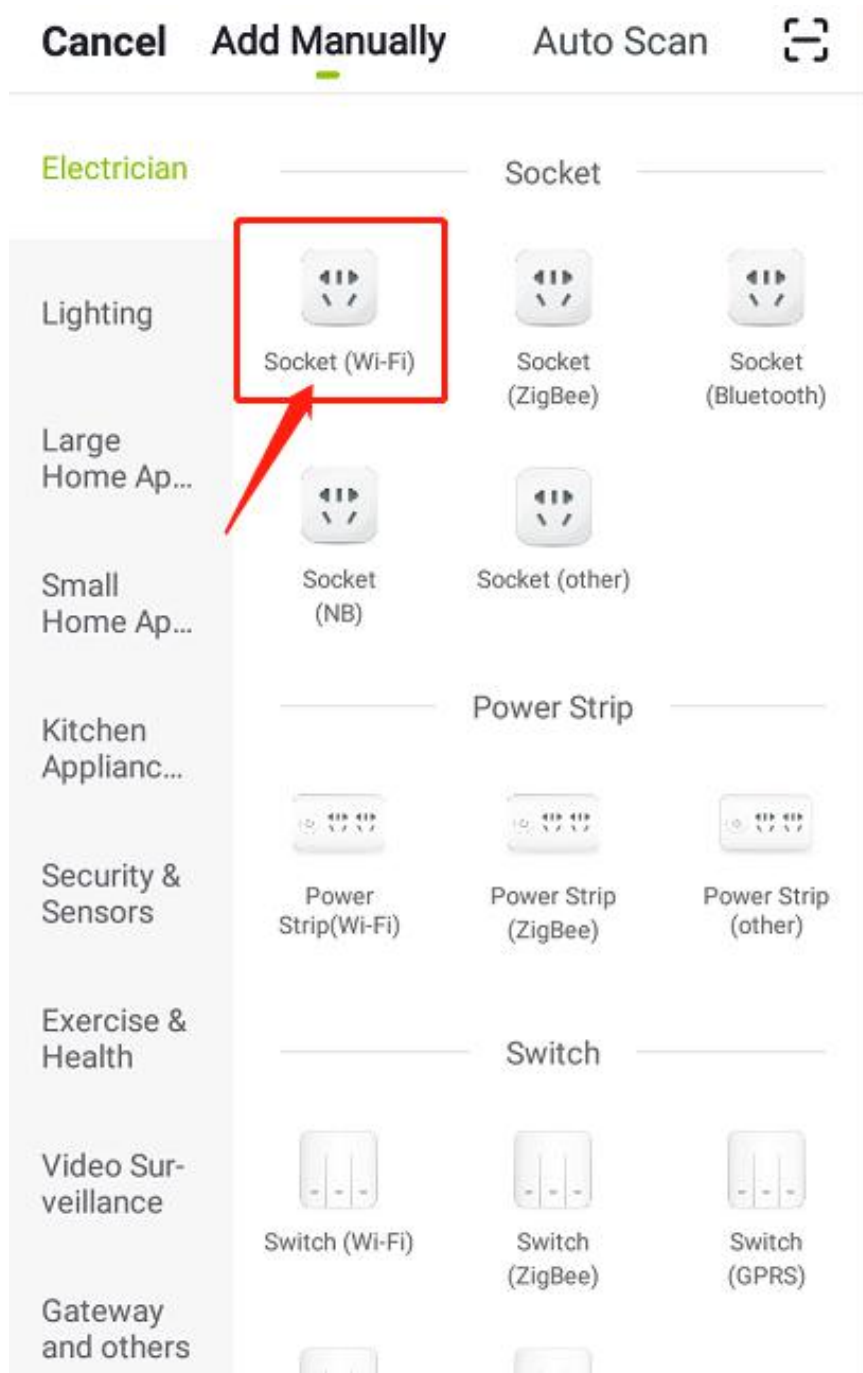

2. Choose Other Mode :

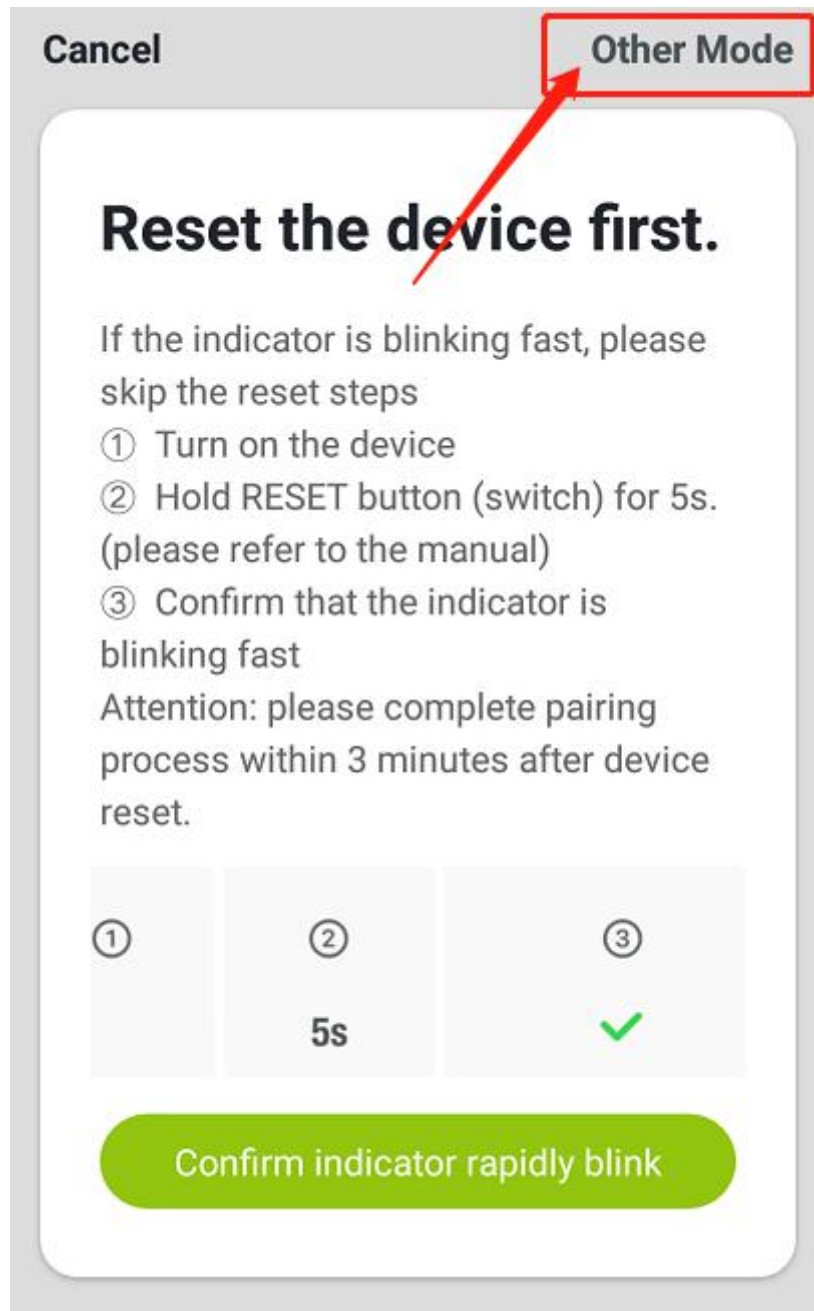

3. Choose AP Mode (indicator slowly blink) :

Cancel Select Network Configuration Mo...

Select a correct network Pairing mode based on the device type or refer to the user manual.

Smart Configuration

The mobile phone will broadcast network config...



AP Mode

The mobile phone connects to the device's Wi-Fi hotsp...



4. Make sure “the indicator light slowly blinks”, then “Confirm” :

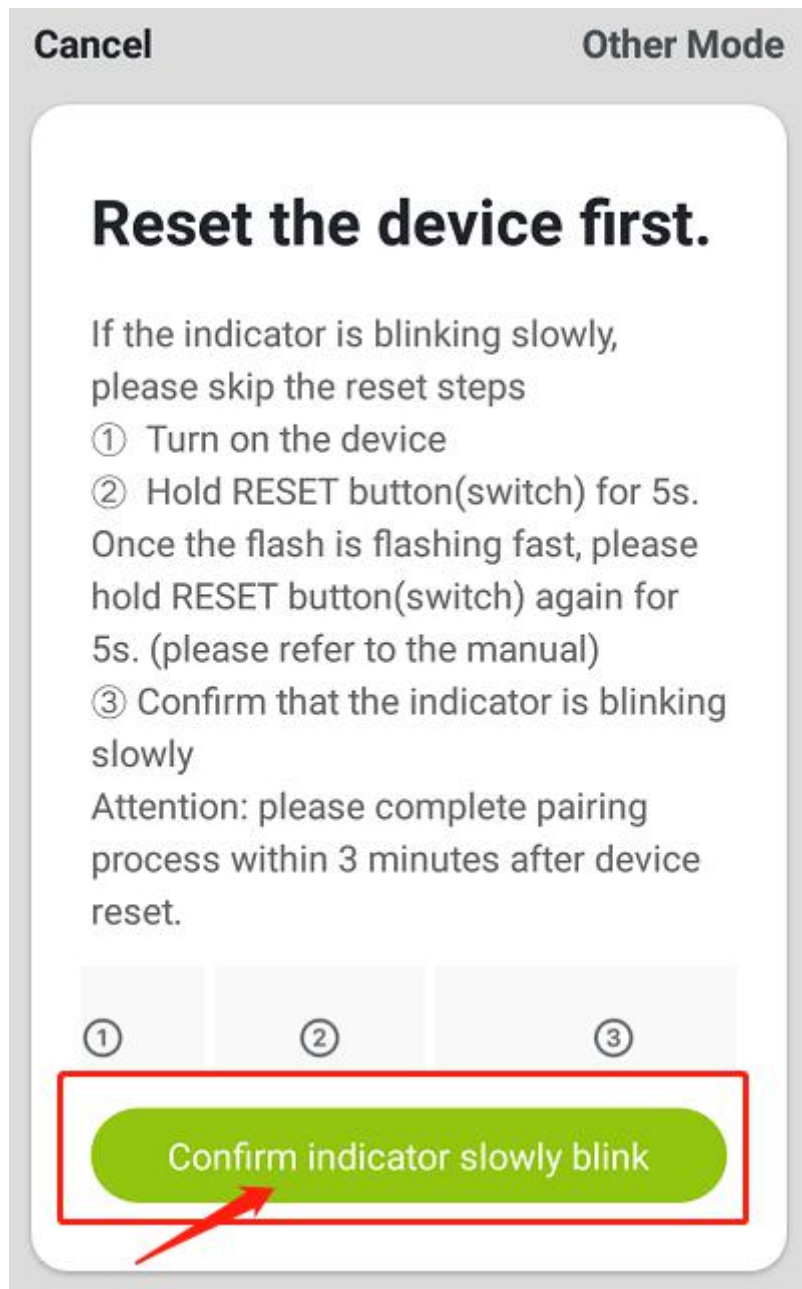

5. Enter your home Wi-Fi password, please make sure the password is correct, then confirm :

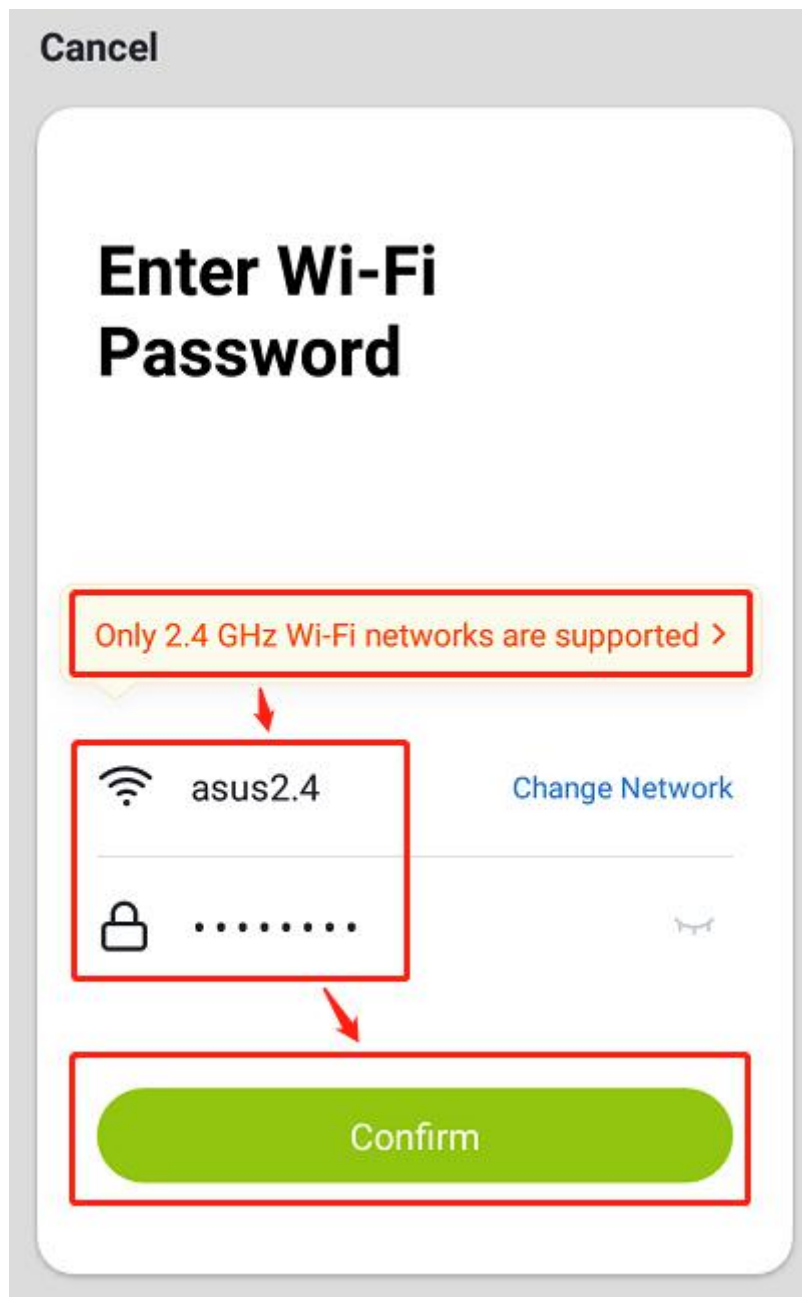

6. Click “ Go to Connect ” :

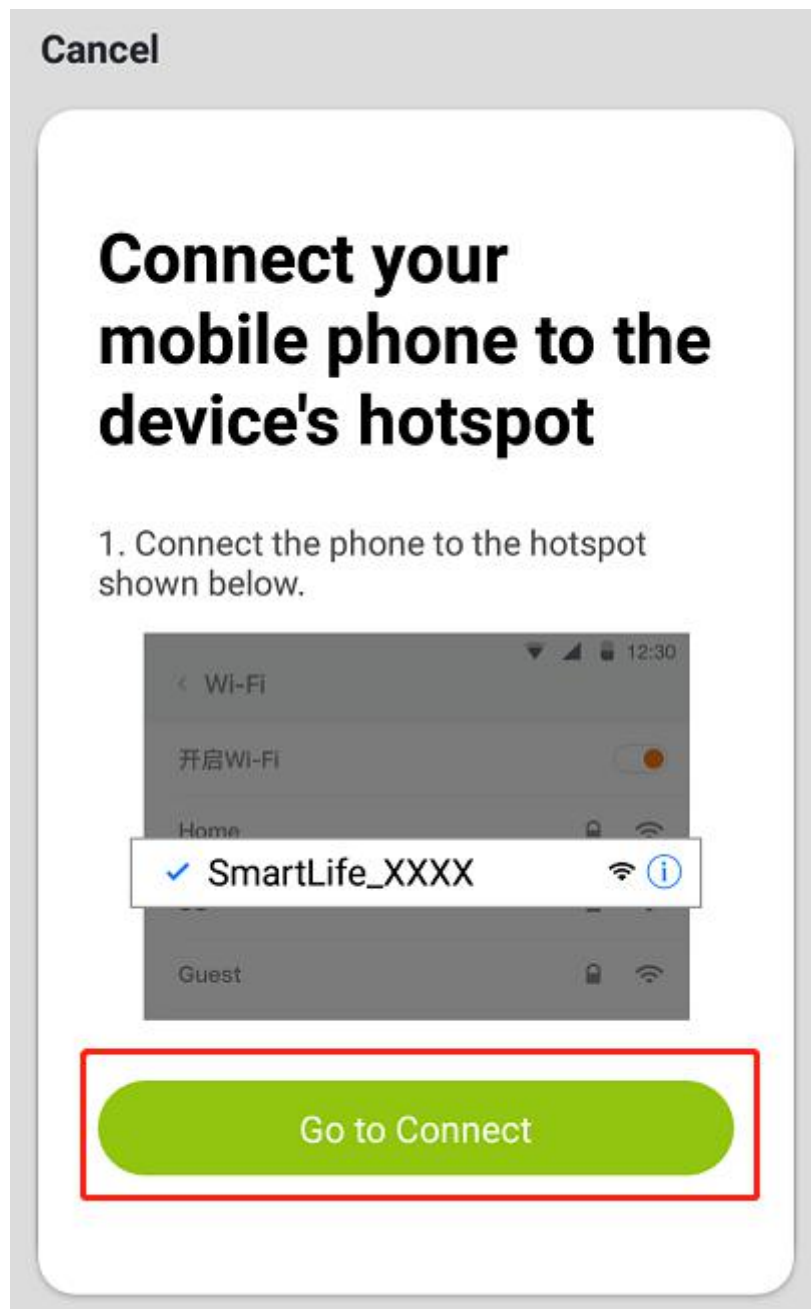

7. Choose the smart plug's Wi-Fi hotspot named Smart Life_XXX

(Note: every smart device has a separate name based on device

id) :

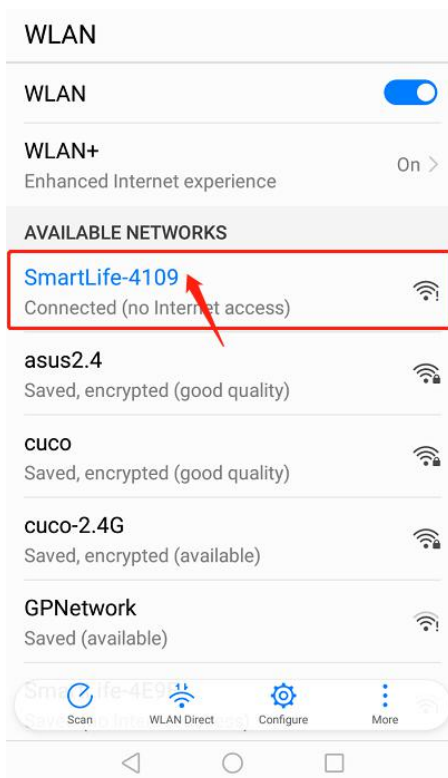

8. Click "No" :

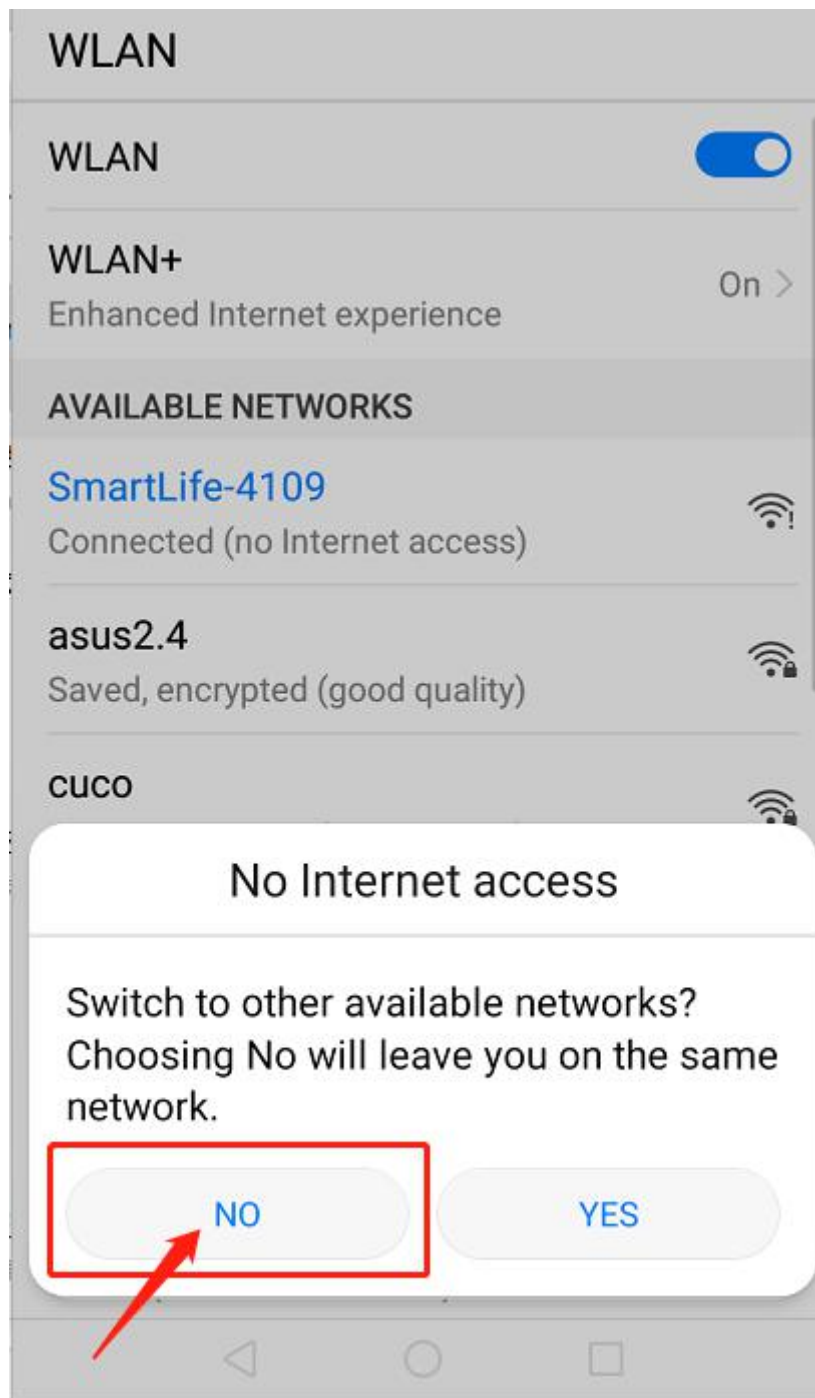

9. Then go back to Connecting, wait the connection to 100% :

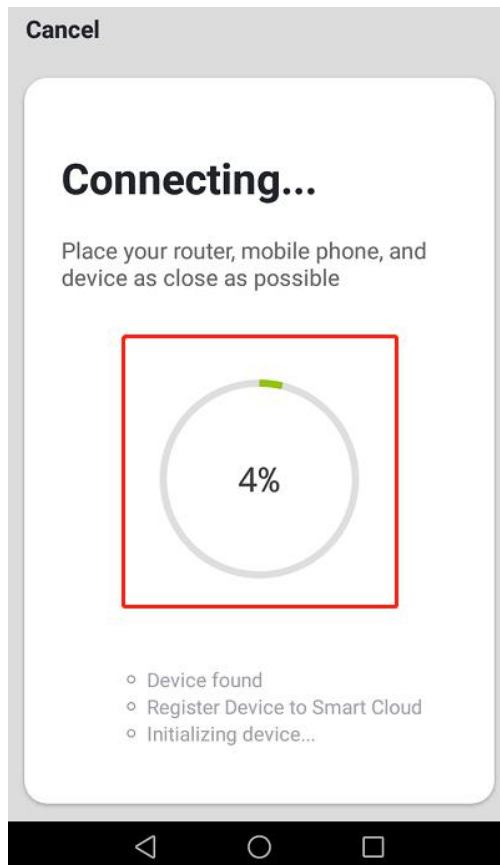
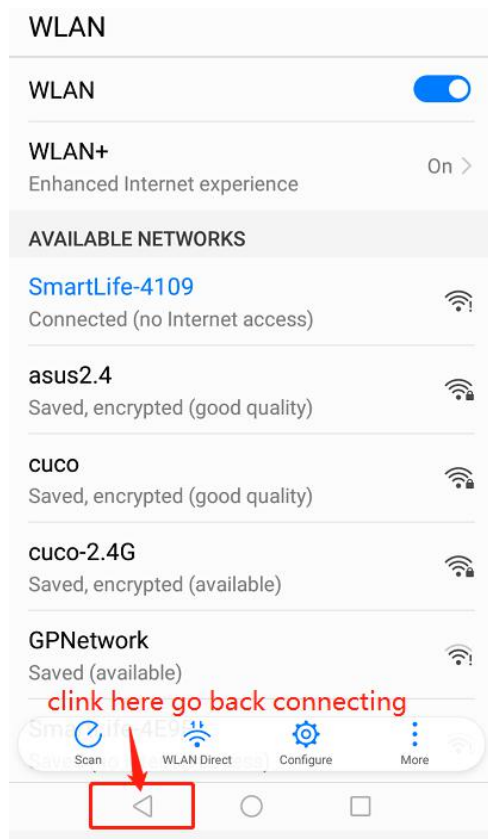

10. Successfully, and you can rename the plug if you like, then click “Done” :

