

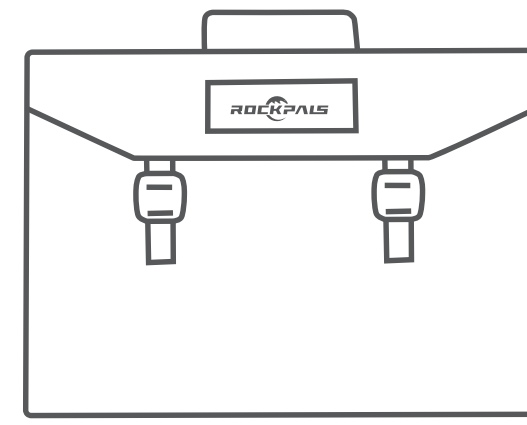

Power Outdoors for Camping



100 Solar Panel

USER GUIDE

ROCKPALS Made in China
www.rockpals.com

Technical Parameters

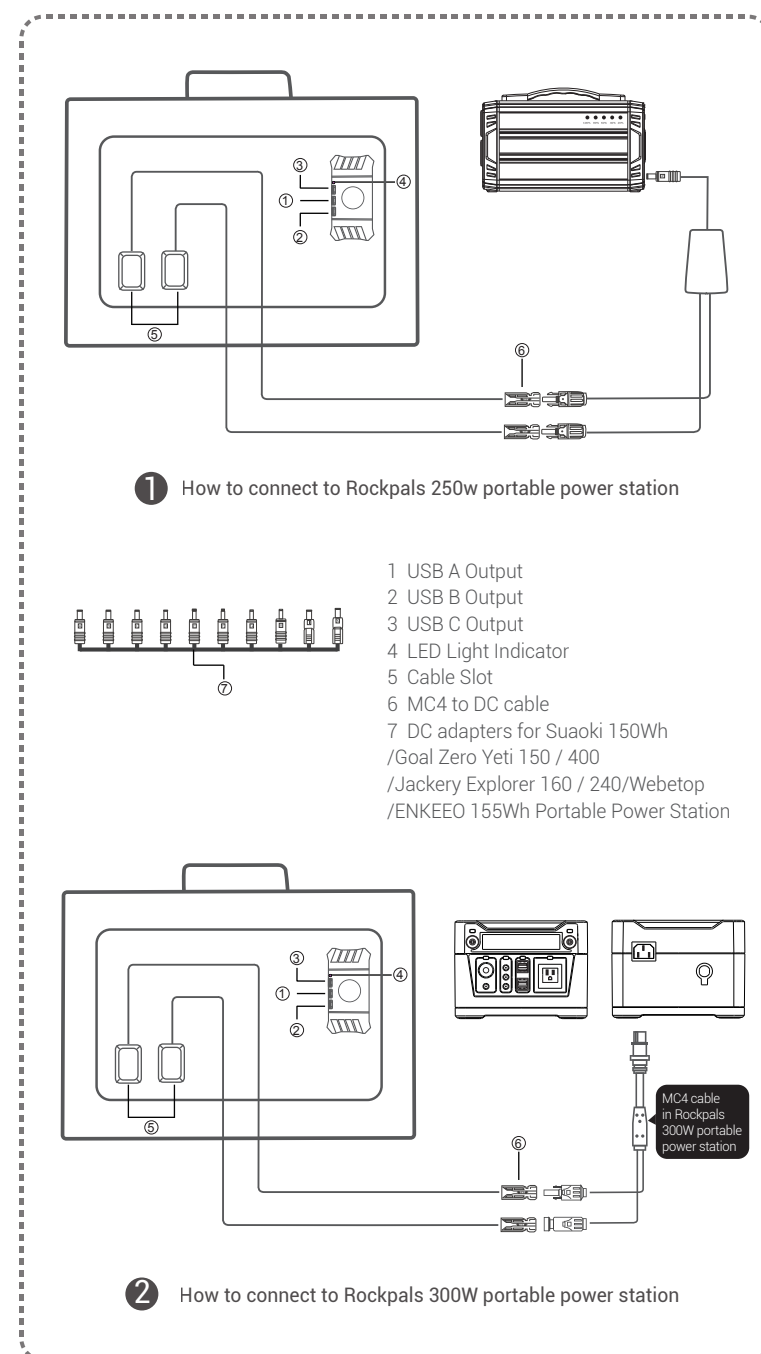

Model	100W Solar Panel
Open Circuit Voltage	19V
Short Circuit Current	3.4A
Operating Temperature Range	-20-45 C
Dimensions	20.5*14.2*2.6 inch (folded)
Dimensions	64.5*20.5*1.2inch (unfolded)
USB A Output	5V/2.4A (USB 2.0)
USB C Output	4V3.6A,5V3.4A,9V2.5A,12V2A,18V5.55AMAX(QC 3.0)

Safety Tips

- Do not put the Solar Panel into a fire or apply direct heat to it.
- Do not pierce the Solar Panel casing with a nail or other sharp object, break it open with a hammer, or step on it.
- This product cannot contact with strong corrosive objects.
- Dispose the solar panel for local environment laws.
- The solar panel is IPX4 water-resistant. Avoid falling into water or used in the rain.

Wide Compatibility

5V USB Port: Smart phones, Tablets, iPad mini, external battery packs, and other 5V USB devices (except for Bluetooth devices under 50mA)
18V DC Port: Charge solar generators or 12V-18V DC-powered devices with built-in controller.

How to charge your solar generator/USB devices

1. Unfold the solar panel and place it under direct sunlight.
2. Connect the solar panel to your devices.
3. Keep your device cool while charging. Place it under the panel, in the pocket of the panel, or in the shade to avoid overheating.

Frequently Asked Questions

Q: What kind of battery can be charged by Rockpals 100W solar panel?
A: 1. Rockpals 250W portable power station/300W portable power station.
2. Suaoki 150wh portable power station
3. Suaoki 150wh portable power station
4. Jackery 160/240 power station
5. Webetop Portable Generator
6. ENKEEO 155Wh Portable Power Station

Q: If my USB device needs an input current of 1A, will the 2A output of the solar panel damage it?
A: No. This solar panel has intelligent charging, detecting the needs of your device and delivering exactly what it needs. If your phone accepts 1A, the charger will deliver 1A

Q: What if the foldable solar panel is not charging my devices?
A: 1. Check the manual of your device to ensure the input voltage is 5V or 18V.
2. Cloudy weather and indirect sunlight may cause fluctuations in the current so that it may hinder or prevent charging. Place the charger in direct sunlight or wait for the weather to clear.
3. Wipe the panels clean with a damp cloth between usages to prevent scratching.
4. Avoid exposure to fire, water and chemical liquid.

Q: If it is partially cloudy or shady will the solar panel still work?
A: Yes, however the charging efficiency will be low causing prolonged charging time.

Q: Can this solar panel charge laptop?
A: Yes, but please check the power should be 12V-18V

Warranty

12 month warranty since purchase date and lifetime friendly customer service.
Email: support@rockpals.com
Tel: (877)756-8666 Service Time: Mon.-Fri.: 9:00-17:00 PST