

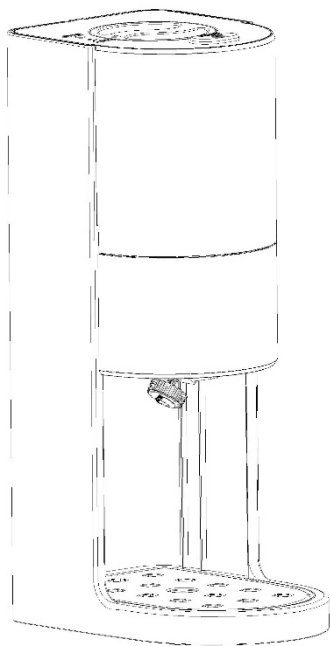

## INSTRUCTION MANUAL



**Electric Ice Shaver**

**Model #S777**

# SAVE THIS MANUAL FOR FUTURE USE

## Registration

You may register this ice shaver through our website at  
[www.HawaiianShavedIce.com/register.html](http://www.HawaiianShavedIce.com/register.html)

## Table of Contents

|                                     |    |
|-------------------------------------|----|
| Registration.....                   | 2  |
| General Warnings & Safeguards ..... | 3  |
| Ice Shaver Specifications .....     | 9  |
| Product Warranty .....              | 9  |
| Parts Diagram .....                 | 12 |
| Assembly & Usage .....              | 13 |
| Cleaning & Care .....               | 15 |
| Shaved Ice Recipes.....             | 16 |
| Shaved Ice Toppings .....           | 17 |

**Mary Mack's Inc.**  
**DBA Hawaiian Shaved Ice**

321 Goldsboro Street

Newton Grove, North Carolina 28366, USA

Toll Free: 1-800-620-2869 | Direct: 910-247-4152 | Fax: 770-234-6333

## **General Warnings & Safeguards**



# **CAUTION!**

To prevent property damage and personal injury, it is important that you read and follow all general warnings, safeguards, and instructions.

- ⚠** Read the instructions provided in this booklet carefully because they give important information with regards to the installation, use, and maintenance. Keep this manual for future reference.
- ⚠** This ice shaver is intended for household use only. Do not use the appliance for other than its intended use.
- ⚠** **This ice shaver has an extremely sharp blade. You should use extreme caution during assembly, operation, disassembly, and while cleaning the unit. If the blade becomes broken or loose, do not use the appliance.**

- ⚠ After unpacking the unit and before each use, make sure the mechanical parts of the unit and all its attachments are intact. Look for any foreign objects before operating the ice shaver. When in doubt, do not use the appliance if there is any visible damage to the appliance or the supply cord, refer to an authorized repair center.
- ⚠ To prevent electrical shock to yourself or others, do not immerse the cord, plugs, motor unit or any other electrical parts in water or other liquids of any kind.
- ⚠ Use extreme caution to make sure you never place your fingers or other items into the machine or the machine's moving parts.
- ⚠ Do not operate the machine without ice.
- ⚠ Use this appliance for no more than two continuous minutes. Failure to obey this may cause the ice shaver to overheat. Allow the appliance motor to cool down before repeat usage.
- ⚠ All packing elements (plastic bags, polystyrene, etc.) should be kept out of the reach of children because they are potentially hazardous.
- ⚠ Before plugging the appliance into a power source, make sure the voltage details marked on the appliance seal/plaque correspond to those of your power supply. The seal/plaque is located on the motor unit.
- ⚠ This appliance has a polarized plug (one blade is wider than the other). As a safety feature, this plug will fit a polarized outlet only one way. If the plug does not fit fully in the outlet, reverse

the plug. If it still does not fit, contact a qualified electrician.  
Do not attempt to defeat this safety feature.

 In the event, the wall socket and the appliance plug are not compatible, have the socket changed by a qualified professional who must also ensure that the cross section of the socket wiring corresponds to the power consumed by the appliance. Generally speaking, adapters, multiple sockets, extension cords, and/or drop cords should not be used. However, if necessary, only use single or multiple adapters and extension cables which comply with the existing safety standards, making sure the current carrying capacity limits marked on the single adapter and the extension cables as well as the maximum power limit marked on the multiple adapters are not exceeded.

 Do not use the machine around a hot surface or hot appliances. Keep the appliance away from stovetops, broilers, ovens or any other potentially hot appliance. Pay special attention to the electrical cord to prevent it from touching a hot surface.

 This appliance must be used only for the purposes it was designed for, (i.e., for crushing/shaving ice in the home). Any other use must be considered improper and therefore dangerous. The manufacturer cannot be held responsible for any damages deriving from improper, incorrect, or unreasonable uses.

- ⚠ The use of any additional accessory attachments not recommended by HawaiianShavedIce.com is not suggested. Failure to obey this warning may cause fire, electric shock, or injury to yourself or others.
- ⚠ The use of any electric appliance requires the user to observe basic rules.

### In Particular:

- ⚠ Never touch the appliance with wet or damp hands.
- ⚠ Never use the appliance barefoot.
- ⚠ Never pull the electrical cable or the appliance itself to remove the plug from the electrical socket.
- ⚠ Avoid all contact with any moving parts of the appliance.
- ⚠ Never leave the appliance exposed to the elements (rain, sunshine, etc.).
- ⚠ Never let children or those unable to operate the appliance use it unattended. Do not leave the unit unattended while plugged into a power source.
- ⚠ **Before any cleaning, maintenance, assembly, or disassembly, make sure that the ice shaver is disconnected from the main power supply by unplugging it.**
- ⚠ Should the appliance be out of order and operating inefficiently switch it off and do not attempt to tamper with it. For any repairs, approach an authorized service center only and

request the use of original spare parts. Failure to comply with the above might result in compromised safety of the appliance.

- ⚠ Should you decide to stop using the appliance, it is advisable to render it unusable by cutting the electrical cable after unplugging it from the main power supply.
- ⚠ Furthermore, it is advisable to render all hazardous parts of the appliance harmless, particularly for children, who might play with the discarded appliance.
- ⚠ Installation must be carried out in compliance with the manufacturer's instructions. Incorrect installation can cause damage to people, animals, or objects for whom the manufacturer may not be held responsible.
- ⚠ To avoid dangerous overheating, it is advisable to unwind the electrical cable completely and use the appliance as recommended in the "Usage Precautions" paragraph.
- ⚠ Never leave the appliance plugged in when not needed. Unplug from the power supply plug whenever the appliance is not in use.
- ⚠ Never obstruct the openings or slits for ventilation and heat dissipation.
- ⚠ Should the electrical cable of this appliance become damaged, have it replaced by a manufacturer authorized after-sales service center only because special tools are required.
- ⚠ The manufacturer reserves the right to make any changes considered necessary for industrial, commercial, or design

improvements or to comply with particular standards. It is advisable to pay particular attention to those warnings highlighted with the  symbol.

## Usage Precautions

- Before using this appliance for the first time or after a long period of disuse, wash the shaver bowl assembly cup in warm water with dish soap, rinse and dry thoroughly.
- Before each use of the appliance, check that it is mechanically intact. The motor unit, the shaver bowl assembly, and the support base must not be cracked or broken in any way. The sheath and the plug should not be cracked or broken. However, if they are, remove the plug immediately from the socket and take the appliance to an authorized technical center for necessary repairs.
- Ensure that the ice shaver and the cable are not too close to the edge of the table or work surface, that it is not touching heat sources, and that it is not near a sink.
- Never immerse the motor unit in water or other liquids.
- Substances other than ice should never be placed in the container shaver bowl assembly.
- Never run the appliance while empty.



- Never run the appliance before it has been correctly mounted on its base.
- Never put your fingers into the bowl assembly because the blade is very sharp and may cause injury.
- Do not damage the blade by using metal implements.
- Do not attempt to sharpen the blades; if necessary, replacement blades may be purchased at [HawaiianShavedIce.com](http://HawaiianShavedIce.com).

## **Ice Shaver Specifications**

Model S777, Electric Ice Shaver – Shaved Ice Machine  
Power: 20v, 60Hz, 65W max | Made in China

## **Product Warranty**

### **Ice Shaver 1-Year Limited Warranty**

Mary Mack’s, Inc. DBA [HawaiianShavedIce.com](http://HawaiianShavedIce.com) warrants to the original purchaser that the Hawaiian Shaved Ice Electric Ice Shaver Machine #S777 shall be free from material defects in material and workmanship under normal household use for a period of one (1) year from the original date of purchase provided that the ice shaver and all parts thereof are used in accordance with all of the general warnings, safeguards, and instructions found in this instruction manual.

If the product is determined to be materially defective during the warranty period, your sole remedy and Mary Mack's, Inc, sole and exclusive liability shall be limited to the repair or replacement of this product with a new or refurbished product at Mary Mack's, Inc. option. This warranty does not cover exterior or interior finish or damage caused by misuse, scratching, accident or negligence. This warranty is extended only to the original purchaser and does not apply to commercial use or damage to the product (not resulting from defect or malfunction) while in possession of the original consumer. Mary Mack's, Inc. claims no responsibility for consequential, foreseeable, incidental, or commercial losses caused as a result of using this product.

If a problem with this ice shaver develops during the warranty period, please contact Mary Mack's, Inc. for service. Send a brief letter or email explaining the problem along with a copy of your receipt or other proof of the original purchase date, which will be required before warranty service is rendered. Be sure to include your name, address, and phone number.

Any ice shaver submitted for repair must be sent (transportation charges prepaid) to the following authorized repair center:

Mary Mack's, Inc.  
Attn: Repair Department  
321 Goldsboro Street, Newton Grove, NC 28366

If you have any questions concerning the use and/or care of this product or comments regarding your experience with the product, we would like to hear from you. Feel free to give us a call at 1-800-620-2869 or email us at [CustomerCare@HawaiianShavedIce.com](mailto:CustomerCare@HawaiianShavedIce.com).

This warranty is valid in the United States & Canada only.

# Parts Diagram

## Get to Know Your Shaver

1. Power cord & plug
2. 'S' Shape handle for LOCK & OPEN
3. Switch button
4. Motor unit
5. Shaft & spring
6. Driving disk
7. Drum
8. Shaver bowl
9. Blade
10. Blade adjustment knob
11. Stand
12. Drip tray
13. Drip tray lid
14. Ice mold cups

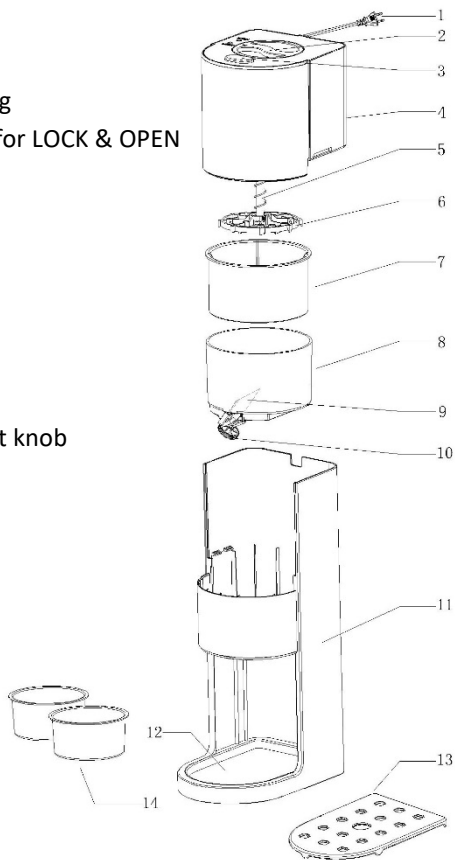

# Assembly & Usage

## Before Usage

When using the appliance for the first time, wash the ice cup and shaver bowl in warm, soap water, rinse and dry. Remember the blade of the shaver is sharp, use caution when handling the shaver bowl.

## Using Your Ice Shaver

1. Always ensure that the appliance is switched off and it is not plugged into an electrical outlet before you assemble or dismantle the ice shaver.
2. Fill the ice molds  $\frac{3}{4}$  of the way full with water. Do not fill the entire cup. Place the ice molds on a level surface in the freezer until the water is completely frozen. Once frozen you will have a small round block of ice. If needed, additional ice molds may be purchased.
3. Take the frozen ice molds out of the freezer. Remove the frozen round ice block from the plastic ice mold.

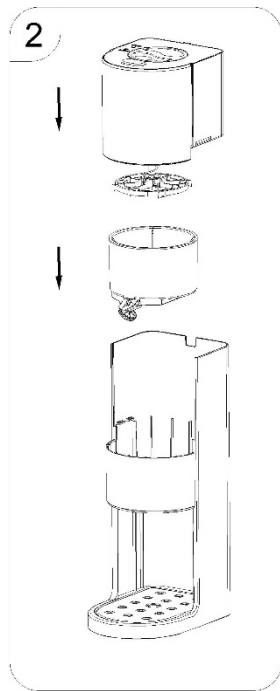
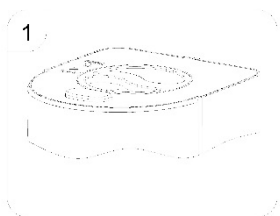

4. Turn the ‘S’ shaped handle of the motor unit from LOCK to OPEN to remove the motor unit from the stand [Figure 1].
5. Once the ice is thawed, place the ice puck into the drum and the drum into the shaver bowl. Always have the blade turned toward you. [Figure 2].
6. Place the motor unit on top of the shaver bowl and turn the ‘S’ handle to the LOCK position. Make sure the motor unit is always snapped completely into the stand on both sides of the unit. You should hear a click.
7. Plug the ice shaver into an electrical outlet and place a bowl or cup onto the drip tray to collect the shaved ice [Figure 2].
8. Press and hold down the power button to start the motor unit.
9. Release the power button to stop the ice from shaving.
10. Apply your favorite premium Hawaiian Shaved Ice syrup and ENJOY!
11. Unplug the ice shaver from the electrical outlet immediately after use.

### **Tips & Tricks**

1. For fluffiest ice, allow the ice blocks to thaw for about 5-7 minutes before shaving. This will produce fluffier snow and will allow the ice to be easily removed from the ice mold.
2. After shaving a block of ice, a thin block will remain inside the shaver bowl. The remaining ice must be discarded before inserting into another block. When removing the remaining ice,

- use caution and pay attention to the blade and avoid all contact with the blade to prevent injury to yourself or others.
3. During the freezing stage, the block of ice may become dome-shaped. If this should happen, place the flat side down inside the shaver bowl for the best results.
  4. If the ice is not dispensing, but the motor runs, adjust your blade using the blade adjustment knob to get your desired consistency.
  5. If the block of ice stop rotating during use, stop the appliance and unplug from the power outlet. Remove the motor unit, turn the ice block over, and resume shaving.

## **Cleaning & Care**

1. Ensure that the ice shaver is off and disconnected from the power supply
2. Dismantle the appliance in the reverse order that it was put together. Start by turning the 'S' shaped handle from LOCK to OPEN, and lift the motor unit off of the stand.
3. During cleaning, use caution and pay special attention to the ice shaving blade to avoid all contact with the blade.
4. Avoid using abrasive detergents or cloths.
5. Wipe the outside of the motor unit with a slightly damp cloth but do not soak or immerse the motor unit in water or other liquids.

6. All machine parts other than the motor unit may be washed in warm water with mild soap and rinsed.
7. Never place any of the appliance parts into a dishwasher.
8. Dry all parts paying particular attention to the blades before putting the ice shaver away.

## Shaved Ice Recipes

There is so much more that you can do with shaved ice than just simply shaving ice into a bowl and adding flavor. Try the great recipes below for fun and easy treats.

**The Classic Shaved Ice** – Shave a mountain of fluffy snow into a small bowl or ice cup. Add premium shaved ice flavor from Hawaiian Shaved Ice and enjoy. The flavor will be absorbed into the ice. Remember that a little flavor goes a long way. You want to eat shaved ice with a spoon not with a straw!

**Dipped Delight** – Take a small bowl or ice cup and add a scoop of vanilla or your favorite flavor of ice cream to the bottom of the cup. Shave ice on top of the ice cream and top with your favorite Hawaiian Shaved Ice syrup. Enjoy the combination treat! A big seller at shaved ice stands all across the country!

**Rainbow Shaved Ice** – Shave a mountain of fluffy snow into a small bowl or ice cup. Take two or more flavors and pour them



over the shaved ice to create a rainbow effect. Try mixing colors like yellow and blue to get a green stripe down the middle. Very popular!

**Slush Drinks** – Dilute one-part shaved ice syrup to three-parts water. Add the mixture over a tall cup of shaved ice. Pour just enough syrup mixture to cover the ice to keep it slushy. A great refreshing treat!

**Soda Ice** – Nothing helps make your favorite soda more refreshing than a tall cup of shaved ice. Pour your favorite soda over shaved ice and enjoy!

**Fruit Ice** – Instead of shaved ice syrup or soda, try natural fruit juices, lemonade or even tea over shaved ice. Serve these treats at your next party and it will be a hit!

**Mixed Drinks** – Instead of having your alcoholic drink on the rocks, try serving it over shaved ice. This also works well with margaritas, smoothies and other frozen drinks!

## Shaved Ice Toppings

**Sweetened Condensed Milk/Sweet Cream** – This is the most popular topping used at shaved ice stands. Purchase a can of sweetened condensed milk from your local grocery store. Then

simply pour a small amount of sweetened condensed milk over your flavored shaved ice treat and enjoy!

**Evaporated Milk** – If you want to give your shaved ice a creamy flavor, add a dose of evaporated milk over the top of your flavored shaved ice treat. Mix gently with a spoon and enjoy! This is especially great with Vanilla, Peach, Banana, Pina Colada and Coconut.

**Marshmallow Topping** – Add a dab to your next shaved ice treat to make it extra special.

**Fresh Fruit** – Try adding a fruit garnish to your shaved ice treat to make it tasty! Popular garnishes include cherries, pineapples, bananas, oranges, lemons and limes.

**Other Uses for Shaved Ice** – Use shaved ice to make an ice bed for serving shrimp, seafood or other cold items.



**Mary Mack's Inc.**

**DBA Hawaiian Shaved Ice**

321 Goldsboro Street

Newton Grove, North Carolina 28366, USA

Toll Free: 1-800-620-2869

Direct: 910-247-4152

Fax: 770-234-6333