

SAFETY INSTRUCTIONS

- Basket safety interlock switch is not activated. See below solution.

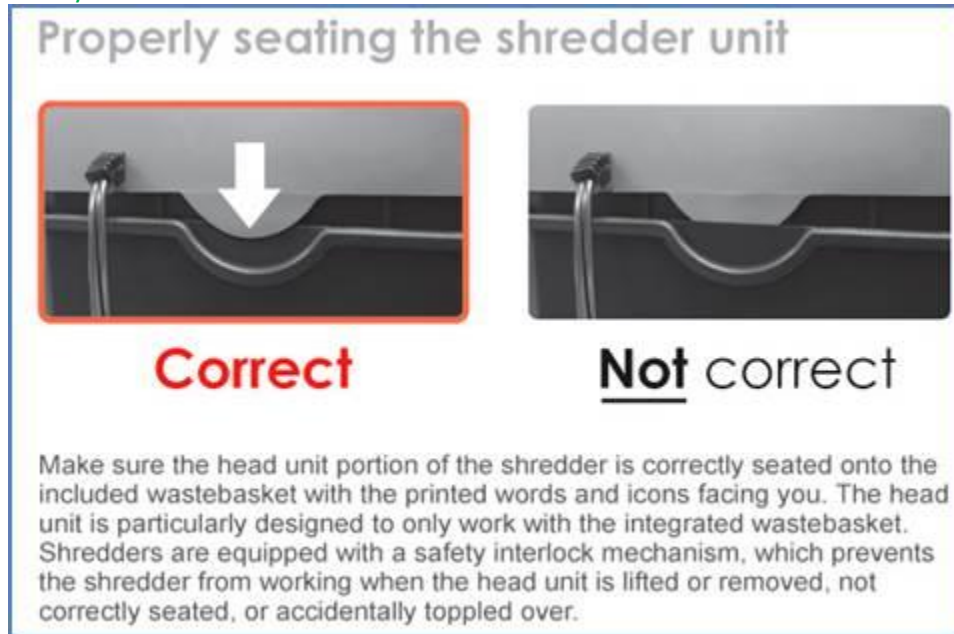

- Paper stuck inside of the feeding slot due to overfeeding.

Solution: Feed a card stock or stiff index card to push through the paper jam while in AUTO mode.

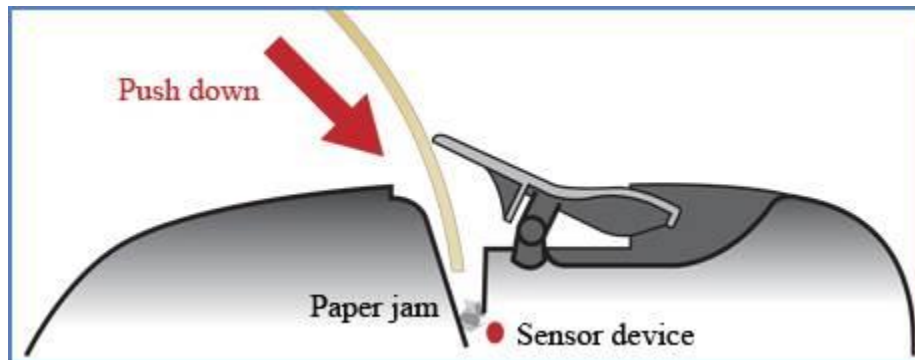

SAFETY INSTRUCTIONS

- Basket safety interlock switch is not activated. See below solution.

Properly seating the shredder unit



The diagram consists of two side-by-side photographs of a shredder's head unit being placed onto a wastebasket. The left photograph shows the head unit being pushed down into the wastebasket, with a white arrow pointing downwards. This is labeled 'Correct'. The right photograph shows the head unit resting on top of the wastebasket without being pushed down. This is labeled 'Not correct'.

Correct **Not correct**

Make sure the head unit portion of the shredder is correctly seated onto the included wastebasket with the printed words and icons facing you. The head unit is particularly designed to only work with the integrated wastebasket. Shredders are equipped with a safety interlock mechanism, which prevents the shredder from working when the head unit is lifted or removed, not correctly seated, or accidentally toppled over.

- Paper stuck inside of the feeding slot due to overfeeding or leaving the basket too full. **Solution: Feed a card stock or stiff index card to push through the paper jam while in AUTO mode.**

