

## **User Manual of Product 1:**

Logitech G915 LIGHTSPEED TKL Tenkeyless Wireless Mechanical Gaming Keyboard with low profile GL-Tactile key switches, LIGHTSYNC RGB, Ultra thin design, 40+ hours battery life, QWERTY UK Layout - White

# G603

LIGHTSPEED™ Wireless Gaming Mouse  
Souris gaming sans fil LIGHTSPEED™

Setup Guide | Guide d'installation

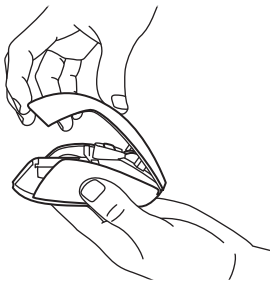
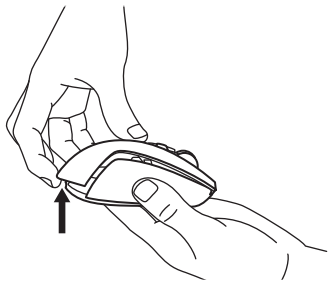
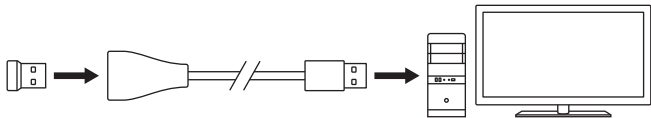

logitech 

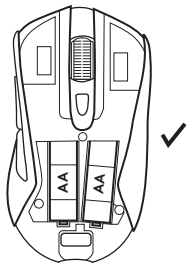

 x 2

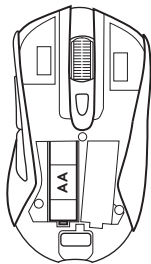

 x 1

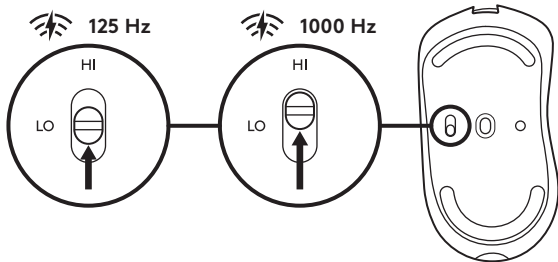

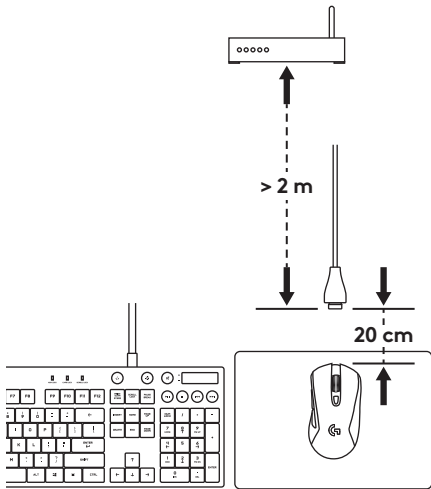

[www.logitech.com/support/g603](http://www.logitech.com/support/g603)

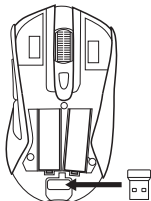
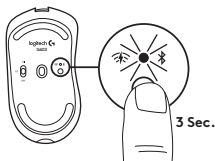

M/N: C-U0008

CFT: RCPLOCU11-0321

**TRA**  
**REGISTERED No:**  
**ER43529/15**  
**DEALER No:**  
**DA0065887/11**

MODELO: C-U0008  
0899-11-3229



(01)07899840473487

© 2017 Logitech. Logitech, Logi and other Logitech marks are owned by Logitech and may be registered. The *Bluetooth*® word mark and logos are registered trademarks owned by the Bluetooth SIG, Inc. and any use of such marks is under license. All other trademarks are the property of their respective owners.

© 2017 Logitech. Logitech, Logi et les autres marques Logitech sont la propriété de Logitech et sont susceptibles d'être déposées. La marque et les logos *Bluetooth*® sont des marques déposées détenues par Bluetooth SIG, Inc. et sont utilisés sous licence. Toutes les autres marques sont la propriété de leurs détenteurs respectifs.

620-007755.002

## Troubleshooting gaming-keyboard profile detection using Logitech Gaming Software

You can configure your gaming keyboard separately for each game or application on your computer (see [360023244954](#) for instructions). When a game is launched, the profile associated with it should activate. Sometimes, the profile doesn't activate properly, which can prevent game-specific settings from being applied.

When a game profile isn't activating properly:

- Try using a Persistent Profile (see answer [360023244954](#) for instructions).

**NOTE:** Using a persistent profile will help you determine if the Logitech Gaming Software is working properly.

- Make sure the correct .exe file is selected for the game (see answer [360023244954](#) for help).
- Check that both the single player and multiplayer .exe files have profiles (see answer [360023244954](#) for help)