

## Door Knob Cover Installation Instructions:

### To install:

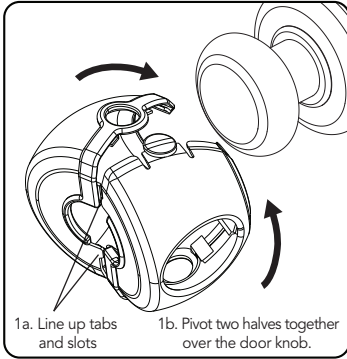

1. Assemble halves around door knob by aligning front tabs and making sure all locking channels are aligned and securely fastened.

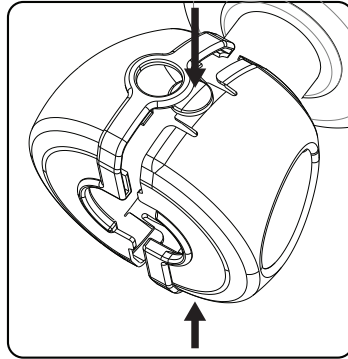

2. Make sure button is aligned below the locking ring on both sides while aligning all the other slots and tabs.

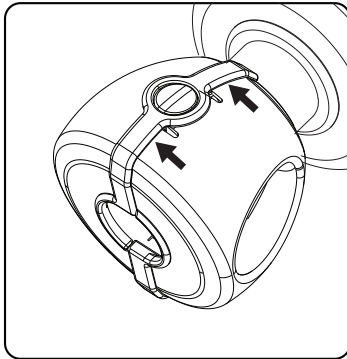

3. When assembled, make sure tabs are aligned properly and fully inserted on both sides. Door Knob Cover should spin freely.

CCD-0051-000 REV 1

**To Use:** To open door, grab door knob through holes in Door Knob Cover and turn door knob.

**To Clean:** Wipe with a clean damp cloth.

**CAUTION:** This product is only a deterrent. Total access is not prevented and should not be a substitute for adult supervision. Discontinue use when child becomes old enough to defeat it. Discard all packaging components before use.

### To remove:

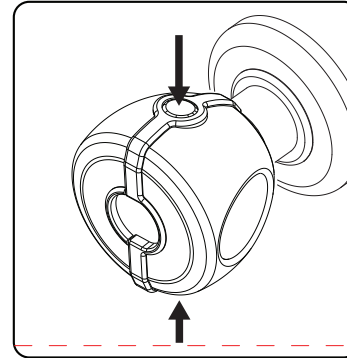

1. Separate halves by pressing top and bottom unlock buttons.

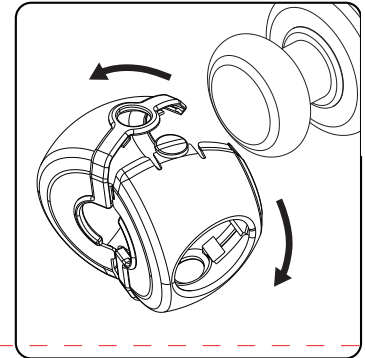

2. Pull apart two halves of Door Knob Cover.

**munchkin<sup>B</sup>**  
It's the little things.<sup>®</sup>

800.344.BABY (2229)  
[www.munchkin.com](http://www.munchkin.com)

PRODUCT AND DESIGN ARE TM & ©2011 MUNCHKIN, INC. MUNCHKIN AND IT'S THE LITTLE THINGS ARE TRADEMARKS OR REGISTERED TRADEMARKS OF MUNCHKIN, INC. 16689 SCHOENBORN ST., NORTH HILLS, CA 91343. MUNCHKIN BABY CANADA LTD., 50 PRECIDIO CT., BRAMPTON, UNIT A, ON L6S 6E3. MADE IN CHINA/FABRIQUÉ EN CHINE.

CCD-0051-000 REV 1