

Elgato Stream Deck – Quick Start Guide

Step 1 - Connect Stream Deck

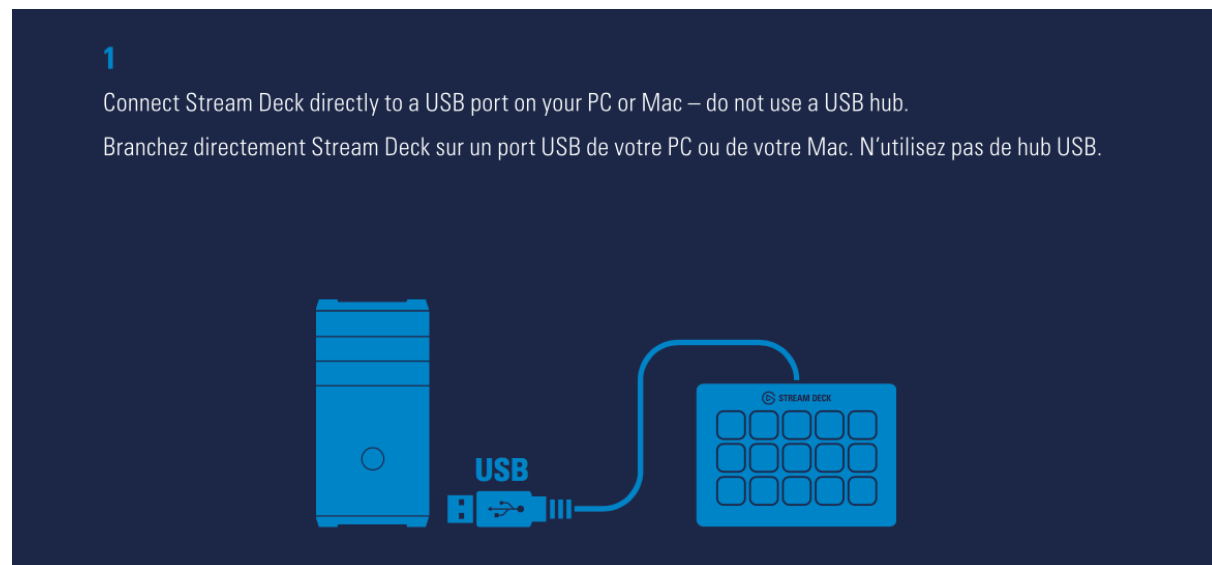

Connect **Stream Deck** directly to a USB port on your PC or Mac – do not use a USB hub.

Step 2 - Download Stream Deck app

Elgato Stream Deck – Quick Start Guide

2

Download and install the Stream Deck app.

Téléchargez et installez l'app Stream Deck.



Download and install the **Stream Deck** app:

<https://www.elgato.com/gaming/download>

Step 3 - Launch and Customize Stream Deck

Elgato Stream Deck – Quick Start Guide

3

Launch the app to customize Stream Deck. Drag actions from the right panel and drop them onto your desired keys on the left.

Ouvrez l'app pour personnaliser votre Stream Deck. Glissez-déposez des actions du panneau de droite vers les touches souhaitées situées à gauche.



Launch the app to customize **Stream Deck**.

Drag action from the right panel and drop them onto your desired keys on the left.

Step 4 - Use Custom Icons

4

Configure your actions and personalize keys with custom icons. Use 72 x 72 pixels .jpg or .png files to achieve best results.

Configurez vos actions et personnalisez les touches au moyen d'icônes personnalisées. Pour un résultat optimal, utilisez des fichiers .jpg ou .png de 72 x 72 pixels.



Elgato Stream Deck – Quick Start Guide

Configure your actions and personalize keys with custom icons.

Use 72 x 72 pixels .jpg or .png files to achieve best results.

Step 5 - Create Folders

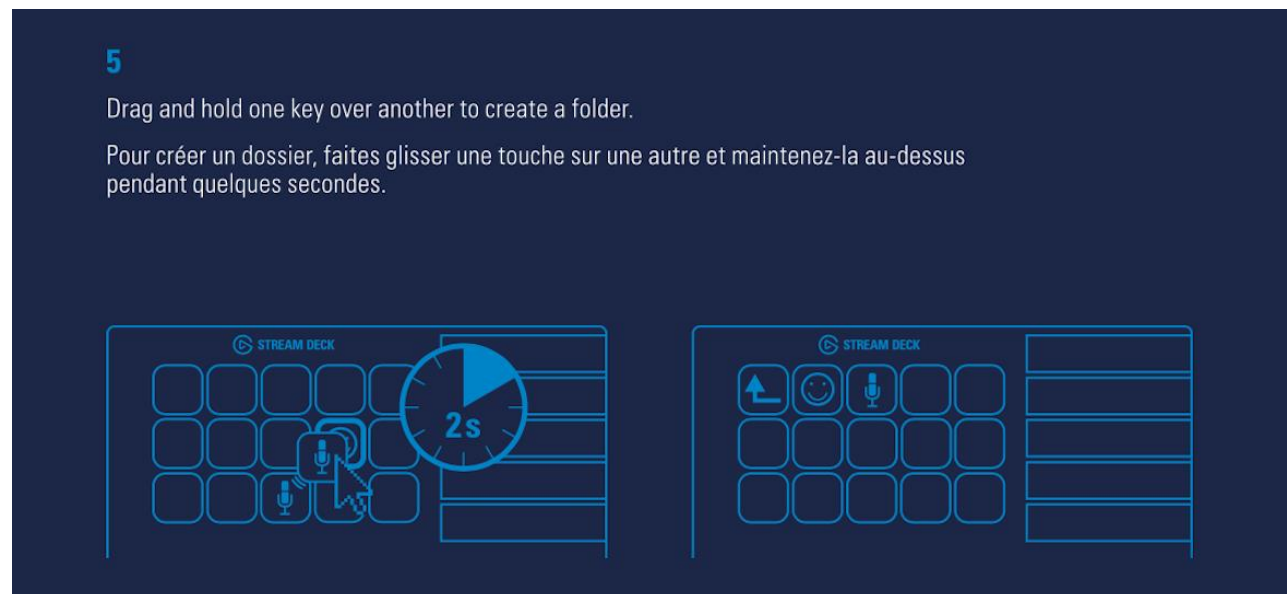

Drag and hold one key over another to create a folder.

Elgato Stream Deck – Quick Start Guide

Tap the back key to exit a folder and return to your main configuration.

Pour quitter un dossier et revenir à la configuration principale, touchez la touche de retour.



Tap the back key to exit a folder and return to your main configuration.

Step 6 - Right-Click Keys to Modify

Elgato Stream Deck – Quick Start Guide

6

Right-click keys to copy, delete or reset them.

Cliquez avec le bouton droit de la souris sur une touche pour copier la touche, la supprimer ou la réinitialiser.

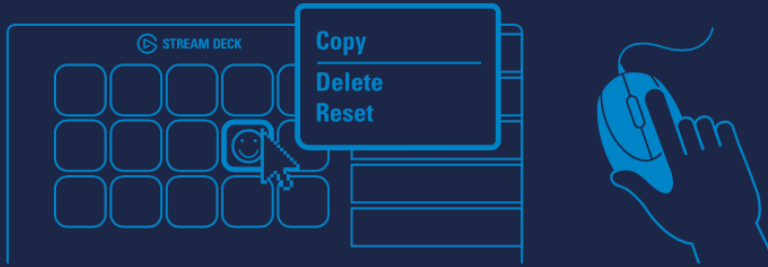

Right-click keys to Copy, Delete, or Reset them.

Step 7 - Use Stream Deck's Stand

Elgato Stream Deck – Quick Start Guide

7

Prop Stream Deck on the included stand and adjust the legs for optimum access.

Placez Stream Deck sur le support fourni et réglez les pattes pour un confort d'utilisation optimal.

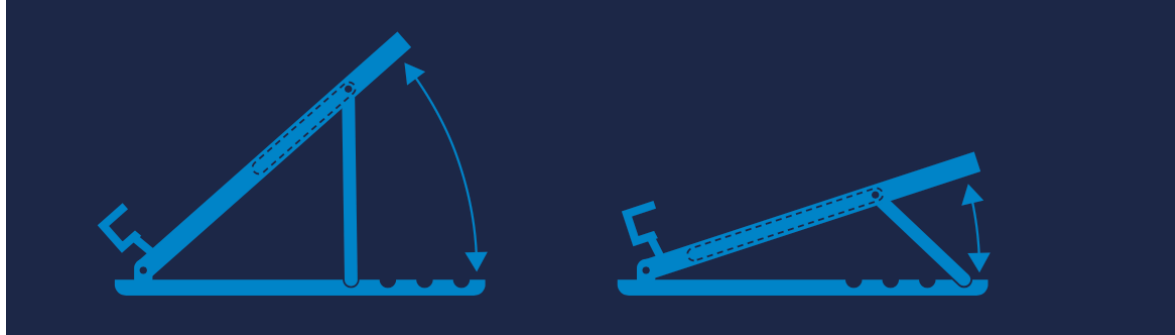

Prop **Stream Deck** on the included stand and adjust the legs for optimum access.

Step 8 - Use Social Media Accounts

8

Enter your social media accounts to connect with your fans.

Ajoutez vos comptes de réseau social pour échanger avec vos fans.

