

We are so glad that you are happy with our products  
We strive to provide better products and services



Share your experiences with your family and friends



Share your experiences for help



Share your photo on Instagram **#kisstysmart**

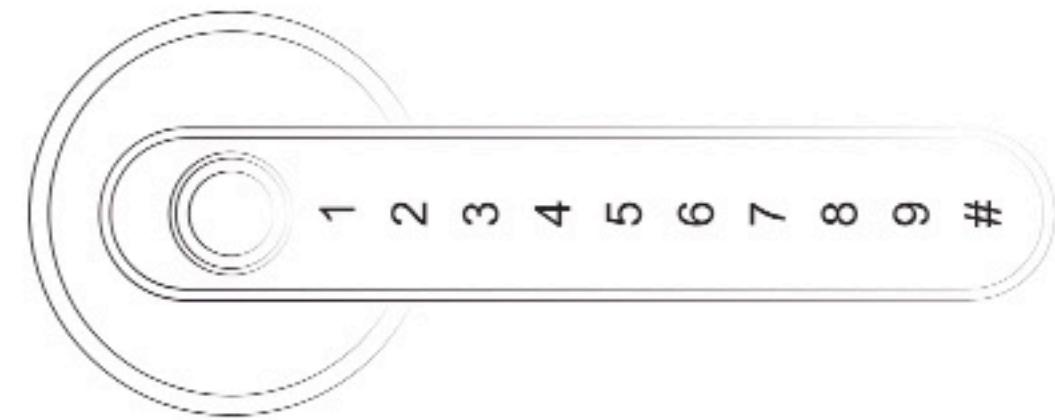

Installation video: Search **kisstysmart** at Youtube or Instagram

Email for service: [kissty2021@126.com](mailto:kissty2021@126.com)



# CATALOGUE

<b>1. Check Foundation Accessories</b> .....	02
<b>2. Installation Step Diagram</b> .....	03
<b>3. TT-Lock User Manual</b> .....	09
Download and register .....	09
Registration and login by APP .....	10
Add lock by APP .....	11
Send key by APP .....	12
Passager mode .....	13
Restore factory settings (not networked) .....	13

## 1. Check Foundation Accessories

After unpacking the product, check whether the following accessories are complete.

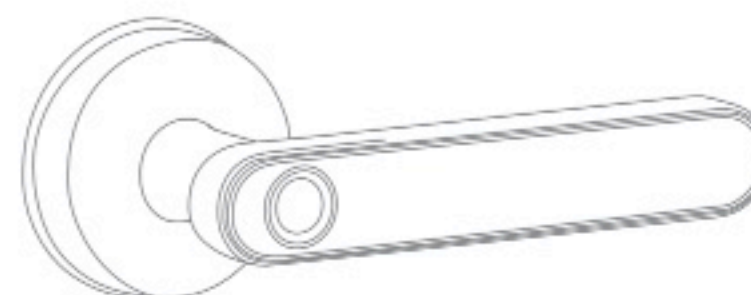

Front handle x1



Key X2

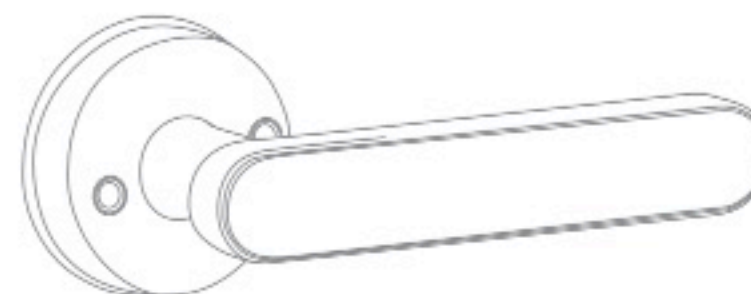

Rear handle x1



Lock screw X2



BatteriesX4  
(Not included)

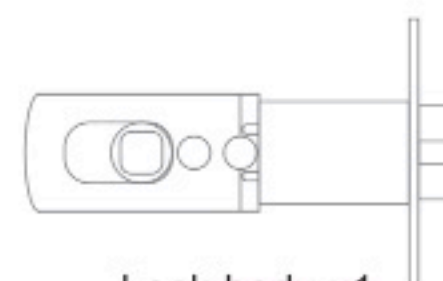

Lock body x1



Long screw X2



Stud X2

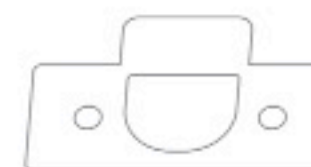

Latch piece x1



Hexagon wrench X1



Pin X1



Latch cover X1



Hollow square steel X1

## 2. Installation Step Diagram

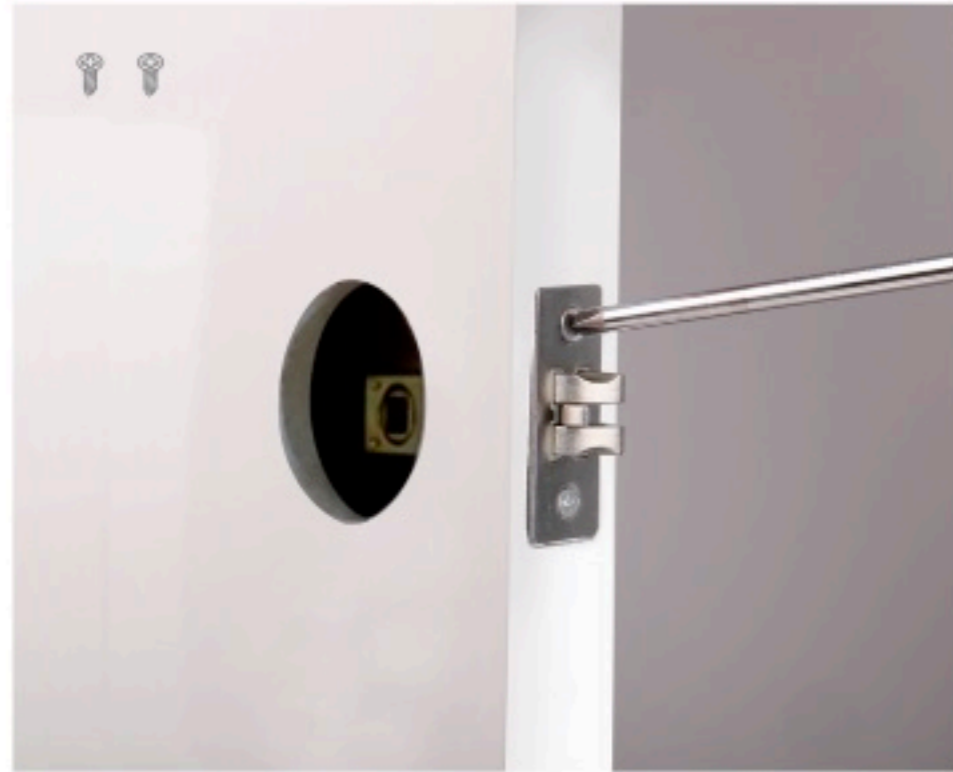

### 1. Install the lock body

Put the lock body into the corresponding slot and fix the upper and lower screws.



### 2. Install front handle

Secure the two nut posts to the front handle.



Put the power cord on the front handle through the square steel bar.



Note: square steel is put to the bottom



The square steel passes through the square steel hole of the lock body, Secure the handle.

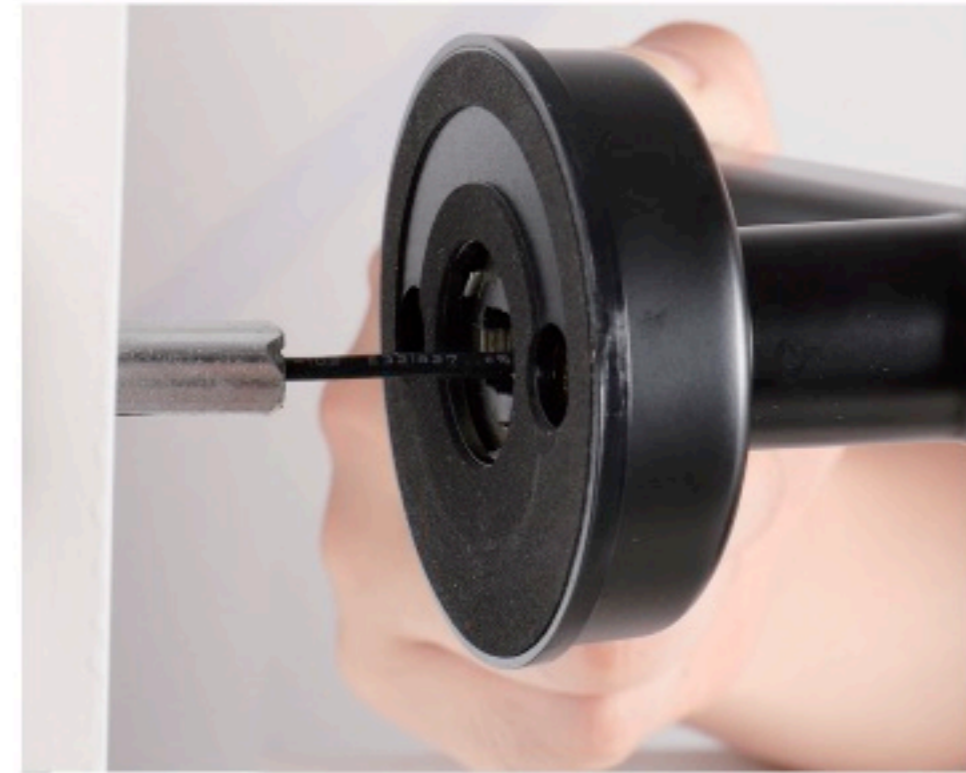

Put one end of the power cord through the center hole of the rear handle.



### 3. Install the rear handle

Loosen the screws of the rear cover plate with a hexagon wrench and remove the rear cover plate.



Align the square steel bar, tighten it with long screws, and fix the rear handle.



#### 4. Install the battery

Plug in the power cord and install the battery.



**Note:** when connecting the power line, the red mark on the terminal block is inserted in the same direction as the port red mark.

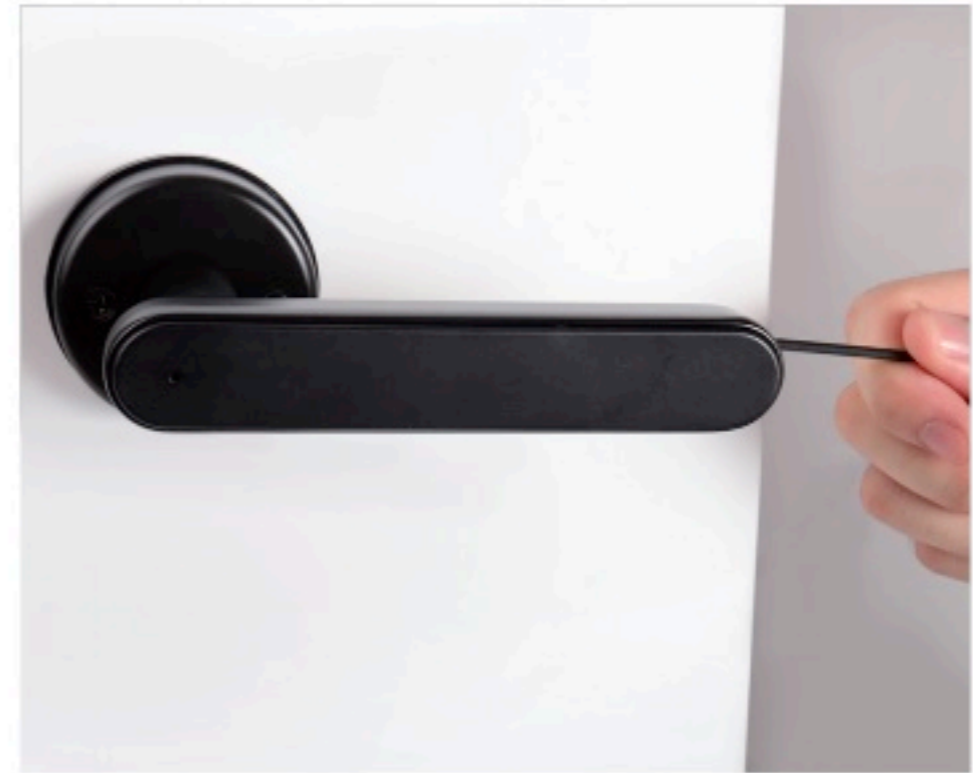

Fasten the rear cover plate and fix the screws of the rear cover plate.





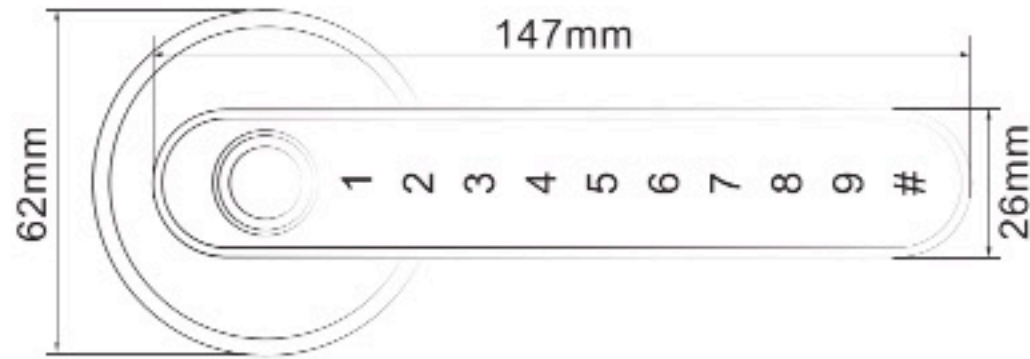

#### 5. Complete and test

After installation, check the door opening

# TT LOCK USER MANUAL

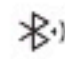

-  Fingerprint open the door
-  Password open the door
-  APP open the door
-  Key to open the door

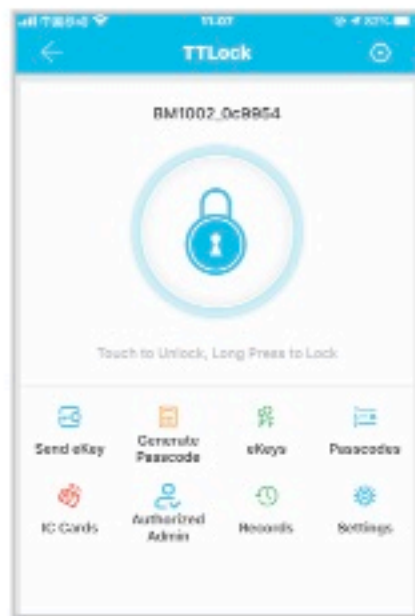
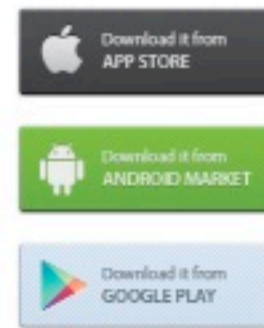

APP Store



Google Play

The software (iOS version) can be downloaded from the APP store, and the Android version can be downloaded from the application store of Google play.

## Registration And Login By APP

1. User can use phone number or email for registration which supported 159 countries.
2. Verification code will send to phone or email.
3. When the registration is successful, it will jump to home page.

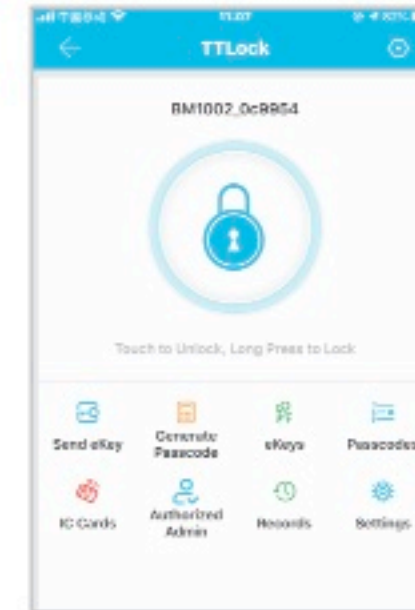

Key Binding



No Key Binding

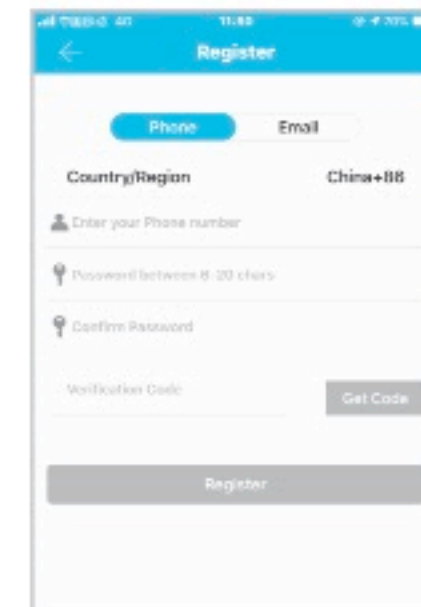
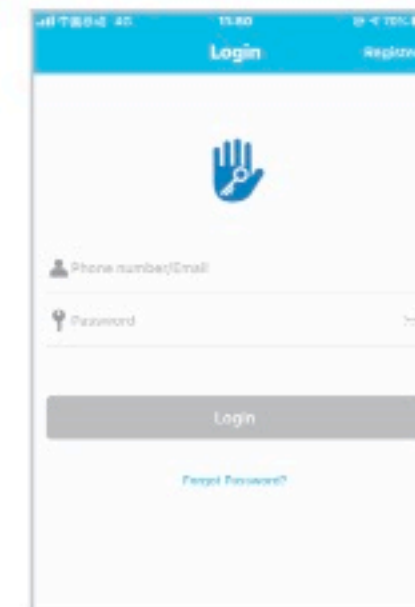

## Add Lock By APP

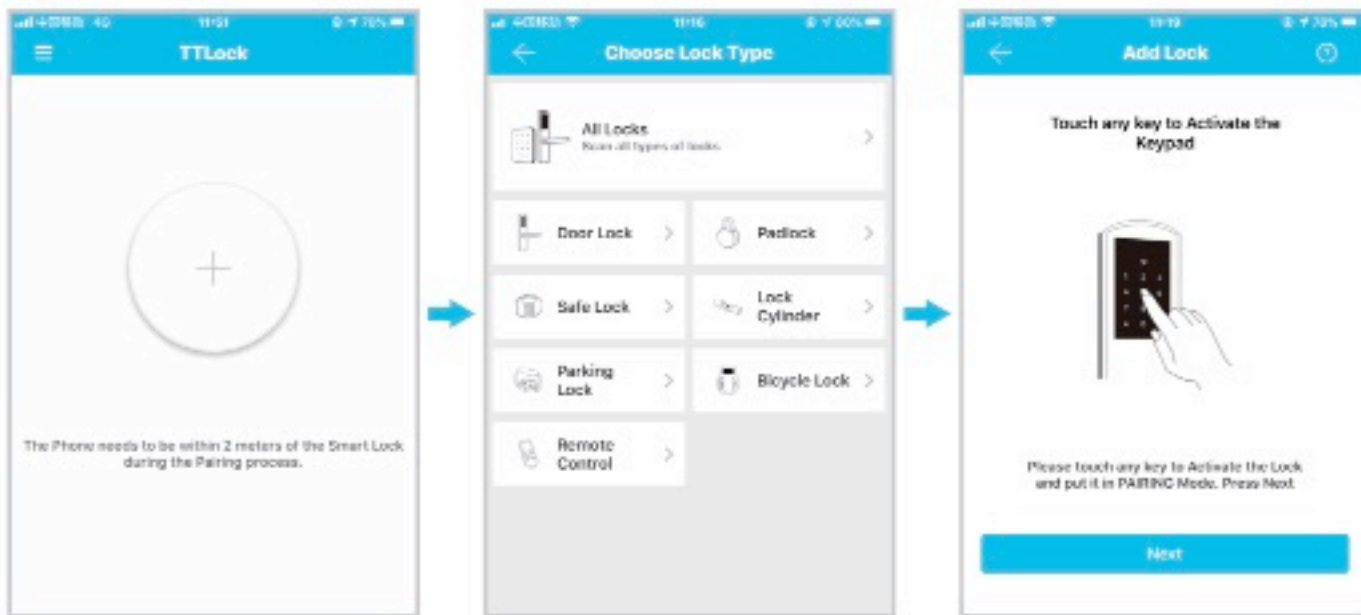

Add a Lock

Select "Door Lock"

Light Up Keypad

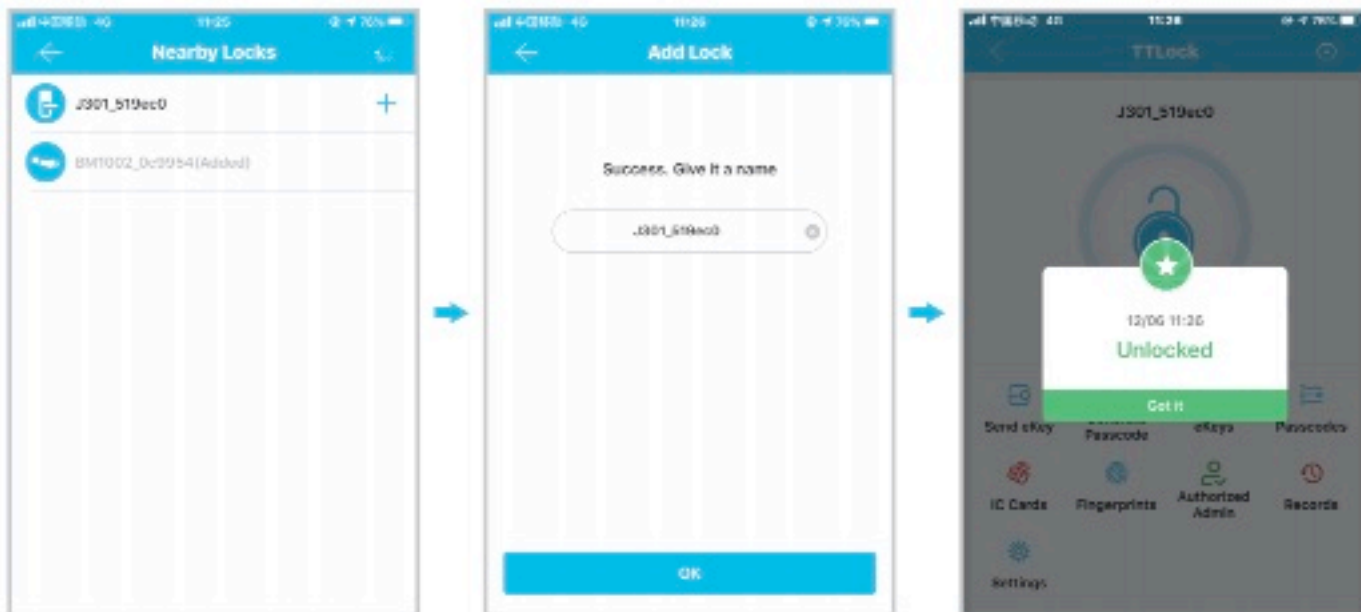

Select Lock

Enter Name

Completed

## Send Key BY APP

The user can send the bluetooth key to others with time, permanent, one-time or recurring key. The administrators can manage all the keys they send out, including clearing keys, resetting keys, sending keys adjusting the time limit of the keys, and viewing the access records.

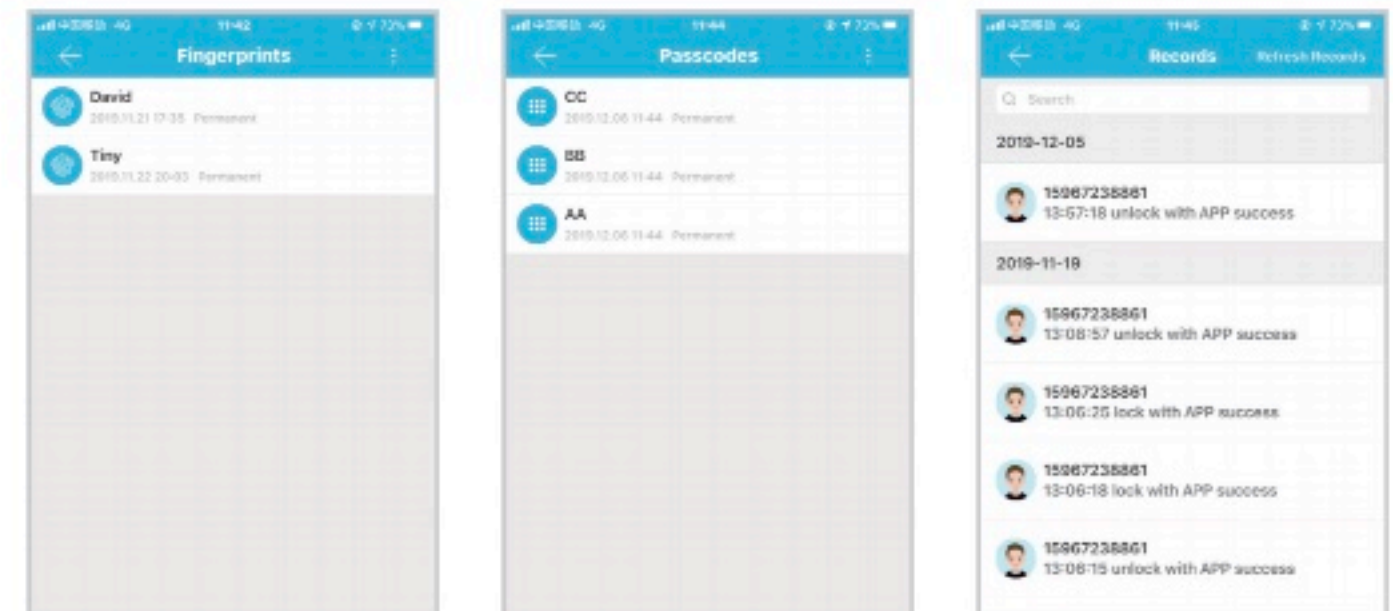
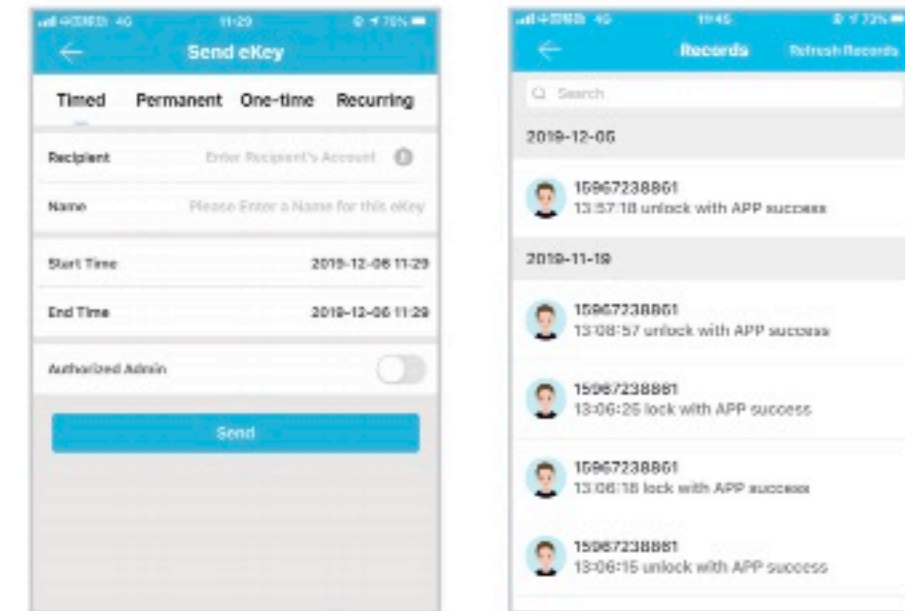

Fingerprints  
Adding

Passcodes  
/Passwords Adding

Records

## Passage Mode

1. Passage mode can be set by days, start time or end time. After the passage mode is activated, everyone can directly unlock the door without any access permission. The passage mode can be turned off by clicking again.

2. Open the lock by fingerprint (this fingerprint must input at lock), press the digit #123#, then the passage mode is on, freely to in and out. How to off this passage mode, just scan the fingerprint again, then it will be locked.

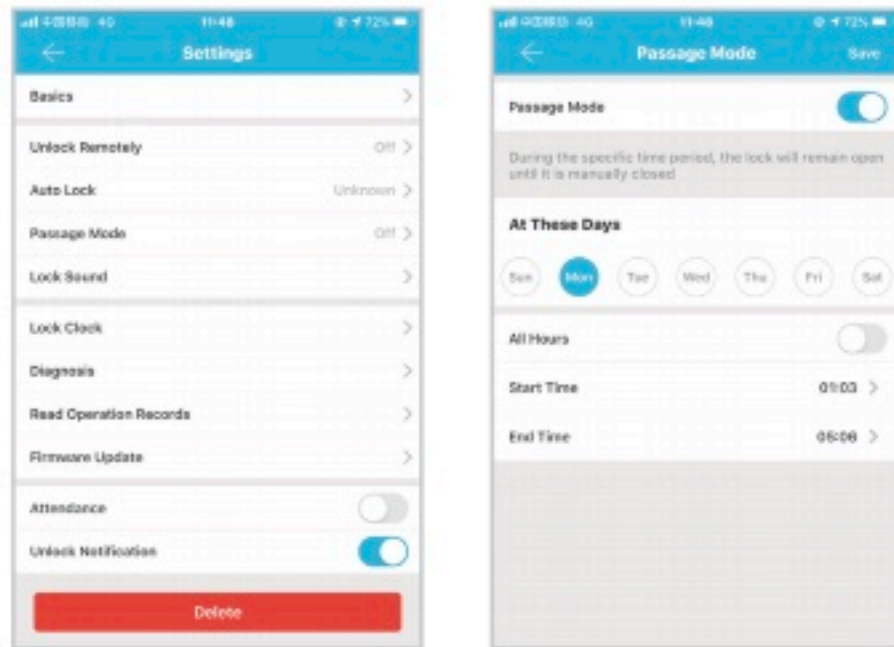

## Restore Factory Settings

1. Long press the back panel setup button for 5 seconds to restore the factory settings

2. Delete the device at TT lock app, after click the delete, it need fill your register password and also press # at the panel of lock, then app will show deleted successfully

