

User Guidelines for installing semi-automatic washing machine

- 1) Congratulations on the purchase of your AmazonBasics washing machine.
- 2) This washing machine comes with 3 items that are provided inside the washing machine
 - User Manual
 - Inlet pipe
 - Spinner adapter
- 3) Once you have removed the outer packaging, place the washing machine on a solid and level floor.
- 4) Be careful that an uneven or rough floor may cause abnormal noise or trembling sound during wash cycle. Hence install the washing machine on an even and flat surface.
- 5) Place the machine at least 15cm away from the wall.

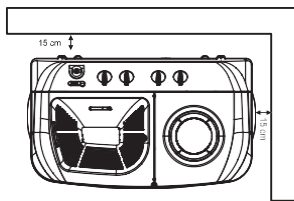

- 6) Install the Washing Machine in well ventilated area. Machine and power cable should be covered from top to avoid rain, sunlight or water on machine.

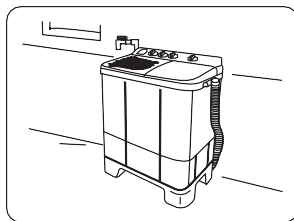

- 7) Insert the Power plug firmly into the main power supply

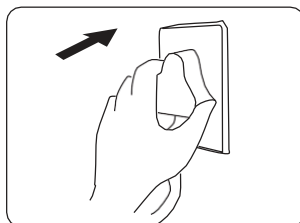

- 8) Connect the water supply hose to Tap and Inlet pipe in washing machine panel. Fill water into the washing machine

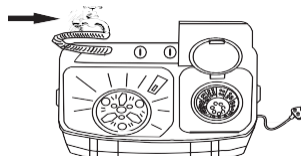

9) Add detergent and clothes into the washing machine. Each clothe should be added one by one in the washing machine so that clothes are not entangled and machine vibrations are low.

10) Positioning the Drain Hose

- Always lay down the drain hose flat on ground during usage of the washing machine.
- The length of the drain hose should not exceed 3m.
- Check for any blockage or obstacles in the path of the drain hose.

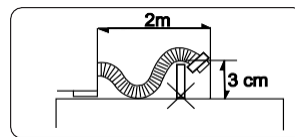
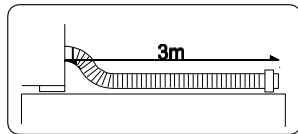

- After use, drain the water, clean the washing machine, pull out the power plug from power supply and hang the drain hose to washing machine

IDENTIFICATION OF PARTS

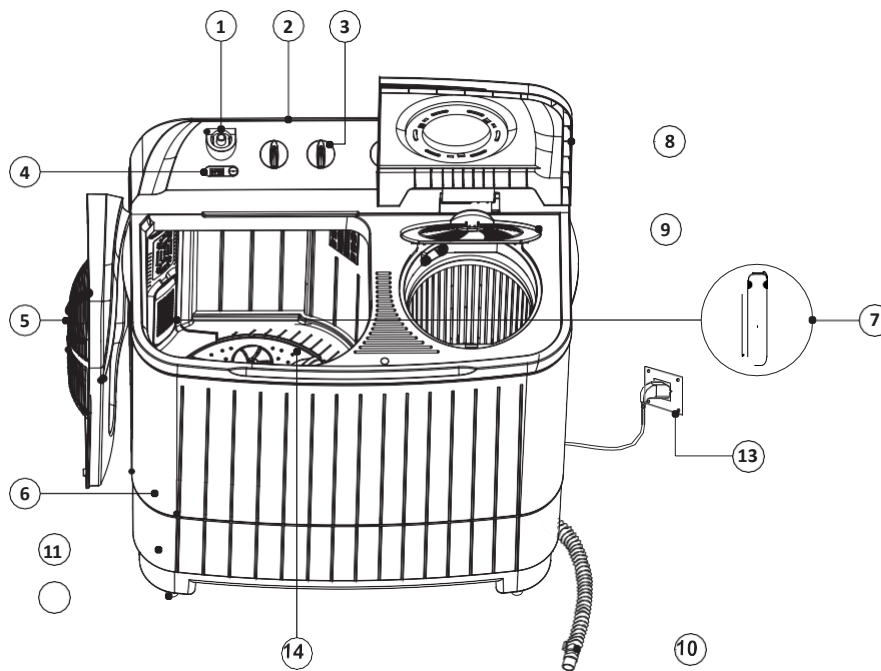

1	Water Inlet	8	Spin Lid
2	Control Panel	9	Mid Cover
3	Knobs	10	Drain Pipe
4	Water Selector	11	Base
5	Basket Wash Lid	12	Castor Wheels
6	Tub	13	Power Cord
7	Lint Filter	14	Pulsator

Note: Graphics and Images shown in manual may differ than actual product, it is for reference only.

CONTROL PANEL INFORMATION

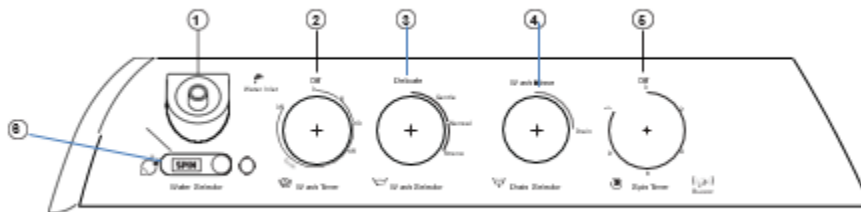

1. WATER INLET

- This is used to fill water in the washing machine.

2. WASH TIMER

- This is used to set Wash Timer for washing clothes. Put Clothes in wash tub with water and detergent.
- Select timer for time period required from 0-35 minutes (may vary from model to model)
- For the first 20 minutes Soak / Rinse will work after that clothes will be washed for 15 minutes. (may vary from model to model)
- A buzzer sound shall indicate the end of wash period.

3. WASH SELECTOR

- Select Wash option from given programs (Gentle / Normal / Strong) (number of wash programs may vary from model to model)

4. DRAIN SELECTOR

- This is used to select between Wash/Rinse or drain function.

5. SPIN TIMER

- This is used to set Spin timer for 0-5 minutes.

- After washing, load clothes into spin tub to spin.

6. WATER SELECTOR

- This is used to direct water supply into Wash Tub or Spin Tub

Note: 1. Do not keep Water Selector in mid position. This may damage electrical parts.

2. Do not rotate the knobs more than prescribed limits.

Laundry loading in the Spin tub

1. Fill half of the spin tub with clothes and press gently
2. Put the remaining clothes and press again
3. Place the cap of Spin Tub horizontally on the laundry and close the Spin Lid
4. If there is sound from the spinner, open the Spin Lid and re-arrange the laundry.

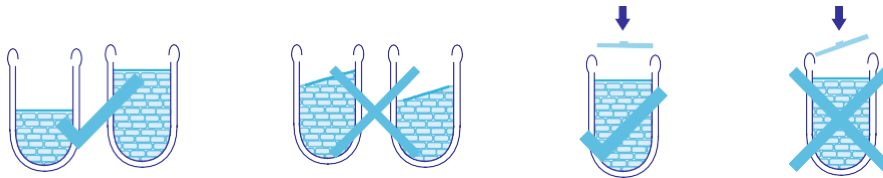

CARE AND MAINTENANCE

A) Cleaning Lint FILTER

1. Push the upper part of the Lint filter and pull in.

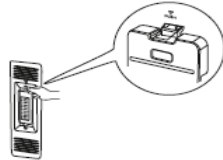

2. Open the cover as shown in figure

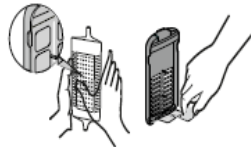

3. Clean the Lint Filter



4. Close the cover and insert the lower part of the filter in the basket first and push the filter from upper part with “click” sound.

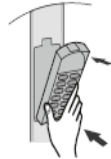

B) Cleaning the WASH TUB

- Wipe off stains on the cabinet and operation panel with soft cloth.
- Do not use benzene, thinners, cleanser, or wax, nor scrub the washing machine with a brush. Painted surfaces or plastic parts will be damaged.
- When cleaning don't spray water directly to the parts of the washer. It may make its life span shorter and also cause electric shock or fire.