



Digital AV Adapter

Manual

en.yehua.cn

I. Product Connection Diagram

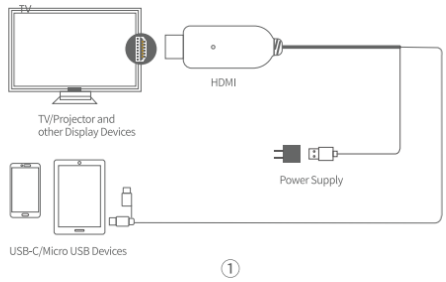

1. Please insert the HD interface of the Digital AV Adapter into the HD interface of TV, projector or monitor, as shown in figure ①.
2. Please connect the A-type USB plug of Digital AV Adapter to the external adapter of 5V/1A to supply power the product, as shown in Figure ①.
3. Please connect the USB-C/Micro USB connector of Digital AV Adapter to Android device, as shown in figure ①.
4. Please adjust the TV or projector, etc. to the HD output port for inserting the device (usually it can be selected by pressing "video source/source" button on the remote control), and you will see the display on the screen, as shown in Figure ②.

1



②

II. Operation Method

Before operating this step, please confirm that the Digital AV Adapter has been successfully connected to the HD interface and has connected the power supply to the device.

1. Insert the USB-C/Micro USB of the device into the mobile phone, and after connection, the screen of the mobile phone is as shown in Figure ③. You will be prompted that this USB accessory application has not been installed. Click View, and it will automatically jump to the download interface. Click download MiraPlug software, and select "Allow installation"(If you accidentally click Cancel, please disconnect and reconnect the cell phone).

2



③

2. After the download is successful, open the MiraPlug software, as shown in Figure ④. You will be prompted whether to open the MiraPlug or not when connecting to this Digital AV Adapter. Click "OK" and "start screen projection immediately".
3. If there is no prompt to open MiraPlug when connecting to Digital AV Adapter after opening MiraPlug software, you can slide down the cell phone screen and touch to change the setting of Digital AV Adapter as shown in Figure ④. Check "Auto default" to open MiraPlug software when connecting to this device, and you can connect it directly next time.
4. Please click the Bluetooth icon in the software center to connect Bluetooth to SSID of the device, so as to ensure that the sound can be synchronously transmitted to the TV when the cell phone is playing.

3

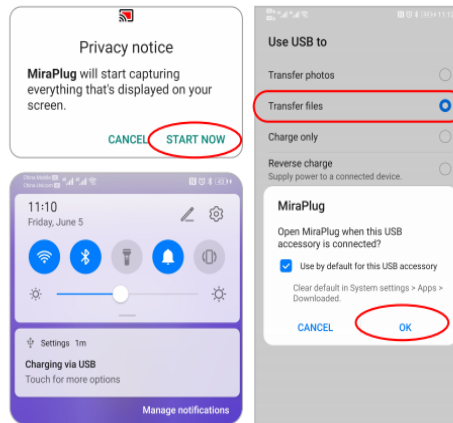

④

III. Firmware Upgrade

1. The firmware upgrade window will pop up automatically after the successful screen projection of the mobile phone. Click to upgrade the latest version, as shown in Figure ⑤.
2. Open MiraPlug software to view the latest version information and update it in the setting function.

4

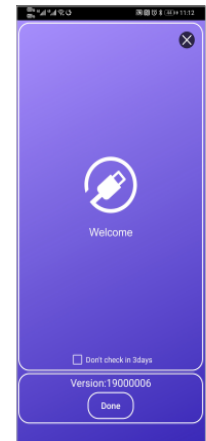

⑤

IV. Troubleshooting

1. When the TV interface does not display, make sure that the device has been powered.
2. If the cell phone cannot be on the same screen, please unplug and plug the device again, restart the cell phone, and uninstall the miraplug software then reinstall it.
3. If the played sound is not transmitted to the TV synchronously. Please open the miraplug software, click the Bluetooth icon in the middle of the screen, and connect the Bluetooth to the SSID of the device.

5

Distributor: Shenzhen Shafan Technology co.,Ltd
 Brand Owner: Shenzhen Qixing Longyuan Technology co.,Ltd
 Address: RM. 808, No. 1 Binhai Bay, RD. Yanxing, Dist. Bao'an,
 Shenzhen City, Guangdong Province, China

support@lemorele.com

4.0002.0049