

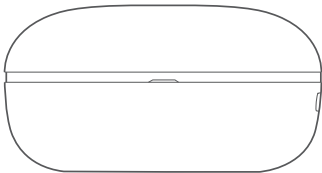

QCY Melobuds ANC

True Wireless Earbuds

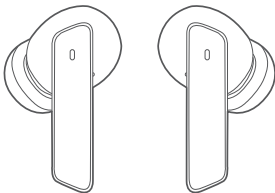

Overview

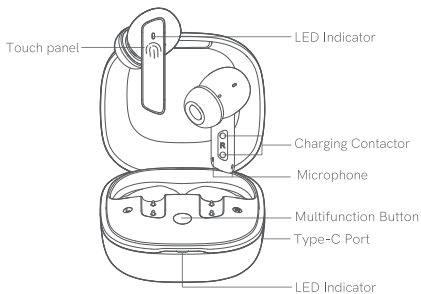

Charging Case



USB Cable



Earbud

Wearing

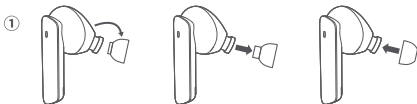

②



1. Choose the EarTips that fit your ears best.
2. Ensure sounds hole downward, then place earbuds into ear. Rotate earbud back to the auricle side to fit snugly.



- * Your earbuds come with multiple pairs of EarTips, among which Medium-sized are pre-installed.

Pairing

First Time Connection

1. Activate the earphones by removing them from the case and placing them back.
2. Open the charging case, remove the earphone from the charging case again, and the earbuds will turn on automatically. Select "QCY Melobuds ANC" on your device's Bluetooth list to connect.

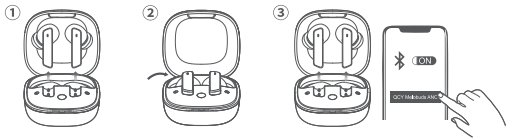

Pairing with another device

1. Place the earbuds in the charging case and leave the case open. Press and hold the button on the case for 3 seconds until the earbud LED indicators flash white to enter the pairing mode.
2. Take the earbuds out of the charging case. Select "QCY Melobuds ANC" on your device's Bluetooth list to connect.

* Multi-connection is not supported.

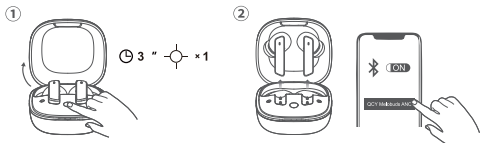

* Each time you power on your QCY earphones, it will automatically connect to your last successfully connected device if available within the Bluetooth range.

Resetting

You might need to reset the earbuds if you experience any connectivity problems or function issues.

1. Place both earbuds into the charging case and keep the charging case open.
2. Press and hold the button on the case for 10 seconds until the LED indicators on both earbuds flash white rapidly for 5 times, then earbuds have been reset successfully.

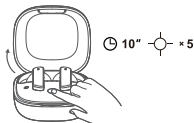

Power on/off

Open the charging case, the earbuds will automatically power on.

* The LED indicator on earbuds will light up white for 2 seconds.

Place the earbuds back into the charging case. Close the case and the earbuds will automatically power off.

Power on



Power off



Controls

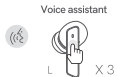

(X 2:Tap twice

X 3:Tap Triple

⌚ 1.5" Press and hold 1.5 second)

Charging



1.Remove the protective film before charging for the first-time use.

2.Fully dry off the earbuds and the USB port before charging.



3. Use a certified USB-C charging cable and charger to avoid damage to the device.

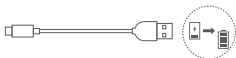

first-time use

⚠ The earphones must be fully charged before first use.
If the earbuds are left unused for over two weeks, please recharge.

LED behaviour

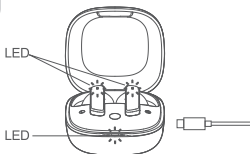

LED indicators (Earbuds)

	Charging	Steady red light
	Fully Charged	Steady white for 30 seconds

LED indicators (Charging Case)

	Charging	Steady red light
	Fully Charged	Steady white light

The LED indicators on the charging case indicate the charging status.

To check the battery level of the charging case, press the button on the charging case

	Battery power \geq 20%	Steady white for 5 seconds
	Battery power $<$ 20%	Steady red for 5 seconds

Caveats

1. Never disassemble or modify your earbuds for any reasons to avoid any damages and danger.
2. Do not store the earbuds in extreme temperatures (under 0°C or over 45°C).
3. Avoid using the indicator close to the eyes of children or animals.
4. Do not use the earbuds during a thunderstorm to avoid dysfunction and increasing risk of electric shock.
5. Do not use harsh chemicals or strong detergents to clean the earbuds.
6. Keep the earphones dry.

Warranty

We warrant this device 12 MONTHS from date of the original purchase for manufacturer defects.

If the device fails due to a manufacturing defect, please contact seller directly to initiate return and warranty process.

The following are excluded from QCY warranty cover:

- Device purchased as second hand, used or from unauthorized seller.
- Damage resulted from misuse and abusive action.
- Damage resulted from chemical, fire, radioactive substance, poison, liquid.
- Damage resulted from natural disaster.
- Damage caused to any third party / person / object and beyond.

Statement

We can only provide after sale service for products purchased directly from QCY or QCY authorized distributor. If you have purchased from a different seller, please contact them for any exchange or refund request.

Thank you for purchasing the QCY authentic product.

For any assistance, please contact us freely.

✉ tech@qcy.com / hello@qcy.com

🌐 www.qcy.com

