

Functional Check List – FUZE Pint



Power on / Power off

1. Turn on the bluetooth speaker



2. Turn off the bluetooth speaker



EQ switching

This speaker comes with dual EQ to cater to various personal preference, to switch EQ, press the power button three times in the state of music playing.



Functional Check List – FUZE Pint

Bluetooth connection

1. The speaker will automatically enter into pairing mode when power on and wait for the device to connect.

2. Connect to bluetooth device



Voice assistant

Bluetooth mode, double press the "  " button on the speaker to activate Siri or Google Now on your phone. Please make sure the Siri or Google Now is enabled on your phone.

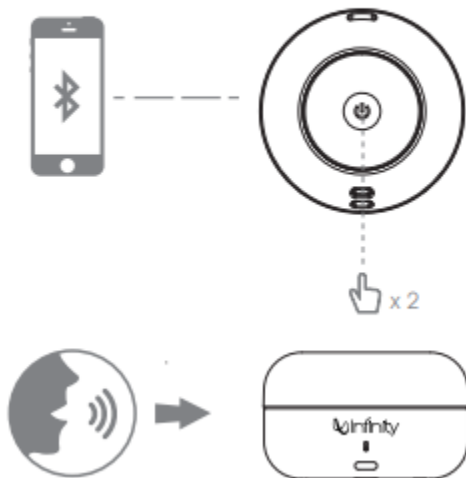

Functional Check List – FUZE Pint

Sr No.	Defect / Symptom Reported by Customer	Checkpoints
1	How to Do Reset?	In the power off state, press the power button for 5 Sec to restore the factory settings.
2	Dead Conditions - No Power, No audio	<ol style="list-style-type: none"> 1. Plug the speaker on charge with the cable given with product. 2. If battery is charging then LED indicator will blink and shows speaker charging. 3. Else input PCB/Product is defective.
3	Low Sound / Noise cracking	<ol style="list-style-type: none"> 1. Check speaker fully charged before using. 2 On low charging speaker will not perform 100% and result of low sound.
4	BT not connecting	<ol style="list-style-type: none"> 1. While pairing with BT feature ensure your handset BT setting correct and into bT always into discover mode. 2. Also check the BT paired list of your handset not be full fill. Delete last paired devices and try to pair once again with speaker.
5	Charging issue	<ol style="list-style-type: none"> 1. Plug the speaker on charging, with the cable coming along product. 2. If LED not blink, change the another cable as per compatible with your speaker - Type C or Android phone charging cable. 3. Still speaker not charging then input connector has been faulty