

earfun

# EarFun Free Mini

True Wireless Earbuds

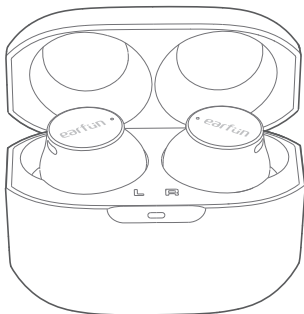

User Manual

## 1 What's in the Box

EarFun Free Mini



Charging Case



Ear Tips (S, M, L)



USB-C Cable

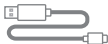

User Manual



## 2 Product Diagram

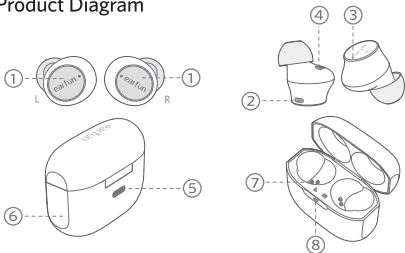

- ① Touch button control zone
- ② Microphone
- ③ Earbuds LED indicator
- ④ Charging contactor
- ⑤ USB-C charging port
- ⑥ Charging case
- ⑦ Charging dock
- ⑧ Charging case indicator

## 3 Charging

1. Place earbuds back into the charging case to activate the case battery level LED indicator.
2. Place earbuds back into the charging case and the earbuds will start charging.
3. Fully charge both the earbuds and the charging case before the first-time usage.
4. Fully dry off the earbuds and the USB port before charging.

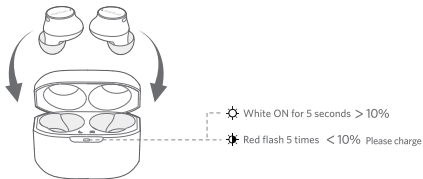

Connect USB-C cable for charging

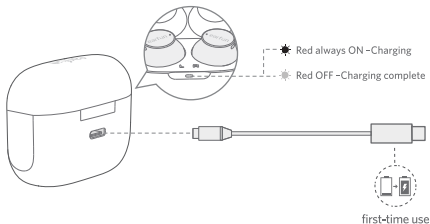

## 4 Specifications

Bluetooth version	V5.0
Bluetooth frequency	2.402GHz-2.48GHz
Bluetooth transmitted power	<7dBm
Bluetooth profile	A2DP, AVRCP, HFP, HSP
Maximum working range	15m(without obstacle)
Battery capacity	40mAh x 2(earbuds); 470mA(charging case)
Charging time	1.5 hour(for earbuds); 2.5 hours(for charging case via USB-C);
Playtime:	Up to 5 hours, Totally 24 hours with the charging case; (varies by volume level and audio content)
Input	DC 5V / 1A
Dimensions	55mm x 26mm x 43mm
Weight	38g

## 5 How to Fit

**Note:** If the earbuds are not worn correctly, they may affect the bass effect.

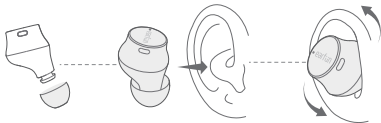

1. Choose the ear tips that fit your ears the best.
2. Identify the left and right earbuds.
3. Insert the earbuds into the canal of your ears.
4. Turn and find the most comfortable position.

## 6 Pairing Your Earbuds

### 1. First-time Pairing with Device

Step 1: Remove both earbuds from the charging case simultaneously and the earbuds will automatically power on and enter into pairing mode.

Step 2: Activate Bluetooth on your Bluetooth-enabled device and search for other Bluetooth devices.

Step 3: Select "EarFun Free Mini" from the list of Bluetooth devices shown (if a password is needed, type '0000').

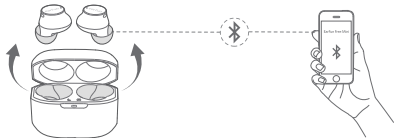

#### Notes:

- The earbuds will automatically connect with the device they were last paired with when the case is open.
- Each earbud could be used independently.

### 2. Connect to a New Device

Step 1. Unpair the earbuds from the Bluetooth-enabled device that's connected. The earbuds will disconnect from the current device and enter into pairing mode for another pair.

Step 2. Search on the new device and connect.

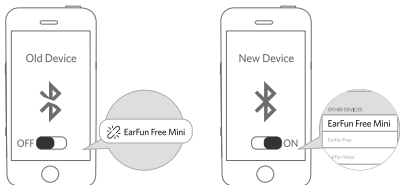

## 7 Functions

### Power on/off

Open the charging case and pick up the earbuds, the earbuds will automatically power on. Place the earbuds back into the charging case, the earbuds will automatically power off.

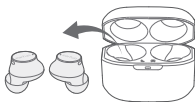

Power on

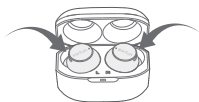

Power off

### Note:

If the earbuds are not connected to any device, they will automatically power off after 5 minutes for saving the battery life.

### Playing music



Play/Pause



Next track



Previous track



Volume up



Volume down



### Hands free conversation



Answer/End a call



Reject a call



Transfer two calls

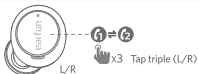

### Activate the voice assistant



Voice assistant

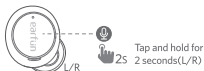

## 8 Earbuds LED Indicator

Power on	Blue indicator flashes 1 second
Power off	Red indicator flashes 1 second
Pairing mode	Indicator flashes blue
Successfully connected	Indicator goes out
Charging	Red always ON
Factory reset	Indicator flashes purple (blue + red)

## 9 Reset and Manually Pairing

### Reset Bluetooth Connection

If you fail to build connection between earbuds and Bluetooth device, please try the following steps:

1. Keep the earbuds out of the charging case, touch and hold the earbuds button for at least 10 seconds to turn off both earbuds and make sure the both earbuds power off.
2. In power-off mode, touch and hold the button on each earbud at the same time for at least 10 seconds until they flash purple 3 times then earbuds have been reset successfully.
3. Delete the old connection from the Bluetooth device and reconnect "EarFun Free Mini".

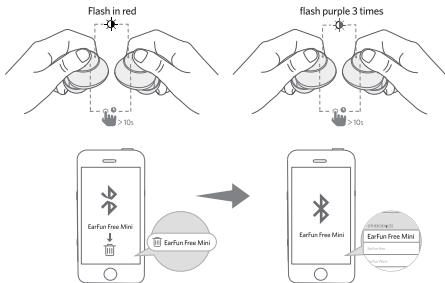



## Left and Right Manually Pairing

If the left or right earbud is disconnected alone, you may need to manually pair them again.

1. Ensure both earbuds are powered on and not connected to any devices, you can see the indicator flash blue quickly when you take them out.
2. Tap the touch button twice on both earbuds, then they will enter to the pairing mode which the indicator flash in blue slowly. Once paired, one of the earbuds' indicator will flash blue quickly while the other will be off.

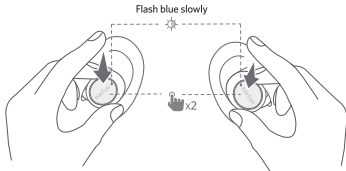

## 10 Troubleshooting

Q: Can I use both earphones separately?

A: Yes, each earbud could be used independently.

Q: The earphones are turning on, but it doesn't connect to my device?

A: To connect the earbuds to your device, please check if the Bluetooth of the device is on at first, then select 'EarFun Free Mini' on the Bluetooth list to get paired. If the earbuds still can't connect to your device, please try to reset it, or contact our customer support.

Q: Why the connection is not stable and cuts out intermittently?

A: Please make sure there are no objects between the earphones and your Bluetooth device, and make sure there is no radio or WIFI interference nearby.

Q: What is the range of Bluetooth earphones?

A: Bluetooth earphones have maximum range of 49 feet (15m, no obstacle). However, the actual range will depend on usage and environment.

Q: Is there volume control on the earphones?

A: Yes, touch L earbud once decreases the volume and touch R once could increase it.

Q: Is the charging case waterproof?

A: No, the earbuds are IPX7 sweat & waterproof, but the charging case is not waterproof.

Q: My earphones will not switch on.

A: Please recharge it and make sure it has enough battery power. If it is fully charged and still nothing happens or if you are not able to charge the unit, please contact our customer support for warranty cover.

Q: Will the earbuds shut off automatically?

A: The earbuds will remain on as long as they are connected to a device. If no audio is in use, they will enter power-saving mode and wake up once audio is played. If the earbuds are not connected with any devices, they will automatically shut off in 5 minutes.

## Customer Service

For FAQs and more information

Please Email to: [service@myearfun.com](mailto:service@myearfun.com)

[www.myearfun.com](http://www.myearfun.com)

## FCC Statement

Changes or modifications not expressly approved by the party responsible for compliance could void the user's authority to operate the equipment.

This equipment has been tested and found to comply with the limits for a Class B digital device, pursuant to Part 15 of the FCC Rules. These limits are designed to provide reasonable protection against harmful interference in a residential installation. This equipment generates uses and can radiate radio frequency energy and, if not installed and used in accordance with the instructions, may cause harmful interference to radio communications. However, there is no guarantee that interference will not occur in a particular installation. If this equipment does cause harmful interference to radio or television reception, which can be determined by turning the equipment off and on, the user is encouraged to try to correct the interference by one or more of the following measures:

- Reorient or relocate the receiving antenna.
- Increase the separation between the equipment and receiver.
- Connect the equipment into an outlet on a circuit different from that to which the receiver is connected.
- Consult the dealer or an experienced radio/TV technician for help.

This device complies with part 15 of the FCC rules. Operation is subject to the following two conditions:

- (1) This device may not cause harmful interference.
- (2) This device must accept any interference received, including interference that may cause undesired operation.

## RF Exposure Compliance

This equipment complies with FCC radiation exposure limits set forth for an uncontrolled environment. This transmitter must not be co-located or operating in conjunction with any other antenna or transmitter.

## CAUTION

Risk of explosion if the battery is replaced by an incorrect type

Disposal of a battery into fire or a hot even, or mechanically crushing or cutting of a battery, that can result in an explosion; Leaving a battery in an extremely high temperature surrounding environment that can result in an explosion or the leakage of flammable liquid or gas; A battery subjected to extremely low air pressure that may result in an explosion or the leakage of flammable liquid or gas.



To prevent possible hearing damage, do not listen at high volume levels for long periods.



The Bluetooth® word mark and logos are registered trademarks owned by Bluetooth SIG, Inc. and any use of such marks by Earfun Technology(HK) Limited is under license.

Other trademarks and trade names are those of their respective owners.

## EU Declaration of Conformity

---

Earfun Technology (HK) Limited hereby declares that this equipment is in compliance with the essential requirements and other relevant provisions of Directive 2014/53/EU and RoHS 2011/65/EU Directive. The declaration of conformity may be consulted in the support section of our Web site, accessible from [www.myearfun.com](http://www.myearfun.com)

## UK Declaration of Conformity

---

Hereby, [Earfun Technology (HK) Limited] declares that the radio equipment type [TW102] is in compliance with UK Radio Equipment Regulations (SI 2017/1206). The full text of the declaration of conformity is available at the following internet address: [www.myearfun.com](http://www.myearfun.com)

## NCC聲明：

取得審驗證明之低功率射頻器材，非經核准，公司、商號或使用者均不得擅自變更頻率、加大功率或變更原設計之特性及功能。低功率射頻器材之使用不得影響飛航安全及干擾合法通信；經發現有干擾現象時，應立即停用，並改善至無干擾時方得繼續使用。前述合法通信，指依電信管理法規定作業之無線電通信。低功率射頻器材須忍受合法通信或工業、科學及醫療用電波輻射性電機設備之干擾。

型號/MODEL: TW102

FCC ID: 2AVIT-TW102L

FCC ID: 2AVIT-TW102R



UK  
CA



211-210814