



# LED OVAL DOUBLE RING FLUSHMOUNT

- ▶ **DESIGN** - LED OVAL DOUBLE RING FLUSHMOUNT has a modern, multipurpose design and a stylish look with efficient lighting. Durable housing resistant to rust and impact along with an acrylic lens provide many years of use. It is designed to operate on 120-277V circuits.
- ▶ **COLOR SELECTABLE** - You can choose either a 3,000K warm white, 4,000K cool white or 5,000K daylight color temperature.
- ▶ **DIMMING** - Smooth triac dimming capabilities ranging from 10% to 100% with modern LED dimmers allow you to control the look and feel of your space.
- ▶ **APPLICATION** - The LED OVAL DOUBLE RING FLUSHMOUNT provides bright, yet smooth lighting for your family room, bedroom, hallway, corridor, or any other common area in your living space. This fixture is also Damp Locations rated.
- ▶ **ADVANTAGES** - With a lifespan of 50,000 hours, these fixtures are made to last decades under normal operation! ASD provides a 5-year limited warranty along with ETL and Energy Star certifications to guarantee top quality products and safety!

Catalog number	
Notes	
Type	



Model	Size	Watts	Voltage	Dimmable	Lumens	CCT	Finish	Dimensions (LxWxH)
ASD-LFMOV-MV-32D45CC-NK	32 inch	45W	120-277 V	TRIAC	3,360/3,750/3,540 lm	3CCT (3,000/4,000/5,000 K)	Brushed nickel	32-7/16" x 18-1/8" x 4-13/16"
ASD-LFMOV-MV-32D45CC-BZ	32 inch	45W	120-277 V	TRIAC	3,360/3,750/3,540 lm	3CCT (3,000/4,000/5,000 K)	Oil rubbed bronze	32-7/16" x 18-1/8" x 4-13/16"
ASD-LFMOV-MV-32D45CC-BK	32 inch	45W	120-277 V	TRIAC	3,360/3,750/3,540 lm	3CCT (3,000/4,000/5,000 K)	Black	32-7/16" x 18-1/8" x 4-13/16"

## ORDERING INFORMATION

Model	UPC	Pcs. per carton	Carton size	Carton weight	GTIN 14
ASD-LFMOV-MV-32D45CC-NK	810050732055	2	35.2" x 11.8" x 21.5"	23.2 lbs	20810050732059
ASD-LFMOV-MV-32D45CC-BZ	810050732567	2	35.2" x 11.8" x 21.5"	23.2 lbs	10810050732564
ASD-LFMOV-MV-32D45CC-BK	810128111706	2	35.2" x 11.8" x 21.5"	23.2 lbs	10810128111703

For most up-to-date spec sheets please refer to [asd-lighting.com](http://asd-lighting.com)

ASD LIGHTING CORP

E-mail: [orders@asd-lighting.com](mailto:orders@asd-lighting.com) | Web site: [www.asd-lighting.com](http://www.asd-lighting.com)





# LED OVAL DOUBLE RING FLUSHMOUNT

## PRODUCT SPECIFICATIONS:

Construction & Materials		Electrical system	
Housing	Steel	Input voltage	120-277 V
Lens	Acrylic	Max input current	0.7 A
Finish	Brushed nickel, Oil rubbed bronze, Black	Inrush current (Action time)	0.36 A (0.1 S)
Weight	7.8 lbs (3.5 kg)	Off state power	0W
Environmental system		Power consumption	45W
Work environment	Suitable for Damp Locations	Power factor	> 0,9
Operating temperature	-4°F to 131°F (-20°C to 55°C)	Output voltage	0.36 V
L-70 life	> 50,000 hrs	Max output current	1 A
Optical system		Surge protection DM/CM	1.5 kV / 1.5 kV
Luminous flux	3,360/3,750/3,540 lm		
Color temperature	3CCT switch (3,000/4,000/5,000 K), 3,000 K by default		
CRI	> 80		
Dimming range			
10-100%			
Dimming compatible controls			
Brand	Lutron MACL-153MLH-WH STCL-153PH-WH PD-6WCL-WH-R	Leviton R02-DW6HD-2RW R00-RNL06-0TW R68-06674-P0T	DSL06
Regular and voluntary certifications			
5-year limited warranty	Energy Star listed	cETLus certified 4001256	

## PACKAGE CONTENTS:

Description	Q-ty
LED Oval Double Ring Flushmount	1
Mounting plate (A)	1
Template (B)	1
Screw (C)	4
Self-taping screw (D)	4
Wire nut (E)	3
Anchor (F)	4
Box	1

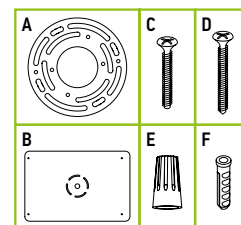

## INSTALLATION GUIDE

### IMPORTANT SAFETY INFORMATION:

Please read all the instructions below before installation.

- ▶ Make sure that the supply voltage corresponds to the rated product voltage.
- ▶ The product must be installed by a qualified electrician in accordance with the National Electrical Code and corresponding local codes.
- ▶ If the product is damaged, do not use it.

### ⚠ WARNING

**RISK OF PERSONAL INJURY – READ and follow all WARNINGS and installation instructions.** Keep or give to the owner for future reference.  
**Risk of cuts:** Wear gloves to prevent cuts or abrasions when removing from carton, handling, installing, and maintaining this product.  
**Risk of electric shock:** This product must be installed in accordance with the applicable installation code by a person familiar with the construction and operation of the product and the hazards involved.  
**Risk of Fire:** Minimum 194°F supply conductors. Consult a qualified electrician to ensure correct branch circuit conductor.  
 ASD® assumes no responsibility for claims arising out of improper or careless installation or handling of this product.

### ELECTRICAL SCHEMATIC DIAGRAM:

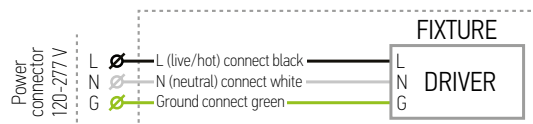

### INSTALLATION STEPS:

1. Unscrew cap nuts counter-clockwise and remove the metal ring and the lens.
2. Attach the mounting plate to the outlet box using two screws. Attach the template to the mounting plate and mark the location of the holes for the wall anchors. Remove the template and drill four appropriate sized holes for anchors, insert anchors into the holes, twist the four self-tapping screws into the anchors.
3. Connect the wires: Black to Black, White to White, Ground to Ground. Attach the back plate to the ceiling by feeding self-tapping screws through the keyhole slots and then tightening the self-tapping screws in the narrow end of the keyhole slots. Secure the fixture to the mounting plate using two screws.
4. Choose either 3,000K, 4,000K, or 5,000K with a simple switch. Secure the lens and metal ring to the fixture pan using cap nuts.

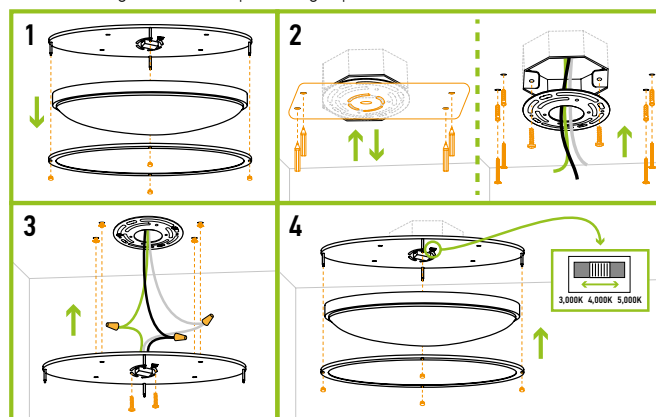

For most up-to-date spec sheets please refer to [asd-lighting.com](http://asd-lighting.com)