



# HAIFUAN

## D6300 Series User Manual

## Technical Parameters

Product Type	HFAD6300-R, HFAD6300-L , HFAD6300-FR, HFAD6300-F
Dimensions	6.1"*2.55"*4.92"(155*65*125MM)
Material	Zinc Alloy
Weight	4.4LBS (2KG)
Operating Voltage	DC6V , 4* 1.5V"AA"Alkaline Batteries
Static Current	≤20μA
Dynamic Current	≤200mA
Ways to open	Password, Mechanical key, M1 Card, Remote control, Fingerprint
User Capacity	Different for each model, check 3.1 for details
Backset	2 3/8"and 2 3/4" both available (60mm or70mm)
Door Thickness	1.2"-2.36"(30mm—60mm)

## Part 1: Product Structure Map

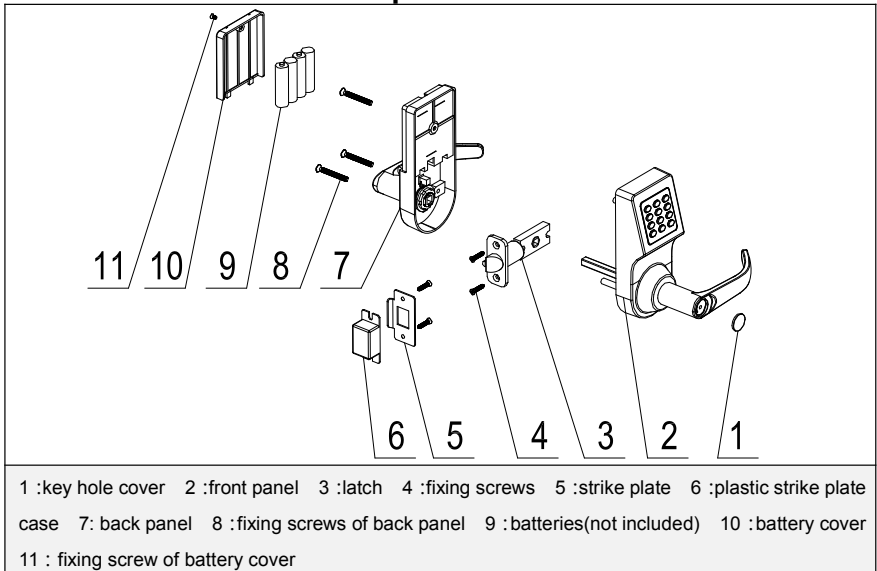

## Part 2: Installation Instructions

### 2.1 Drilling holes

- 1、 Drill holes according to the drilling template
- 2、 Drill holes on the door frame to install strike plate

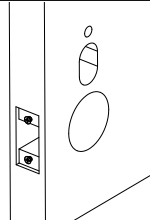

### 2.2 Install latch and strike plate

- 1、 Fix the lock on the door broadside with two screws
- 2、 Fix the plastic case and strike plate on the door frame with two screws

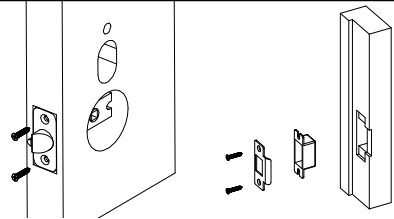

### 2.3 Install square shaft to front panel

- 1、 Put the square shaft into square hole(on the back of front panel)
- 2、 Fix the square shaft with the pin in fitting screw bag(make sure it won't move)

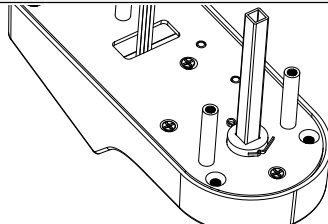

### 2.4 Install front panel

- 1、 Install front panel, pull the connect data line through the hole

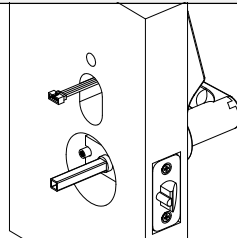

### 2.5 Install back panel

- 1、 Remove battery cover
- 2、 Connect data line of the front and back panel
- 3、 Fix the back panel with 3 fixing screws.
- 4、 Make adjustment if necessary, fasten the screws

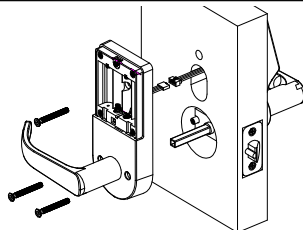

### 2.6 Install batteries

- 1、 Put 4 AA batteries into the battery case and pay attention to the directions.
- 2、 Close the battery case and fix it with screws.
- 3、 Installation finished.

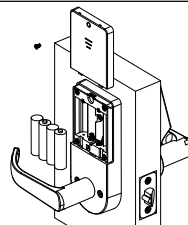

### 2.7 Test after installation

- 1、 The door can be opened when turn on the back plate handle.
- 2、 Input initial master code "123456" "#" on front panel to open it.

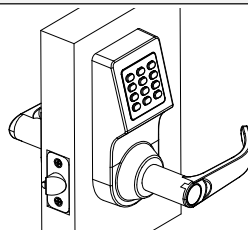

### 2.8 Usage of emergency mechanical key

- 1、 Remove key hole cover with plastic sucker or magnet
- 2、 Insert the mechanical key, turn 90 degrees.
- 3、 Turn on the handle, door opened.

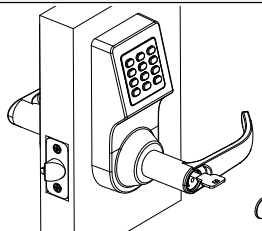

### 3 Operation Instruction

#### 3.1 Outline

**Admin:** code (fingerprint, card or remote control cannot be used as admin)

**User:** card, code(6-10digits), fingerprint(fingerprint version), remote control(remote control version)

**User Capacity:** HFAD6300-R, 1 admin code, 100 codes, 800 cards, 120 remote controls

HFAD6300-L, 1 admin code, 100 codes, 800 cards,

HFAD6300-FR, 1 admin code, 100 codes, 150 fingerprints, 120 remote controls

HFAD6300-F, 1 admin code, 100 codes, 150 fingerprints,

#### 3.2 System Initialization

Default admin code is "123456". You must change the default admin code to add user.

##### Initialization :

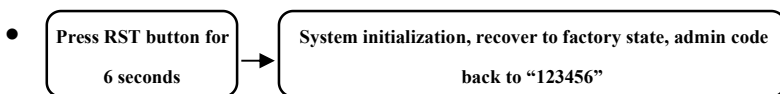

You can press "\*" "#", and then input the admin code to enter to system setting.

#### 3.3 Operations

Press "\*" "#" $\rightarrow$ "#"  $\rightarrow$  Admin Code  $\rightarrow$  "#" to enter the following menu

##### Set Admin Code



##### Set User Code:

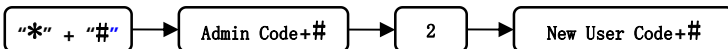

##### Set Card user:

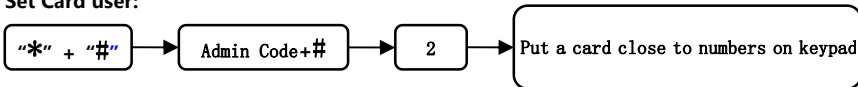

##### Set remote control(For remote control version):

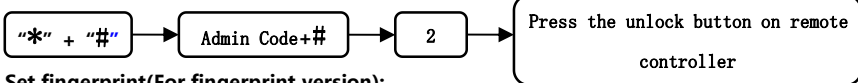

##### Set fingerprint(For fingerprint version):

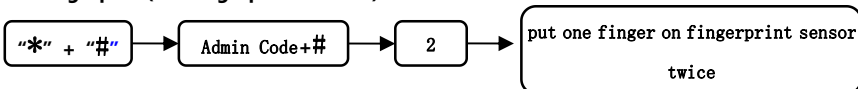

(Tips: you can add many users at the same time, for example, when you just added a code user, you can press the unlock button on remote control to add a remote user, or put a finger on fingerprint sensor to add a fingerprint, or input another code to add another code user )

Users can change their codes by their own

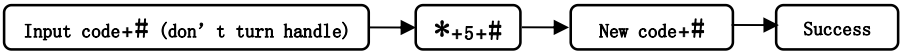

Delete Single user :

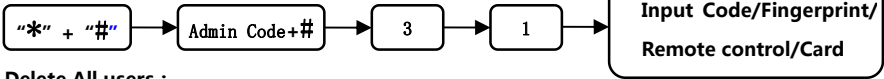

Delete All users :



Passage Mode setting

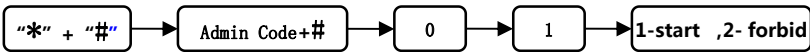

Verification Mode setting

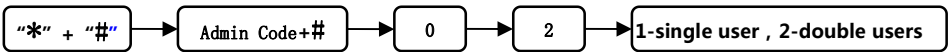

### 3.4 Function List(need to enter to system setting first)

Functions		Operation	Description
System Setting	Passage Mode setting	0 → 1 → X	x :1-Start ,2-Forbid. Default is 2
	Verification Mode setting	0 → 2 → X	x :1-Single user ,2-double users , Default is 1, if in double mode, you need to enter two different codes to open
Admin Setting	Set Admin Code	1 → input Admin Code and #	Program new master code
Add Users	Add code user	2 → input code and #	Add new code users
	Add card user	2 → put a card close to number keys	Add new card users
	Add remote user	2 → press remote	Add new remote users
	Add fingerprint	2 → put one finger on finger print sensor	Add new fingerprint users
Delete Users	Delete one User	3 → 1 → U	U stands for Users (input code/fingerprint/remote/card)
	Delete all Users	3 → 2	Delete all users except Admin

#### 4 Others

- Admin User can set a new Admin code by revision. After the revision, the new Admin will replace the old one. (the new Admin code will replace the old one)
- When entering the Passage Mode, the motor will not lock the door automatically after unlocking by code/fingerprint, and everyone can unlock the door by turning the handle. Press # to cancel the Passage Mode.
- When inputting the password, please press # for confirmation, and press \* for elimination.
- This lock has anti-peeking function, with which users can input innocent number before or after the password, e.g. XXX+password+XXX. (no more than 20 digits.)
- Password digits is 6-10digits.
- The keypad will be locked for 3 minutes if you continuously input wrong codes for 5times.
- Low voltage alarm function : There will alarm to remind to change the batteries upon unlock the door when the voltage is below 4.8V.After that, the lock can still be unlock 200 time.

#### 5 Video Instruction

	Video content	link
1	Installation and programming HFAD6300	<a href="https://youtu.be/Cnv17ybYJds">https://youtu.be/Cnv17ybYJds</a>

Problem shooting (Customer Service Email: [xionsihong@hotmail.com](mailto:xionsihong@hotmail.com))

If you failed to program this lock or you have any other question, please contact customer service email, we will reply within 24 hours normally.

