

User Manual

Tips: To request for installation tutorial video, please send email with title “K10 Installation Video” to service@klloque.com

Model No.:K10

Notes:

- ① Before installation, please check and confirm all parts and components are complete. If you find any part missing, please contact our customer service by email to service@klloque.com
- ② This lock comes with a built-in rechargeable battery. Before installation, please recharge the lock for at least 3 hours.
- ③ Please use manual screw driver to install, electric screw driver is not recommended.
- ④ When fingerprint recognition is error for 5 times, the module will be deactivated for 2 minutes. Please retry after 2 minutes.

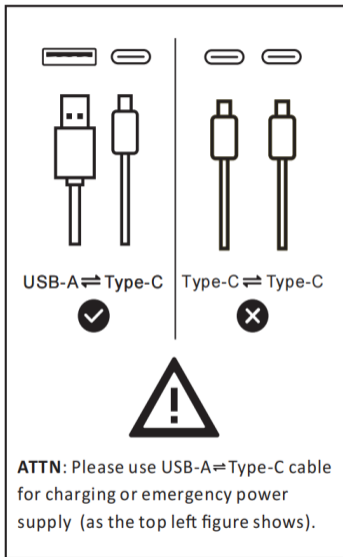

ATTN: Please use USB-A⇌Type-C cable for charging or emergency power supply (as the top left figure shows).

CONTENTS

INSTALLATION GUIDE	2
<i>Prepare Door and Check Dimensions</i>	3
<i>Install Latch and Strike</i>	4
<i>Pull out the Interior Knob & Install the Exterior Knob</i>	5
<i>Install the Interior Knob</i>	6
OPERATION GUIDE	7
PRODUCT FEATURES	10
APP GUIDE	11
<i>Account Registration</i>	11
<i>Pairing Your Lock</i>	12
<i>App Unlock/Lock</i>	14
<i>Member Management & Fingerprint Input</i>	16
<i>Create Smart Scenes</i>	18
<i>More</i>	19
<i>Device Information Set Up</i>	20
SPECIFICATIONS	21
FAQ	22
FCC WARNING	23

INSTALLATION GUIDE

Packing List

A

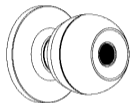

Exterior Knob
1 PC

B

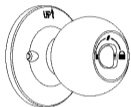

Interior Knob
1 PC

C

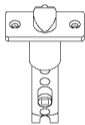

Latch
1 PC

D

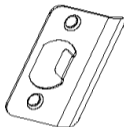

Strike Plate
1 PC

E

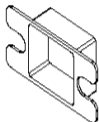

Strike Box
1 PC

F



Screw A
4 PCS

G



Screw B
2 PCS

H



Key
2 PCS

I

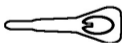

Pin
1 PC

J

User Manual
1 PC

Tools Required



Phillips Screwdriver



Tape Measure

Prepare Door and Check Dimensions

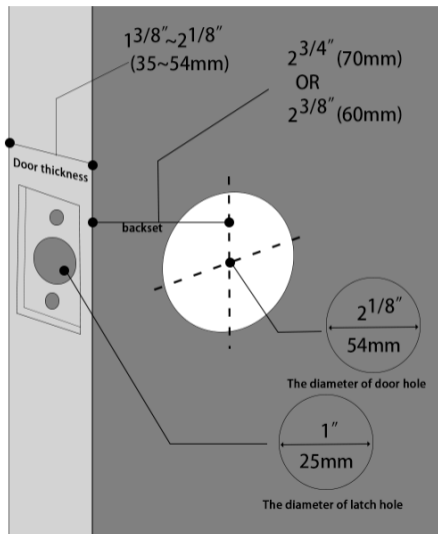

Install Latch and Strike

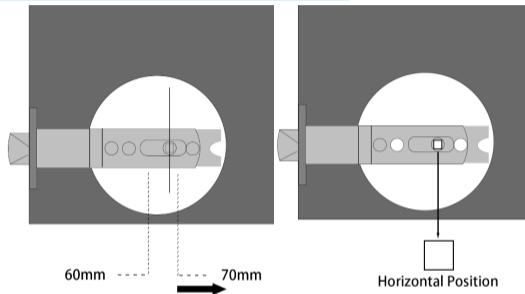

1. Hold the latch in front of the door hole so that the latch is flush with the door edge.
2. Press the square-shaped hole and pull the latch to set the latch backset to 60mm(2-3/8") or 70mm(2-3/4") to fit your door hole.
3. Make sure the square-shaped hole places the horizontal position.

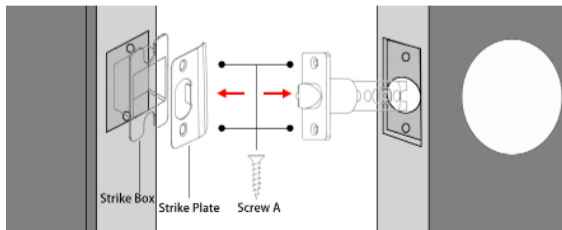

1. Insert the latch into the door hole, and tighten Screw A to fix the latch.
2. Install strike box and strike plate with screw A into the door frame.

Pull out the Interior Knob

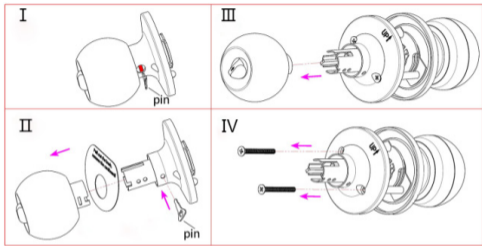
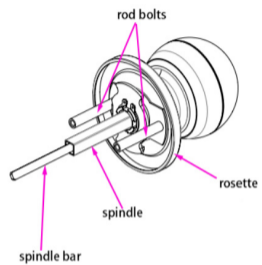

As the left figure shows, insert the pin into the hole and separate the rosette from the Interior Knob. Then use a screwdriver to remove the screw B.

Install the Exterior Knob

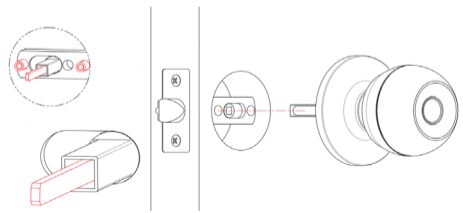

As shown left, install the Exterior Knob onto the door with the rod bolts going through the circular holes on the Latch, and spindle going through the square-shaped(center)hole.

Install the Interior Knob

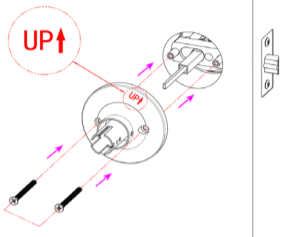

The "up" mark above the rosette should face upward.

Install the rosette onto the door with the rod bolts aligning the circular holes and spindle aligning the square-shaped (center) hole. Then insert the Screw B into the circular holes and tighten them to secure the rosette.

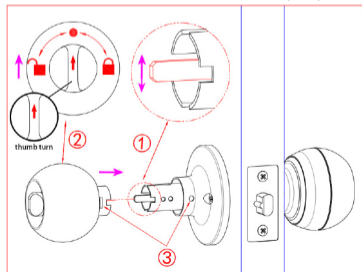

Firstly, make sure the spindle bar is in the vertical position as shown left. Secondly, rotate the thumb turn to the circular mark. Lastly, insert the Interior Knob into the rosette by aligning the hole of Interior Knob with the spindle bar and aligning the rectangular hole at the edge of the interior knob with the circular hole at the edge of the rosette.

OPERATION GUIDE

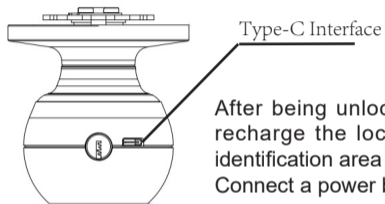

After being unlocked by fingerprint or APP successfully, it is time to recharge the lock when the buzzer beeps once and the fingerprint identification area flashes green and then flashes red.
Connect a power bank to the type-C interface on the knob for charging.

Key To Unlock

Insert the key into the keyhole at the edge of the Exterior Knob and turn key 120° to unlock, then turn the Exterior Knob to open the door.

Low Power Indication

Restore the Factory Setting

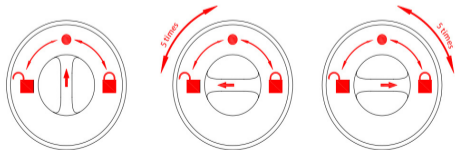

Unlock the smart lock with either app or fingerprint, rotate the thumb turn from the circular mark to the unlock sign on the left and then return the thumb turn to the circular mark, after repeating this operation 5 times, conduct the same operation towards the right for 5 times. After that, you will hear the long beep and the fingerprint identification area flashes green.

Any fingerprints can unlock the lock.

Normal Mode

As the figure shows, rotate the thumb turn to circular mark above the thumb turn to switch to normal mode. In the normal mode, after unlocking with the fingerprint, the door knob automatically locks in 5 seconds. **Both members and administrators can unlock with their fingerprints.**

Passage Mode

As shown right, rotate the thumb turn to unlock sign on the left to activate passage mode. After activating passage mode, the door knob is always unlocked.

Privacy Mode

As the figure shows, rotate the thumb turn to lock sign on the right to activate privacy mode. Both members and administrators can unlock via app. **Only the administrators' fingerprints can unlock.**

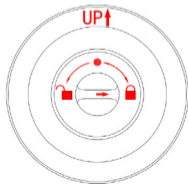
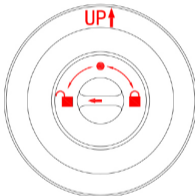
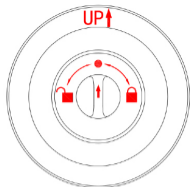

Action	Buzzer	Indicator
Power on	Beep once	Inactive
Fingerprint added successfully	Long Beep	Stay green for a while
Unlocking successful	Beeps once	Blinks green once
Unlocking failure	Beeps twice	Blinks red once
Low battery warning	Beeps once	Blinks green then blinks red
Resetting successful	Long Beep	Blinks green once

PRODUCT FEATURES



Fingerprint Unlock



APP Unlock



Key Unlock



Auto-Lock



Privacy Mode



Passage Mode



History Log

**This smart lock can be managed and controlled by Smart Life app on your phone.
Please read the following pages for app instructions.**

APP GUIDE

Scan the Smart Life QR Code to download the app or search "Smart Life" in APP Store (IOS) and Google Play (Android) for download.

Account Registration

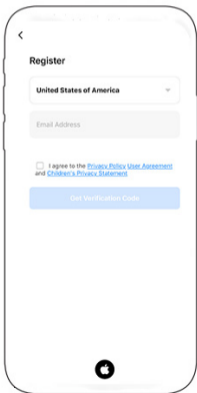

Register a new account (Email Address) or log in with an existing account.



Smart Life QR Code

Pair the Lock

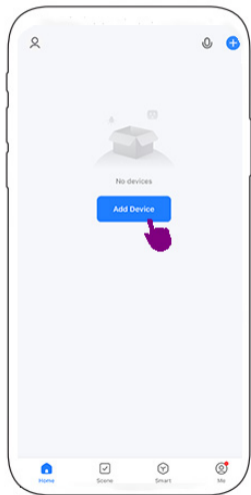

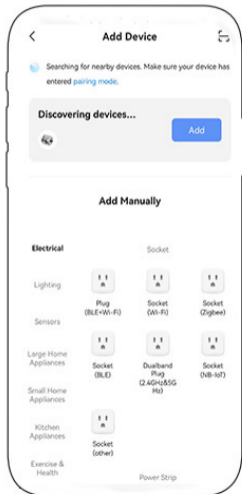

Turn on your phone's bluetooth and stay near the lock (within 3 meters) Click "Add Device" on the App.

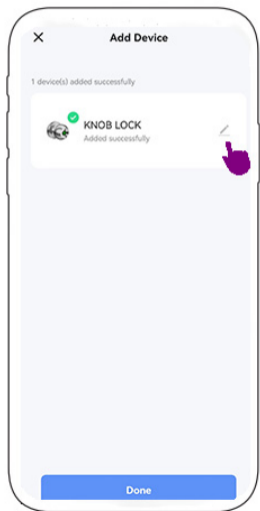

Add the lock.

Pair the Lock



Successful connection! You can click this icon “” to rename the lock or just click “Done” to complete the pairing.

APP Unlock/Lock

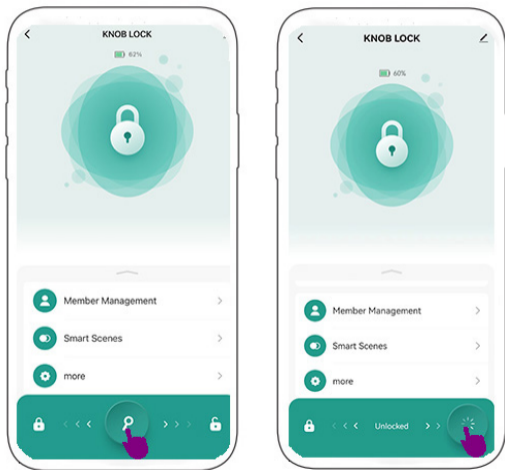

Unlock: Hold and drag the icon “

14

APP Unlock/Lock

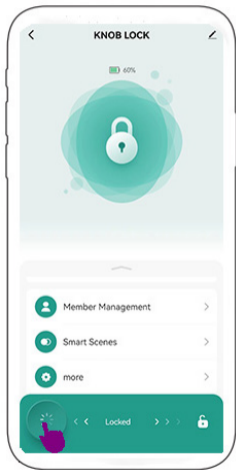

Lock: Hold and drag the icon “” to the icon “”.

Member Management & Fingerprint Input

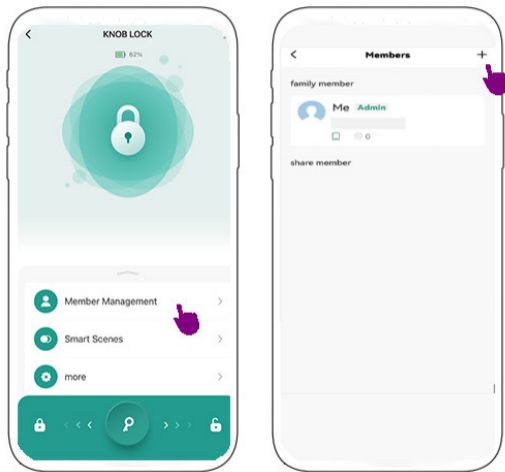

Select “Member Management” and tap “+” to add/share/cancel members.

Member Management & Fingerprint Input

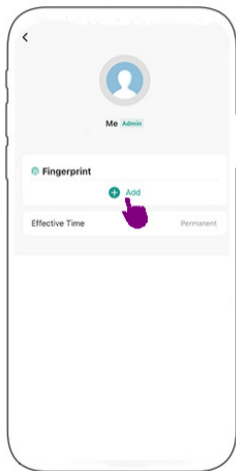

Press “Add” and follow the instructions to add fingerprints.

Warm tips:

1. Please keep your fingers and sensing area clean and dry before inputting your fingerprint.
2. For improving the fingerprint recognition rate of the elderly, children or people with light fingerprints, it is necessary to create more fingerprint files and input different angles of their fingerprints.
3. For your privacy, your fingerprints will be stored in the device only.

Creat Smart Scenes

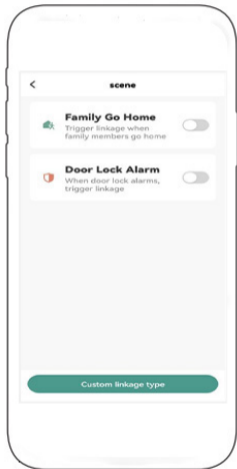
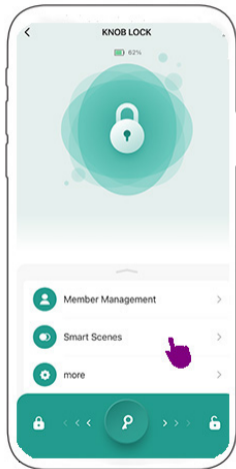

Select “Smart Scenes” on the screen. Then choose the scenes you prefer to set intelligent interactions.

More

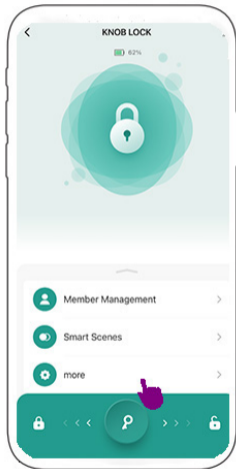

Choose "More" to turn on/off "Remote Unlock" and set up lock volume.

 Note: Remote unlocking requires a gateway connection.

Device Information Set Up

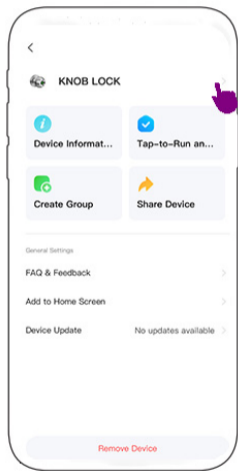

Press the product name to check and set up the relevant information.

SPECIFICATIONS

Technical Parameters

Name	Parameter Description
USB	Type-C/5V2A
Fingerprint Capacity	20
Low power warning	3.3V±0.2
Voltage range	3.0~4.2V
Stand-by current	≤90μA
Working current	≤500mA
Working temperature	23 °F ~131 °F (-5°C ~55°C)

FAQ

Q: When recording fingerprints, please place your clean and dry finger at different angles and positions to ensure that a larger area is scanned.

A: If two apps use Bluetooth to manage one lock at the same, only one user can connect to control this lock.

Q: If the batteries die, how can I open the door?

A: The smart door knob built-in rechargeable battery. You can use an emergency power supply to charge the smart door knob through a Type C port or use the backup key to open the door.

Q: After installing the new lock, what should I do to pair and set it up?

A: This smart knob lock can be controlled on smart phone by Bluetooth connection and Smart Life app. Please confirm that the Bluetooth and Location permission is turned on for the App. After authorization, you need to touch the fingerprint sensor to wake up the smart lock.

Q: Why is my Smart Lock low-powered?

A: Charge the lock for 3 hours before installing. When the low battery warning occurs (fingerprint unlocked first green light then flashing red light), indicating the need for charging.

Q: What can I do if the smart knob locks me out after several times incorrectly input?

A: For user safety, if you enter the wrong fingerprint ten times in a row, the lock will enter security mode, and stop accepting fingerprints for unlock. Methods to exit this mode:

1. Unlock via app. 2. Unlock via backup key. 3. Waiting for 2 minutes.

FCC WARNING

Any changes or modifications not expressly approved by the party responsible for compliance could void the user's authority to operate the equipment.

Note: The equipment has been tested and found to comply with the limits for a Class B digital device. Pursuant to part 15 of the FCC Rules. These limits are designed to provide reasonable protection against harmful interference in residential installation. This equipment generates uses and can radiate radio frequency energy and, if not installed and used in accordance with the instructions, may cause harmful interference to radio communications. However, there is no guarantee that interference will not occur in a particular installation. If this equipment does cause harmful interference to radio or television reception, which can be determined by turning the equipment off and on, the user is encouraged to try to correct the interference by one or more of the following measures:

- Reorient or relocate the receiving antenna.
- Increase the separation between the equipment and receiver.
- Connect the equipment into an outlet on a circuit different from that to which the receiver is connected
- Consult the dealer or an experienced radio/TV technician for help.

This device complies with part 15 of the FCC Rules. Operation is subject to the following two conditions: (1) This device may not cause harmful interference, and (2) this device must accept any interference received, including interference that may cause underired operation.



Customer Service

Please send email to service@klloque.com