

Trail Camera User Manual

iG220

EN

DE

FR

IT

ES

iZEEKER

Product Structure

Inside View

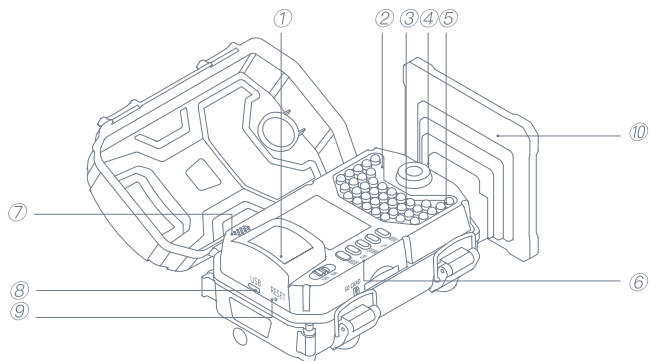

Back View

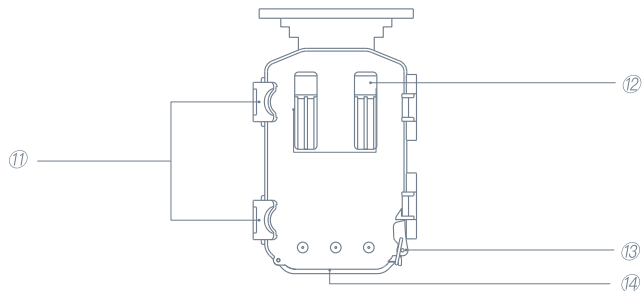

① PIR Sensor

② Light Sensor

③ Infrared LEDs

④ Lens

⑤ PIR Sensor Indicator

⑥ Mode Button

⑦ Speaker

⑧ USB Port

⑨ Reset Button

⑩ Solar Panel

⑪ Latch

⑫ Buckles

⑬ Battery Case Lock

⑭ Battery Case

Important Note

EN

Dear Customer,

Thank you for purchasing a iZEEKER Trail Camera. We appreciate your business and will do everything in our power to earn your trust. Please refer to the instructions in this manual for operation and best use of the camera.

If your iZEEKER Trail Camera does not seem to be functioning properly or if you are having photo/video quality issues, please feel free to email us, we will respond quickly and professionally to solve whatever issue you may have.

We also welcome and value all feedback and suggestions on our camera. Your objective feedback and frank opinions are the driving force behind our innovation. Please do not hesitate to reach out to us with complaints or suggestions, as they allow us to continue to grow and adapt with the ever-changing market.

We are deeply aware that quality service never ends, and will spare no effort to improve on our product quality and customer service experience now and forever. Thank you, once again, for choosing iZEEKER and we look forward to being your camera partner now and in the future.

iZEEKER Trail Camera Service email: support.gc@izeeker.co

Sincerely,
iZEEKER

For Video Instruction, Exclusive Offers, New Releases, and more, please search "iZEEKER Trail Camera" on YouTube, Facebook and Instagram, or scan below QR code.



Quick Start Guide

EN

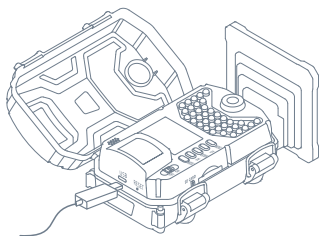

Charge the Built-in Battery

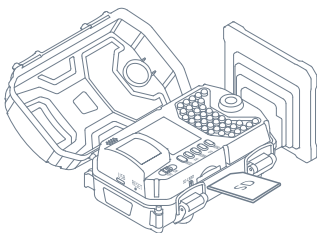

Insert SD Card



Switch to ON

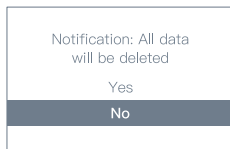

Format SD card & Adjust Settings

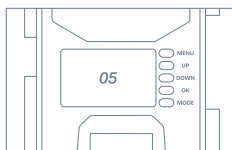

Start working after countdown finishes

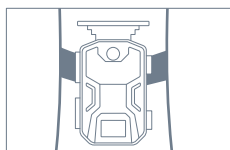

Position the camera

Power Supply and Install the SD Card

Power Supply

A. Built-in Battery Powered and Solar Powered

- Before your first use, charge the built-in rechargeable battery with a USB cable (included) and 5V wall outlet charger (not included) about 8 hours.
- You can check whether it is fully charged by looking at the charging light on the bottom of the camera: red light means charging, green light means charging is complete.
- The charging efficiency of the solar panel is related to the intensity of sunlight, the duration of sunlight exposure, and the ambient temperature.

B. AA Battery Powered (Optional)

Under low temperature/low sunlight situations, you can use 4 AA batteries as a backup power source. When the built-in lithium battery power is low, the camera will automatically switch to be powered by the AA batteries.

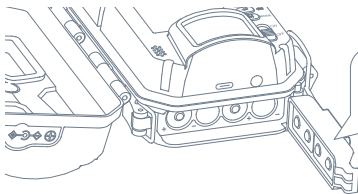

- Do not mix old and new batteries.
- Do not mix battery types. Use ALL alkaline or ALL rechargeable.
- When the camera is turned on, the power is supplied by the built-in battery in default.
- When the built-in battery power is lower than 10%, the camera automatically switches to be powered by backup 4 AA batteries.
- The Solar panel charges built-in battery only. It does not charge the AA alkaline batteries or AA rechargeable batteries.
- When the AA battery power is lower than 30%, the camera will stop or reduce night shooting, and will stop shooting when the power is exhausted.

Insert and format the SD Card

EN

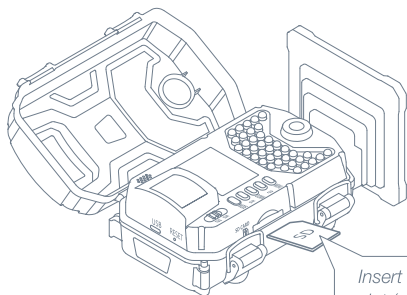

Insert the SD card into the card slot (metal contacts down) and push in until you hear a "click".

- When the card is inserted or removed, the mode switch must be in OFF position.
- Insert a Class 6 or higher class SD card up to 128GB.
- Insert or remove the SD card in ON mode, the camera might shut itself down.
- Format the new SD card before using the camera.

Product Operation and Menu Settings

EN

Product Operation

OFF/ON Mode

Shift the “Mode Switch” to choose working status



OFF Mode: Turn off the camera

The camera is completely off. Only in OFF mode should you insert or remove the memory card or replace the batteries.

ON Mode: Adjust settings/Start operating

- *When switched from OFF to ON, the screen display will go into the preview mode. You can manually record video, take photos, playback the recorded files or change settings.*
- *In the preview mode, the PIR sensor is on. When they are triggered, light indicator will flash, but the camera will not take photos or record videos automatically.*
- *If there is no operation, it will automatically get into working mode. There will be have a delay time (30S/60S/3MIN) and the screen will have a 10s countdown, and then it will go black, the button operation will be disabled.*
- *When detecting animals or other moving objects, the camera will take photos or record videos when the PIR sensor is triggered, then return to standby afterward.*

Menu Settings

EN

Monitor Delay

Select the delay time when the camera enters the automatic shooting mode. In ON mode, the camera will automatically go into the automatic shooting mode after the set delay time if you do not make any operations.

Mode

Selects whether still photos or video clips are captured when the camera is triggered. Photo&Video mode combines both Photo and Video, so a still photo and a video clip are both captured for each trigger.

Photo Resolution

Selects resolution for still photos. Higher resolution provides more pixels, but creates larger files that take up more of the SD card capacity (fills up faster).

Photo Series

Selects how many photos are taken per trigger in Photo mode.

Video Resolution

Selects video resolution. Higher resolution produces better quality videos, but creates larger files that take up more of the SD card capacity (fills up faster). Using high speed SD cards (SanDisk® SDHC class 6 or higher) is recommended if you will higher video settings.

Video Length

Specifies the duration of a video recording when the camera is triggered automatically. To extend camera using life, we recommend to set a shorter video length.

Audio Recording

Selects if record audio while recording a video.

PIR Interval

Selects the length of time that the camera will "wait" until it responds to any additional triggers from the PIR after an animal is first detected and remains within the sensor's range.

Note:

PIR Interval takes great effect on battery working time. The shorter the interval, the high frequency to capture target, but more power consumption; The longer the interval, the lower frequency to capture the target and less power consumption.

IR Distance

Selects the distance that the PIR sensor can detect.

PIR Sensitivity

Select sensitivity according to application conditions.

Select "High" For interior areas and environments with little interference.

Select "Medium" for exterior areas and the environment with a normal amount of interference.

Select "Low" for an environment with a high level of interference.

Target Recording Time

Select "ON" to turn on this function, and set the start and end working time. The camera will not be triggered and will not take any photos or videos beyond this period. For instance set to 18:35 and the end time is 8:25, the camera will be operational from 6:35 pm of the current day until 8:25 am of the following day.

Note:

The start time must be later than the camera system time, otherwise the camera will work at the set time period in the next day.

Time Lapse

Turns Time Lapse recording mode on/off. Once activated, this function forces the camera to take photos or videos even when it is not triggered by a nearby live target, useful for constant monitoring of an area that might be far away from the camera. This is also useful for observing cold blooded animals (e.g. snakes) or outdoor plants etc. As soon as the "on" setting has been confirmed by pressing the OK key, you could set up the interval time (3 seconds~24 hours) and press the OK key, the feature will be activated.

Note:

In this mode, the PIR function would stop working, and the camera would take photos in the set interval time. The photos will automatically form videos.

Language

Select the desired menu language.

Loop Recording

If you turn on this function, the new captured files will overwrite the first file and stores the latest captured file. when your memory card is full.

Time & Date

Set the year, month and date (based on the date format you set), then the hour (based on the date format you set) and minute.

Time Stamp

Turn on/off the display of date and time watermark on the photos and videos.

Password Protection

After selecting "On", you can set up a four-digit password to protect your camera against unauthorized access. Use the UP/DOWN keys (to change the setting) and OK keys (to move to the next field) to set the four-digit code.

Note:

If you forget your password, please input the universal password "1111" to enter into the camera settings.

Format Memory Card

Deletes (erases) all files stored on a card to prepare it for reuse. Always format a card that has been previously used in other devices or if it is a new card.

Note:

Make sure you have downloaded and backed up the files you want to preserve first!

Serial No.

In order to distinguish between your camera and others, each camera can be set with a unique serial number, the serial number has 4 digits, each of which can be a letter or a number. It will be displayed in the photo/video watermark.

Reset Settings

Selects OK to restore all parameters to the original factory default settings. If the camera is behaving oddly and you think you may have changed the setting accidentally (but aren't sure which one), this will reset all parameters to their most commonly used or "generic" settings.

Version

Displays current firmware version for reference.

Mounting and Positioning the Camera



1. Position the camera facing north or south

The sun can cause false triggers with east or west camera placement. North is best.

2. Position the camera perpendicular to the ground

Ensure your camera is mounted straight up and down so the pictures you capture are level to the horizon. This will also help prevent false triggers and improve the camera's ability to capture wanted motion.

3. Point camera at a 45-degree angle

Position your camera at a 45-degree angle to a trail, allowing more time for an animal to trigger the camera's sensors for a photo. Never place a camera directly across from a trail because it will leave less time for your camera to photograph a fast-moving deer or other object.

4. Place camera about 20 feet from your target

This distance helps provide good lighting for a clear photo of the entire target.

5. Place camera 3 to 6 feet off the ground

Mount your camera to a stand or a strong tree that won't sway. This will help ensure you don't receive any unwanted photos of small critters curious about your camera.

6. Clear vegetation from the front of the camera

Remove grass, small limbs and twigs away from the camera's view to avoid getting unwanted pictures of moving vegetation.

7. Adjust the position of the solar panel

- Make sure the solar panel forms an angle with the horizontal plane to prevent the accumulation of rain or snow. The solar panel can be tilted upwards by 5 degrees and downwards by 15 degrees.
- To ensure sufficient sunlight reaches the solar panel on top of the camera, the camera should be fixed in a position where the solar panel is fully exposed to sunlight.
- Regularly clean the solar panel to remove dust, dirt, bird droppings, and other debris. This will maintain a smooth and transparent surface, increasing light absorption efficiency.

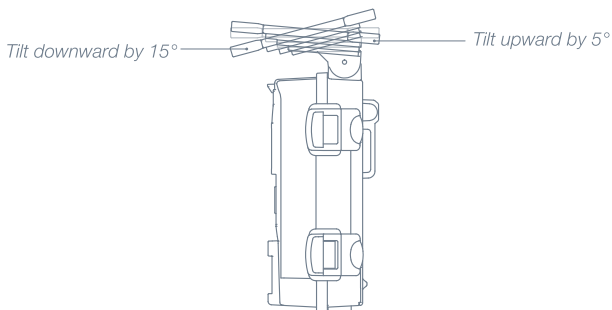

Sensing and Distance Test

EN

To test whether the trail camera can effectively monitor the area you choose, this test is recommended to check the sensing angle and monitoring distance of the trail camera. To perform the test:

- Switch the trail camera to the ON mode.
- Make parallel movements in front of the camera at several positions within the area where you expect the game or subjects to be. Try different distances and angles from the camera.
- If the motion indicator LED light blinks, it indicates that the position can be sensed. If it does not blink, that position is outside of the sensing area.
- The results of your testing will help you find the best placement when mounting and aiming the trail camera. The height away from the ground for placing the device should vary with the animal size appropriately. In general, 3 to 6 feet is preferred. The optimal distance away from the subject is about 20 feet.
- If you want to capture small animals, we recommend placing the camera directly on the ground and making it close to the subject.
- You can avoid potential false triggers due to temperature and motion disturbances in front of the camera by not aiming it at a heat source or nearby tree branches or brush (especially on windy days).

Replay Mode

All photos and videos taken by the iZEEKER trail camera can be viewed directly on the built-in screen, also can be protected, unprotected and deleted directly on the camera, and can be displayed as a slide show.

Reviewing the Files Directly on the Camera

Put the power switch to ON position, press **【Mode】** key twice to enter into the Replay mode.

- Press **【UP】** : page forward
- Press **【DOWN】** : page forward
- When check videos in the Replay mode, **【OK】** key is Play/Pause key.
- When you want to delete the unwanted file in the Replay mode, press **【MENU】** key and **【OK】** key to delete the current file or delete all files.
- Press **【Mode】** key again to quit the Replay mode.

Connecting the Camera to a Computer

When using a PC (or Mac*) to view photos (or video clips*), First, put the power switch to the **【ON】** position. Then connect to the PC via the micro USB cable. Once successfully connected, the camera screen will display the characters "MSDC," while the computer will show a "Removable Disk" notification. You can then operate the camera on the computer just like a regular USB flash drive, performing various operations such as file transfers and data management. You could view images/videos saved on the SD card directly on the PC.

Note:

Video files may require additional software for viewing on Mac.



Made in China
Version 1.0