

HAMMERHEAD™



4V LITHIUM-ION SCREWDRIVER



MODEL HCSD040

ATTACH YOUR RECEIPT HERE

Serial Number _____ Purchase Date _____



Questions, problems, missing parts? Before returning to your retailer, call our customer service department at 1-877-888-1880, 8:30 a.m. – 8:00 p.m. EST (Monday – Friday) & 10:00 a.m. – 6:00 p.m. EST (Saturday and Sunday).

TABLE OF CONTENTS

Product Specifications	3
Safety Information	4
Preparation	8
Operating Instructions	9
Care and Maintenance	14
Troubleshooting	15
Warranty	16

WARNING

- Some dust created by power sanding, sawing, grinding, drilling and other construction activities contains chemicals known to the State of California to cause cancer, birth defects or other reproductive harm. Some examples of these chemicals are:
 - Lead from lead-based paints.
 - Crystalline silica from bricks, cement, and other masonry products.
 - Arsenic and chromium from chemically-treated lumber.
- Your risk from these exposures varies, depending upon how often you do this type of work. To reduce your exposure to these chemicals: work in a well-ventilated area and work with approved safety equipment, such as dust masks that are specially designed to filter out microscopic particles.

PRODUCT SPECIFICATIONS

COMPONENT	SPECIFICATIONS
Rated voltage	4V d.c.
No-load speed	200/min
Collet size	1/4" hex
Recommended working temperature	41 ~ 104°F (5 ~ 40°C)
Recommended charging temperature	41 ~ 104°F (5 ~ 40°C)
Recommended storage temperature	41 ~ 104°F (5 ~ 40°C)

Please read and understand this entire manual before attempting to assemble or operate this product. If you have any questions regarding the product, please call Hammerhead customer service at 1-877-888-1880, 8:30 a.m. – 8:00 p.m. EST (Monday – Friday) & 10:00 a.m. – 6:00 p.m. EST (Saturday and Sunday).

FCC Statement

1. This device complies with Part 15 of the FCC Rules. Operation is subject to the following two conditions:
 - (1) This device may not cause harmful interference.
 - (2) This device must accept any interference received, including interference that may cause undesired operation.
2. Changes or modifications not expressly approved by the party responsible for compliance could void the user's authority to operate the equipment.

NOTICE:







This equipment has been tested and found to comply with the limits for a Class B digital device, pursuant to Part 15 of the FCC Rules. These limits are designed to provide reasonable protection against harmful interference in a residential installation. This equipment generates, uses, and can radiate radio frequency energy and, if not installed and used in accordance with the instructions, may cause harmful interference to radio communications. However, there is no guarantee that interference will not occur in a particular installation. If this equipment does cause harmful interference to radio or television reception, which can be determined by turning the equipment off and on, the user is encouraged to try to correct the interference by one or more of the following measures: Reorient or relocate the receiving antenna. Increase the separation between the equipment and receiver. Connect the equipment into an outlet on a circuit different from that to which the receiver is connected. Consult the dealer or an experienced radio/TV technician for help.

SAFETY INFORMATION

Know the Tool

To operate this tool, carefully read this manual and all labels affixed to the screwdriver before using it. Keep this manual available for future reference.

Some of the following symbols may be used on this screwdriver. Please study them and their meaning. Proper interpretation of these symbols will allow you to operate the tool better and more safely.

SYMBOL	DEFINITION	SYMBOL	DEFINITION
V	Volts	n_0	No-load Speed
	Direct current	/min	Revolutions or reciprocations per minute (rpm)
	Alternating current	A	Amps
	A danger, warning or caution. It means ' ATTENTION! Your safety is involved. '		Always wear safety goggles or safety glasses with side shields and a full face shield when operating this product.
	This symbol designates that this tool is listed by Underwriters Laboratories, to United States and Canadian Standards.		Read the instructions
	Li-ion RBRC seal		

IMPORTANT: This tool should only be serviced only by a qualified service technician.

IMPORANT SAFETY INSTRUCTIONS

SAVE THESE INSTRUCTIONS-This manual contains important safety and operating instructions for screwdriver Model HCSD040

DANGER

To reduce the risk of fire or electric shock, carefully follow these operating instructions.

SAFETY INFORMATION

GENERAL POWER TOOL SAFETY WARNINGS

WARNING

Read all safety warnings, instructions, illustrations and specifications provided with this power tool. Failure to follow all instructions listed below may result in electric shock, fire and/or serious injury.

SAVE ALL WARNINGS AND INSTRUCTIONS FOR FUTURE REFERENCE.

The term “power tool” in the warnings refers to your mains-operated (corded) power tool or battery-operated (cordless) power tool.

Work Area Safety

- **Keep work area clean and well lit.** Cluttered or dark areas invite accidents.
- **Do not operate power tools in explosive atmospheres, such as in the presence of flammable liquids, gases or dust.** Power tools create sparks which may ignite the dust or fumes.
- **Keep children and bystanders away while operating a power tool.** Distractions can cause you to lose control.

Electrical safety

- **Power tool plugs must match the outlet. Never modify the plug in any way. Do not use any adapter plugs with earthed (grounded) power tools.** Unmodified plugs and matching outlets will reduce risk of electric shock.
- **Avoid body contact with earthed or grounded surfaces, such as pipes, radiators, ranges and refrigerators.** There is an increased risk of electric shock if your body is earthed or grounded.
- **Do not expose power tools to rain or wet conditions.** Water entering a power tool will increase the risk of electric shock.
- **Do not abuse the cord. Never use the cord for carrying, pulling or unplugging the power tool. Keep cord away from heat, oil, sharp edges or moving parts.** Damaged or entangled cords increase the risk of electric shock.
- **When operating a power tool outdoors, use an extension cord suitable for outdoor use.** Use of a cord suitable for outdoor use reduces the risk of electric shock.
- **If operating a power tool in a damp location is unavoidable, use a ground fault circuit interrupter (GFCI) protected supply.** Use of a GFCI reduces the risk of electric shock.

SAFETY INFORMATION

Personal Safety

- **Stay alert, watch what you are doing and use common sense when operating a power tool. Do not use a power tool while you are tired or under the influence of drugs, alcohol or medication.** A moment of inattention while operating power tools may result in serious personal injury.
- **Use personal protective equipment. Always wear eye protection.** Protective equipment such as a dust mask, non-skid safety shoes, hard hat or hearing protection used for appropriate conditions will reduce personal injuries.
- **Prevent unintentional starting. Ensure the switch is in the off-position before connecting to power source and/or battery pack, picking up or carrying the tool.** Carrying power tools with your finger on the switch or energising power tools that have the switch on invites accidents.
- **Remove any adjusting key or wrench before turning the power tool on.** A wrench or a key left attached to a rotating part of the power tool may result in personal injury.
- **Do not overreach. Keep proper footing and balance at all times.** This enables better control of the power tool in unexpected situations.
- **Dress properly. Do not wear loose clothing or jewellery. Keep your hair and clothing away from moving parts.** Loose clothes, jewellery or long hair can be caught in moving parts.
- **If devices are provided for the connection of dust extraction and collection facilities, ensure these are connected and properly used.** Use of dust collection can reduce dust related hazards.
- **Do not let familiarity gained from frequent use of tools allow you to become complacent and ignore tool safety principles.** A careless action can cause severe injury within a fraction of a second.

Power Tool Use and Care

- **Do not force the power tool. Use the correct power tool for your application.** The correct power tool will do the job better and safer at the rate for which it was designed.
- **Do not use the power tool if the switch does not turn it on and off.** Any power tool that cannot be controlled with the switch is dangerous and must be repaired.
- **Disconnect the plug from the power source and/or remove the battery pack, if detachable, from the power tool before making any adjustments, changing accessories, or storing power tools.** Such preventive safety measures reduce the risk of starting the power tool accidentally.
- **Store idle power tools out of the reach of children and do not allow persons unfamiliar with the power tool or these instructions to operate the power tool.** Power tools are dangerous in the hands of untrained users.

SAFETY INFORMATION

- **Maintain power tools and accessories. Check for misalignment or binding of moving parts, breakage of parts and any other condition that may affect the power tool's operation. If damaged, have the power tool repaired before use.** Many accidents are caused by poorly maintained power tools.
- **Keep cutting tools sharp and clean.** Properly maintained cutting tools with sharp cutting edges are less likely to bind and are easier to control.
- **Use the power tool, accessories and tool bits etc. in accordance with these instructions, taking into account the working conditions and the work to be performed.** Use of the power tool for operations different from those intended could result in a hazardous situation.
- **Keep handles and grasping surfaces dry, clean and free from oil and grease.** Slippery handles and grasping surfaces do not allow for safe handling and control of the tool in unexpected situations.

Battery tool use and care

- **Recharge only with the charger specified by the manufacturer.** A charger that is suitable for one type of battery pack may create a risk of fire when used with another battery pack.
- **Use power tools only with specifically designated battery packs.** Use of any other battery packs may create a risk of injury and fire.
- **When battery pack is not in use, keep it away from other metal objects, like paper clips, coins, keys, nails, screws or other small metal objects, that can make a connection from one terminal to another.** Shorting the battery terminals together may cause burns or a fire.
- **Under abusive conditions, liquid may be ejected from the battery; avoid contact. If contact accidentally occurs, flush with water. If liquid contacts eyes, additionally seek medical help.** Liquid ejected from the battery may cause irritation or burns.
- **Do not use a battery pack or tool that is damaged or modified.** Damaged or modified batteries may exhibit unpredictable behaviour resulting in fire, explosion or risk of injury.
- **Do not expose a battery pack or tool to fire or excessive temperature.** Exposure to fire or temperature above 265 °F may cause explosion.
- **Follow all charging instructions and do not charge the battery pack or tool outside the temperature range specified in the instructions.** Charging improperly or at temperatures outside the specified range may damage the battery and increase the risk of fire.

SAFETY INFORMATION

Service

- **Have your power tool serviced by a qualified repair person using only identical replacement parts.** This will ensure that the safety of the power tool is maintained.
- **Never service damaged battery packs.** Service of battery packs should only be performed by the manufacturer or authorized service providers.

ADDITIONAL SAFETY INSTRUCTIONS FOR SCREWDRIVER

- **Hold the power tool by insulated gripping surfaces, when performing an operation where the fastener may contact hidden wiring .** Fasteners contacting a “live” wire may make exposed metal parts of the power tool “live” and could give the operator an electric shock.

PREPARATION

Before attempting to use the screwdriver, familiarize yourself with all of its operating features and safety requirements.

PACKAGE CONTENTS

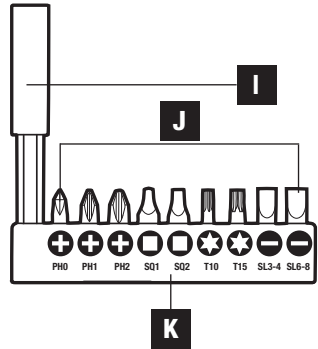
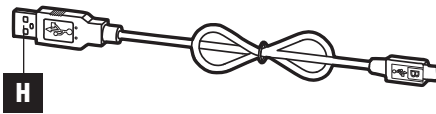
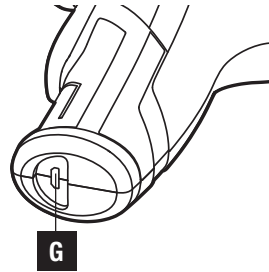
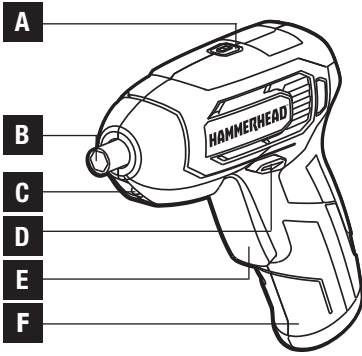

PARTS	DESCRIPTION
A	Charging Indicator
B	Bit Holder
C	LED Worklight
D	Forward/Reverse Rotation Selector
E	Trigger Switch
F	Soft Grip
G	Charging Port
H	USB Charging Cable
I	Magnetic Holder
J	Bits
K	Plastic Bit Holder

OPERATING INSTRUCTIONS

⚠ DANGER: NEVER INSERT ANY PART OF THE TOOL, INCLUDING BIT, INTO AN ELECTRICAL OUTLET FOR ANY REASON. NEVER TOUCH ANY PORTION OF THE TOOL TO ANY POTENTIALLY LIVE CIRCUIT. Failure to obey this warning could cause electric shock and other serious personal injury.

1. How To Charge

NOTICE: The screwdriver is shipped partially charged; fully charge the battery before first use.

Optimum performance can be reached by recharging the tool for approximately 2 hours after use. It is not recommended to recharge the tool for more than 24 hours after each use. The power supply can be used with normal household voltage of 120 volt AC.

NOTICE: Power supply is not included. For use only with Listed/Certified Information Technology (Computer Equipment). (Max. Charging current: 0.5A; Max. Charging voltage: 4.2V)

⚠ WARNING: Never charge the tool with any power supply or power source that is not listed/certified. Failure to obey this warning could cause battery damage and serious personal injury.

- a. Insert the USB interface of the USB charging cable into the power supply.
- b. Insert the charging plug into the charging port, making sure that they are properly connected.
- c. Connect the power supply (together with USB charging cable) to the power outlet. The charging indicator light will shine green to indicate that the tool is charging.

NOTICE: The tool will not run when you rotate the forward/reverse selector during charging.

- d. When charging is complete, the charging indicator light will keep steady green. Remove the USB charging cable from the tool.

NOTICE: Do not operate the power supply in an area of extreme heat or cold. It works best at normal room temperature. The bottom of the tool or power supply may become warm during charging.

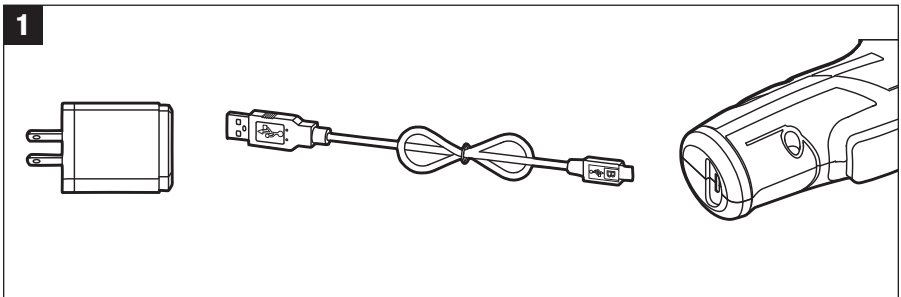

OPERATING INSTRUCTIONS

2. Forward/Reverse Selector

Change the rotational direction from forward to reverse by pressing the forward/reverse control.

1. Move the forward / reverse rotation control to the left in order to use the product in a clockwise rotational mode. Use this function for screw driving.
2. Move the forward / reverse rotation control to the right in order to use the product in counter clockwise rotational mode. Use this function to loosen jammed screws.
3. Move the forward / reverse rotation control to the centre position to lock the on/off switch and avoid accidental starting.

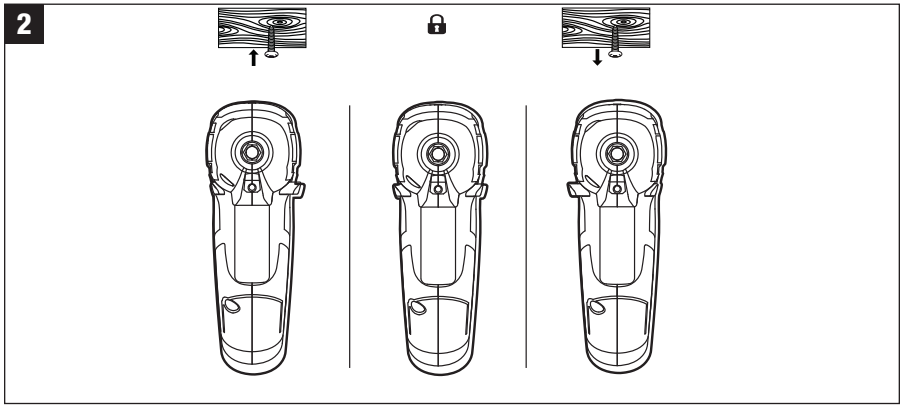

3. Trigger Switch

Your tool is equipped with a trigger switch with enough room for two fingers for more comfortable operation and better control. The tool can be turned “ON” by depressing the trigger, or “OFF” by releasing the trigger

⚠ WARNING: If any parts are damaged or missing, do not operate this product until the parts are replaced. Use of this product with damaged or missing parts could result in serious personal injury.

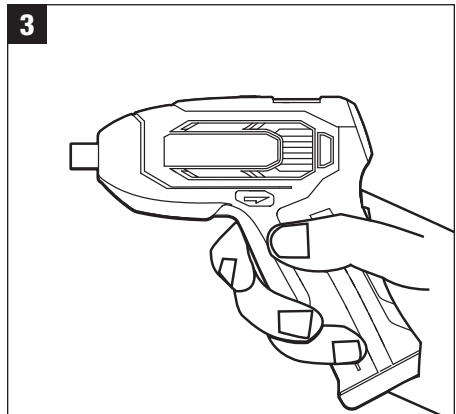

OPERATING INSTRUCTIONS

4.LED Worklight

Your tool is equipped with an LED worklight, illuminating when the trigger is squeezed. This provides additional light on the surface of the work piece for operation in lower-light areas. The LED worklight will automatically turn on when depressing the trigger switch, and turn off after the trigger switch is released.

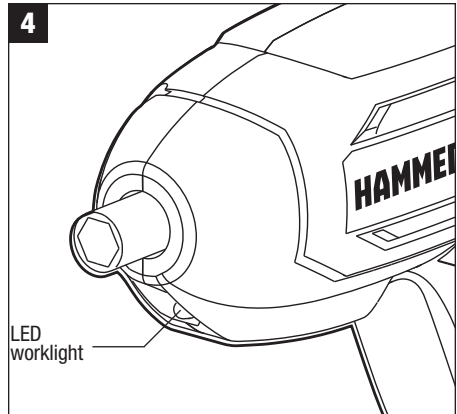

5.Install and Remove Bits

Your tool is equipped with a magnetic bit holder, making bit installing and removing very easy.

Lock the trigger switch “OFF” by placing the direction-of-rotation selector in the center position.

To install the bit:

Insert the bit into the holder. The built-in magnet will help to securely hold the bit in place.

To remove the bit:

Just pull the bit out of the holder.

⚠ WARNING: Use protective gloves when removing the bit from the tool, or first allow the bit to cool down . The bit may be hot after prolonged use .

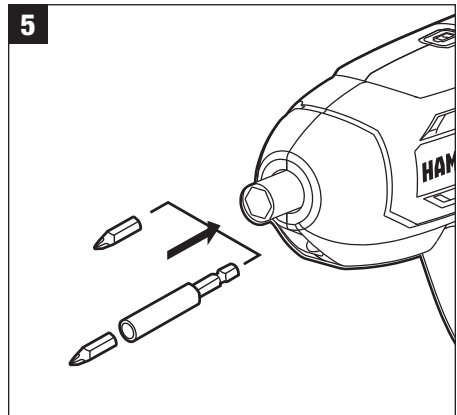

OPERATING INSTRUCTIONS

6. Screw Driving

- a) Install a suitable bit.

NOTICE: Always use the correct type and size of screwdriver bit for your application.

- b) Grasping only the handle of the tool, align the bit perpendicular to the screw.
- c) Apply just enough pressure to keep the bit engaged on the screw.
- d) To tighten a screw, set the direction of rotation at “Forward”, then depress the trigger switch.
- e) To loosen a screw, set the direction of rotation at “Reverse”, then depress the trigger switch.

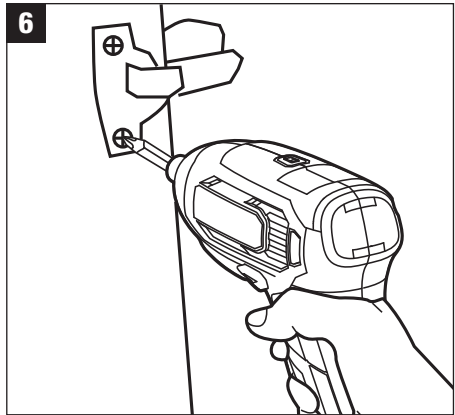

NOTICE: The screwdriver may also be used manually as a non-powered screwdriver when battery power has been depleted.

⚠ WARNING: Do not over-tighten, as the force of the screwdriver can break the fastener . Keep the screwdriver at a right angle to the fastener to avoid damaging the fastener head .

CARE AND MAINTENANCE

General Maintenance



WARNING: When servicing, use only identical replacement parts. Use of any other parts could create a hazard or cause product damage.

Periodically inspect the entire product for damaged, missing, or loose parts such as screws, nuts, bolts, caps, etc. Securely tighten all fasteners and caps and do not operate this product until all missing or damaged parts are replaced. Please contact customer service or an authorized service center for assistance.

Cleaning

- a. Avoid using solvents when cleaning plastic parts. Most plastic parts are susceptible to damage from various types of commercial solvents and may be damaged by their use. Use clean cloths to remove dirt, carbon dust, etc.
- b. The tool may be cleaned most effectively with compressed dry air. Always wear safety goggles when cleaning tools with compressed air. Ventilation openings and switch levers must be kept clean and free of foreign matter. Do not attempt to clean by inserting pointed objects through openings.

Storage

Store the tool indoors in a place that is inaccessible to children. Keep away from corrosive agents.

TROUBLESHOOTING

Suspected malfunctions are often due to causes that the users can fix themselves. Therefore, check the product using this section. In most cases the problem can be solved quickly.

! WARNING: Only perform the steps described within these instructions! All further inspection, maintenance and repair work must be performed by an authorised service centre or a similarly qualified specialist if you cannot solve the problem yourself!

PROBLEM	POSSIBLE CAUSE	CORRECTIVE ACTION
Tool does not work.	Battery is depleted.	Charge the battery.
	Tool is over-loaded.	Release the trigger switch and try again.
	Battery is over-temperature.	Turn off the tool and allow the tool to cool.
	Burned out switch.	Have the tool replaced by an Authorized HAMMERHEAD Service Center or Service Station.
Bit cannot be installed.	Something is stuck in the bit holder.	Clean the bit holder.
	Bit does not fit the holder.	Use suitable bit or adapter.



To preserve natural resources, please recycle or dispose of batteries properly. This product contains lithium-ion batteries. Local, state, or federal laws may prohibit disposal of lithium-ion batteries in ordinary trash. Consult your local waste authority for information regarding available recycling and/or disposal options.

WARRANTY

This screwdriver is warranted to the original purchaser from the original purchase date for 24 Months, Hammerhead consumer portable power tool models will be free from defects in material or workmanship for a period of ninety days if the tool is used for professional use. Please retain your receipt.

This screwdriver is warranted to the original user to be free from defects in material and workmanship. If you believe that the screwdriver is defective at any time during the specified warranty period, call HAMMERHEAD support at 1-877-888-1880 to speak with a customer service agent. This warranty does not cover: (1) Part failure due to normal wear or tool abuse; (2) any parts have been altered or modified by anyone other than an authorized HAMMERHEAD personnel.

This warranty excludes bits, bulbs and accessories. This warranty gives you specific legal rights, and you may also have other rights that vary from state.