

# VACTIDY

---



VACTIDY

---

## APP Connection Guide

TO EXPERIENCE ALL ADVANCED FEATURES,  
IT IS RECOMMENDED TO CONTROL YOUR  
Nimble T6 VIA THE **Vactidy** APP.

# VACTIDY

## 1. How to Connect your Nimble T6 with the Vactidy APP

Before you start, make sure that:

- 🌸 Your Nimble T6 is on and ensure it is charging in the charging dock .
- 🌸 Your smartphone is connected to a **2.4GHz** Wi-Fi network. If your router is a dual-band router, please select the **2.4GHz** network.
- 🌸 The WiFi name and password are correct and avoid using an emoji or special characters or symbols.
- 🌸 Keep the Nimble T6 and your mobile device as close as possible to the router when connecting.

### 1.1 APP Download and Installation

Search for **Vactidy** APP on App Store (IOS devices) or Google Play (Android devices).

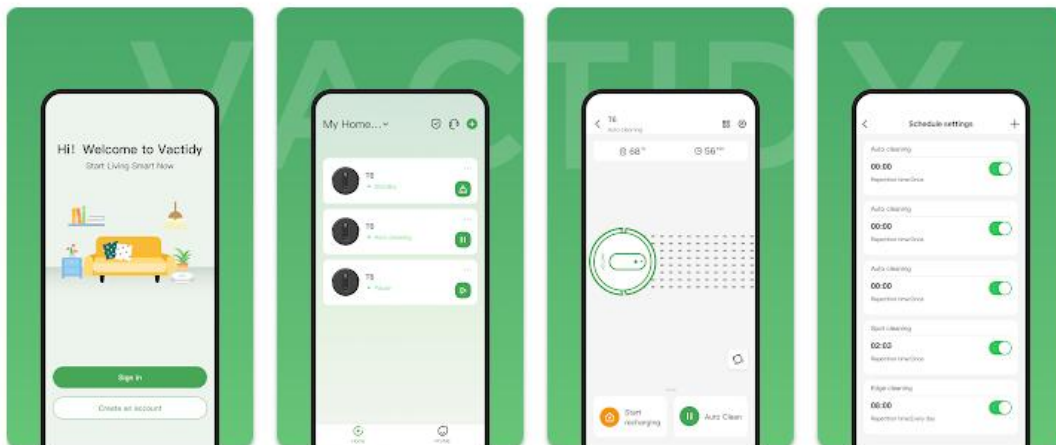

## 1.2 WiFi Connection

A. Open the APP and create a new account at your first use, and then log in your account.

(Please agree the Terms and Conditions for the connection.)

B. Click “Add advice” and select the model of your Nimble T6.

C. Press and hold the button “” for 5 seconds until the WiFi indicator light is flashing blue.

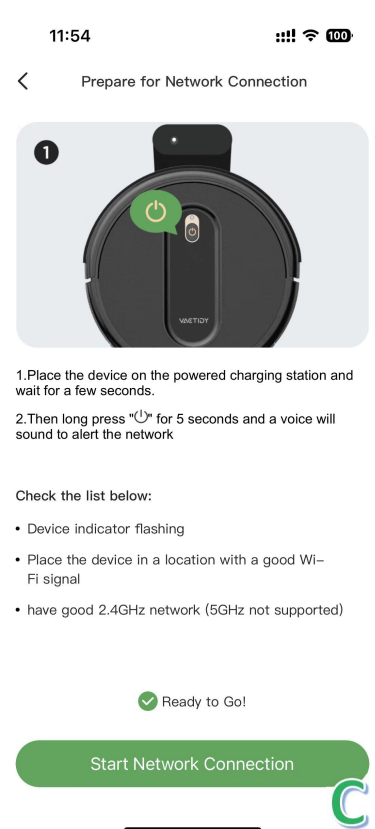
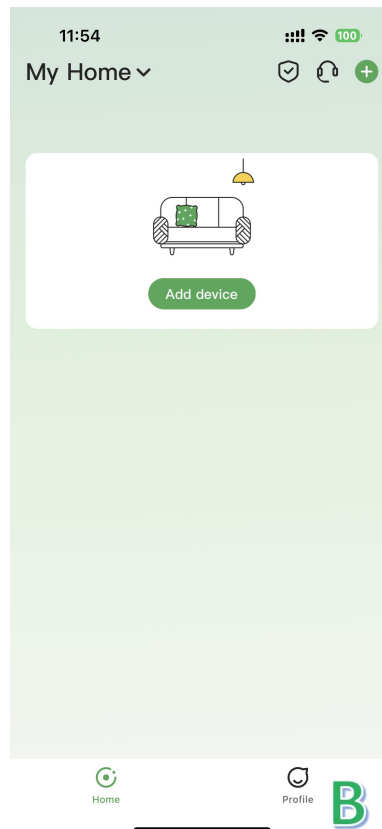
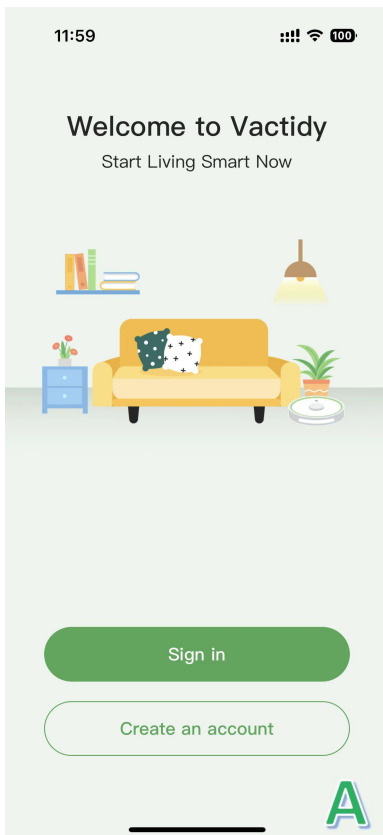

# VACTIDY

## 1.2 WiFi Connection

- D. Select the same 2.4GHz WiFi as your smartphone is connecting and enter the WiFi password.
- E. Go to WiFi setting page to connect to the Nimble T6's WiFi named "SL-Vactidy-XXXX".
- F. Go back to Vactidy APP and complete the WiFi connection.

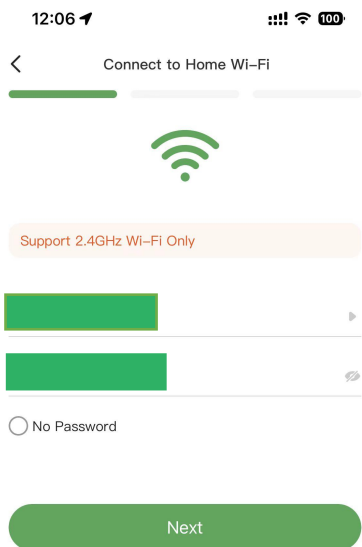

D

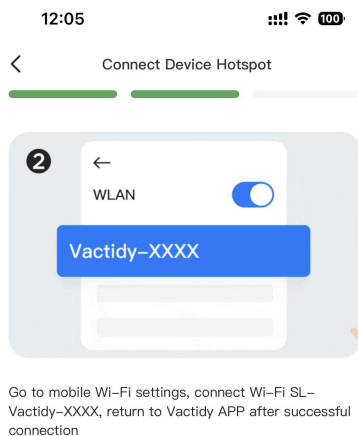

E

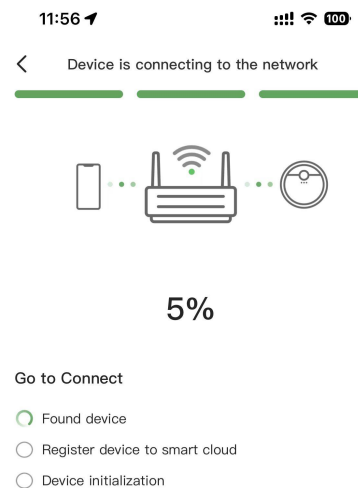

F

Wi-Fi in Use 普森科技\_5G

Connect

## 2. How to Control your Nimble T6 with the Alexa

### Before you start, make sure that:

- 🌸 Your Nimble T6 is on and ensure it has enough power during setup.
- 🌸 Your Nimble T6 is successfully connected to Vactidy APP.
- 🌸 You already have a device that can use Alexa, such as the Amazon Echo Dot.
- 🌸 The Amazon Alexa APP has been installed on your smartphone and connected to the Wi-Fi network.

### 2.1 Alexa Connection

- Open Vactidy APP and Click the “Profile”.
- Click “Amazon Alexa”.
- Click “Login to Amazon account”, and it will jump to the Alexa APP.

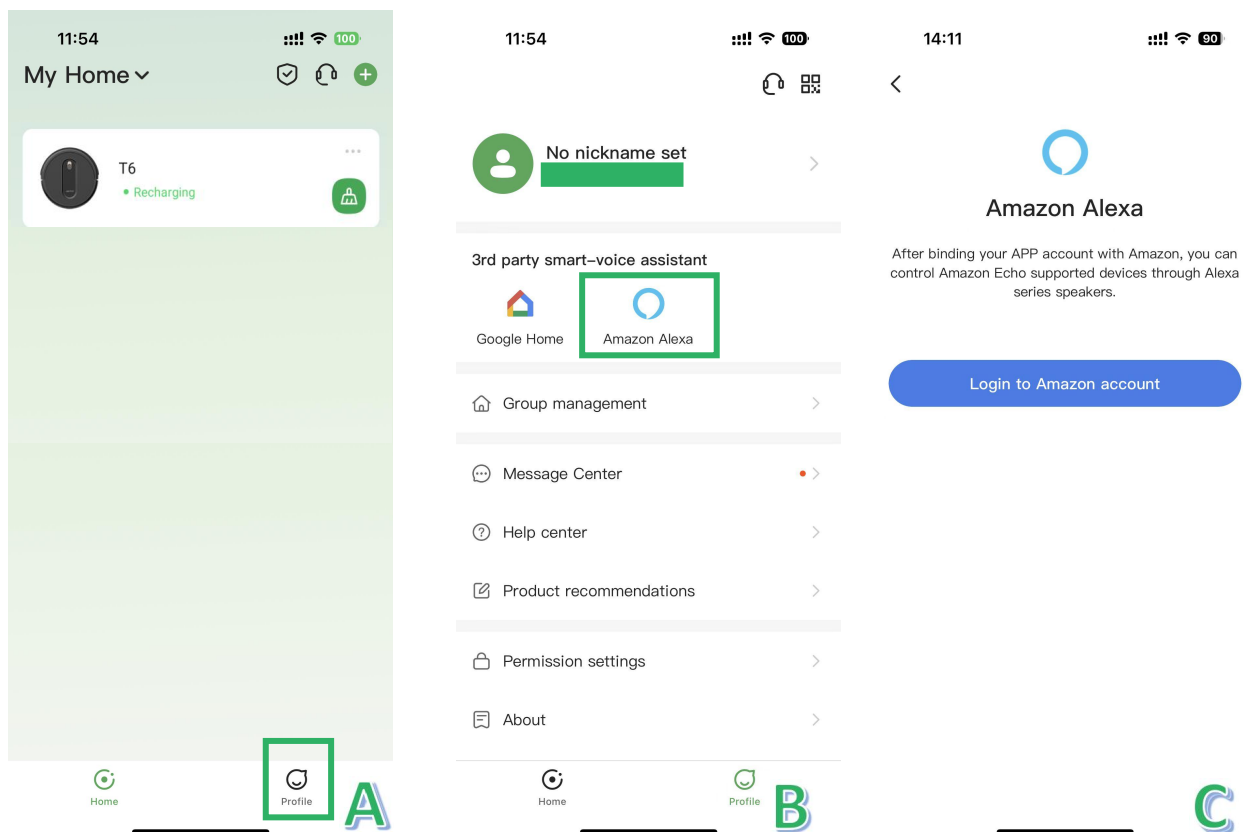

# VACTIDY

## 2.1 Alexa Connection

D. Click “LINK” to enable the Vactidy skill.

E. After the authorization is done, it’s linked to Alexa successfully.

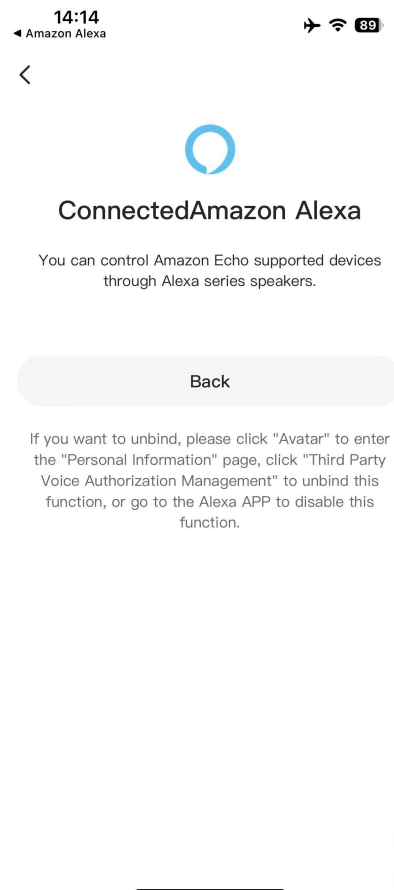
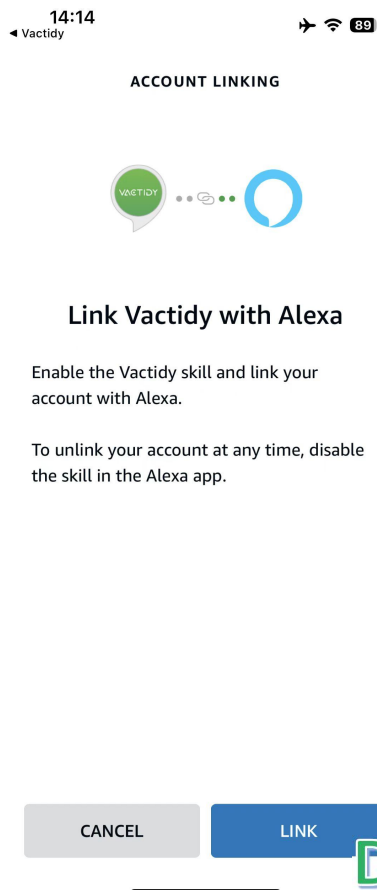

## 2.2 Alexa Voice Command

### Switch On/Off

- 🌸 Alexa, turn on <device name>
- 🌸 Alexa, turn off <device name>

### 3. Troubleshooting

 The Nimble T6 is not able to connect to the WiFi network.

- \* Make sure you entered the Wi-Fi password correctly .
- \* Make sure your Nimble T6, router, and mobile phone are close enough to ensure a strong signal strength.
- \* Make sure your Wi-Fi router supports the 2.4GHz, the 5GHz band is not supported.

 The Nimble T6 is not able to be controlled with Amazon Alexa.

- \* Please check the network connection of your mobile device.
- \* Make sure you've connected the robot to Vactidy APP.
- \* Make sure your robot has been discovered in Alexa APP.
- \* Make sure you are using correct Alexa voice-commands.

# VACTIDY

## 4. APP Online Customer Service

- 🌸 If you have any questions or suggestions, please feel free to contact us.
- 🌸 The online customer service team will answer you as soon as possible.

### 5.1 How to contact the APP Online Customer Service

- Open Vactidy APP and Click the “🎧”.
- Click “Start a conversation” to start the online chat.

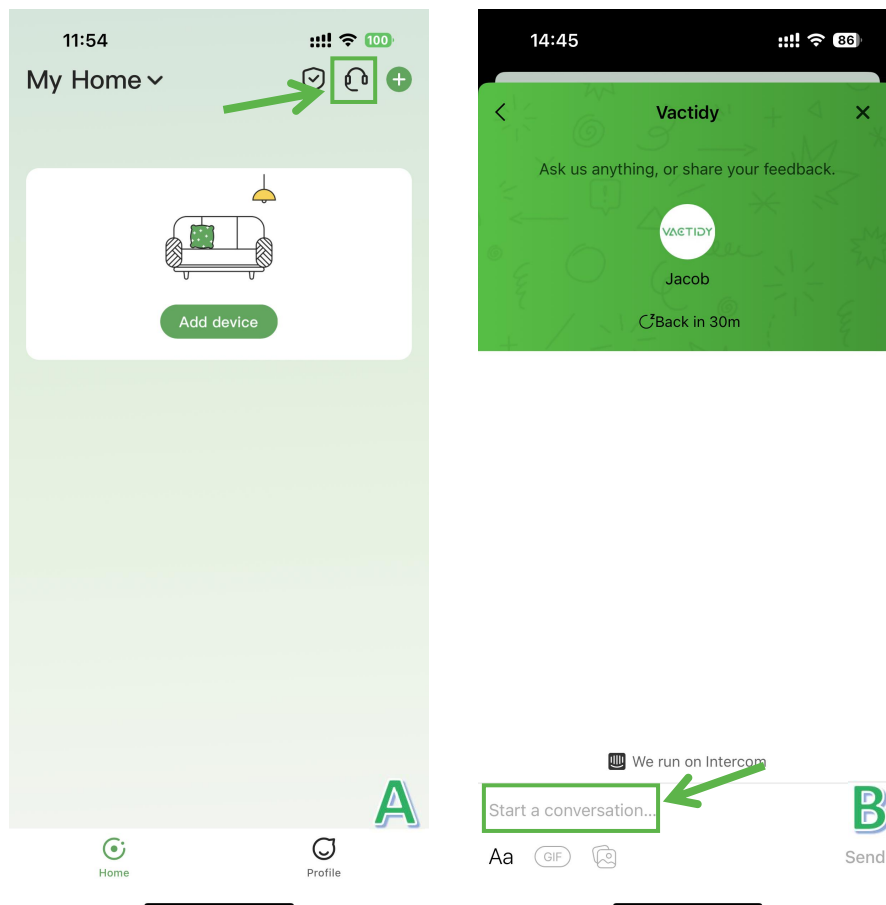

# VACTIDY

## 5. Vactidy After-Service Contact

	Service Email	Telephone
United States	Service-us@vactidy.com	+1(833) 313 1310
Canada	Service-ca@vactidy.com	Mon-Fri. 5.30am-2.30pm (Eastern Time)
United Kingdom	Service-uk@vactidy.com	+44 (0)808 273 7688  (English only) Mon-Fri. 11.30am-8.30pm (Central European Time)
Deutschland	Service-de@vactidy.com	
France	Service-fr@vactidy.com	
Italia	Service-it@vactidy.com	
España	Service-es@vactidy.com	
日本	Service-jp@vactidy.com	050-5533-2720
Other Countries	Service@vactidy.com	/