

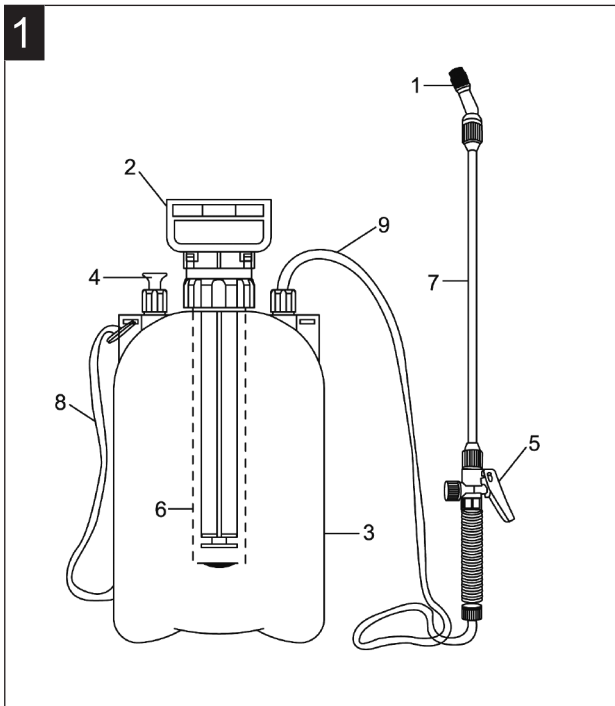

SPEAR & JACKSON

Basic user instructions for: 5LPAPS, 5LPAPSTWIN and 8LPAPS



Parts List:

- | | | |
|----------------------------|-----------------|----------|
| 1. Adjustable Spray Nozzle | 4. Safety Valve | 7. Lance |
| 2. Pump Handle | 5. Trigger | 8. Strap |
| 3. Spray Bottle | 6. Pump | 9. Hose |

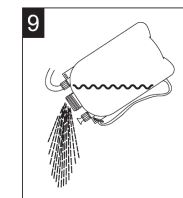
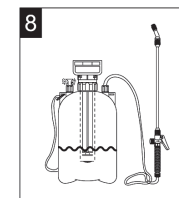
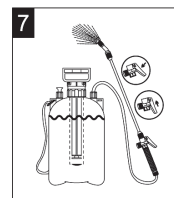
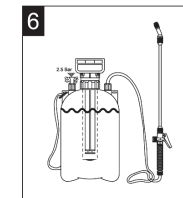
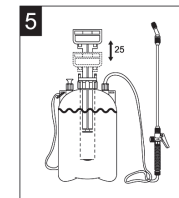
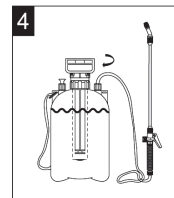
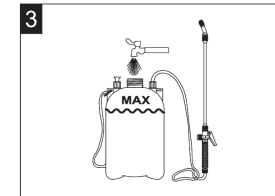
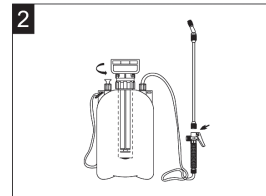

Step:

1. Attach the nozzle by screwing it on in a clockwise direction.
2. Unscrew the pump handle in an anticlockwise direction.
3. Fill with the desired liquid to the max fill line as shown on bottle.
4. Screw the pump handle back down in a clock wise direction.
5. Pump the sprayer about 25 times.
6. The safely vavle will leak if the air pressure in too high.Do not over fill with air or liquid.
7. The sprayer will work when the trigger on the nozzle handle is depressed.To spray continuously, slide the trigger forward into lock position after depressing. To unlock, siide the trigger back.
8. Release pressure from bottle after using by slowly pulling the safety valve a quarter of a turn.
9. Empty the water from bottle after using by unscrew the pump handle and pouring the water out.