

# raydrop

Feel the air of love around you.

# raydrop Humidifier

USER MANUAL

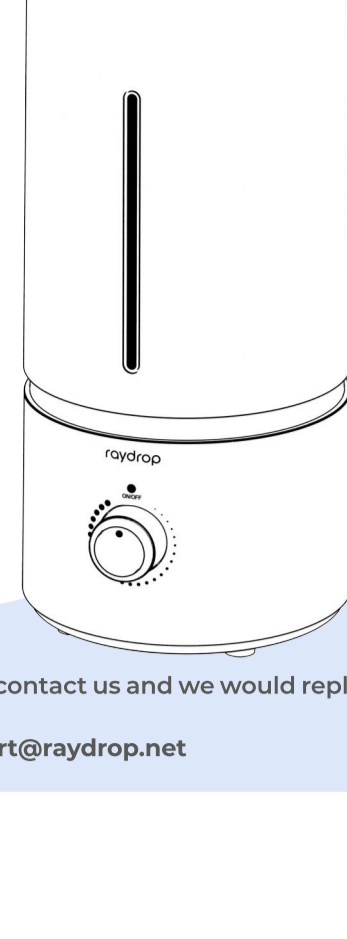

Need any help?  
Please feel free to contact us and we would reply within 1 working day.  
Contact Us: support@raydrop.net

## TABLE OF CONTENTS

- PACKAGE CONTENTS ..... 01
- SAFETY INFORMATION ..... 02
- SPECIFICATIONS ..... 03
- PRODUCT DIAGRAM ..... 04
- FUNCTIONS ..... 05
- GETTING STARTED ..... 06
- IMPORTANT TIPS ..... 07
- CARE & MAINTENANCE ..... 08
- TROUBLESHOOTING ..... 11
- WARRANTY ..... 13
- CUSTOMER SUPPORT ..... 13

## raydrop

Feel the air of love around you.

Thank you for choosing our humidifier. Please read the following instructions carefully before use!

## PACKAGE CONTENTS



## SAFETY INFORMATION

**▲**To reduce the risk of fire, electric shock, or other injury, follow all instructions and safety guidelines.

### General Safety

- Disassembly, repair or remodeling by an unauthorized person may result in serious harm and will void the manufacturer's warranty.
- If the humidifier is damaged or is not functioning properly, stop using it and contact Customer Support immediately.
- Please always keep the humidifier out of reach of children & pet.
- Do not use the humidifier in wet environments.
- Always place the unit 12 inches (30 cm) away from the wall other appliances or wooden furniture.
- Do not handle the plug with wet hands.
- Please check the cord for any signs of damage. DO NOT use the humidifier if the cord has been damaged.
- Do not move the nozzle while the humidifier is working.
- Do not cover or tilt the humidifier while it is in operation.
- Do not fill the water tank with hot or boiling water.
- Do not use this product in direct sunlight or near a heat source such as a stove, heater or radiator.
- Use clean or distilled water in tank. Hard water areas will require more frequent cleaning.

## SPECIFICATIONS

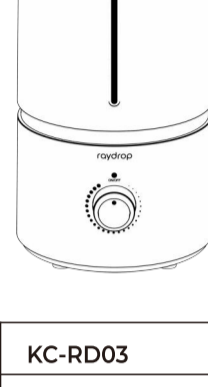

Model	KC-RD03
Rated Voltage	110V
Capacity	0.45gal(1.7L)
Rated Power	18W
Noise Level	≤32dB
Dimensions	5.7*5.1*11.0inches(14.5*13*28cm)
Net Weight	1.68lbs(0.76kg)

## PRODUCT DIAGRAM

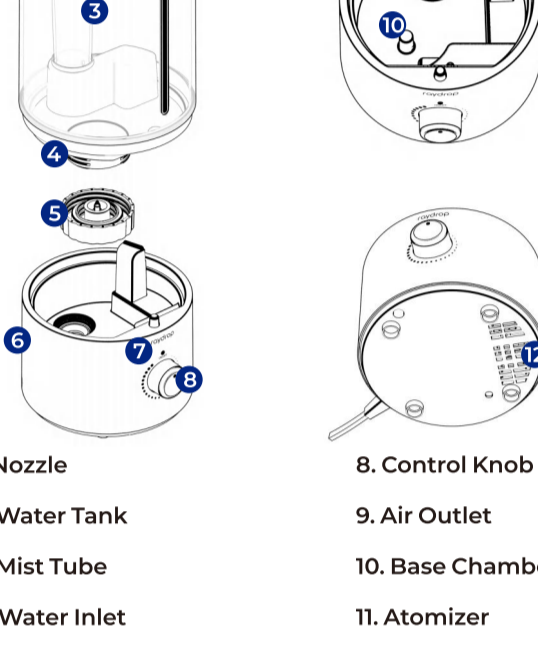

- 1. Nozzle
- 2. Water Tank
- 3. Mist Tube
- 4. Water Inlet
- 5. Tank Cap
- 6. Base
- 7. Indicator
- 8. Control Knob
- 9. Air Outlet
- 10. Base Chamber
- 11. Atomizer
- 12. Air Inlet

## FUNCTIONS



### Power On/Off & Mist Level Setting

1. Plug in the humidifier.
2. Power On: Turn the knob dial all the clockwise until it 'click' to turn on the humidifier. The indicator light would be green and produce mist.
3. Mist Level Setting: Rotate the knob dial to adjust the mist level.
4. Power Off: Turn the knob dial counter clockwise, the machine will stop working and indicator light turn off.

### Auto Shut-off

When the humidifier runs out of water, it would stop producing mist and the indicator light turns red.

## GETTING STARTED

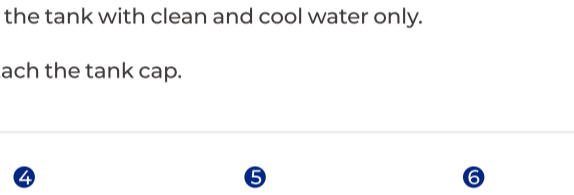

1. Turn the water tank upside down and remove the tank cap.
2. Fill the tank with clean and cool water only.
3. Attach the tank cap.



4. Turn the tank over to place on humidifier base.
5. Plug in the humidifier.
6. Rotate the control knob clockwise to turn it on.

## IMPORTANT TIPS

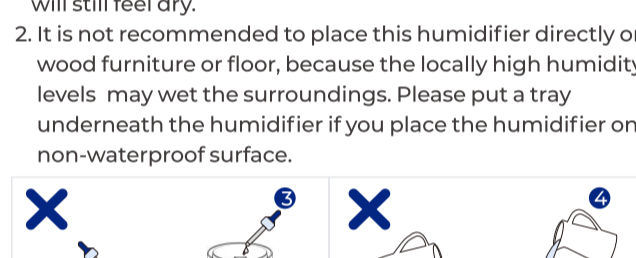

1. Please always place this humidifier on a firm, flat & water-resistant surface at least 2-4 feet above the floor. Placing a humidifier in a corner, on the floor, or near a wall will get localized higher humidity levels but the rest of the room will still feel dry.
2. It is not recommended to place this humidifier directly on wood furniture or floor, because the locally high humidity levels may wet the surroundings. Please put a tray underneath the humidifier if you place the humidifier on a non-waterproof surface.

3. Do not add water into the base or through the nozzle.
4. Do not add essential oils into the water tank or base chamber. Essential oils will corrode the humidifier, causing the water tank or base to crack.
5. Do not place this product on cloth, carpet. This may block air inlet.

## CARE & MAINTENANCE

- To keep your humidifier running efficiently, clean it regularly. Weekly cleaning is recommended. All maintenance should be done in the kitchen or bathroom on a water-resistant surface near a faucet.
- In some areas, tap water is richer in minerals. The humidifier won't instantly go haywire if you do use tap water, but in the long term, this may cause scale, pink mold, or 'slime' forming in the tank, you need to maintain it more often. Distilled or purified water is the best option to keep your machine running at optimum performance.
- Change the water daily to avoid bacteria growth.

### CAUTION

- Never immerse the humidifier base in water.
- Make sure water does not enter the base through the air outlet and air inlet.



## Cleaning & Descaling



1. Turn off and unplug the humidifier.
2. Remove the water tank from the base and remove the tank cap. Drain water from the water tank and base.

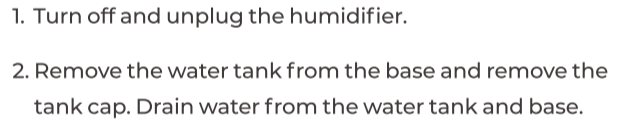

3. Fill the water tank halfway. Add one to two cups of undiluted distilled white vinegar (add or reduce acetum according to the severity of scaling). Attach the tank cap and shake the tank for 5 seconds.
4. Place the tank on the base. The vinegar solution will enter the base chamber to loosen mineral buildup (scale) on the atomizer and the bottom of the water tank. Soak for 15-20 minutes.

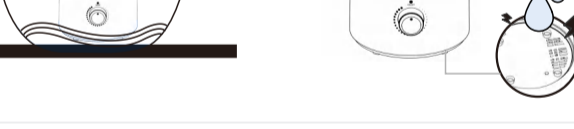

5. Remove the tank and pour out any solution. Clean the atomizer with a soft cloth or cotton swab to remove loosened mineral deposits. (The mist tube or corners that are out of reach can be cleaned with the included brush)
6. Rinse all parts until any vinegar smell is completely gone.

### End of Season Storage

- Follow the Cleaning & Descaling instructions when the humidifier will be stored at the end of the season.
- Dry the humidifier completely before or after tank. DO NOT store with water inside the base or water tank.
- Store in a cool, dry location.

## TROUBLESHOOTING



Problem	Possible Cause
Indicator light turn red.	Not enough water inside the base chamber. Fill the water tank. Tighten the water tank cap.
Water leaks from the humidifier.	The rubber ring was not installed on tank cap. Check the tank cap for rubber ring. If it is missing, please contact Customer Support. (see page 13). Leak from TANK: Check for possible cracks in the tank or around the seam of the tank. Leak from BASE: Contact Customer Support (see page 13).
Humidifier doesn't turn on. (Indicator light doesn't turn on)	Ensure unit is properly plugged into a power outlet / try another power outlet.

Problem	Possible Cause
Humidity level is low or no mist comes out.	Turn the mist level to a higher setting.
	Mineral buildup on atomizer. Clean atomizer (see Cleaning & Descaling, page 9).
	Make sure the air inlet on the bottom of the base is not blocked. The humidifier should not be set on carpet or other surfaces that may block the air inlet.
	Make sure the nozzle is not blocked or clogged.
	Make sure the humidifier is on a level surface.
Condensation forms around humidifier.	Water in unit is too cold: Replace with cool water.
	Saturation of humidity: Lower mist control setting.
Mold grows inside the humidifier, or white dust appears around the humidifier.	Point mist away from objects: Raise unit on a water-resistant level surface 2-4 feet off of floor.
	Use purified or distilled water to fill the humidifier. Avoid using water with high mineral content.
Humidifier produces an unusual smell.	Clean the water tank and base chamber (see Cleaning & Descaling, page 9).
	Bubbling or knocking sounds is normal, that is the sound of water moving from the water tank to the base.
Humidifier makes a loud or unusual noise.	If it is continuous motor noise, the humidifier may be malfunctioning. Stop using the humidifier and contact Customer Support. (see page 13)

## WARRANTY

This humidifier comes with an 1 Year Warranty that begins on the date of purchase.

Raydrop will replace any product found to be defective due to manufacturer flaws based on eligibility.

This warranty is void if the defect is due to any damages, losses, or inconveniences caused by equipment failure by user negligence, abuse, or use noncompliant with the user manual or any additional safety, use, or warnings included in the product packaging and manual.

## CUSTOMER SUPPORT

If you encounter any issues or have any questions regarding your new product, feel free to contact our helpful Customer Support Team.

**Contact Us:**  
support@raydrop.net

\*Please have your order ID ready before contacting Customer Support.