

NETGEAR®

Connect with Innovation™

Powerline Nano500 Set XAVB5101 Installation Guide



© 2012 NETGEAR, Inc. All rights reserved.

No part of this publication may be reproduced, transmitted, transcribed, stored in a retrieval system, or translated into any language in any form or by any means without the written permission of NETGEAR, Inc.

DO NOT stack equipment, or place equipment in tight spaces or in drawers. Be sure your equipment is surrounded by at least 2 inches of air space.

Technical Support

Thank you for choosing NETGEAR. To register your product, get the latest product updates, or get support online, visit us at <http://support.netgear.com>.

Phone (US & Canada only): 1-888-NETGEAR

Phone (Other Countries):

See http://support.netgear.com/app/answers/detail/a_id/984.

Trademarks

NETGEAR, the NETGEAR logo, and Connect with Innovation are trademarks and/or registered trademarks of NETGEAR, Inc. and/or its subsidiaries in the United States and/or other countries. Information is subject to change without notice. Other brand and product names are registered trademarks or trademarks of their respective holders. © 2012 NETGEAR, Inc. All rights reserved.

Statement of Conditions

In the interest of improving internal design, operational function, and/or reliability, NETGEAR reserves the right to make changes to the products described in this document without notice. NETGEAR does not assume any liability that may occur due to the use or application of the product(s) or circuit layout(s) described herein.

Package Contents

**XAV5101
Powerline
Adapters**

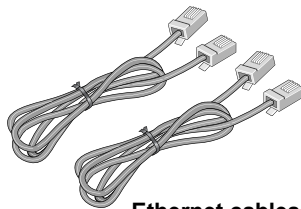

Ethernet cables (2)

**Products sold in some
locations include a
Resource CD.**

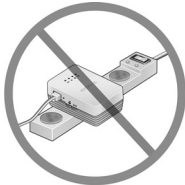
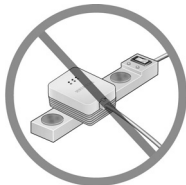



WARNING!!

**Do not plug
Powerline devices
into a power strip.**

LED Descriptions





The LEDs indicate the status of your Powerline adapters.

- When you plug in the adapter, the Power LED  lights up and turns green.

The adapter is not active when no Ethernet link has occurred for more than 10 minutes. The adapter enters power saving mode, and the Power LED turns amber .

- The Powerline LED turns on when the adapter detects at least one other compatible Powerline device.

The Pick A Plug feature lets you pick the electrical outlet with the strongest link rate, indicated by the color displayed by the Powerline LED:

-  Green: Link rate > 80 Mbps (Best)
-  Amber: Link rate > 50 and < 80 Mbps (Better)
-  Red: Link rate < 50 Mbps (Good)
- The Ethernet LED  lights up when you connect a powered-on Ethernet device to at least one Ethernet port.

Button Descriptions

The buttons on your Powerline adapters let you do the following:

- **Factory Reset** — Use the Factory Reset button to return your Powerline device to its default factory settings. Press and hold the **Factory Reset** button for an interval between 1 and 5 seconds, and then release it.
- **Security button** — Use the Security button to set the security between Powerline devices. Press and hold the **Security** button for an interval between 2 and 5 seconds, and then release it.

For more about security settings, see [*Install Your Powerline Adapters*](#) on page 7.

Install Your Powerline Adapters

Set up a secure Powerline network with two Powerline adapters.

Step 1.

Plug in the two Powerline adapters.



Step 2.

On each adapter, press the **Security** button for > 2, but < 5 seconds, and then release. The Powerline LED starts blinking.

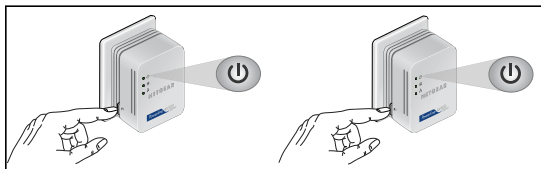

The Power LED stops blinking. The Powerline LED turns on. Security pairing is done.

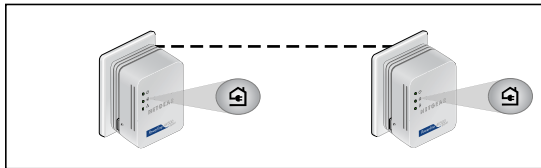

Add a new Powerline adapter to the secure Powerline network.

Step 1.

Plug in the new adapter.

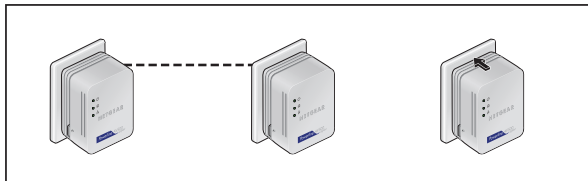

Step 2.

Press the **Security** button on the new adapter and on one of the existing adapters. The Power LED starts blinking.

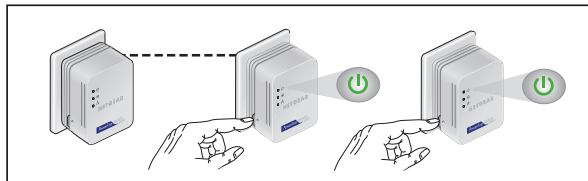

The Power LED stops blinking. The Powerline LED turns on. The new adapter joins the network.

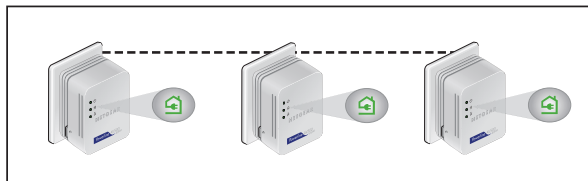

Technical Support

Thank you for selecting NETGEAR products.

After installing your device, locate the serial number on the label of your product and use it to register your product at <https://my.netgear.com>.

Registration is required before you can use the telephone support service. Registration through the NETGEAR website is strongly recommended.

Go to <http://support.netgear.com> for product updates and web support.

For additional information about setting up, configuring, and using your Powerline adapter, see the *User Manual*.

Compatible NETGEAR Powerline Devices

Your Powerline adapter can share a Powerline network with these compatible NETGEAR devices: XAV101, XAV1004, XAV2001, XAV1101, XAV1301, XAV1601, XAV2501, XAV2602, XAV5001, XAV5501, XAV5601, and XAV5004.

For a complete list of HomePlug AV certified devices, go to www.homeplug.org/certified_products.

Compliance

Declarations of Conformity

For complete DoC please visit the NETGEAR EU Declarations of Conformity website at: http://support.netgear.com/app/answers/detail/a_id/11621/.

For GNU General Public License (GPL) related information, please visit http://support.netgear.com/app/answers/detail/a_id/2649.

WARNING: Do not stack equipment or place equipment in tight spaces, in drawers, or on carpets. Make sure your equipment is surrounded by atleast 2 inches of air space.



This symbol is placed in accordance with the European Union Directive 2002/96 on the Waste Electrical and Electronic Equipment (the WEEE Directive). If disposed of within the European Union, this product should be treated and recycled in accordance with the laws of your jurisdiction implementing the WEEE Directive.

NETGEAR, the NETGEAR logo, and Connect with Innovation are trademarks and/or registered trademarks of NETGEAR, Inc. and/or its subsidiaries in the United States and/or other countries. Information is subject to change without notice. Other brand and product names are trademarks or registered trademarks of their respective holders.
© 2011 NETGEAR, Inc. All rights reserved.

NETGEAR, Inc.
350 East Plumeria Drive
San Jose, CA 95134, USA

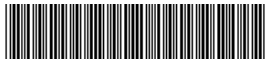

201-14324-02

January 2012