

USER GUIDE ZYC8A

Bazyths



www.bazyths.com

ENJOY YOUR NEW BAZYTHS SMART TOILET

Please contact Bazyths Support if you have any questions.

Contact Information:

support@bazyths.com

How to Use the Foam Shield Function	1
Introduction to the Foam Shield Function	1
How to Get Your Free Foam Shield Liquid	1
Replace the Foam Shield Bottle	1
Toilet Bowl Cleaner Tablets Installation Instructions	2
Panel instruction	3
Remote Control Panel	3
Remote Control Pairing Instructions	3
Main Unit Control Panel	4
Main Unit Display Screen	4
How to Use	6
When sitting on the seat	6
Start Rear cleansing or Front cleansing Function	6
When standing up from the seat	6
Function Setting and Adjustment	7
How to Turn On/Off the Radar Sensor Function	7
How to Adjust the Radar Sensor Distance	7
Lid\Seat Open	7
Anema\Aperient	8
Rear Wash	8
Feminine Wash	9
Wash Water Pressure Adjustment	9
Wash Nozzle Position Adjustment	9
Wash Water Temperature Adjustment	9
Hot and Cold Massage	10
Child Wash	10
Drying Function	10
Drying Temperature Adjustment	10
Seat Temperature Adjustment	11
Night Light	11
Nozzle Self-Cleaning	11
Power Button	11
Remote Flush	11
Manual Flush	11
Foot Sensor Flush	12
Foam Shield	12
Blue Toilet Cleaner Tablets Function	12
Smart Seat Temperature	12
Power-Outage Flushing	13
Cleaning and Maintenance	14
Clean and Maintain the Power Plug	14
Clean and Maintain the Main Unit of the Smart Toilet	14
Clean and Maintain the Ceramic Part of the Smart Toilet	14

How to Use Foam Shield & Toilet Bowl Cleaner Tablets

■ Introduction to the Foam Shield Function

The Foam Shield creates a soft foam layer inside the toilet bowl that prevents splashing, blocks odors, and keeps the bowl cleaner. It is an innovative feature designed to enhance hygiene and provide a more comfortable and pleasant bathroom experience.

■ How to Get Your Free Foam Shield Liquid

For transportation safety, the foam liquid is not pre-filled in the foam shield bottle. After receiving your toilet, please contact us at support@bazyths.com to request the foam liquid. Your first bottle is completely free, and we will ship it to you separately.

■ Replace the Foam Shield Bottle

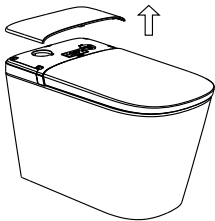

1. Hold both hands together on the left and right sides of the decorative cover, and lift it out vertically.

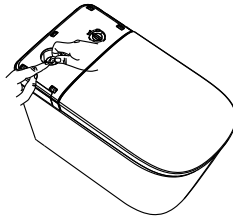

2. Press the connector cap and detach the soft tube.

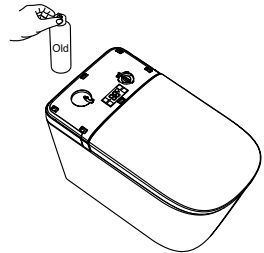

3. Remove the old bottle.

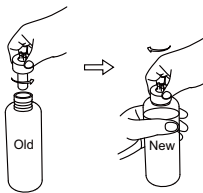

4. Take the connector head from the old bottle and attach it to the new bottle.

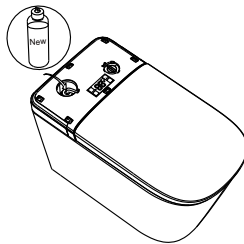

5. Place the new bottle back into the machine and reconnect the soft tube.

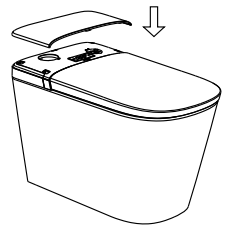

6. Secure the decorative cover back in place.

Note: Regardless of whether you use the Foam Shield function, please ensure that a foam liquid bottle is placed here and that the soft tube is connected to the bottle. Without a bottle, water leakage may occur.

■ Toilet Bowl Cleaner Tablets Installation Instructions

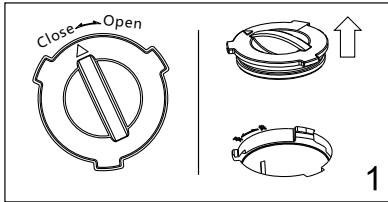

1. Turn the arrow on the lid to "Open" and lift the lid.

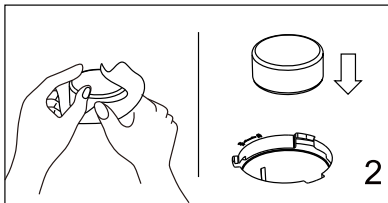

2. Remove the "water-soluble film" from the cleaner tablet.  (Failure to do so may clog the pipes). Then place the cleaner tablet (Diameter $\leq 45\text{mm}$, Thickness $\leq 20\text{ mm}$) into the mixing chamber.

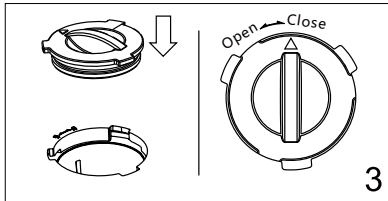

3. Close the lid and turn the arrow to "Close."  (Flushing is not allowed if the lid is not properly closed).

Note: Due to shipping restrictions, we are temporarily unable to provide toilet cleaner tablets. Please purchase them locally.

Panel Instruction

This product is designed primarily for remote control operation, with main unit panel operation as a supplement.

■ Remote Control Panel

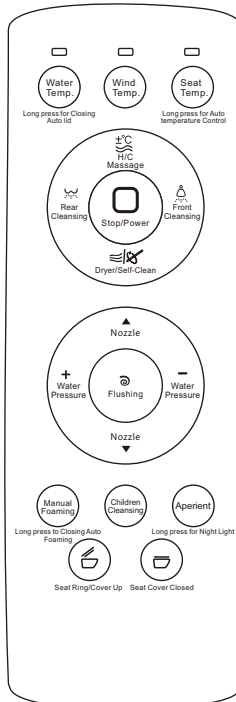

● Remote Control Pairing Instructions:

1. Press and hold the side "Rear Wash" button for 3 seconds. The display will flash once, accompanied by a beep.
2. Press and hold the side "Rear Wash" button again for 3 seconds. The display will start flashing, and the beeper will sound, indicating the system has entered pairing mode (the pairing mode will automatically exit after 15 seconds if no action is taken).
3. In pairing mode, briefly press the "Stop" button on the remote control. The display will stop flashing, and the beeper will stop sounding, indicating the pairing was successful.

◆ Main Unit Control Panel

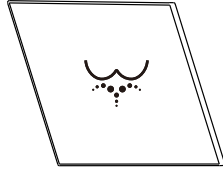

Rear Wash

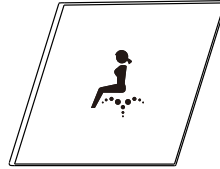

Front Wash

- In the seat-off state, press the front wash or rear wash button to activate manual flushing.
- In the seated state, press the rear wash button to start the one-press rear wash mode, press again to enter drying mode. Press the front wash button to start the one-press front wash mode, press again to enter drying mode. Press and hold for 2 seconds to stop the function.

■ Main Unit Display Screen



 **Power Indicator Light:** Lights up when the main unit is powered on.

 **Temperature Level:** Displays the set temperature when the main unit is powered on.



Air Temperature Icon: Lights up when the temperature level shows the air temperature setting.



Seat Temperature Icon: Lights up when the temperature level shows the seat temperature setting.



Water Temperature Icon: When the icon is lit, the temperature level displays the water temperature setting.

- The digital display shows the set temperature; every 30 seconds, it cycles through water temperature, seat temperature, and air temperature.
- When the user leaves the toilet's sensing area, the display screen automatically turns off after approximately 30 seconds.

◆ Main Unit Ambient Light

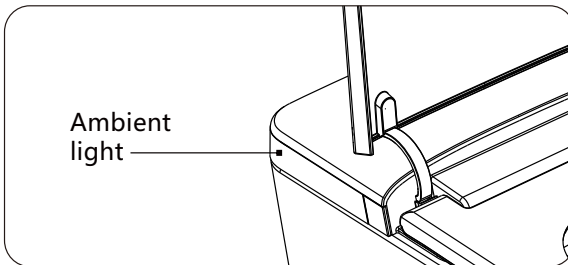

- Press and hold the nozzle position button on the remote control to turn the ambient light function on/off. When a user approaches the sensing area, the ambient light turns on, and it automatically turns off approximately 30 seconds after the user leaves the sensing area.

How to Use

■ When Sitting on the Seat

- Upon hearing the "beep" sound, the various functions of the smart toilet will start.
- The nozzle will clean itself automatically.

■ Start Rear Cleansing or Front Cleansing Function

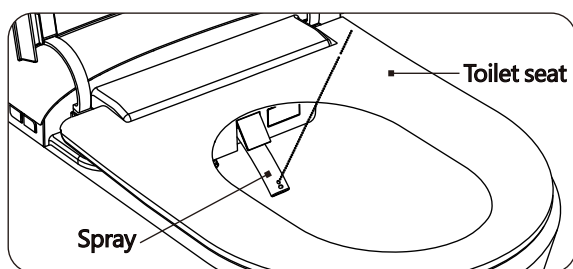

- Start the rear cleansing or front cleansing function by the remote control.
- Adjust the cleansing position and water pressure by the remonte control.
- Start the drying function by the remote control.
- Press "stop" button to stop the bidet function (rear cleansing, front cleansing or drying).

■ When standing up from the seat

- The toilet will auto flush once.

Function Setting and Adjustment

■ How to Turn On/Off the Radar Sensor Function

To turn this function on or off, press and hold Water Temperature button on the remote control for 5 seconds.

Note: When the radar sensor function is turned off, you can still use the foot kick to open the toilet lid and seat.

■ How to Adjust the Radar Sensor Distance

The radar sensor sensitivity on this model can be adjusted to control the detection range. By default, the sensor is set to level 7. You can reduce the sensitivity by lowering the level, which will decrease the detection range.

Adjustment Steps:

1. Turn off the power, then restart the smart toilet.
2. Within 30 seconds, press and hold the Feminine Wash button for 5 seconds to enter radar adjustment mode.
3. Press the Rear or Front button to adjust the radar sensitivity level.
4. Press the Stop button to confirm your selection.

■ Lid/Seat open

This product features an open lid and seat function. When a person approaches the toilet from the front, the foot sensor activates the open lid and seat function. You can also press the open lid and seat button on the remote control to open the lid and seat.

Foot Sensor Open Lid and Seat:

In the unseated state:

- When the seat and lid are in the low position, place your foot near the sensor area on the side of the toilet. The lid will open.
- When the lid is in the high position and the seat is in the low position, trigger the sensor again to open the seat.
- When both the lid and seat are in the high position, trigger the sensor again to close the lid and seat, and flush once (if the last operation already flushed, closing the lid will not flush again).

Remote Control Open Lid and Seat:

In the unseated state:

- Press the open lid and seat button on the remote control to activate the sequence: "Lid opens → Seat opens → Seat closes → Lid opens."
- Press the close button to lower both the seat and lid to the low position and flush once (if the last operation already flushed, closing the lid will not flush again).
- If both the seat and lid are already in the low position, pressing the close button will not trigger any action.
- **When the toilet is in operation (e.g., rear wash, feminine wash, flushing), the open lid and seat function will be temporarily disabled.**

■ Enema/Aperient

This product includes an enema function for bowel relief, using a single nozzle for effective cleansing.

- Press the Enema button on the remote control to activate the enema mode. Water will be sprayed from the single nozzle.
- While seated, press the enema button to start the function. The main unit will emit a "beep" sound to indicate activation. You can press the stop button to end the function at any time.
- In enema mode, the water pressure is fixed. The nozzle position and water temperature are adjustable.

■ Rear Wash

This product features a rear wash function using a single nozzle for powerful cleaning.

Press the rear wash button on the remote control to activate the back-and-forth washing mode (nozzle moves back and forth), spraying water from the single nozzle.

In the rear wash state, press the nozzle position button on the remote control to switch to a fixed washing mode (nozzle stops moving). You can alternate between the two modes as needed.

- The rear wash function lasts for approximately 3 minutes and stops automatically. During the 3 minutes, you can switch to another function or press the stop button to end the cycle.

- The nozzle will automatically clean itself before and after the rear wash cycle.

■ Feminine Wash

This product features a feminine wash function, providing gentle cleansing with a dedicated nozzle for women.

- Press the Feminine Wash button on the remote control to activate back-and-forth cleansing mode (nozzle moves back and forth), releasing water from the dedicated feminine nozzle.
- During feminine wash mode, press the nozzle position button on the remote control to switch to fixed cleaning mode (nozzle stops moving). You can alternate between the two modes.
- The feminine wash function automatically stops after approximately 90 seconds. Within this 90-second period, you can switch to another function or press the stop button to end the cycle.
- The nozzle automatically cleans itself before and after the feminine wash cycle.

■ Wash Water Pressure Adjustment

In rear wash or feminine wash mode, press the wash intensity buttons (+/-) to adjust the water pressure according to your preference.

- There are 4 water pressure levels to choose from. When pressing the wash intensity buttons, the water pressure adjustment function is activated, allowing you to set your desired level.

■ Wash Nozzle Position Adjustment

In rear wash or feminine wash mode, press the nozzle position buttons (▲/▼) to move the nozzle forward or backward and adjust the cleaning position.

- There are 5 cleaning positions to choose from. When pressing the nozzle position buttons, the nozzle adjustment function is activated, allowing you to set the desired cleaning position.

■ Wash Water Temperature Adjustment

In rear wash or feminine wash mode, press the wash water temperature buttons (+/-) to adjust the water temperature to a comfortable level according to your preference.

■ Wash Water Temperature Adjustment

Press the Water Temperature button on the remote control, and the main unit will emit a "beep" sound to enter the water temperature setting mode. Adjust to the desired water temperature.

- There are 4 adjustable temperature levels: room temperature, high, medium, and low. Each press of the water temperature button switches to the next level.

■ Hot and Cold Massage

Press the Massage button on the remote control, and the water temperature alternates between hot and cold. The transition follows the set temperature levels. If the set temperature is room temperature, it alternates between the room temperature level and the set level.

■ Child Wash

Press and hold the Child Wash button on the remote control to activate child wash mode.

- Child wash does not require the user to be seated. It enters child wash mode, automatically adjusting the nozzle position, water temperature, and water pressure.

■ Drying Function

Press the Drying/Self-Cleaning button on the remote control to activate the drying function. The drying function focuses on drying the cleaned and wet areas.

- The drying function automatically stops after approximately 3 minutes. Within this 3-minute period, you can switch to another function or press the stop button to end the cycle.

■ Drying Temperature Adjustment

Press the Air Temperature button on the remote control, and the main unit will emit a "beep" sound to enter the air temperature setting mode. Adjust to the desired air drying temperature.

- There are 4 adjustable temperature levels: room temperature, high, medium, and low. After activating the drying function, press the drying button again to switch to the next temperature level.

■ Seat Temperature Adjustment

Press the Seat Temperature button on the remote control, and the main unit will emit a "beep" sound to enter the seat temperature setting mode. Adjust to the desired seat temperature.

- There are 4 adjustable temperature levels: room temperature, high, medium, and low. Each press of the seat temperature button switches to the next level.

■ Night Light

This product is equipped with a night light function, making it convenient for nighttime use.

- Press and hold the Night Light button on the remote control to turn the night light on or off. The soft light will illuminate or turn off accordingly.

■ Nozzle Self-Cleaning

Press and hold the Drying/Self-Cleaning button on the remote control, and water will flow continuously through the nozzle for cleaning.

- Nozzle self-cleaning is only effective when no one is seated.
- The nozzle self-cleaning cycle lasts for approximately 90 seconds. You can press the stop button to end the cleaning cycle at any time.

■ Power Button

Press and hold the Power/Stop button on the remote control to shut down the main unit system.

■ Remote Flush

Flush the toilet by pressing the Flush button on the remote control. This will activate a single flush.

- If flushing is performed while the washing function is active, the washing function will stop.

■ Manual Flush

When not seated, press the Rear Wash or Feminine Wash button on the main unit to activate a manual flush.

- If flushing is performed while the washing function is active, the washing function will stop.

■ Foot-Sensor Flush

Specially designed for men's convenience during urination. Without the need to bend down to find the button, lightly tapping the foot sensor will activate the flush (when the seat is in the raised position).

Capacitive Foot-Sensing Technology: This product uses capacitive sensing technology. Lightly tap the sensor area near the ceramic base with your foot to activate the function. The system will deactivate when your foot leaves the area.

■ Foam Shield

- Manual Activation: Press the Foam Shield button on the remote control to activate foam generation once.
- Automatic Activation: Foam is automatically generated once you are seated.
- Press and hold the Foam Shield button on the remote control for 3 seconds to turn the automatic foam function on or off.

■ Blue Toilet Cleaner Tablets Function

- Activated Mode: During the refill stage of each flushing cycle, blue cleaning liquid is mixed with water in the toilet bowl.
- Automatic Blue Cleaner Setting: Press and hold the Air Temperature button on the remote control for 5 seconds, and the main unit will emit two "beep" sounds to turn the blue toilet cleaner function on or off.

■ Smart Seat Temperature

The main unit defaults to smart seat temperature mode, automatically adjusting the seat temperature according to seasonal indoor temperatures.

- Press the Seat Temperature button on the remote control to cancel the smart seat temperature mode.
- Press and hold the Seat Temperature button for 3 seconds to re-enter smart seat mode or restore the smart seat temperature after a power reset.

■ Power-Outage Flushing

In the event of a power outage, press and hold the Feminine Wash button on the main unit for 3 seconds to activate the power-outage flushing function.

Cleaning and Maintenance

■ Clean and Maintain the Power Plug

Please clean the power plug regularly. When cleaning, remove the power plug from the outlet and wipe it with a dry cloth.

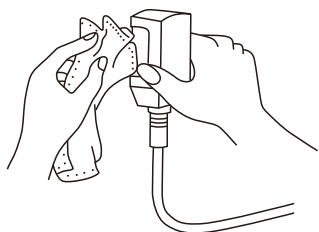

- Dust accumulation on the power plug may cause fire.

■ Clean and Maintain the Main Unit of the Smart Toilet

When cleaning the surface of the main unit, please wipe it with a soft, wet cloth.

- When cleaning and maintaining the smart toilet main unit, please pull the power plug out of the outlet to avoid any contact with water.
- If the surface has stubborn stains, you can use a soft, wet cloth with neutral kitchen detergent to clean it.

■ Clean and Maintain the Ceramic Part of the Smart Toilet

You can pour a neutral toilet cleaner onto a soft brush or sponge and use it to clean the ceramic part of the smart toilet. Rinse the area with tap water after cleaning.

- Do not use detergents or disinfectants that contain chlorine or are acidic.
- Do not use brushes that contain abrasive materials.

