

User Manual of MP3 Player

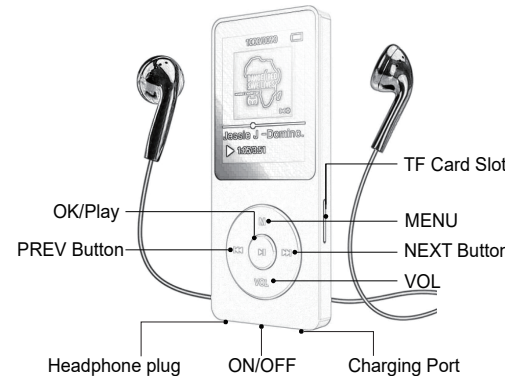

Dear User,
Thanks very much for your support to buy this MP3 player!
This MP3 player is designed to provide a convenient method to let you enjoy music anywhere and anytime.
Before using, please read the user manual carefully.

Safety Instructions:

In order to ensure that you can use this product safely, please read the following safety instructions and to operate it correctly; at the same time, please keep this manual carefully for later reference.

1. If the player enters a state of crash, please switch off the player then switch it on again.

2. Please do not disassemble and change the components and parts by yourself; if there is any damage in the product, please contact the professional maintenance personnel or specified maintenance center for maintenance.
3. Do not put the product in place where there is water or moist. Please keep the product dry.
4. Keep the product away from spatters of liquid and liquid.
5. Do not place the product near fire, such as candles or other bright flames.
6. When using the buttons, avoid excessive force resulting in damage to the product.
7. For cleaning products, use a dry soft cloth or a wet cloth that does not contain any corrosive solvents.
8. Do not use a high-power charger or a mobile power that with current of exceeding 2 amps to charge the player to avoid damage.

Button Instructions:

Power Button: Turn On/ Turn Off the player

M : Menu button, Function button

VOL : Return Button; Volume Button

<< : Left / Previous option; Previous track; Volume Down

>> : Right / Next option; Next track; Volume Up

>|| : OK; Play/ Pause

Let' s start the operation:

Turn on/ Turn Off the player

Please toggle the power button to power on or power off the player.

I . Music:

In Music Interface:

- Press >|| button to start or pause playing.
- Shortly press |<< or >>| button to switch to previous or next song.
- Long press |<< or >>| button to rewind or fast forward playing.

- Shortly press M button to enter into playlist. Press M again to select song options:

【Play, Refresh list; Add; Remove; Remove all; Setting】

- Long press M button to enter into Player settings, you could set playing modes:

【Repeat, Shuffle, Background Play, Lyrics Display】

- Shortly press VOL button to return to main interface.
- Long press VOL button to enter into Volume page, press |<< or >>| button to turn down or turn up the volume.

- Supported Audio Formats: MP3, WAV, FLAC, WMA, APE

How to display song lyrics?

When downloading songs, please download the lyrics at the same time onto the MP3 player. Note the lyric name must be same as the song name (eg. Song name: Love Story.mp3 and the corresponding name of lyric should be: Love Story.lrc). And Turn on the option of Lyrics Display in setting.

II Video

When enter into video function, you will see file list of videos first (Video files should be under Video catalog).

- Press >|| button to start or pause playing; Press M button to enter into setting options:

【Play; Delete; Sort by】

While in playing interface:

- Shortly press M button to achieve full screen playback. Long press M button to enter into Video settings. You could set Auto Repeat or not.
- Shortly press VOL button to return to video list. Long press VOL button to enter into Volume page, press |<< or >>| button to turn down or turn up the volume.
- Shortly press |<< or >>| to switch to previous or next video. Long press |<< or >>| to rewind or fast forward playing. .

- Supported Video Formats: AVI
- Supported Video Size: 120*160.

1. Please unzip it onto your computer first (PwConverterSetup is in MP3 player);
2. Click PwConverterSetup.exe to install the program.
3. Click setting and set the video details:
Please set the output location; And select the size to 120*160, rotate 0°
4. Add your task: Load the video that you need to convert from local computer.
5. When it shows running, wait for a while. Once it shows Finished, that means done. You could find converted video from Directory.

III E-Book

Press >|| to enter into text list.

- When in text list interface, Press M button to open text setting options:

【Open; Delete; Sort by; Copy; Move; Details】

- When in text content interface, Press M button to enter into setting page.

【Full screen on or off; Jump to; Add bookmark; Go to bookmark; Delete bookmark; Auto scroll on or off; Close; Global settings】

- Press |<< or >>| to turn to previous or next page.
- Press VOL button to return to previous interface.
- Supported Format: TXT.

IV Record

After enter into record function interface, press >|| to start voice recording, press >|| button again to pause. You can press >|| again to keep recording (will be in same voice file). Press VOL button to finish recording and save voice files. After recorded, press M button to enter into options to current voice file:

【New record; Play; Append; Delete; List; Settings; Send】

Press M button to enter into record settings.

V FM Radio (Need to plug in earphones as antenna)

- Press >|| to play radio and press again to pause.
- Press |<< or >>| to adjust the radio channel.
- Shortly press VOL button to return back to main menu.
- Long press VOL to enter in volume interface and press |<< or >>| to adjust volume.
- Press M button to enter into radio options:

【Channel list; Manual input; Auto search; Record; File list】

VI Files

Enter into to check your files in the memory card. Press VOL button to return back.

VII Tools

1. Calendar
2. Alarm

You could set max 5 alarm clocks.

3. Stopwatch

You could start split timing or lap timing.

4. Image Viewer

Supported picture formats: JPG; JPEG; BMP
Supported Size: max 1080*1920
You could set picture to wallpaper.

VIII Bluetooth

This Upgraded MP3 player has Bluetooth function. It supports **playing music via Bluetooth**.

Before using, let' s learn below settings first:

1.Power: Active Bluetooth function or not.

2.Visibility: Whether other devices are able to find the Bluetooth signal of this MP3 player.

3.My Device: You could click " Search New device " to find nearby Bluetooth signals. While searching signals, you cannot proceed pairing. Click VOL button to quit searching, then select needed signal, click >|| to pair. You can see saved signals for later pairing. If you want to delete saved signals, press M button to enter into setting options, select Delete or Delete all.

4.My Name: BT_Speaker

✓ **Bluetooth Playing:** It could pair with Bluetooth speaker or Bluetooth earphones for playing.

Using steps: After activated Bluetooth feature, click My device and Search new device to find nearby Bluetooth signals. After found your device, click VOL to stop searching, then select your device signal to connect. You could play music or video via Bluetooth speaker or Bluetooth earphones.

IX Setting

-1) System Settings

1. Time and date

You could set Time city, Date (Year, Month; Day), Time and time format. After setting, please press M button and select save.

2. Language

System languages could be adjusted to: English, Germany, French, Italian, Spanish, Japanese, Chinese, etc

3. Display

Some Display settings: Entry idle; Screen saver; Wallpaper; Show date and time

4. Misc.settings

You could set brightness and time for LCD backlight: Press M button to select next option, Press |<< or >>| to lower or add; Press >|| to save and press VOL to exit.

5. Power saving mode

You could set power saving mode time.

-2) Restore setting

It will delete all customized settings and go back to system default settings.

X How to Transfer Files

<1> USB Transmission

Firstly please download files into your computer first.
a. Connect this MP3 player with your computer via data cable, make sure your computer find this player disk;
b. Copy and paste files to this MP3 player.

<2> OTG Transmission (Through mobile phone directly)

Firstly please ensure your phone supports OTG function (OTG=On-The-Go, it' s used for data transmission between mobile devices)

You need to have an OTG adapter(Not included in box).

Start: Connect both mp3 player and your phone with OTG adapter via data cables; Find and select needed files in mobile phone, copy and paste into the mobile disk(MP3).
Note: Currently Apple devices don't support OTG technology.

Technical Parameters:

- Built-in Polymer Battery Voltage: 3.7V
- Input: AC110-240V, 50/60Hz, 100mA
- Output: DC 5.0V/500mA-1A
- Supported Headphones: 3.5mm jack
- Supported audio formats: MP3, FLAC, WMA, WAV, APE, etc
- Supported video format: AVI
- Supported text format: TXT
- Support image format: JPG, JPEG, BMP