

WHITEFANG

Pop-up Beach Tent

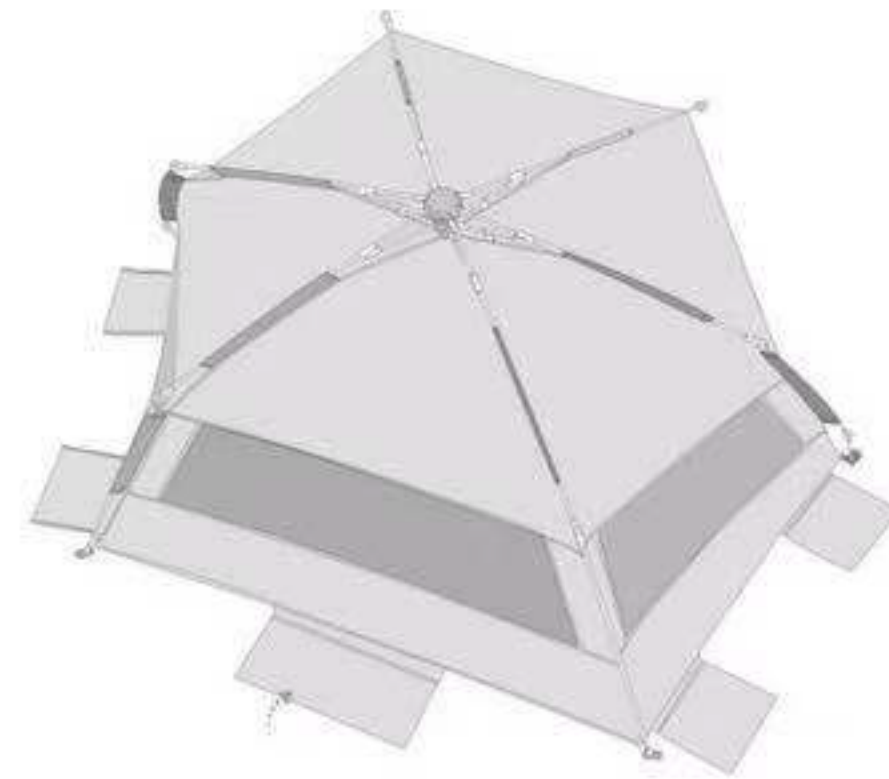

User Manual

ASSEMBLY INSTRUCTIONS

1

TAKE THE TENT OUT OF IT'S PACKAGING, PLACE IT ON A FLAT SURFACE & LOCK THE TWO LOCKABLE JOINTS (MARKED WITH ORANGE ARROWS) BY PUSHING THE POLES TOGETHER

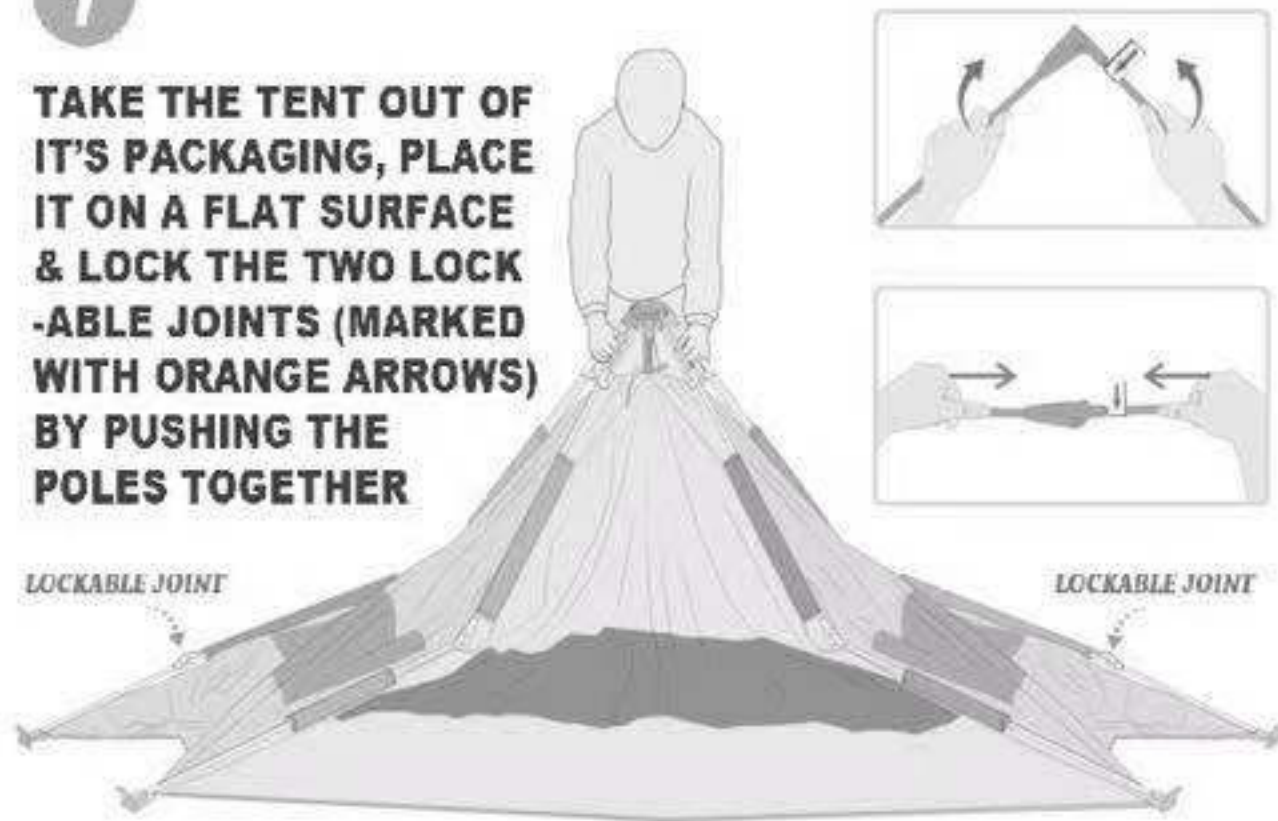

2

MAKE SURE THE END OF THE POLES GOES THROUGH THE DEDICATED SOCKETS

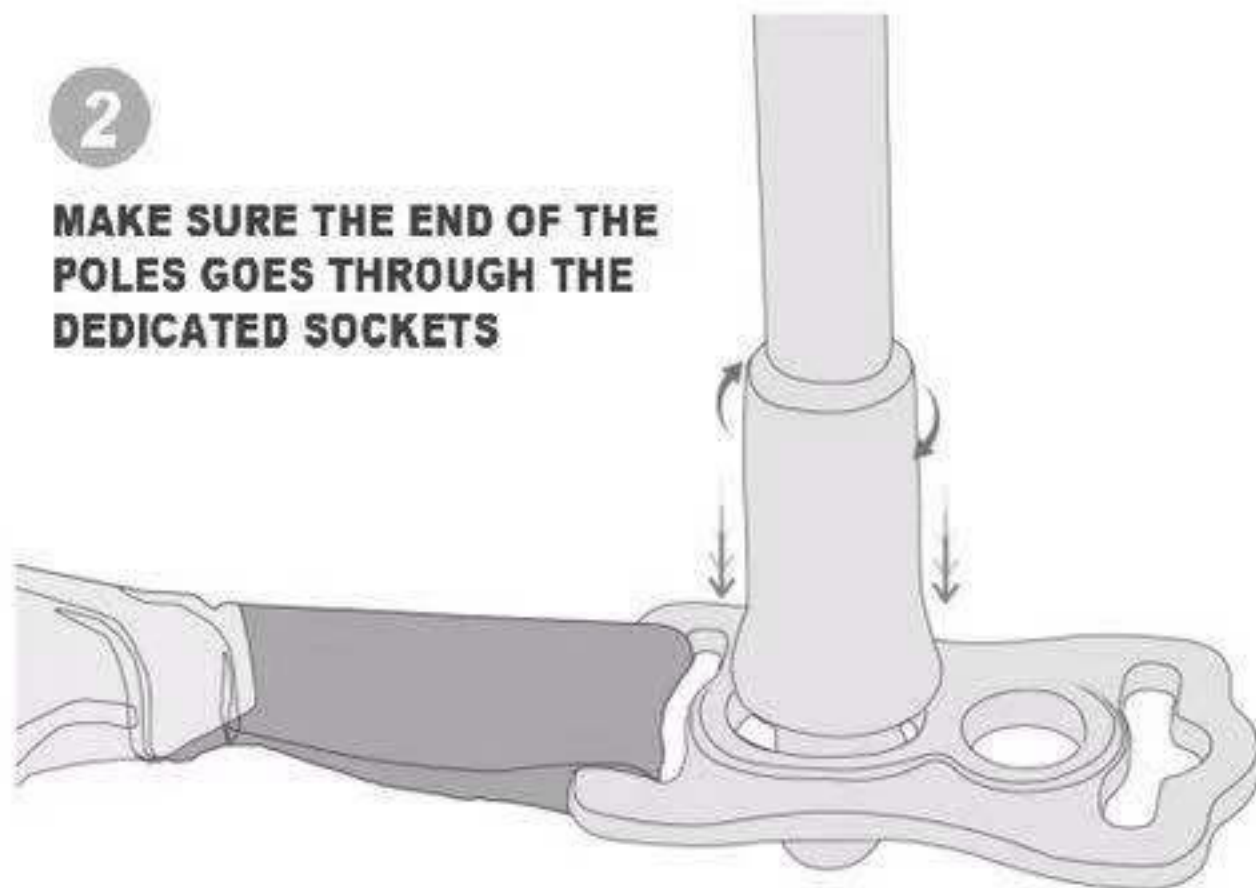

ASSEMBLY INSTRUCTIONS

3

RAISE THE TENT BY PUSHING THE BOTTOM PART DOWNWARDS

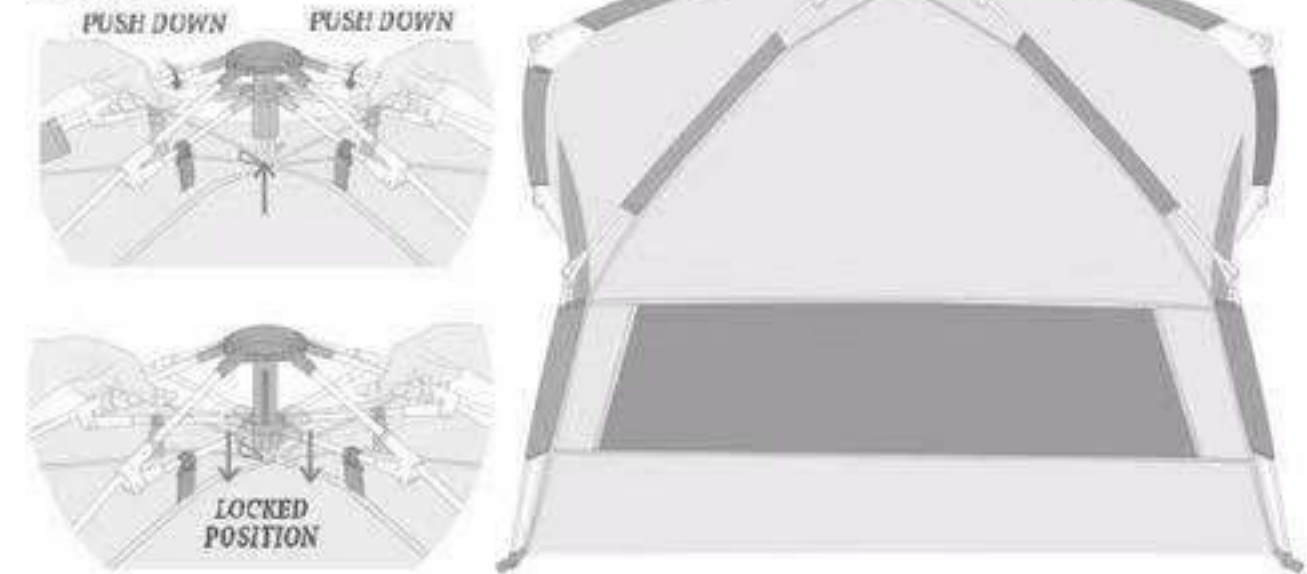

4

SECURE THE TENTS PLACEMENT USING THE TENT PEGS OR BY FILLING THE SAND BAGS

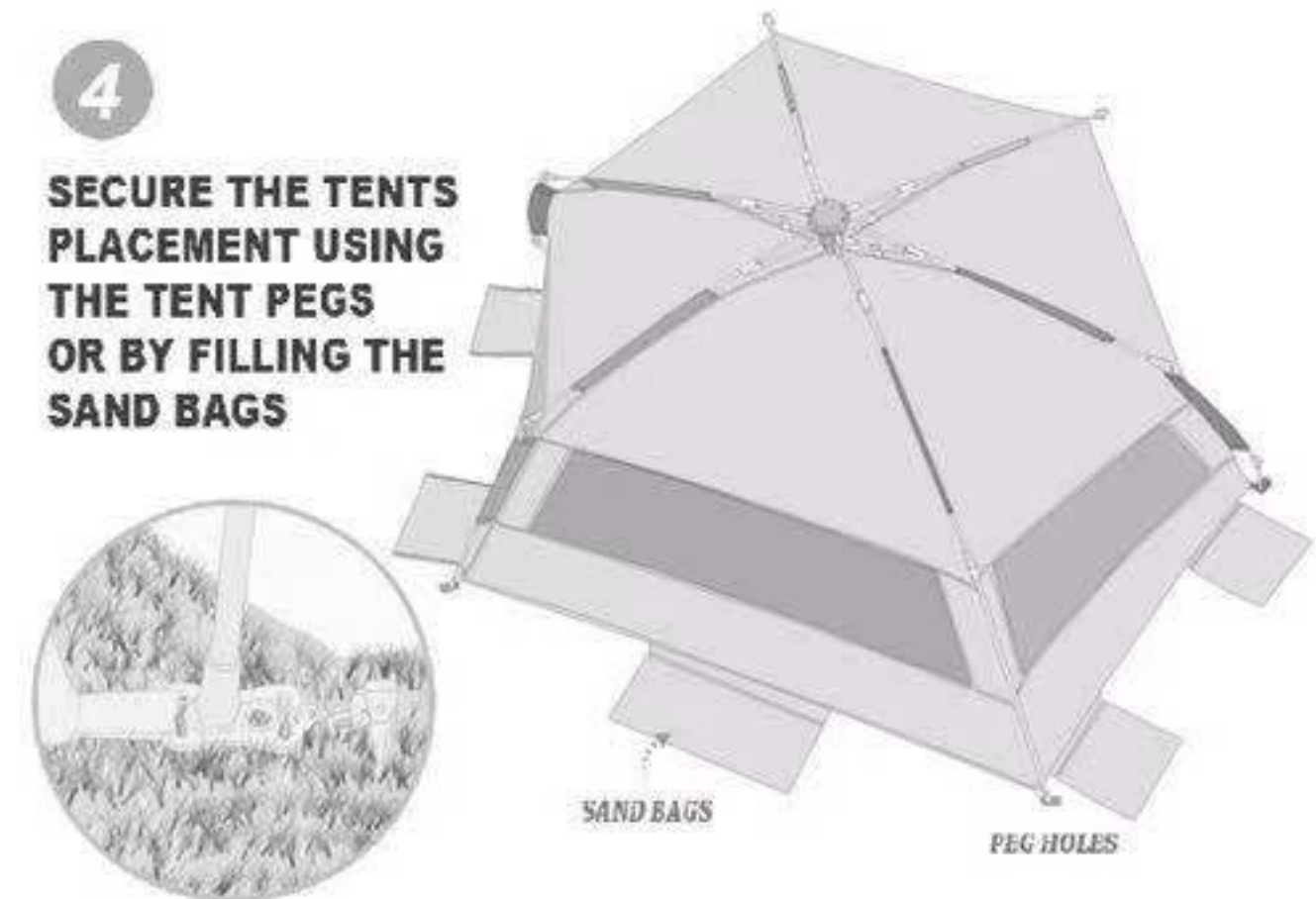

DISASSEMBLY INSTRUCTIONS

1

PUT DOWN THE TENT BY PULLING THE BOTTOM PART UPWARDS & THEN PULL THE POLES OUT OF THE SOCKETS

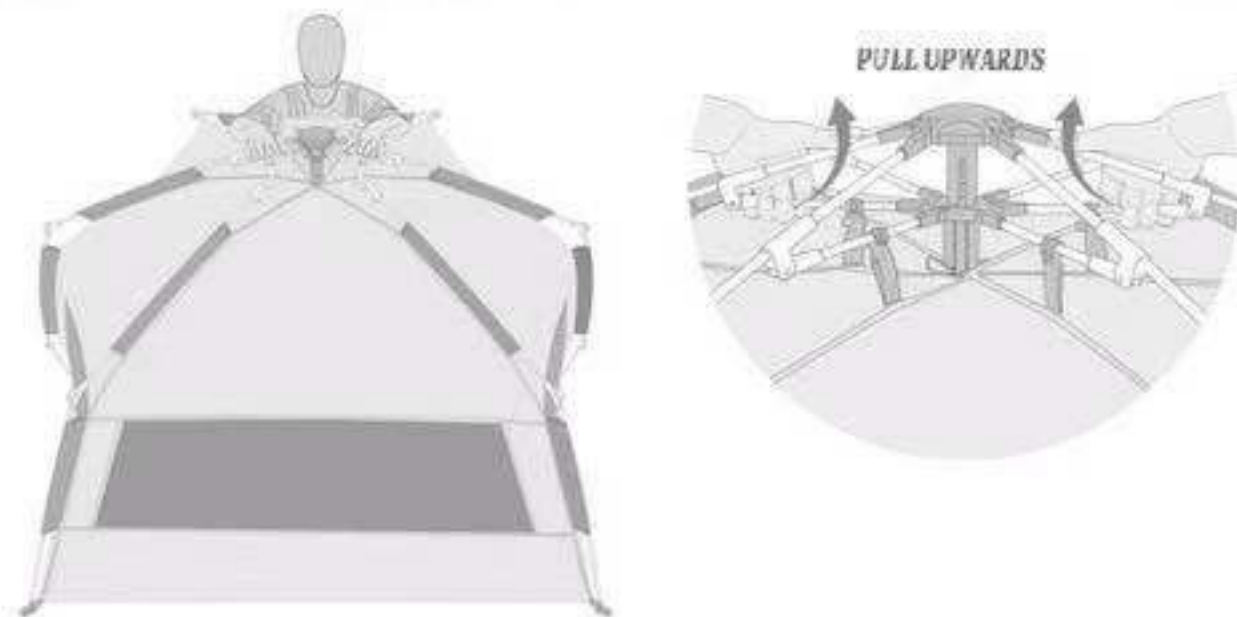

2

UNLOCK THE TWO LOCKABLE JOINTS & FOLD ALL THE POLES

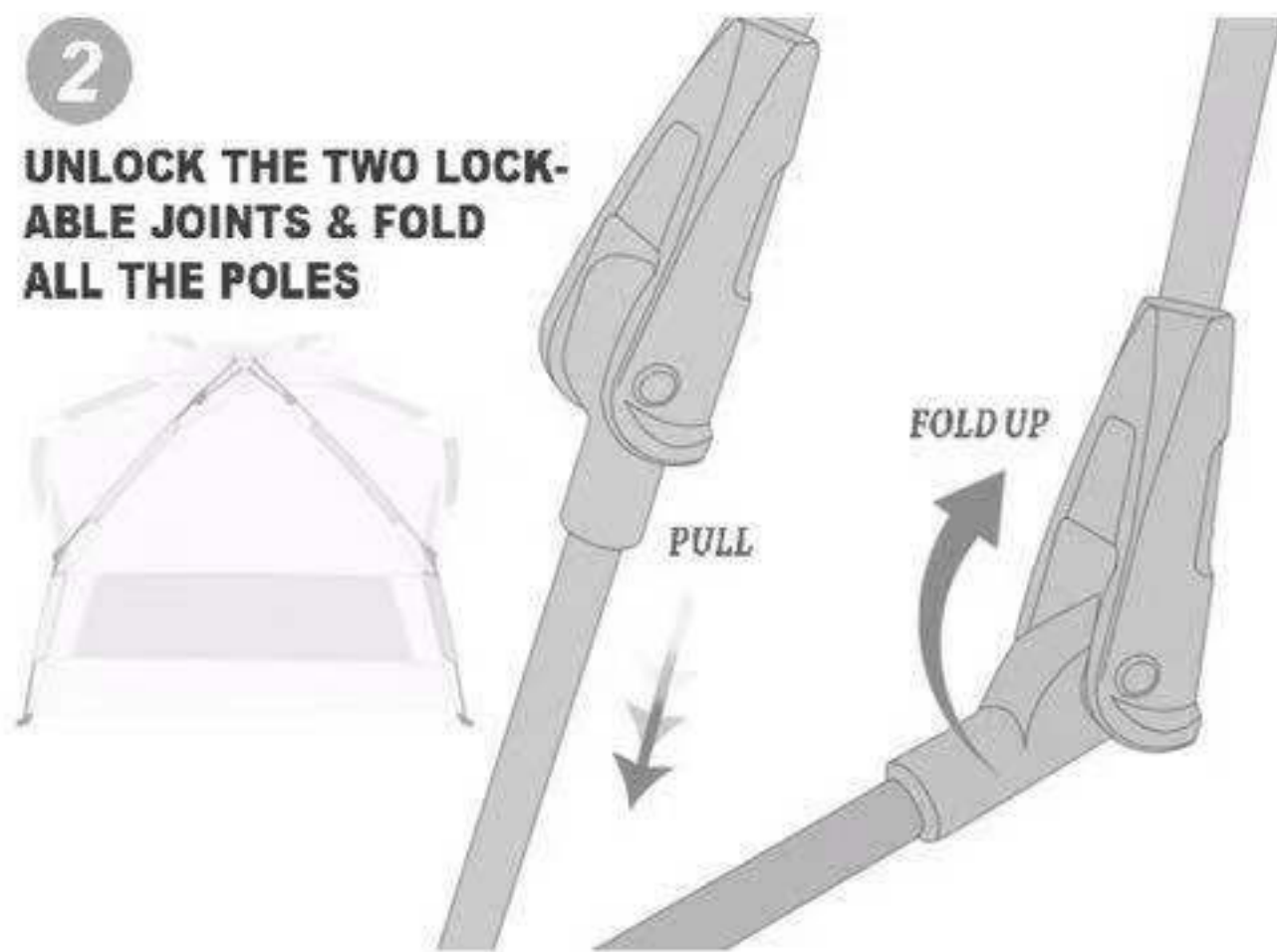

3

DISASSEMBLY INSTRUCTIONS

3

ROLL THE TENT TIGHTLY & PUT IT BACK IN IT'S DEDICATED PACKAGING

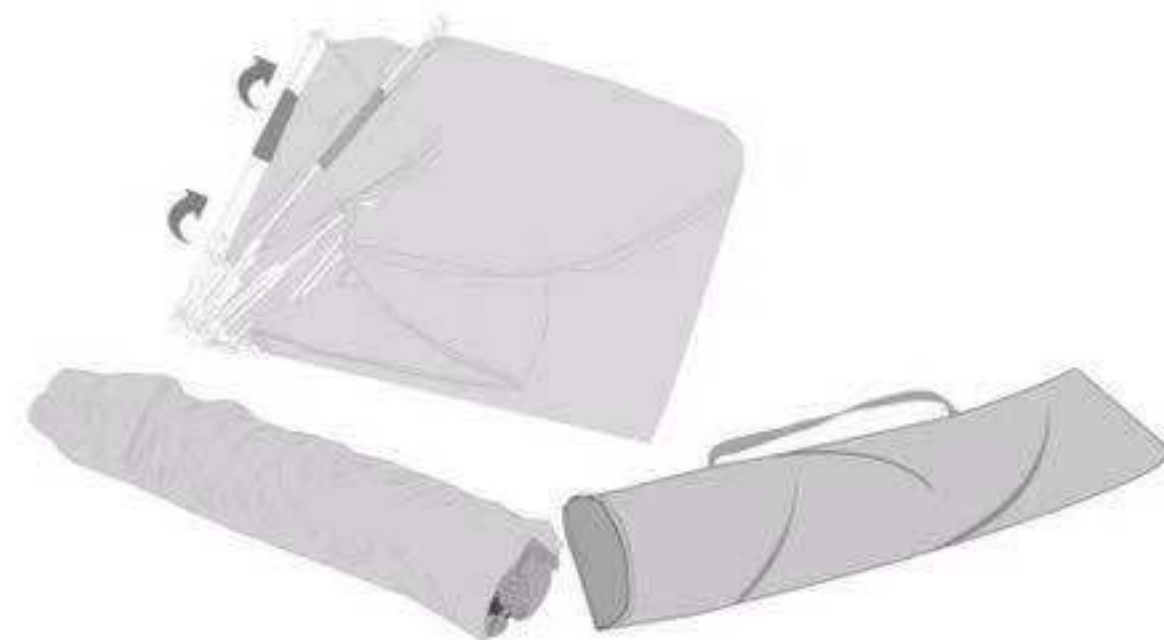

4

MATTERS NEEDING ATTENTION

Attention: it's important that all poles are properly unfolded & that the lockable joints are locked before raising the tent. Misuse may lead to damages to the tent.

Attention: remove as much sand from the tent as possible before disassembling the tent.

Keeping the tent clean when stored will make it last longer.

Happy?

MATTERS NEEDING ATTENTION



We're just happy that you're happy.
If you don't know how to express your newfound joy.
We've got a few suggestions...

-  **Tell your friends and family**
-  **Share your experience by writing a review on Amazon**



WHITEFANG