

KNOW YOUR BAJAJ GX1 / GX2 / GX4 MIXER GRINDER
अपने बजाज जीएक्स १/जीएक्स २/जीएक्स ४ मिक्सर ग्राइंडर को जानिए

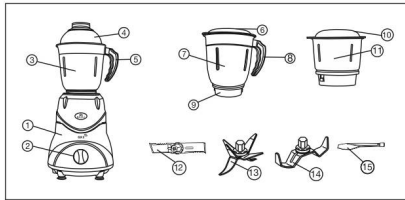

KNOW YOUR BAJAJ GX6 / GLORY MIXER GRINDER
अपने जीएक्स ६ / ग्लोरी मिक्सर ग्राइंडर को जानिए

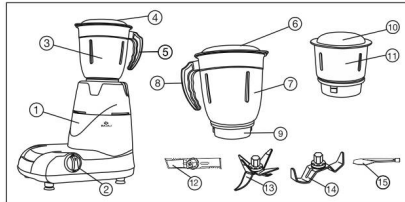

- | | |
|------------------------------------|----------------------------------|
| 1. Main Unit | १. मुख्य इकाई |
| 2. Speed / Incher Selector Knob | २. स्पीड / इंचर सिलेक्टर नॉब |
| 3. Liquidising Jar | ३. लिक्विडाइजिंग जार |
| 4. Lid for Liquidising Jar | ४. लिक्विडाइजिंग जार का ढक्कन |
| 5. Jar Handle | ५. जार हैंडल |
| 6. Lid for Dry / Wet Grinding Jar* | ६. सूखी/मौली पिमाई जार का ढक्कन* |
| 7. Dry / Wet Grinding Jar* | ७. सूखी/मौली पिमाई जार* |
| 8. Dry / Wet Grinding Jar Handle** | ८. सूखी/मौली पिमाई जार हैंडल** |
| 9. Jar Base | ९. जार का आधार |
| 10. Chutney Jar Lid | १०. चटनी जार का ढक्कन |
| 11. Chutney Jar | ११. चटनी जार |
| 12. Chutney Blade | १२. चटनी ब्लेड |
| 13. Liquidising Blade | १३. लिक्विडाइजिंग ब्लेड |
| 14. Multi Function Blade | १४. मल्टी फंक्शन ब्लेड |
| 15. Spatula | १५. स्पैचुल |
- * (Not provided with GX1 & GX2 - 2 JAR)
** (Not provided with GX1 & Glory)

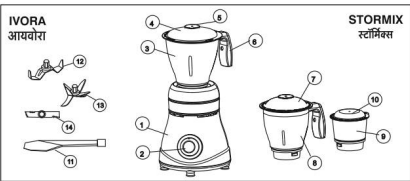

- | | |
|--------------------------------|-------------------------------|
| 1. Main Unit | १. मुख्य इकाई |
| 2. Speed/ Incher Selector Knob | २. स्पीड / इंचर सिलेक्शन नॉब |
| 3. Liquidising Jar | ३. लिक्विडाइजिंग जार |
| 4. Lid for liquidising jar | ४. लिक्विडाइजिंग जार का ढक्कन |
| 5. Lid cap | ५. ढक्कन का ढक्कन |
| 6. Handle | ६. जार हैंडल |
| 7. Lid for grinder jar | ७. ग्राइंडर जार का ढक्कन |
| 8. Grinder Jar | ८. ग्राइंडर जार |
| 9. Chutney Jar | ९. चटनी जार |
| 10. Lid for chutney jar | १०. चटनी जार का ढक्कन |
| 11. Spatula | ११. स्पैचुल |
| 12. Multi Function Blade | १२. मल्टी फंक्शन ब्लेड |
| 13. Liquidising Blade | १३. लिक्विडाइजिंग ब्लेड |
| 14. Chutney Blade | १४. चटनी ब्लेड |

KNOW YOUR BAJAJ MIXER GRINDER
अपने बजाज मिक्सर ग्राइंडर को जानिए

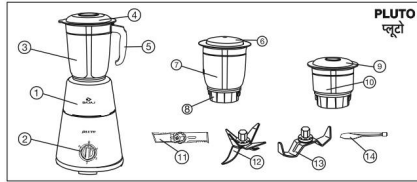

- | | |
|------------------------------------|----------------------------------|
| 1. Main Unit | १. मुख्य इकाई |
| 2. Speed / Incher Selector Knob | २. स्पीड / इंचर सिलेक्टर नॉब |
| 3. Liquidising Jar | ३. लिक्विडाइजिंग जार |
| 4. Lid for Liquidising Jar | ४. लिक्विडाइजिंग जार का ढक्कन |
| 5. Jar Handle | ५. जार हैंडल |
| 6. Lid for Dry / Wet Grinding Jar* | ६. सूखी/मौली पिमाई जार का ढक्कन* |
| 7. Dry / Wet Grinding Jar* | ७. सूखी/मौली पिमाई जार* |
| 8. Jar Base | ८. जार का आधार |
| 9. Chutney Jar Lid | ९. चटनी जार का ढक्कन |
| 10. Chutney Jar | १०. चटनी जार |
| 11. Chutney Blade | ११. चटनी ब्लेड |
| 12. Liquidising Blade | १२. लिक्विडाइजिंग ब्लेड |
| 13. Multi Function Blade | १३. मल्टी फंक्शन ब्लेड |
| 14. Spatula | १४. स्पैचुल |

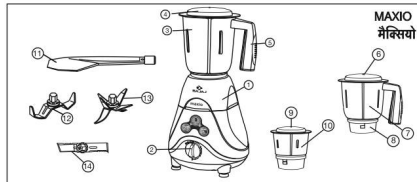

- | | |
|--|---------------------------------|
| 1. Main Unit | १. मुख्य इकाई |
| 2. Speed / Incher Selector Knob | २. स्पीड / इंचर सिलेक्टर नॉब |
| 3. Liquidising Jar | ३. लिक्विडाइजिंग जार |
| 4. Lid for Liquidising Jar | ४. लिक्विडाइजिंग जार का ढक्कन |
| 5. Jar Handle | ५. जार हैंडल |
| 6. Flat Lid for Dry / Wet Grinding Jar | ६. सूखी/मौली पिमाई जार का ढक्कन |
| 7. Dry / Wet Grinding Jar | ७. सूखी/मौली पिमाई जार |
| 8. Jar Base | ८. जार का आधार |
| 9. Chutney Jar Lid | ९. चटनी जार का ढक्कन |
| 10. Chutney Jar | १०. चटनी जार |
| 11. Spatula | ११. स्पैचुल |
| 12. Multi Function Blade | १२. मल्टी फंक्शन ब्लेड |
| 13. Liquidising Blade | १३. लिक्विडाइजिंग ब्लेड |
| 14. Chutney Blade | १४. चटनी ब्लेड |

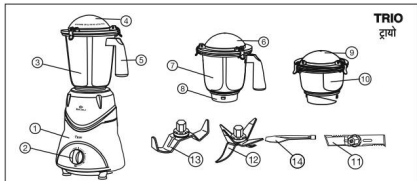

- | | |
|-----------------------------------|---------------------------------|
| 1. Main Unit | १. मुख्य इकाई |
| 2. Speed / Incher Selector Knob | २. स्पीड / इंचर सिलेक्शन नॉब |
| 3. Liquidising Jar | ३. लिक्विडाइजिंग जार |
| 4. Lid for liquidising jar | ४. लिक्विडाइजिंग जार का ढक्कन |
| 5. Jar Handle | ५. जार हैंडल |
| 6. Lid for Dry / Wet Grinding Jar | ६. सूखी/मौली पिमाई जार का ढक्कन |
| 7. Dry / Wet Grinding Jar | ७. सूखी/मौली पिमाई जार |
| 8. Jar Base | ८. जार का आधार |
| 9. Chutney Jar Lid | ९. चटनी जार का ढक्कन |
| 10. Chutney Jar | १०. चटनी जार |
| 11. Chutney Blade | ११. लिक्विडाइजिंग ब्लेड |
| 12. Liquidising Blade | १२. मल्टी फंक्शन ब्लेड |
| 13. Multi Function Blade | १३. लिक्विडाइजिंग ब्लेड |
| 14. Spatula | १४. स्पैचुल |

PRECAUTIONS

- PLEASE READ THE FOLLOWING INSTRUCTIONS CAREFULLY BEFORE USING MIXER GRINDER**
- Keep the Mixer Grinder at least 6" (150mm) away from the wall and on the flat level surface.
 - Have sufficient place around the Mixer Grinder to keep the various items and ingredients required.
 - Do not touch moving parts & blades when the Mixer Grinder is in operation.
 - To protect against electrical hazards, do not immerse any part of the Mixer Grinder like base, plug or cord in water or any other liquids.
 - Always disconnect the plug from the power outlet before cleaning, while emptying and when not in use.
 - Do not let the power cord hang over the edge of table/counter or touch any hot surface. If the plug or cord is damaged or the unit malfunctions, do not use it, contact Bajaj consumer care center for repairs.
 - This appliance is not intended for use by persons (including children) with reduced physical, sensory or mental capabilities, or lack of experience and knowledge, unless they have been given supervision or instruction concerning use of the appliance by a person responsible for their safety.
 - Children should be supervised to ensure that they do not play with the appliance.
 - Keep the Mixer Grinder out of reach of children at all times. Close supervision is necessary when used near children.
 - In the event of any failure of your Mixer Grinder or cord damaged, do not attempt to repair it at home or allow any unauthorized person to do so. Ensure repairs are carried out only at an authorized Bajaj Consumer care centre.
- NOTE:**
- Parts illustrated in this use and care manual are indicative only.
 - This mixer Grinder is intended for household use only.
 - Specifications are subject to change without notice.

INSTRUCTIONS TO USE YOUR BAJAJ MIXER GRINDER :

- Before you start the mixer grinder for the first time or after a long period of non-usage :
- After unpacking the mixer grinder, wash the jars and blades with mild detergent and dry it thoroughly.
 - Rotate the motor shaft by hand to ensure that it turns freely & smoothly (Fig. 8). Make sure the unit is not connected to the electric supply source
 - Before fixing the jar to the main unit, rotate the jar coupler to ensure that it turns freely (Fig. 9)
 - Each jar comes fitted onto an aluminium/ plastic base that has to be fitted onto the main unit. Hold the base and rest it on the main unit (Fig 10)
 - Plug the power cord in the electric supply socket & switch the power ON.
 - Do not touch the jars with bear hands immediately after using the mixer.
- WARNING : Do not run the mixer grinder unless lid is in place and held firmly with hand.**

INSTRUCTIONS TO USE CHUTNEY JAR

- This jar (Fig. 11) can be used to grind small quantities of jeera, dhania, coconut, green chilli, pepper, garam masala, etc.
- The substance to be ground should not be too large. Cut/hack ingredients into smaller pieces.
 - Put the ingredients to the ground in the chutney jar.
 - Put the flat lid on top of the jar and fit it onto the main unit.
 - Place the chutney jar on the main unit through the jar base.
 - While using, hold the lid with hand and press it down firmly on the jar, ensuring that lid has locked securely from all sides.
- NOTE:**
- Do not add too much water while using this jar.
 - Do not run the mixer continuously as it tends to rob the ingredients of their flavour - thus short spurts would be preferable.
 - While dry grinding, friction may heat up the jar, this is not abnormal.

INSTRUCTIONS TO USE DRY GRINDING JAR

- This jar (Fig. 12) can be used for grinding items like Coffee beans, coconut chutney, groundnut, red chilli, sugar, palak etc.
- Fill the jar with the ingredients, upto 2/3 of capacity of the jar and add some water as per the desired quantity.
 - Put the lid on the top of the jar and fit it onto the main unit.
 - While using, hold the lid with hand and press it down firmly on the jar, ensuring that lid has locked securely from all sides.
 - Grind at a low speed for about 15 sec. And then move to higher speeds. Keeping add water till you achieve desired consistency.
- NOTE:**
- Always ensure lid is in place before starting.
 - Please add the water as and when required.
 - Start from lowest speed and increase gradually.

INSTRUCTIONS TO USE BLENDING, LIQUIDIZING, WET GRINDING AND OPTIONAL JAR

- This jar (Fig. 13) can be used to perform all type of blending, liquidizing & wet grinding operation such as preparing lassi, milk shakes, purees, juices, Lassi & Dosa batter etc.
- Fill the jar with the solids to be liquidised such as tomatoes or watermelon and fit the jar onto the main unit.
 - Put the Dome Assembly on to the jar. Put the Dome Cap into place.
 - If needed more water can be added by removing Dome Cap.
 - While using ensure that the dome/lid has securely locked from all sides.
 - While using, hold the lid with hand and press it down firmly on the jar, ensuring that lid has locked securely from all sides.
 - Now switch on the mixer for under a minute and you will get finely blended juices and purees.
- Note:**
- Always ensure Dome Lid and Dome Cap are in place before starting
 - Use incher button for better results.
 - Use the handle of the jar for pouring out the contents.

HOW TO CARE FOR YOUR BAJAJ MIXER GRINDER

- CLEANING AFTER USE**
- Warning:** Be sure to switch off your Mixer Grinder after use. Wait until the blades come to a halt before removing the cover.
- After each use it is highly desirable to wash and thoroughly clean the jars blades and the lids.
 - Firstly remove the powerplug from the electric supply socket. Gently detach the jar from the main unit
 - Open the lid and empty the contents.
 - To remove the blade assembly, use a spoon to stop the blade from rotating and use Spatula to gently loosen/uncrew the plastic dome into place.
 - Do not Operate or touch the unit when smoke/burnt smell is observed. Contact the authorized Bajaj Consumer Care Centre.



- OVERLOAD PROTECTOR (OLP)**
- The OLP is designed to protect your motor from burning.
 - When the jar is filled more than what is specified or the liquid is too viscous the OLP trips and the motor stops automatically.
 - When this happens, reduce the quantity of material being grounded or add some water.
 - To restart wait for a while and press the OLP button located at the bottom of the mixer base (Fig-16).
 - Wait for a while and then start your Mixer Grinder again.

TROUBLE SHOOTING GUIDE

Note : In case the following measures do not work, please take the Mixer Grinder to the nearest Bajaj Authorized Consumer Care Center.

PROBLEM	CAUSE	CORRECTIVE ACTION
The mixer does not start	No electric supply Tripped due to overload	Ensure electric supply Switch off the electric supply. Remove excess load and reset the OLP located at the bottom of the mixer base. (If it still does not work, contact the nearest Bajaj authorised customer center).
The result / performance is not satisfactory	Overloading Size of ingredients not proper Wrong Jar / Blade used	Fill the Chutney Jar up to the level of blades & the other 2 jars up to 2/3 of capacity level indicated. Cut / Break down the ingredients to be ground into appropriate size. Ensure that you are using the jar / blade for its right / intended purpose.
Mixer generates abnormal noise	Jar is not locked properly Blade assembly loose Coupler loose	Lock the jar properly Tighten dome nut of blade assembly properly. Tighten Coupler