

Smart Life Camera S8

User Manual



QR code: YouTube video

You can scan the QR code to check the install video on YouTube

Version 5.1

Thank you very much for purchasing the our **Mini Spy Camera Wi-Fi**. Please read the instruction manual carefully and use it correctly and safely. Please keep it in a safe place for future reference.

Notes (Very important): This is a high-tech product, please read the instructions carefully before using the camera. If you don't know how to install it, or have questions, please contact us with your order number at this e-mail:

Support_Jayol@163.com

Our customer support will send you some pictures and videos to help you set-up and use this camera.

Please read this User Manual before using

Table of Contents

1. How To Download the APP	2-2
2. How To Connect This Camera.....	3-7
3. Power ON & Power OFF Operation.....	8-9
4. AP Connection Mode.....	9-11
5. How To Add The Camera To Other Phone.....	11-14
6. Interface introduction	15-18
7. Reset The Device.....	18-18
8. Two ways recording.....	18-19
9. Working Mode Switching	19-21
10. Functions Introduction.....	21-22
11. Indicators Introduction.....	23-23
12. Questions & Answers.....	24-26
13. Attention.....	27-27
14.12-Months No Risk Guarantee.....	28-28

Product Details

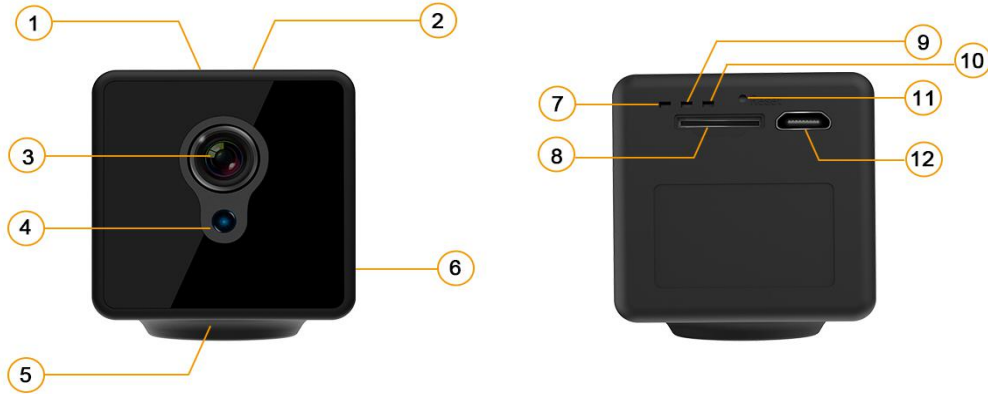

- ①Mode K2--Network reset ②Confirmation K1--Power button ③Lens
④Photosensitive ⑤Nut base ⑥Mic ⑦Yellow Indicator
⑧Micro-SD Slot ⑨Blue Indicator ⑩Red Indicator
⑪Force Close ⑫USB Port

1. How To Download the APP

Scan the QR Code below or search keyword “iCookyCam” to download and install the mobile APP from the application store.



Android



iOS

2. How To Connect This Camera

This part just helps you connect the camera. If you want to know more functions of this camera, you can check the settings section below.

The camera supports 2 connection modes to your mobile device:

- 1. AP connection mode:** Camera generates a short range Wi-Fi network (about 10 meters) so you connect your mobile device and have short distance preview image on your “iCookyCam“ APP. The light blinks **Blue**.
- 2. IP connection mode:** Camera connects to your in-house Wi-Fi router for unlimited distance preview image on your “iCookyCam“ APP on your mobile device. The light blinks **Red**.

If you want to **REMOTE USE**, please use IP mode, NOT AP mode.

If you have not inserted a micro SD card, the **Red** and **Blue** light will both be on.

You can choose whichever connection mode you want (AP or IP):

- ① How to connect in AP mode:** Turn on the camera for about 60 seconds → Enter your Wi-Fi list → Choose the Wi-Fi hotspot iCooky_***** ; Turn on the APP “iCookyCam”  → Do you want to connect the device to the router? Choose **“Cancel”** → The camera will enter **AP mode**.

②**How to connect in IP mode:** There are three ways to connect IP mode.

(1)**If you first use the camera:** Turn on the camera for about 60 seconds

→ Enter your phone WiFi list → Choose the WiFi hotspot iCooky_*****

(P 2.1); Turn on the APP “iCookyCam”  (P 2.2) → Do you want to connect the device to the router? Choose “Connect” (P 2.3) →

Select your home Wi-Fi and enter its password (P 2.4) → Click

“Connect” → Connecting the Wi-Fi (P 2.5) → **Wait for about 60**

seconds (It depends on your network) → You will auto return to the

interface, connecting successful and enter IP mode (P 2.6)

(2)**If you are in AP mode:** Tap the Interface → Click gear icon



→ Choose WiFi Setting → Select your home router Wi-Fi → Enter your home Wi-Fi password → Click “Connect” → Connecting the Wi-Fi

(P 2.5) → Connecting successful it will enter IP mode

How to verify that your camera is successfully set in IP mode: On your mobile device enter your Wi-Fi settings and you should not see the camera hotspot [iCooky_***] appearing in your Wi-Fi list. This means the camera is NOT in AP mode but is in IP mode.**



P 2.1



P 2.2

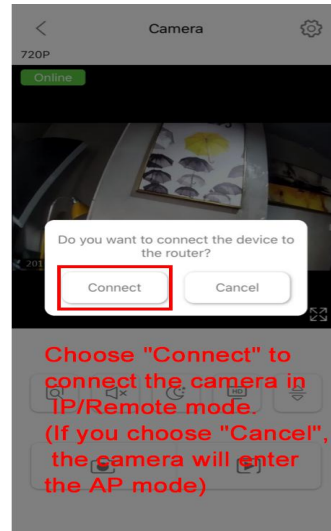

P 2.3

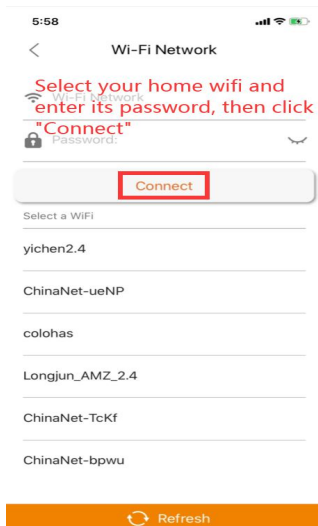

P 2.4

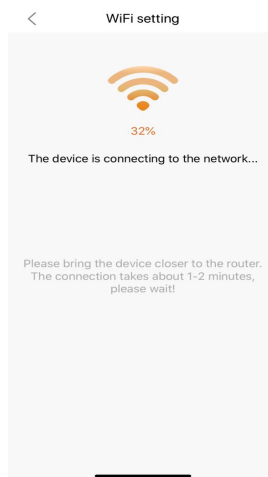

P 2.5

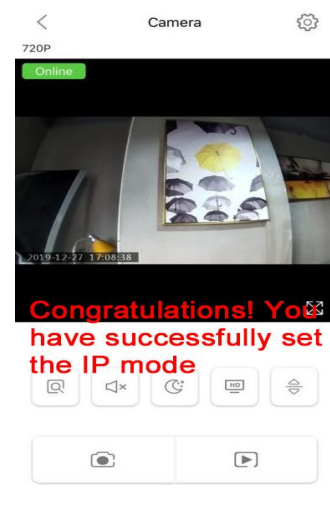

P 2.6

(3) Connect via the micro-SD card:

1. First prepare a blank micro-SD card in your computer by formatting it
2. In the root folder of the micro-SD card create a txt file named "wifi.txt"
3. In the file "wifi.txt" write two lines of text:

On the first line write your Wi-Fi name
On the second line write your Wi-Fi password

See picture below (P2.7)



P 2.7 Connect via the SD card

4. Eject the micro-SD card from your computer, make sure the camera is OFF and then insert it in the micro-SD slot in the back of the camera.
5. Power on the camera and wait for about 30 seconds. The camera will read the file on the microSD card, store its settings in memory and then will directly connect in IP mode. The light blinks **Red**. You can now use it remotely.

IMPORTANT→ **How to tell if the camera is set on IP mode successfully: On your mobile device, the Wi-Fi list will not contain the camera hotspot yet ICooky*****

Warning Tips:

- ① For first time use you need to pair the iCooky APP on your mobile phone with the camera. Please use AP mode and make sure the camera and the mobile App are close by **(Do not have obstacles, such as walls, to prevent signal transmission)**. The effective range of the Wi-Fi signal iCooky_***** sent by the camera is within **10 meters**. When the mobile phone exceeds the range, it will be disconnected from the Wi-Fi signal.

② SSID with **special characters** and 5G networks are not compatible with the APP for remote mod. The camera only supports Wi-Fi 2.4G frequency; 5G frequency Wi-Fi is not supported temporarily. Also Wi-Fi encryption mode cannot be WEP mode and the Wi-Fi **password cannot be empty.**

③ If you want to know some functions of this camera, please check **“10.Function Introduction”**

④ If you use AP and connect to the camera's Wi-Fi, there is no internet function so please don't worry about it. You can only preview images in short range on the mobile APP.

⑤ **How to change the IP mode to AP mode:** Long press **M mode** for about 8 seconds, and then the camera will be back into the **AP mode. (On your mobile device, you will need to reconnect to the camera hotspot)**

⑥ For initial connection in IP mode, the device requires a about 1-3 minutes (**depending on network conditions**) to establish the connection. Please wait patiently.

⑦ **IMPORTANT: Please ensure the Wi-Fi password you have typed is correct. If the wrong password was typed in, please click Delete on the mobile APP and withdraw from APP, then add the camera device again using AP mode.**

3. Power ON & Power OFF Operation

3.1 Insert micro-SD card: Class 10 or above is recommended.

Maximum supported 128GB.



(Please format memory card before using.)

Warning Tips:

① **Pay attention to the direction of memory card!**

② **Insert the SD card, the camera will auto turn on 24 hour loop recording**

3.2 Power ON: Connect the camera to power supply or long press confirmation button K1 (Power button) for 3 seconds, **Red** & **Blue** indicator keeps on and then, after continuous scintillation, camera starts to initialize (**it takes around 60 seconds**). After the initialization succeeds, the **Blue** indicator flashes slowly, camera enters **AP connection mode** and starts recording automatically.

[Summary: Long press power button to turn on the camera → After one minute the camera will finish initialization]

Warning Tips:

① **If you want to power on without connecting to the USB charger, make sure that the camera has enough power! We recommend you charge the camera about 7 to 8 hours before the first use.**

② **K1 is power button, K2 is “M” mode.**

③ Power OFF: press the confirmation button K1 for 5 seconds, **Red & Blue** indicator flashes for 7 times (about 7 seconds) and then the camera turns off.

④ It is not possible to power off the camera through the above operation when USB power is connected.

4. AP Connection Mode

4.1 Why do we need the AP mode?

① If you are with your camera outdoors where there is no external Wi-Fi router, you can connect the camera Wi-Fi hotspot to check the live video.

② When your home Wi-Fi router network is not strong enough, you can connect the camera hotspot to check the live video.

4.2 If you need only AP connections but not IP connections, please select

"Cancel" when prompted "Do you want to connect the device to the router?" in the above P4.2.1 operation steps. APP automatically returns to the device list interface and successfully adds the camera to the list. (P

4.2.1-4.2.2)

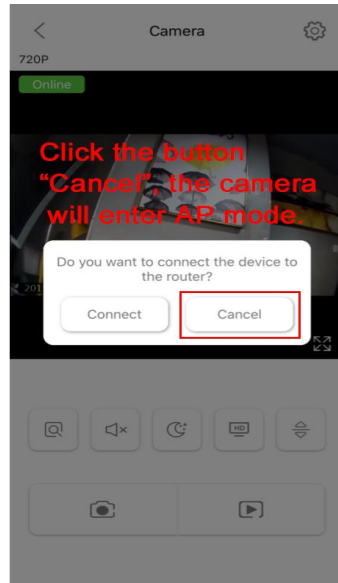

P 4.2.1 Click “Cancel”

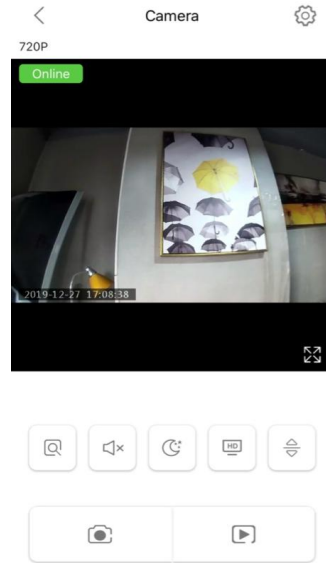

P 4.2.2 Viewing

4.3 How to change AP mode to IP mode: Tap the Screen → Click the gear icon → Choose Wi-Fi Setting → Select your home router Wi-Fi → Enter your home Wi-Fi password → Select “OK”. (P 4.3.1- P. 4.3.5)

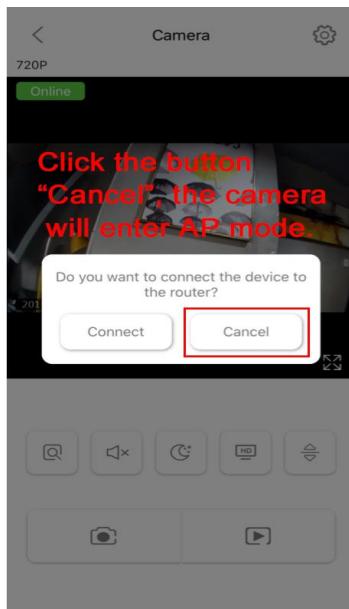

P 4.3.1 Tap the Screen



P4.3.2 Click the gear icon

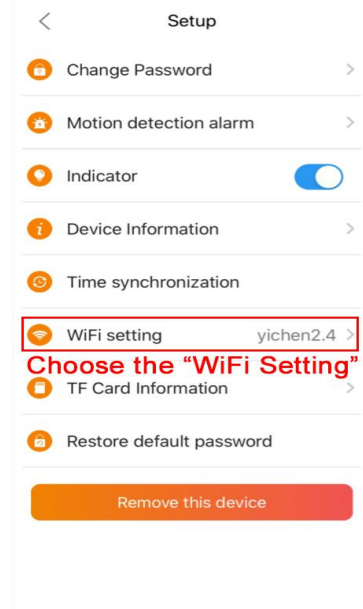

P4.3.3 Choose WiFi Setting

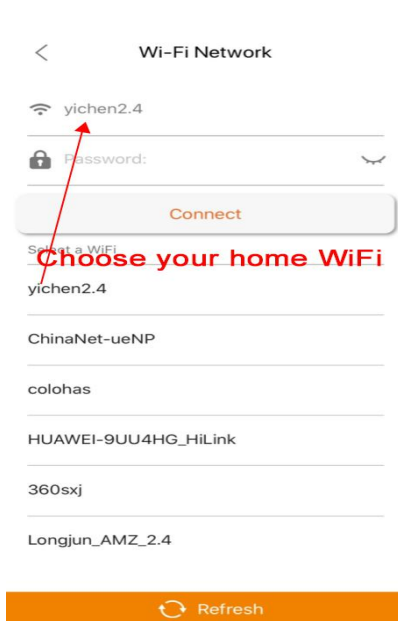

P.4.3.4 Select your router WiFi

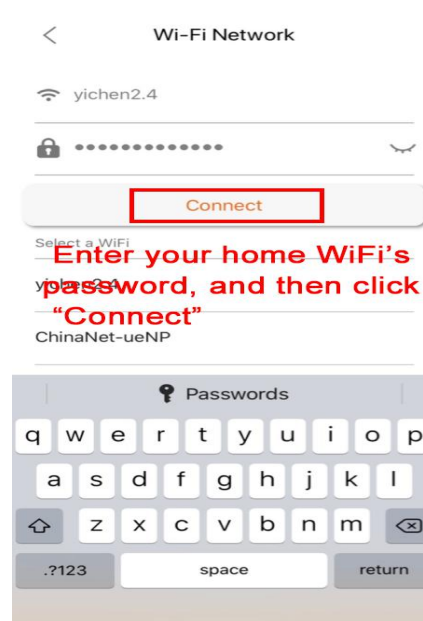

P. 4.3.5 Enter your WiFi password

4.4 How to switch from IP connection mode to AP connection mode:

Long press Mode button K2/M for 8 seconds.

5. How To Add The Camera To Other Phone

5.1 If the camera has been connected to the Internet to work in **IP remote** mode, when you want to add the camera to other people's APP, please open APP on the other's phone, click the "+" in the middle or below the interface, select the "Been connected to the router", and enter to the "Lan Search" interface. (P 5.1-5.3)

NOTE: If you want to add the camera on other phones, please confirm the phone connects the same Wi-Fi network like the camera Wi-Fi (which you change)

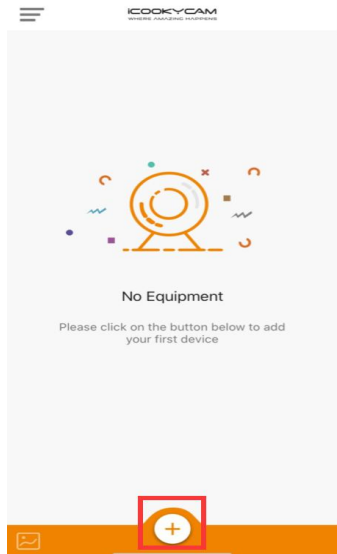

P 5.1 Click “+”

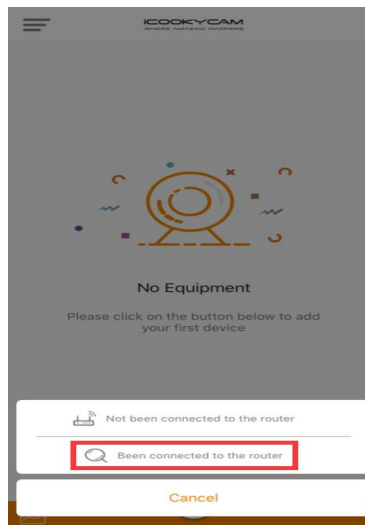

P 5.2 Click “Been connected to the router”

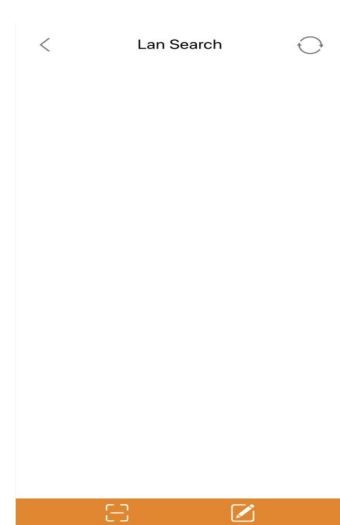

P 5.3 Lan Search interface

5.2 Search addition under the same Wi-Fi

If the mobile phone and the camera are connected to the **same Wi-Fi**, then the "Lan Search" interface will automatically search all the camera serial numbers under the Wi-Fi, select the camera that you need to add, (the default password is "ok123456"); the camera should be added successfully. (P 5.2.1-5.2.2)



P5.2.1 Select a camera

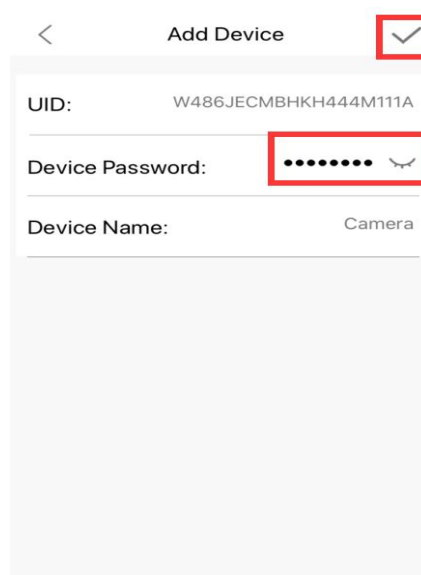

P 5.2.2 Default password "ok123456"

5.3 Scanning QR code addition

Open the APP that has already added the camera, find the camera that needs to be added in the device list, and click the share button in the lower right corner to automatically generate a camera QR code. Open the APP on the phone that needs to add the camera, enter the "Lan Search" interface, click the QR code scan button in the lower left corner to open the scan window, scan the generated camera QR code, and then click the ✓ button to confirm. (P 5.3.1-5.3.5)

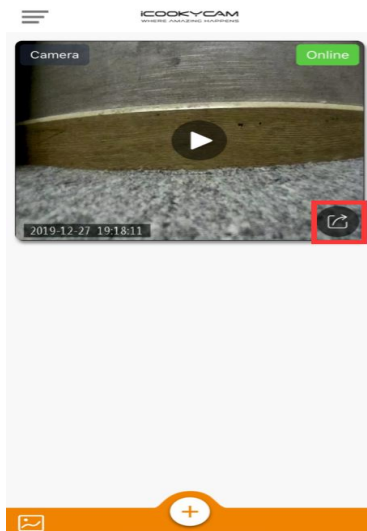

P 5.3.1 Click QR code button

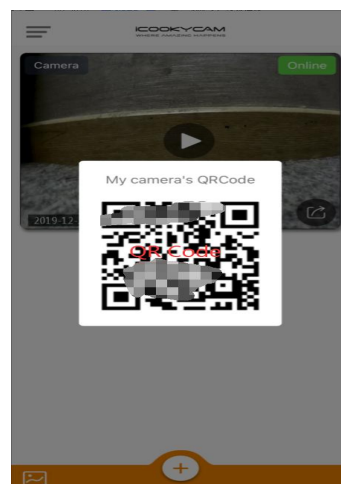

P 5.3.2 Generating QR code

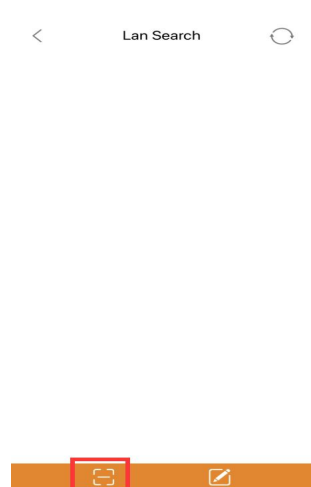

P 5.3.3 Click scan button



P 5.3.4 Scan window

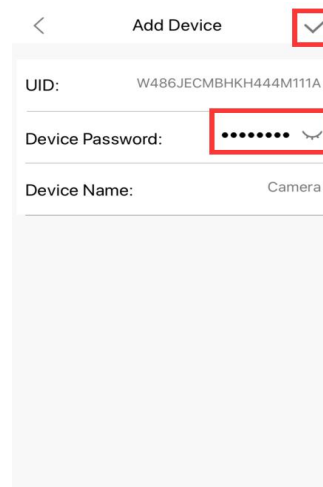

P 5.3.5 Default password

5.4 Manual input addition

Open the APP that needs to add the camera, enter the "Lan Search" interface to select the manual add button in the lower right corner, and input the correct device UID and password in the "Add Device" interface to be added successfully.(P 5.4.1-5.4.2)



P 5.4.1 Click Manual addition button

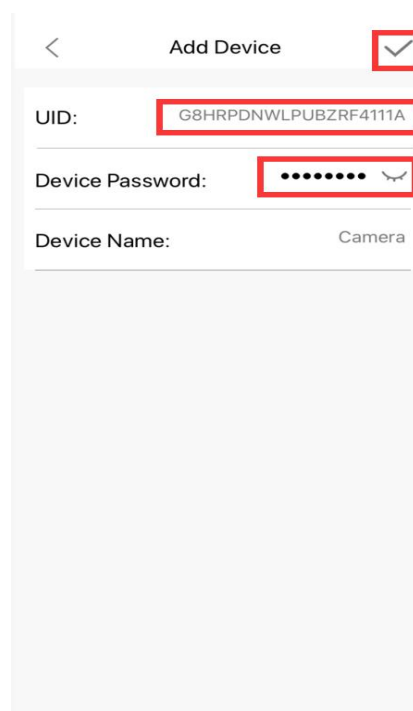

P 5.4.2 Input UID&password

6. Interface Introduction

6.1 Device list interface

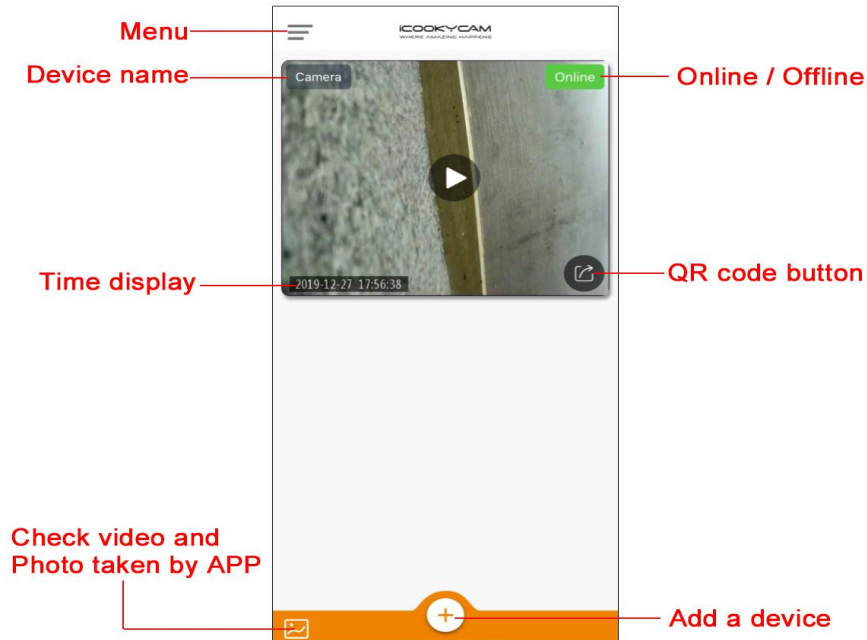

6.2 Real-time interface

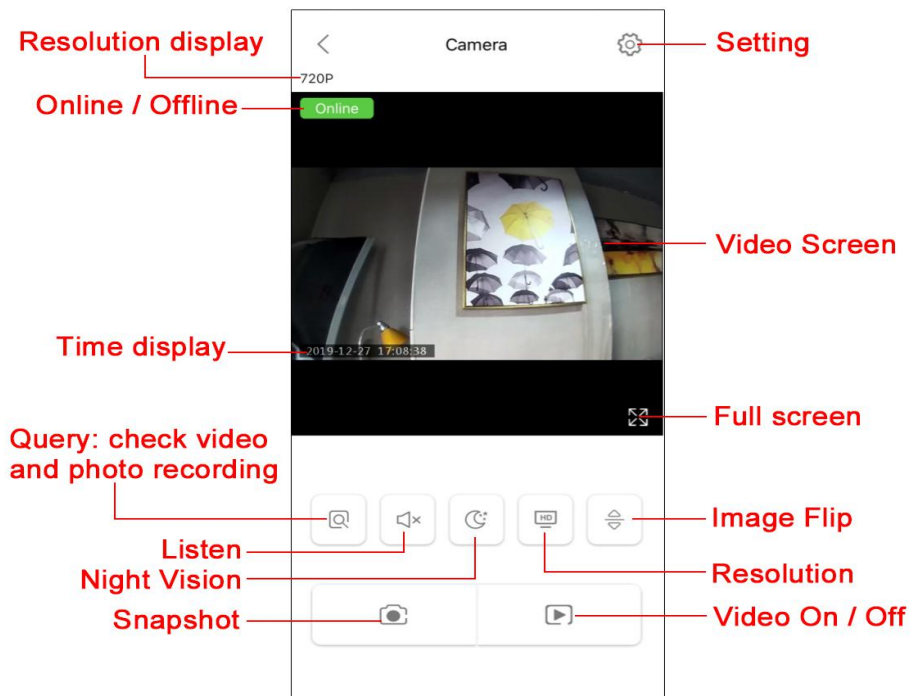

6.3 How To Check SD Card Recording File: You can click the Query



to check that.

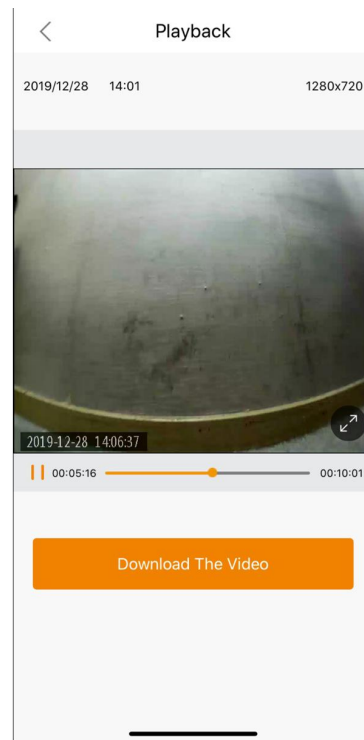
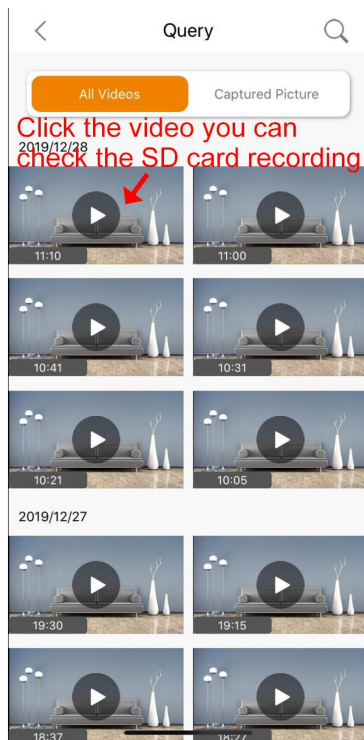
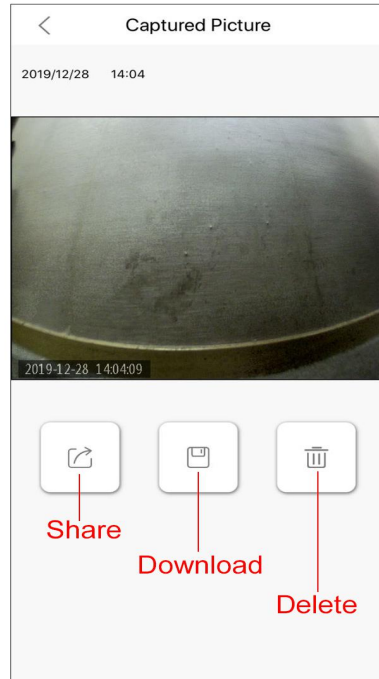
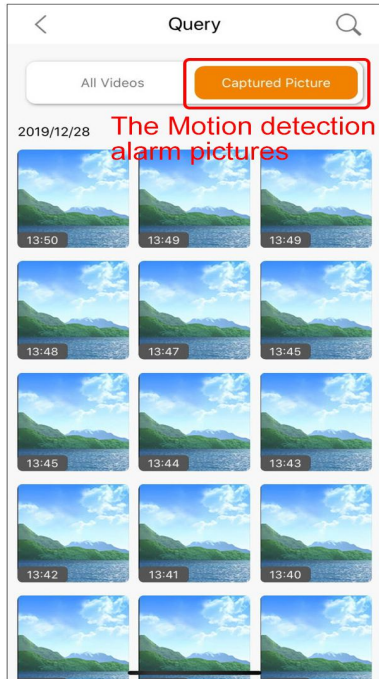

6.4 Setting interface

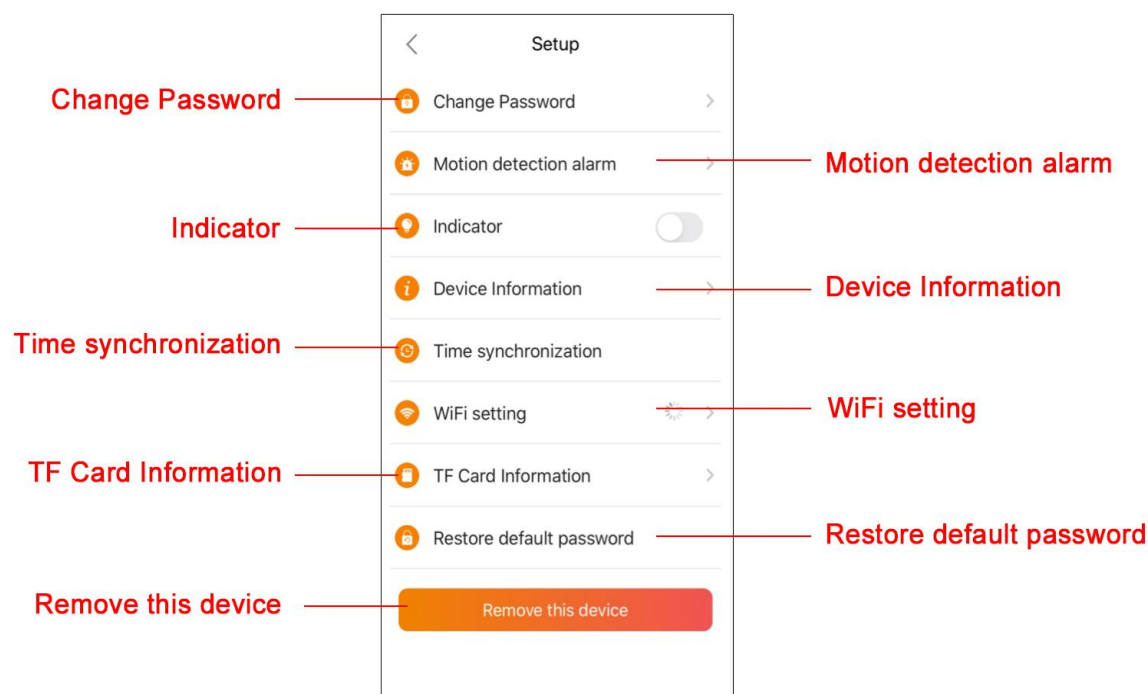

6.5 What are the functions of these buttons?

- ① **QR code button:** You can share the QR code to let other connect to this device.
- ② **Check video and Photo taken by APP:** Check the phone recording in your phone.
- ③ **Device name:** Click this button can adjust the device name.
- ④ **Video On / Off:** Click this button to start phone video recording.
- ⑤ **Snapshot:** Click this button to snapshot, the snap will save in your phone.
- ⑥ **Resolution:** Choose the resolution (High/Medium/Low) which you want.
- ⑦ **Device indicator on/off:** Turn on/ off the camera light.

- ⑧ **Restore default password:** Click this button the camera password will be restored to **ok123456**, and the camera will be turn off.
- ⑨ **Query: check video and photo recording:** Check the SD card recording file and motion detection alarm pictures.
- ⑩ **Query--All Videos:** Refers to the micro-SD card recorded files. Includes full time and motion detection mode recording video
- ⑪ **Query--Captured Picture:** Refers to the micro-SD card recording files. Renders an image from when motion was detected.

7. Reset The Device

1. **Reset camera the network:** Long press K2/M mode for about 8 seconds.
2. **Turn on/off the camera:** Long press K1/Power for about 5 seconds.
3. **Forced camera shutdown:** Use the pin and insert it in the hole at the back.
4. **“Restore default password”** : Click this button the camera password will be restored to **ok123456**, and the camera will be turn off.

8. Two ways recording

1. **Micro-SD card recording:** When you insert the micro-SD card, the camera will auto turn on 24 loop recording mode and the recording will be saved on your micro-SD card file. (When card is full, old records are overwritten)

2. Phone recording mode: Click the  icon, the camera will turn on phone recording, and the recording will save in your phone. (You need to connect the AP mode or IP mode)

Warning Tips:

① You can live-stream the footage from anywhere in the world once you connect the camera in IP mode to your home Wi-Fi network.

② When you insert the micro-SD card, the camera will auto-start 24 hour loop recording, that means although the camera has no Wi-Fi connection, it still records. (Therefore in this method, you can use this camera to record also outdoors)

③ You can use the USB cable to connect the camera and computer, and then you can check/transfer the SD card recording in your computer. Or you can use the card reader to transfer the micro-SD card recording to your computer.

9. Working Mode Switching

After initialization succeeds, if you press the Confirmation Button K1 once, the camera turns into standby mode. Then press Mode Button K2 to change the working mode between: Full Time Video/ Motion Detection.

1. Full Time Video Mode

After initialization succeed, camera starts recording automatically, if the camera working in AP mode, the **Blue** indicator flashes slowly, if the camera working in IP mode, **Red** indicator flashes slowly, the camera turns into Full Time Video Mode.

[Summary: Long press power button to turn on the camera → Wait one minute, and then the camera will successfully initialize → The camera will auto enter the full time recording]

2. Motion Detection Mode

In Full Time Video Mode, Full Time Video Standby Mode, Press Confirmation Button K1 once, the camera turns into Full Time Video Standby Mode. Then press Mode Button K2/M once, **Red** & **Blue** indicator keeps on, the camera turns into Motion Detection Standby Mode. When the camera detects object moving, **Blue** indicator keeps on & **Red** indicator flashes slowly (AP mode) or **Red** indicator keeps on & **Blue** indicator flashes slowly (IP mode), the camera starts recording automatically.

[Summary: How to turn Motion Detection Recording Mode: Click K1 →Click K2]

Warning tips:

- ① When using the motion detection mode for the first time, it takes about half an hour to save the recording. You can check the recording after half an hour.
- ② The Motion detection recording mode file is triggered every three minutes
- ③ If you do not insert a memory card, the **Red** and **Blue** lights will be on at the same time.

10. Functions Introduction

1. Motion detection function: The camera can send you an alarm message when it detects the moving objects.

How to set: Enter to APP- Tap the screen-- Click the gear icon-- Choose "Motion detection alarm" --Turn on the "Motion Switch" .



Warning tips:

- ① Motion detection function and motion detection recording mode are not the same!
- ② **Please ensure your phone allows the camera to push the alarm messages.**
- ③ Please change the AP mode to IP mode (AP mode cannot support motion detection function)
- ④ If you are watching live video, you will not receive an alarm message

⑤ Sometimes, if the network signal is not strong, the alarm message has a minute delay.

2. Full time recording: Just Insert the micro-SD card, the camera will turn on 24 hours loop recording. (When the card is full, it will continue recording by overwriting older recordings)

3. Night Vision: The night vision is Auto; it will turn on infrared lights automatically once the environment light is getting dim. (When the brightness is sufficient, night vision is off.)

4. Phone Recording & Snap: Click the button  to turn on the phone recording; Click the button  to snap the picture.

5. Real Time Video: Connect the AP mode or IP mode; you can check the real time video from anywhere. (The camera can transmit/build the hotspot)

6. Video playback: You can check the previous recording in your app or micro-SD card file.

7. Magnetic & 3MM Sticker: You can put it in many places.

11. Indicators Introduction

Camera Mode	Light Status
AP Connection Mode	Blue Light
IP Connection Mode	Red Light
Full Time Video Mode Working/Standby	Light Flashes / Light keeps on
Motion Detection Mode Working /Standby	Blue Light keeps on& Red Indicator Flashes; Red Light keeps on& Blue Light Flashes / Red & Blue Light keeps on
No Memory Card	Blue & Red Light Flashes at the same time
Connect USB & insufficient electricity	Yellow Light keeps on
Connect USB & Sufficient quantity of electricity	Yellow Light keeps off
Unconnected USB	Yellow Light keeps off

12. Questions & Answers

1. Question: How can I reset my camera network?

Answer: Long press M/K2 mode about 10 seconds to reset this camera. After this network will be back to AP mode, you need to reconnect again

2. Question: I have been trying repeatedly to set this up and it keeps saying offline?

Answer: ① Please put the camera in a place where there is a strong signal; Please confirm that the signal on your phone is good. ② Long press “M” mode to reset the camera network ③ Keep your phone and camera within 10 meters when you connect the first time; ④ Remove the device and reconnect again. ⑤ Check if your Wi-Fi setting is correct, make sure you use the proper password ⑥ Check our **YouTube** link to know how to install: <https://youtu.be/eKSridyEN3E>

3. Question: What's AP mode & IP mode?

Answer: AP connection mode: camera creates a Wi-Fi hotspot to allow the smart phone for short distance previewing; the light is blue. IP connection mode: camera connects to the home router for unlimited distance preview image. The light is red.

4. Question: How to change AP mode to IP mode?

Answer: Enter to APP → Tap the Screen → Click the gear icon → Choose Wi-Fi Setting → Select your router Wi-Fi → Enter your Wi-Fi password → Select “OK” .

5. Question: Can it be accessed anywhere via the internet or by the app?

Answer: You can live-stream the footage from anywhere in the world once you connect this mini camera to your home Wi-Fi network. (Only works in IP mode)

6. Question: Can I use it on outdoors? Or can I use it without Wi-Fi?

Answer: ① Insert the Micro SD card, the camera will turn on 24 hour loop recording (NO Wi-Fi need), so you can use it on outdoors. ② The camera can transmit/launch the hotspot, so you can connect the smartphone to the camera hotspot to check the real-time video.

Warning tip: This camera can run about 8 hours in full charge, If you are using it outdoors for a long time, please prepare a backup power supply.

7. Question: How to set motion detection?

Answer: Enter to APP- Tap the screen-- Click the gear icon-- Choose "Motion detection alarm" --turn on the "Switch" and then confirm.

Warning tips: Please make sure your phone allows the APP to push notifications. If you put the camera in a place with strong Wi-Fi signal, it will work much better.

8. Question: How do I stop the camera from reflecting in the glass?

Answer: You can try to turn off the indicator light: Enter the mobile APP--Tap the screen--Click the gear icon--Choose the "Indicator" Turn it off

9. Question: How can I turn on the night vision?

Answer: The night vision is Auto, it will turn on infrared lights automatically once the environment getting dim.

10. Question: How do you know when the battery needs charging?

Answer: You can use the light to judge. Connect to USB charger and if the YELLOW light is on then the camera is charging; if the light goes off then the battery is fully charged.

11. Question: How long it takes to fully charge the battery?

Answer: It takes about 8 hours to fully charge the battery.

12. Question: What's the function of the pin?

Answer: Use the pin to insert it in the hole to force camera shutdown.

13. Question: How to restore the default password:

Answer: Plug in the power → Click the power button, and then the light will keep turn on → Long press power button about 5 seconds → The camera will automatically restart and restore the default password.

13. Attention !

1. Please note this camera does not support 5G network for remote use. Please connect it to 2.4G Wi-Fi.
2. Use an adequate charger with output voltage 5V/2A.
3. Do not drop this product or subject it to strong impact.
4. Do not touch the camera lens and image sensor directly. If you need to clean it, please use a soft fabric slightly moistened with alcohol and wipe gently.
5. Avoid exposure to bright light, such as strong sunlight or focusing on bright lamps because the images recorded will be too bright and will reduce the life of the photosensitive sensor;
6. Avoid working under extreme conditions such as moisture, dust, extreme cold, extreme heat, etc. Use between -5° C to 50° C. Do not place in strong electromagnetic radiation fields.
7. Avoid heat accumulation, do not block the ventilation slits of the camera and keep a good cooling space around the camera.
8. Please strictly abide to the relevant laws and decrees of the state, and do not use this product for any illegal purposes, otherwise the consequences will be conceited.
9. Please format the micro-SD card before using and also once every three months.

14. 12-Months No Risk Guarantee

We offers you a 12-month warranty without risk. If you have any questions when using our product, you can contact us at any time by email. We will promptly respond to your questions or help requests.

It is important to us to build a happy and satisfied customer base. If you have any suggestions for this camera, please contact us at

Our service email:

Support_Jayol@163.com