



SMART Sprinkler

Model: SW-C04-02

User Guide and Instrction

Version number: SP202202-LCD-DR15

Dear friend,

Thanks for choosing our smart sprinkler product! Your satisfaction as a sPlant customer means everything to us. Before using this unit, please read these operating instructions carefully, take special care to follow the warning and safety suggestions. If you have any question or problem during using our product, please contact our customer service and your problem will be solved within 24hrs. Contact on Amazon: Click on "Ask a question" Email: splant-us@outlook.com Website: www.spriro.com

Thank you!
Enjoy building your custom loop using the Smart Sprinkler

sPlant

What's in the Box

Content	SW-C04-02
Smart Sprinkler	1
User Guide and Instruction (This Document)	1
Soft watering pipe	10m/33ft.
Drippers	15
T-Connector	14
Filter	1
USB Power cable	1

Product Specification

Model	SW-C04-02
Power supply way (Not recommended at the same time)	1. AA Battery x4 2. USB power supplier(DCSV 2A)
Working temperature	0-40°C/32-104°F
Water flow	800ml/minute
Waterproof Grade	Not Waterproof (Pls keep it out of water)
Dimension	100*100*80mm / 3.94*3.94*3.15 in
Package dimension	215*170*90mm / 8.46*6.69*3.54 in

Design Your Watering Loop

The first task at designing your custom watering loop, your custom watering loop contains:
- Water source generally a container (not supplied) of water
- A source to cut the pipe
- A cup of hot water (Softens the pipes to set the T-connector and drippers easier)
- The smart sprinkler unit set

We recommend you to draw a design map of your loop, which indicate where the T-connectors will be used. Such a design will help you to determine how to cut the soft pipe and prevent wastes.

- The following considerations are advised for your design:
1. This smart sprinkler is designed to watering up to 15 plants, because of high power pump you'd better to set up more than 4 drippers (in the container).
 2. For even water flow, the plants should not 2 meters over than the water source (in the container).
 3. The inlet pipe should not be more than 3 meters, the outlet pipe should not be more than 10 meters.

4. The important is the smart sprinkler unit should be placed above the water source for prevent Siphon.

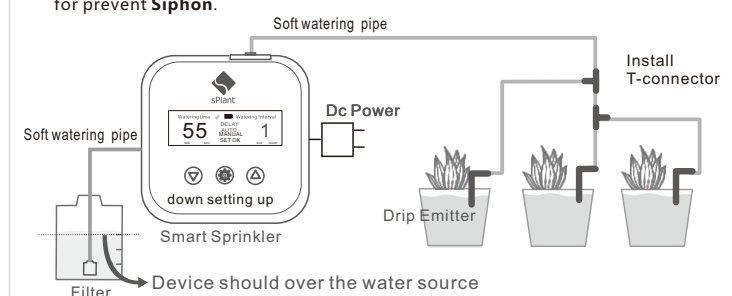

Assemble Your Watering Loop

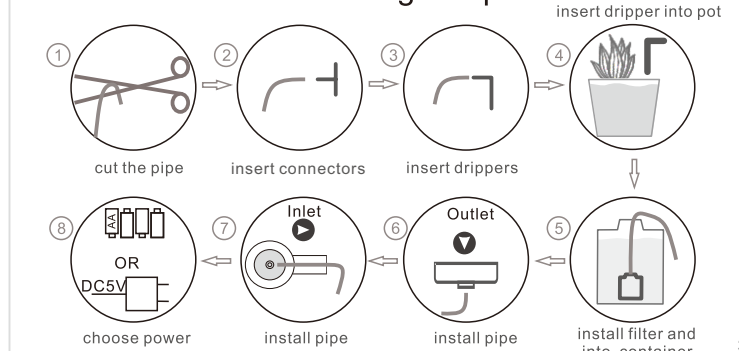

Smart Sprinkler Operation

Manual Mode (Means watering anytime, it won't disturb the timer you already set.)
Press and hold the Middle button (Setting button) for 3 seconds, then manual watering is on. You can press again to stop manual watering. If your "Watering Time" is settled up, then the device will stop when finish the "Watering Time".

Watering Time (Means the watering duration.)
Press the Setting button once the watering time on the left starts to flash, indicating that you can start to set. Press the up and down button to set the watering time (Time range: 5-55seconds or 1-59 min). After setting is done, press the Setting button again means save and complete, then "set ok" shows on screen and goes into setting the next step.

Attention: In order to ensure that the water flow is your need, you should press the manual mode to test the "watering time". The count of drippers and the high of your plants make different flow you get.

Watering intervals (Means the time between the last watering time and the next.)
After you set up the "Watering Time", it will enter into the "Watering Interval" setting. The "Watering Interval" starts to flash, indicating that you can set it now. Press up and down button to set the watering interval. (Time range: 1-30 days or 1-23hrs). After setting is done, press the Setting button again means save and complete, and goes into setting the next step.

Delay time (Means the first watering time you want.)
The "Delay" starts to flash, indicating that you can start to set. Press the up and down button to set the delay time (Time range: 0-30 days or 0-23 hours). After setting is done, press the setting button again means save and complete, then "set ok" shows on screen and press setting button again. And programs are saved and will be run automatically.

Attention: This is an optional function. If you don't need it please choose 0 days and 0 hours; when you set 1 day, your first watering time is the next day; when you set 10 hours, your first watering time is 10 hours later. This function won't disturb the timer you already set.

Example:
If your plants need: Watering every day at 9 am, 2 mins each time.

Way1: You can set the device time at 9 am

(1) Set the "watering time" to "2" min, (2) "Interval time" to "1" day, (3) "Delay time" to "0". When you "set ok" the device will work promptly, by 9 am the next day, the device will work again, and so on.

Way2: You can set the device time at 8 am.

(1) Set the "watering time" to "2" min, (2) "Interval time" to "1" day, (3) "Delay time" to "1" hour. When you "set ok" the device will work 1 hour later (at 9 am), by 9 am the next day, the device will work again, and so on.

Q&A Trouble Shooting Guide

This part will be updated on the listing, please refer to the page.

Maintenance and Services

Email: splant-us@outlook.com
Manufacturer: Guangdong sPlant Technology Co., Ltd.
Address: Room 106 or 107, Jinhuazhong Industrial Park, No. 1, Nengxin Road, Huangpu District, Guangzhou, China

Made in China

