

piOrifyTM
CLEAN AIR AND WATER

HYDROGENATOR[®]

USER MANUAL





HYDROGENATOR®

USER MANUAL

www.purify.com

SAFETY GUARD/CAUTION

Please review the safety guards and cautions below carefully to ensure the proper performance of this product and your safety.

To safely and correctly use this product, please read the following tips:



WARNINGS FOR YOUR SAFETY

Don't place or use it around or near fire or under direct sunlight.

Don't set it on fire.

Don't pour flammable liquid in.

Do not place in microwave and hand-wash only.

Don't use wet hands to touch the bottle while it's charging.
If there is water vapor around the charge port, wipe and dry before charging.

Please clean dirt and dust around the port before charging.

Keep the connection fastened between the bottle and the cord, do not tie, flex, stretch, or twist the cable while in use.

*All the above behaviors are forbidden because these could lead to glass fracture, battery explosion, electric shock, short circuit and even fire.

Drinking hydrogen-rich water is forbidden for pacemaker carriers or people with tech equipment in their bodies. This is due to the subtle current within hydrogen. Water can influence equipment on the human body.

Drink hydrogen-rich water must not be reserved. Drink it right after it's generated.

Put the bottle out of infants' reach to prevent them from swallowing bottle parts.

Make sure that the bottle lid and screws are tightly fastened before carrying it.

Keep the bottle upright at any moment (Generating water or in your bag). If the bottle lay down, some water could be released through the pressure reduction valve.

Don't drop the bottle or enforce it too much. These may cause deformation and damage to it.

Don't freeze the bottle. It could lead to malfunction and glass fracture.

Refresh and clean the bottle before first use.

Don't use metal brushes to clean the inner bottle. Use soft tools and neutral detergents.

Don't pour other liquid in the bottle except water. Other liquids could stain the electrode plate.

Don't use bottles underwater. This leads to the malfunction of the product.



HYGIENIC USE

Frequently clean the inner bottle to keep hygienic use.



Never use chlorine bleach nor scrub brush when cleaning this product.

Don't drink long reserved water (Try not reserve water).
*If you compare it with normal water, hydrogen rich water is easier to breed bacteria.

PRODUCT PARAMETERS

Product Name	PIRUIFY Water HydroGenerator® H2 Water Generator
Voltage	DC12V/2A
Power	15W
Net Weight	4.8 lbs.
Bottle Capacity	50oz (1500ml)
Product Size	8.3 x 7.1 x 13.2 Inch
Bottle Size	4.9 x 8 x 9.8 Inch
Hot/Cold	N/A
Material	<ul style="list-style-type: none">• PC - Polycarbonate (Pitcher)• PP - Polypropylene (Filter's housing)• Titanium platinum (Generator)• ABS (enclosure)• Silica Gel (Sealing element)
Liquid Temperature	41~100°F (5~38°C)
Water Source	Direct Drinking Water

COMPONENTS

INCLUDED IN THE BOX

- 1x HydroGenerator® stander
- 1x Water pitcher
- 1x Calcium sulfite filter
- 1x Power Adapter with US plug
- 1x User Manual



Water pitcher



HydroGenerator® stander



Calcium sulfite filter



Power Adapter



User Manual

PRECAUTIONS



The water quality requirement of water source

The water quality is complied with "Standards for Drinking water Quality."



Use for the first time

When used for the first time or not used after a long period, please wash properly before using it.



Environment and temperature

Please use it at a temperature of 5 to 45° and in dry condition



Storing of hydrogen water

Place and freeze the hydrogen water in the refrigerator after it is sealed properly; by doing so, the active level of the hydrogen water can be preserved longer. It is suggested that the water should be consumed as soon as possible.



Avoid direct sunlight

Please do not place the product under direct sunlight.



Freezing prevention

Do not keep or expose the product in an environment under 0°.



Prohibit to drink

Do not drink the water generated from self-cleaning.

FUNCTIONS

Magnetic Water

The Vortex motion aerates the water and causes:

- **Balanced Oxygen**
- **Raised pH levels**
- **Released VOCs**
- **Helps retain the H2** for up to 3x times longer.

Use this function right before H2 Infusion for maximum benefits

Self-cleaning

Maintain the pitcher always fresh and clean. Use this function once after every 10 cycles of hydrogen infusion.



H2 Water Standard

Standard infusion of pure hydrogen into the drinking water (8 min)

H2 Water Higher

Strong infusion of pure hydrogen into the drinking water (13 min)

MAGNETIC WATER

Innovative Vortex Technology



Infusion of oxygen

The vortex allows atmospheric oxygen to enter, and dissolved oxygen to exit. Just like breathing.



Raised pH levels

The swirling motion increases the evaporation of dissolved volatile compounds (such as chlorine and CO₂); this outgassing of CO₂ from the water reflects in increased pH levels.



Helps retain the H₂

for up to 3x times longer.

Use the 'Magnetic Water' function right before H₂ Infusion for maximum benefits.



INSTRUCTIONS



1

Rinse with water: Take out the body of the cup, open the lid, rinse the cup thoroughly with water. Do not rinse the connecting latch at the bottom of the cup with water. Take out the filter and rinse it under running tap water for one minute, and then use clean water to rinse it one more time before putting it into the cup, which is already cleaned with water.

2



Fill with drinking water: Fill with household drinking water complied with "Standards for Drinking Water Quality." Pure water or mineral water can also be used.

3



Place into position: Place the cup into the position on the base and close the lid.

4



Connect with power: Connect the output socket of the power adapter into the machine and plug in the power cable; the buzzer will then provide an audible signal.

5



Power on the product: When the product is in standby mode, press the

power key and then the buzzer will beeps once, the power indicator and the other buttons light will turn on, the product enters function to set up waiting mode.

6

Function selection: when product is switched on



6.1 H2 Water Higher:

When this key is pressed, the buzzer beeps once. The indicator light under the H2 Water Higher key is turned on, and "13" is shown on the digital display at the same time. The machine enters strong hydrogen production mode with the blue color LED turned on.

After every minute, the digital display will be cut down by one. When "00" is reached on the digital display, the buzzer beeps six times, and the color light will turn off. The machine returns to standby mode.

6.1 H2 Water Standard:

When this key is pressed, the buzzer will beeps once. The indicator light under the H2 Water Standard key is turned on, and "08" is shown on the digital display at the same time.

The machine enters standard hydrogen production mode with the blue color LED light turned on. After every minute, the digital display will be cut down by one. When "00" is reached on the digital display, the buzzer will beeps six times and the color light will turn off. The machine returns to stand by mode.

6.2 Magnet Water: When this key is pressed, the buzzer beeps once, the indicator light under the Magnet Water key is turned on, and "10" is displayed on the digital display at the same time. The machine enters oxygen production mode with the blue color LED light turned on.

After every minute, the digital display will be cut down by one. When "00" is reached on the digital display, the buzzer beeps six times, and the color light turns off. The machine returns to standby mode.

6.3 Self-cleaning: After this key is pressed, the buzzer beeps once, the indicator light under the Self-cleaning key is turned on, and "01" is displayed on the digital display at the same time. The machine enters flush mode with the blue color LED light turned on. After every one minute, the buzzer beeps six times with the color light turned off. The machine enters standby mode.

7



Switching functions: If the user wants to switch to another function from the current function, the current function key must be pressed to stop the current function. After that, press the function key that the user wants to switch to.

8



In operation: The bottom of the cup starts generating bubbles, and blue color light displays to indicate that the machine is operating.

9



End of operation: When the time reaches what it is set for, the product will stop operating. The blue color light turns off and the machine enters standby mode.

Pressing the power key when the machine is in operation can force it to stop immediately.



When you notice that it gives off hydrogen bubbles less than usual, clean the generator according to the guidelines stipulated in this manual below.

CLEANING

Do not directly wash or soak the product in water in order to prevent water damage to the machine.



USE OF POWER ADAPTER

The power adapter is only suitable for this product.

Our company will not be responsible for any consequences that result from using it for other products or applications.

MAINTENANCE

- Do not use volatile solvents such as detergent, thinner, etc. to clean the cup.
- Do not fill the cup with drinks other than drinking water.
- The machine should be flushed once after every 10 electrolytic processes.
- If there is fewer bubble than usual generated when the machine operates, there could be dirt built up at the electrodes. It can be cleaned by taking out the filter in the machine and then pouring in edible vinegar. After two hours, shake it for two minutes, then pour out the vinegar and wash it with clean water.

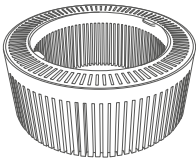

Please replace cartridge every
3 (three) months of daily use.

YOUR HARDWARE WARRANTY



PIURIFY One (1) Year Limited Warranty

for your Water Hydrogen Infuser
PIURIFY Branded Products Only

WHAT IS COVERED BY THIS WARRANTY?

PIURIFY warrants the water softener product and accessories contained in the original packaging against defects in materials and workmanship when used normally in accordance with this user manual. The standard warranty is valid for ONE (1) YEAR from the date of original retail purchase by the end-user purchaser ("Warranty Period"). PIURIFY's guidelines include but are not limited to information contained in technical specifications, user manuals, and service communications.



You can **extend** your warranty to
18 MONTHS by registering your
product on www.piurify.com/warranty.



www.purify.com

piurify[™]
CLEAN AIR AND WATER

www.piurify.com