

NUTRI NINJA®

BL480 Series
OWNER'S GUIDE



IMPORTANT SAFETY INSTRUCTIONS

For Household Use Only

WHEN USING ELECTRICAL APPLIANCES, BASIC SAFETY PRECAUTIONS SHOULD ALWAYS BE FOLLOWED, INCLUDING THE FOLLOWING:

READ ALL INSTRUCTIONS BEFORE USING YOUR NUTRI NINJA® WITH AUTO-iQ®.

POLARIZED PLUG

⚠ WARNING: To reduce the risk of electric shock, this appliance has a polarized plug (one blade is wider than the other). This plug will fit into a polarized outlet only one way. If the plug does not fit fully into the outlet, reverse the plug. If it still does not fit, contact a qualified electrician to install the proper outlet. **DO NOT modify the plug in any way.**

⚠ WARNING: Extension cords are not recommended for use with this product.

⚠ WARNING: TO REDUCE THE RISK OF FIRE, ELECTRIC SHOCK OR INJURY:

- 1 ⚠ WARNING:** Remove utensils prior to processing. Failure to remove may cause the jar to be damaged or to shatter which may cause personal injury.
- 2 ⚠ CAUTION:** Blade assembly is sharp, handle with care. When handling the blade assembly, always hold it by the base.
- 3 ⚠ CAUTION:** DO NOT blend hot liquids, as doing so may cause excessive pressure buildup, resulting in risk of the user being burned.
- 4 ⚠ CAUTION:** We do not recommend grinding in any of our Nutri Ninja® Cups.
- 5 ⚠ CAUTION:** Remove the Pro Extractor Blades® Assembly from the Nutri Ninja Cup upon completion of blending. DO NOT store ingredients before or after blending them in the cup with the blade assembly attached. Some foods may contain active ingredients or release gases that will expand if left in a sealed container, resulting in excessive pressure buildup that can pose a risk of injury. For ingredient storage in the cup, use only spout lid to cover.
- 6** To protect against electrical shock, **DO NOT** submerge the appliance or allow the power cord to come into contact with water or any other liquid.
- 7 DO NOT** allow young children to operate this appliance or use as a toy. Close supervision is necessary when any appliance is used near children.
- 8** Never leave an appliance unattended when in use.

- 9** Appliance accessories are not intended to be used in the microwave as it may result in damage to the accessories.
- 10** Remove the power cord from the electrical outlet when not in use, before assembling or disassembling parts and before cleaning. To unplug, grasp the plug and pull from the electrical outlet. Never pull from the power cord.
- 11 DO NOT** abuse the power cord. Never carry the appliance by the power cord or yank it to disconnect from electrical outlet; instead grasp the plug and pull to disconnect.
- 12 DO NOT** operate any appliance with a damaged cord or plug, or after the appliance malfunctions, has been dropped or damaged in any manner. This appliance has no serviceable parts. Return the appliance to SharkNinja Operating LLC for examination, repair or adjustment.
- 13 DO NOT** let the power cord hang over the edge of table or counter or touch hot surfaces such as the stove.
- 14** Always use appliance on a dry, level surface.
- 15** Keep hands, hair, clothing, as well as utensils out of container while processing to reduce the risk of severe injury to persons or damage to the appliance. A scraper may be used but only when the appliance is not running.
- 16** Avoid contact with moving parts.
- 17 DO NOT** attempt to sharpen blades.
- 18 DO NOT** use the appliance if blade assembly is bent or damaged.
- 19** To reduce risk of injury, never place the blade assembly on base without the Nutri Ninja® Cup properly attached.

- 20 DO NOT** operate this appliance on or near any hot surfaces (such as gas or electric burner or in a heated oven).
- 21** The use of attachments or accessories (including canning jars) not recommended by the manufacturer may result in fire, electric shock or personal injury.
- 22 DO NOT** remove the cup from the motor base while the appliance is in operation.
- 23** To reduce the risk of injury, **NEVER** operate the appliance without the lid in place. **DO NOT** try to defeat the interlock mechanism; make sure that the attachment is properly installed before operating the appliance.
- 24 DO NOT** expose cups to extreme temperature changes.
- 25 DO NOT** overfill.
- 26 DO NOT** operate the appliance empty.
- 27** If the appliance overheats, a thermal switch will become activated and shut off the motor. To reset, unplug the appliance and let it cool down for approximately 30 minutes before using again.
- 28 THIS PRODUCT IS INTENDED FOR HOUSEHOLD USE ONLY. DO NOT** use this appliance for anything other than its intended use. **DO NOT** use outdoors.

SAVE THESE INSTRUCTIONS

Contents

**Thank you for
purchasing the
Nutri Ninja® with
Auto-iQ®**

Getting to Know Your Nutri Ninja® with AUTO-iQ®.....	5
Before First Use	7
Use	8
Suggested Uses.....	9
Care & Maintenance	10
Troubleshooting Guide.....	11
Replacement Parts.....	11
Warranty & Registration.....	14

TECHNICAL SPECIFICATIONS

Voltage: 120V., 60Hz.
Power: 1000 Watts

Cup Capacity:
32 oz. (4 cups, 950 ml)
24 oz. (3 cups, 710 ml)
18 oz. (2.25 cups, 532 ml)



Getting To Know Your Nutri Ninja® with Auto-iQ®

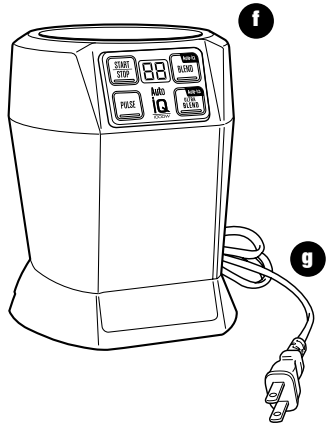
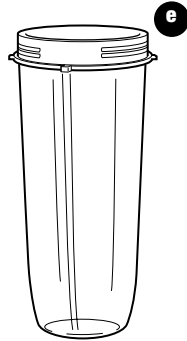
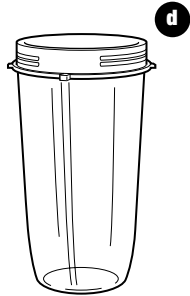
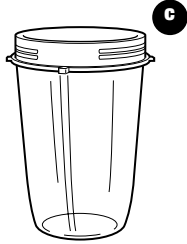
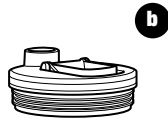

a Pro Extractor Blades® Assembly

b Spout Lid

c 18 oz. Nutri Ninja Cup

d 24 oz. Nutri Ninja Cup

e 32 oz. Nutri Ninja Cup

f Motor Base

g Power Cord

NOTE: The quantity, sizes, and presence of some accessories depend on the specific model configuration. All configurations include a motor base, Pro Extractor Blades Assembly, certain Nutri Ninja cups, spout lids, and instructions.

Welcome to the Ninja® Auto-iQ® Experience! The Nutri Ninja® with Auto-iQ features pre-programmed settings that take the guesswork out of making delicious drinks and great-tasting meals. These programs are timed to deliver consistent, delicious results that finish on their own so all you have to do is press a button and enjoy.

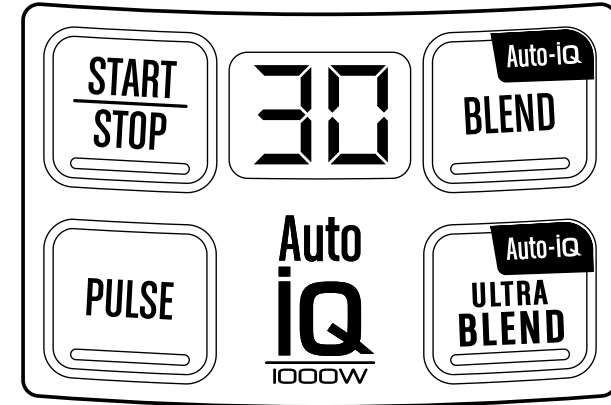

FEATURES:

- **Nutrient & Vitamin Extraction***

- **1000-Watt Motor**

- **User Interface:**

START | STOP

Press once to start continuous running; press again to stop. Timer counts up by seconds, up to 60 seconds.

PULSE

Runs only while pressed down. Short presses make short pulses. Timer counts up by seconds as long as pressed down.

AUTO-iQ BLEND

Pulses and blends fresh or softer ingredients to create smooth, consistent results. Timer counts down.

AUTO-iQ ULTRA BLEND

Pulses and blends frozen, fibrous, or hard ingredients to create consistently smooth results. Timer counts down.

- **Personalized, healthy drinks and juices**

- **Spout lids for drinks on the go**

- **Nutri Ninja Cups, BPA free**

- **Cord storage**

*Extract a drink containing vitamins and nutrients from fruits and vegetables.

Before First Use

PLEASE KEEP THESE IMPORTANT SAFEGUARDS IN MIND WHEN USING THE APPLIANCE:

IMPORTANT: Make sure the motor base is plugged in for use.

IMPORTANT: DO NOT attempt to operate the appliance without the lid on.

IMPORTANT: Never run the appliance empty.

IMPORTANT: Appliance accessories are not intended to be used in the microwave, as it may result in damage to the accessories.

CAUTION: DO NOT immerse the motor base in water or any other liquid.

- 1 Remove all packaging material and labels from the appliance. Separate/remove all parts.
- 2 Wash the lids, Nutri Ninja® Cups, and Pro Extractor Blades Assembly in warm, soapy water. When washing the Pro Extractor Blades Assembly, use a dishwashing utensil with a handle to avoid direct hand contact with blades.

WARNING: Handle the Pro Extractor Blades Assembly with care when washing, as the blades are sharp.

- 3 Handle the Pro Extractor Blades Assembly with care to avoid contact with sharp edges. Rinse and air-dry thoroughly.
- 4 The Nutri Ninja Cups, lids, and Pro Extractor Blades Assembly are all dishwasher safe. The lids and Pro Extractor Blades Assembly are top-rack dishwasher safe. Ensure the Pro Extractor Blades Assembly is removed from the cup before placing in the dishwasher.
- 5 Wipe the motor base clean with a damp cloth.

Use

- WARNING:** Handle the Pro Extractor Blades Assembly with care, as the blades are sharp.
 - WARNING:** Never leave the appliance unattended while in use.
 - WARNING:** Remove utensils prior to processing. Failure to remove may cause the bowl to be damaged or to shatter, which may cause personal injury.
 - CAUTION:** DO NOT blend hot liquids, as doing so may cause excessive pressure buildup, resulting in risk of the user being burned.
 - CAUTION:** Remove the Pro Extractor Blades Assembly from the cup upon completion of blending. DO NOT store ingredients before or after blending in the Nutri Ninja® Cup with the blade assembly attached. Some foods may contain active ingredients or release gases which will expand if left in a sealed container, resulting in excessive pressure buildup that can pose a risk of injury. For ingredient storage in the cup, use only spout lid to cover.
- IMPORTANT:** Make sure that the motor base is plugged in for use.

ASSEMBLY

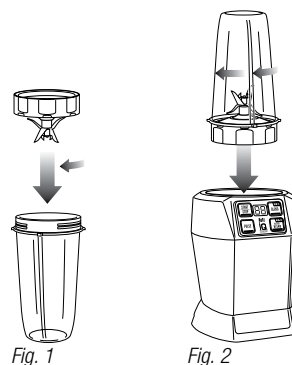

USE

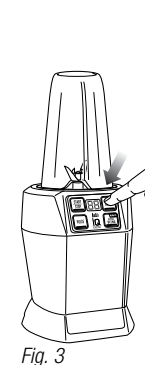

REMOVAL

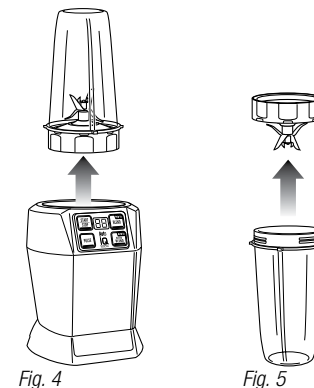

- 1 Review warning and caution statements above before proceeding to step 2.
- 2 Place the motor base on a clean, dry, level surface such as a counter or tabletop.
- 3 Make sure the motor base is plugged in for use. Display will read "--".
- 4 Add ingredients to the Nutri Ninja Cup.
NOTE: Do not overfill. To avoid spilling, DO NOT add ingredients past the "MAX" fill line.
- 5 Place the Pro Extractor Blades Assembly onto the cup and twist it on tightly until completely sealed. (Fig. 1)
- 6 Turn the cup upside down and place it onto the motor base, aligning the tabs on the cup with the motor base. Once cup is correctly placed onto base, display will read "0". (Fig. 2)
- 7 Press one of the buttons to activate. (Fig. 3)

NOTE: When using the Auto-iQ® presets, the unit will operate using pulses, pauses, and continuous runs. The pauses allow the contents of the cup to settle. When the timer reaches "0", the unit will stop by itself.

- 8 To remove the cup from the base, ensure the motor has stopped running, then pull the cup straight up. (Fig. 4)
- 9 Turn the cup upright and remove the Pro Extractor Blades Assembly by twisting it counterclockwise. (Fig. 5)
- 10 DO NOT store blended contents with the Pro Extractor Blades Assembly attached.
- 11 Place the Spout lid onto the Nutri Ninja Cup, twist to seal and enjoy.
- 12 For ingredient storage in the cup, only use Spout lid to cover.
- 13 Be sure to store the Pro Extractor Blades Assembly attached to an empty cup when not in use.

Suggested Uses

⚠ CAUTION: DO NOT process dry ingredients without adding liquid to the cup. This product is not intended for dry blending.

PURPOSE / FUNCTION	SUGGESTED CUP	TYPE OF FOOD
Chopping/Pulsing	18 oz. 24 oz. 32 oz.	Salsa Leafy Herbs
Mixing	24 oz. 32 oz.	Batters Dips
Sauces	24 oz. 32 oz.	Vinaigrettes Salad Dressings Sauces*
Frozen Blending	18 oz. 24 oz. 32 oz.	Ice Frozen Fruit Ice Cream
Nutrient Juices/Smoothies	18 oz. 24 oz. 32 oz.	Fruits Vegetables Leafy Greens

* When blending sauces, make sure they're cooled to room temperature first. Ninja® containers are not intended for hot blending.

FILLING YOUR NUTRI NINJA®

For best results, always follow recipe directions when filling your Nutri Ninja® Cups. When you're not using a recipe, use the following guidelines:

Start with your fresh fruit or veggies. Then add any nuts, seeds, or powder followed by any liquids like juice or milk. More liquid can help to integrate powder. Then add your frozen fruit and ice. Remember to securely tighten the Pro Extractor Blades® Assembly and don't overfill the cups.

(Fig. 7)

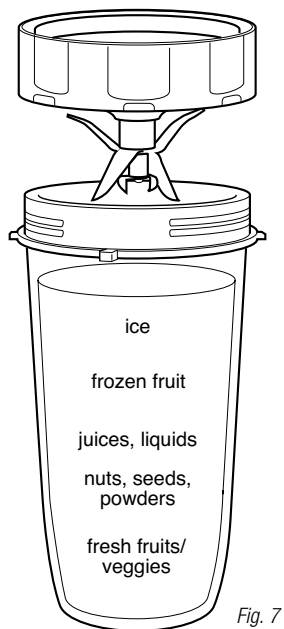

Fig. 7

Care & Maintenance

HOW TO CLEAN

⚠ CAUTION: Make sure that the motor base is unplugged from the power source before inserting or removing any attachment and before cleaning.

⚠ CAUTION: DO NOT immerse the motor base in water or any other liquid.

- 1 Separate/remove all parts.
- 2 **Hand-Washing:** Wash the lids, Nutri Ninja® Cups, and Pro Extractor Blades® Assembly in warm, soapy water. When washing the Pro Extractor Blades Assembly, use a dishwashing utensil with a handle to avoid direct hand contact with blades. Handle Pro Extractor Blades Assembly with care to avoid contact with sharp edges. Rinse and air-dry thoroughly.

Dishwasher: The Nutri Ninja Cups, lids, and Pro Extractor Blades Assembly are all dishwasher safe. The lids and Pro Extractor Blades Assembly are top-rack dishwasher safe. Ensure the Pro Extractor Blades Assembly is removed from the cup before placing in the dishwasher.

⚠ WARNING: Handle the Pro Extractor Blades Assembly with care when washing, as the blades are sharp. Contact with the blades' edges can result in laceration.

- 3 Wipe the motor base clean with a damp cloth.

If the appliance needs servicing, please call Customer Service at 1-877-646-5288.

HOW TO STORE

- 1 Store the Nutri Ninja® with Auto-iQ® upright with the blade assembly inside the corresponding container with the lid secured on top. **DO NOT** place anything on top. Store the rest of the attachments in a safe place where they will not be damaged and won't cause harm. Loosely wrap the power cord around the motor base.

NOTE: DO NOT store blended or unblended ingredients in the Nutri Ninja Cup with the blade assembly attached.

RESETTING THE MOTOR THERMOSTAT

The Nutri Ninja with Auto-iQ features a unique safety system that prevents damage to the unit's motor and drive system should you inadvertently overload your appliance. If the appliance is overloaded, the motor will stop. To reset the appliance, follow the resetting procedure below:

- 1 Unplug the appliance from the electrical outlet.
- 2 Remove and empty the cup and ensure no food is jamming the Pro Extractor Blades Assembly.
- 3 Allow the appliance to cool for approximately 30 minutes.
- 4 Reinstall the cup onto the base and plug the appliance into the electrical outlet.
- 5 Proceed to use the appliance as before, while making sure not to exceed the recommended maximum capacities.



SharkNinja Operating LLC

US: Needham, MA 02494

CAN: Ville St-Laurent, QC H4S 1A7

1-877-646-5288

ninjakitchen.com

© SharkNinja Operating LLC 2017

AUTO-IQ, NINJA, NUTRI NINJA, and PRO EXTRACTOR BLADES are registered trademarks of SharkNinja Operating LLC.

For SharkNinja U.S. Patent information, visit sharkninja.com/USPatents.

Printed in China

BL480DOB_E_(BL480_BL482)_IB_170825