



WT2 EDGE USER GUIDE

—— V3.0 ——

WT2 Edge – Device Pairing

- 1) Select the earbuds model to pair.
- 2) Enable Bluetooth and location permissions.

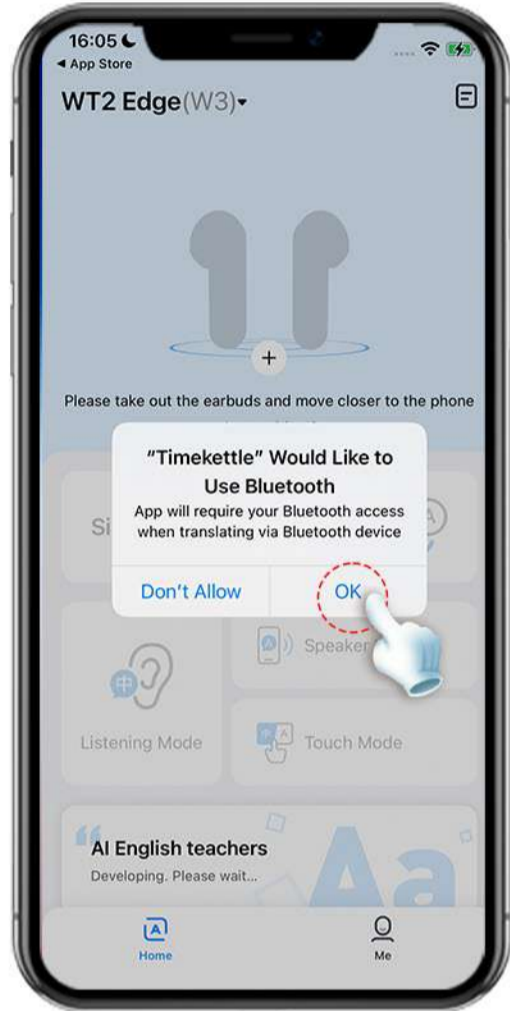

- 3) Remove the earbuds from the charging case, and tap [+] to find the earbuds you want to pair.

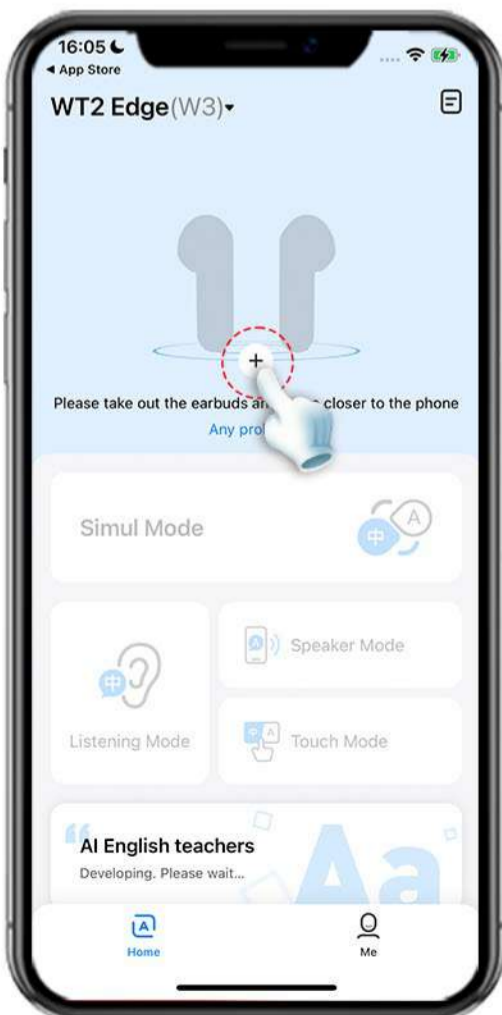

4) When the left and right earbuds are found in [New Connection], tap [Connect] for each. After successful connection, tap [OK] to enter [Home].

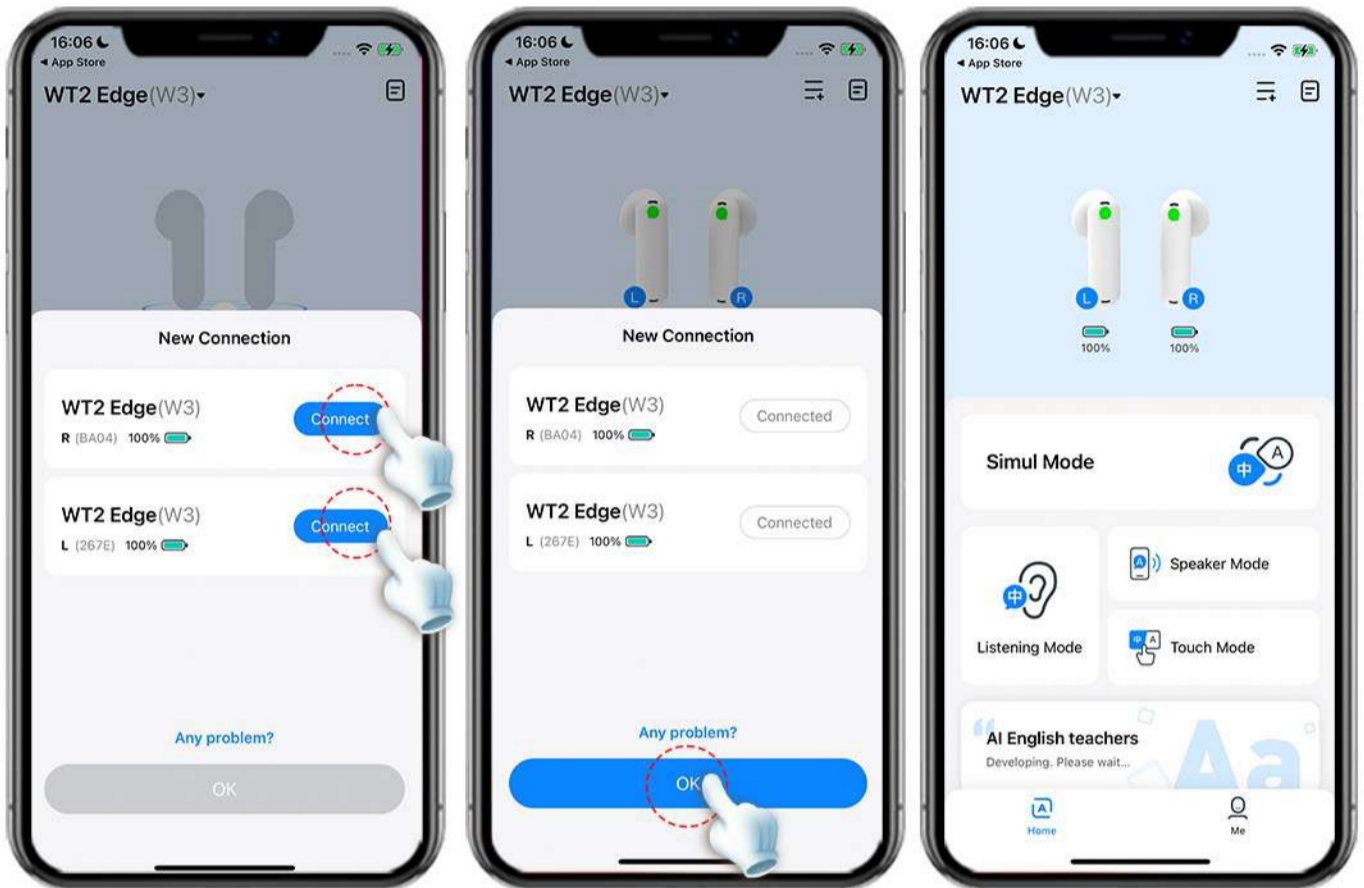

Notes:

1. In order to find and pair the earbuds, it is necessary to enable the Bluetooth and location permissions for Timekettle APP and also turn on the Bluetooth and Location Services in the smartphone Settings.
2. If [New Connection] does not pop up automatically, just tap [+] to enter.

WT2 Edge – Listen Mode

1) Just wear one earbud and tap [Listen Mode] (in [Listen Mode], if the other earbud is also connected, do not place it back into the charging case; if it is not connected before use, you can put it back in the charging case).

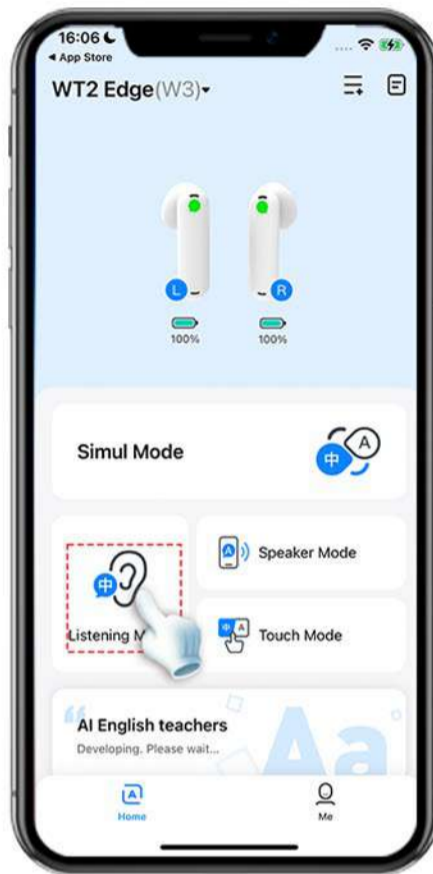

2) Set the source languages for both the earbud user and the smartphone user.



3) Tap the microphone icon to pick up voice and move the smartphone close to the sound source.



4) Tap the wavy lines to pause before returning to [Home].

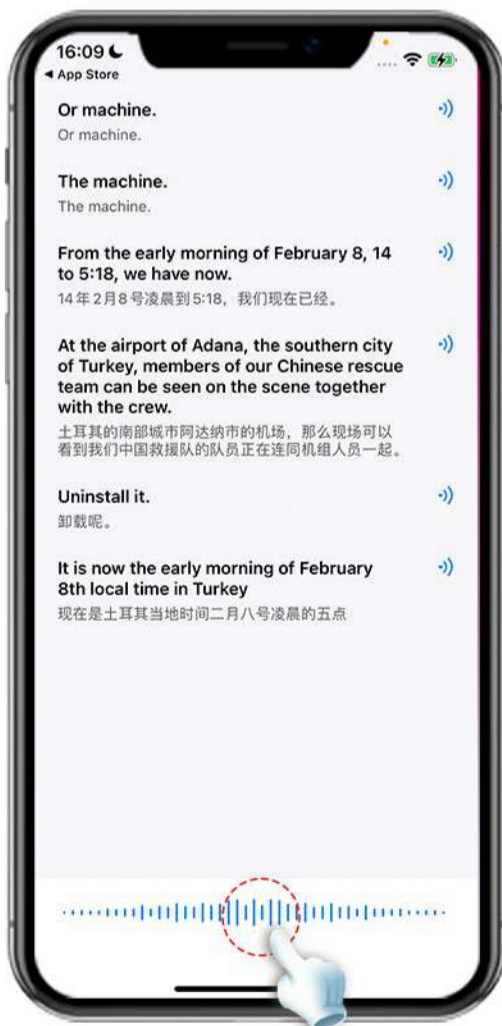

WT2 Edge – Touch Mode

1) Two persons wear one earbud each, and then tap [Touch Mode].

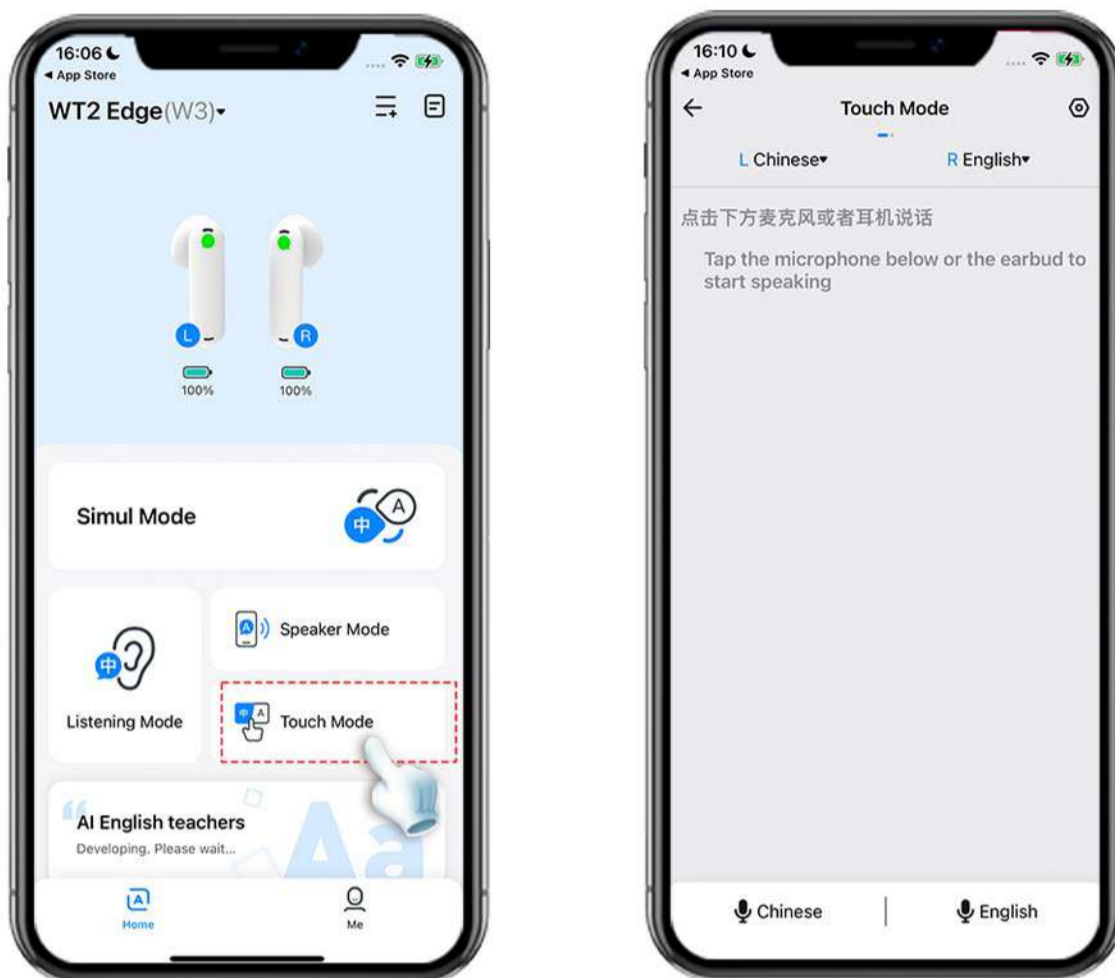

2) Set the source language for each person's earbud.

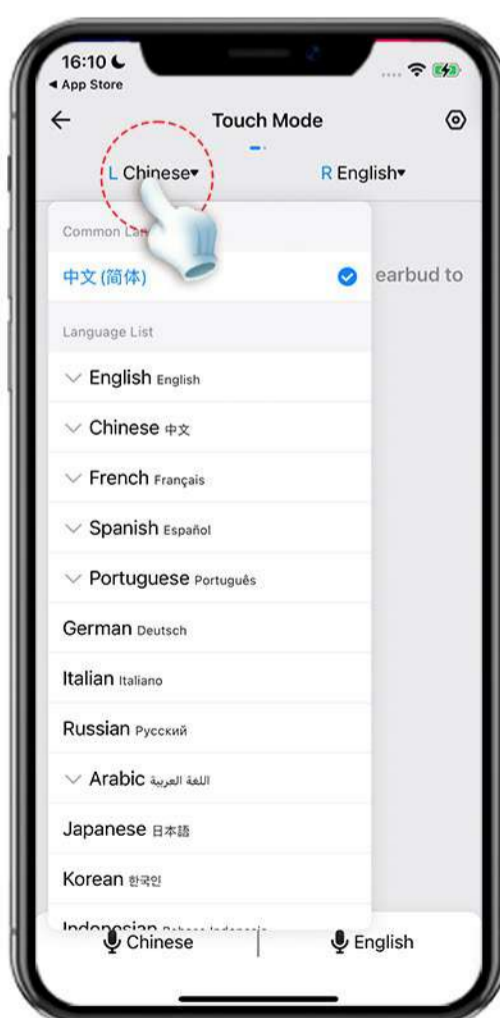

3) Before starting a conversation, both persons should first tap the microphone icon on the screen that corresponds to the language being spoken, or tap the indicator on the earbud being worn.

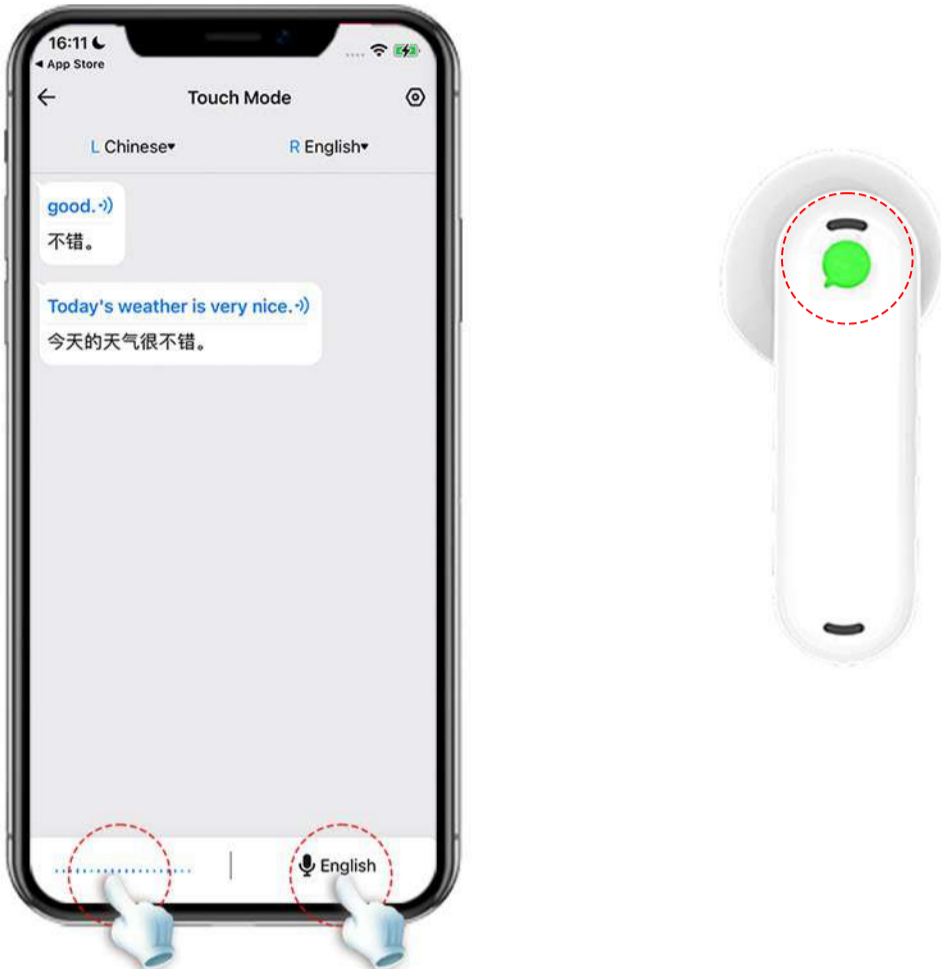

4) You can switch between Face-to-Face display and Side-by-Side display by sliding the screen to the left or right. When the two persons are side by side, the Side-by-Side display is recommended. When the two persons are facing each other, the Face-to-Face display is recommended.

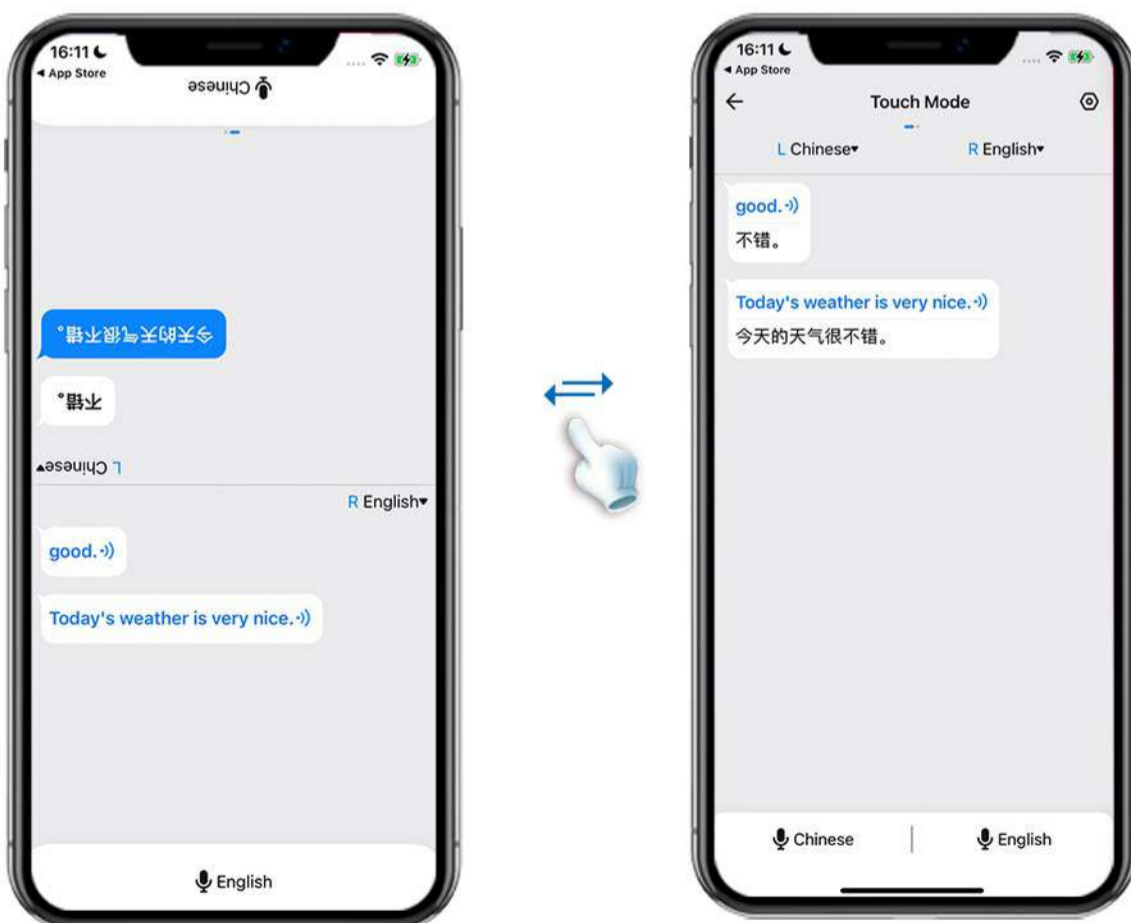

Face-to-Face

Side-by-Side

WT2 Edge – Speaker Mode

1) Two persons wear one earbud each, and then tap [Speaker Mode].

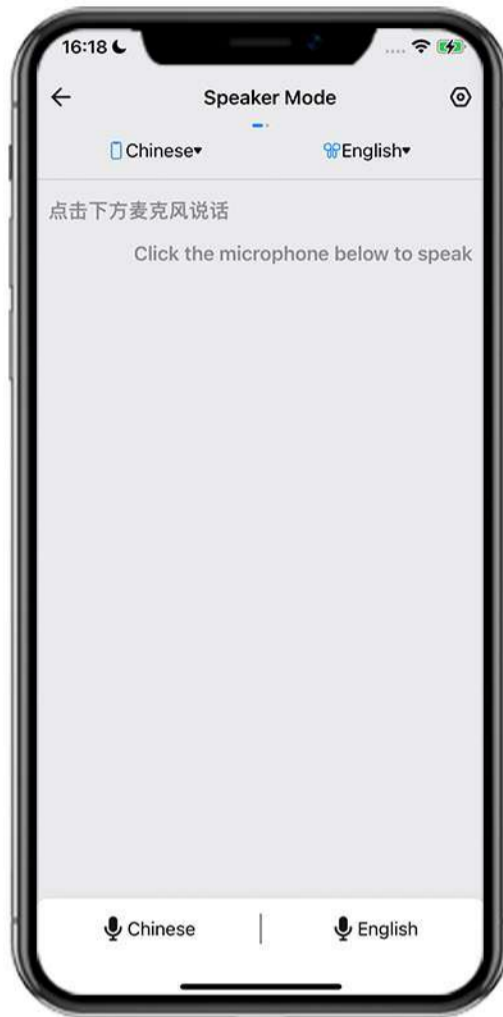

2) Set the source languages for both the earbud user and the smartphone user.



3) Before starting a conversation, both persons should first tap the microphone icon on the screen that corresponds to the language being spoken (the earbud user can also tap the indicator on the earbud to start speaking).



4) You can switch between Face-to-Face display and Side-by-Side display by sliding the screen to the left or right. When the two persons are side by side, the Side-by-Side display is recommended. When the two persons are facing each other, the Face-to-Face display is recommended.



side-by-side



face-to-face

WT2 Edge – Simul Mode

1) Two persons wear one earbud each, and then tap [Simul Mode].

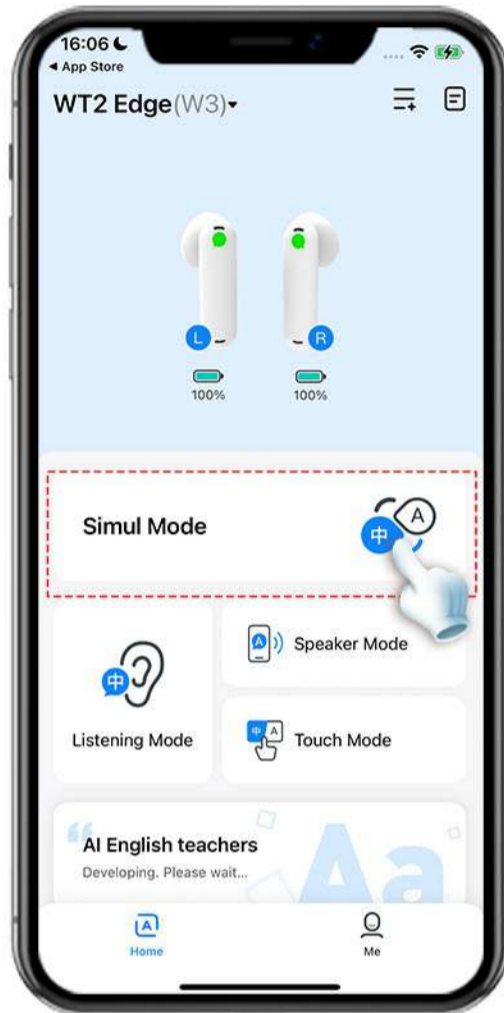

2) Set the source language for each person's earbud.

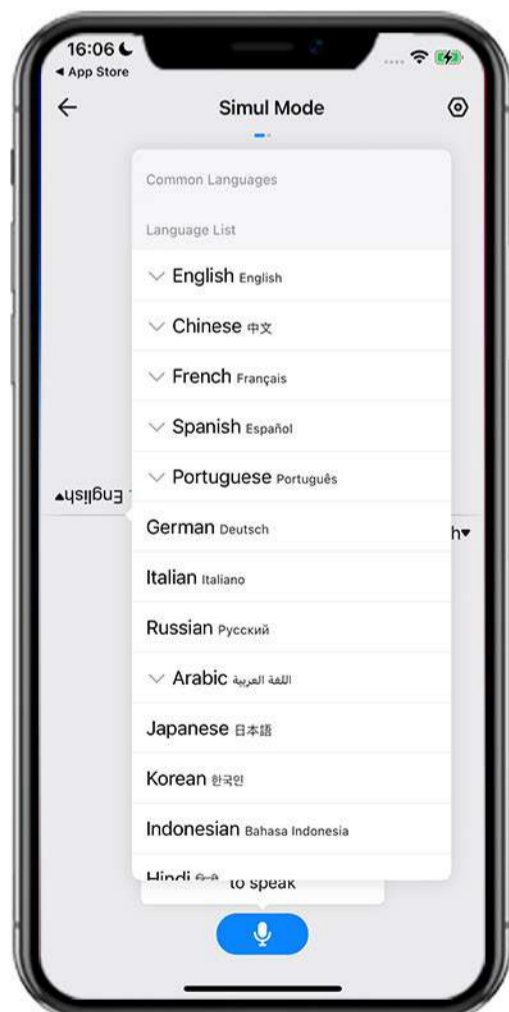
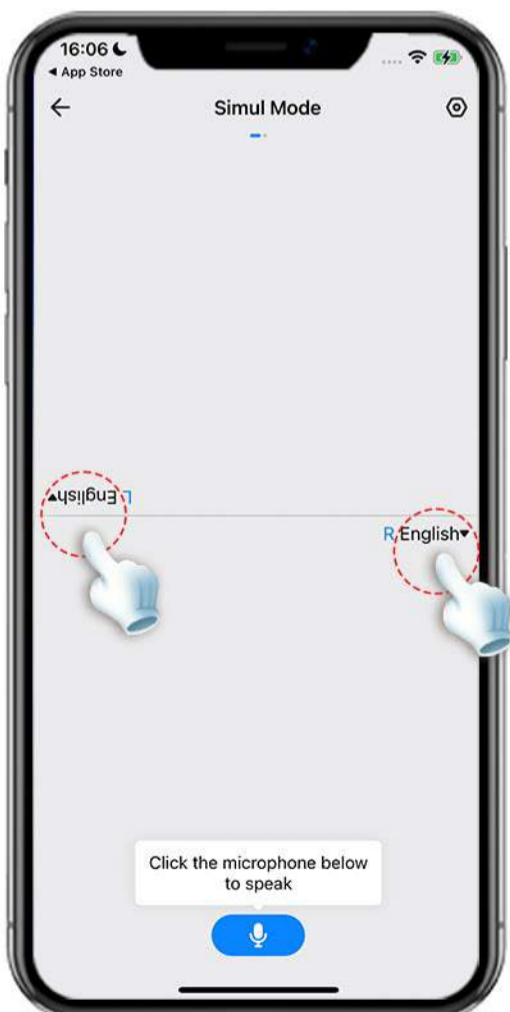

3) Tap the microphone icon to start the conversation, allowing you to speak naturally and smoothly without tapping the screen or indicators on your earbuds; tap the wavy lines to pause before returning to [Home].



4) You can switch between Face-to-Face display and Side-by-Side display by sliding the screen to the left or right. When the two persons are side by side, the Side-by-Side display is recommended. When the two persons are facing each other, the Face-to-Face display is recommended.



Face-to-Face



Side-by-Side

Tips:

1. In Simul Mode, two persons should each wear one of the earbuds instead of one person wearing both.
2. The two persons should keep a distance of about 1 meter to prevent one's voice from being picked up by the other's earbud.

WT2 Edge – Settings

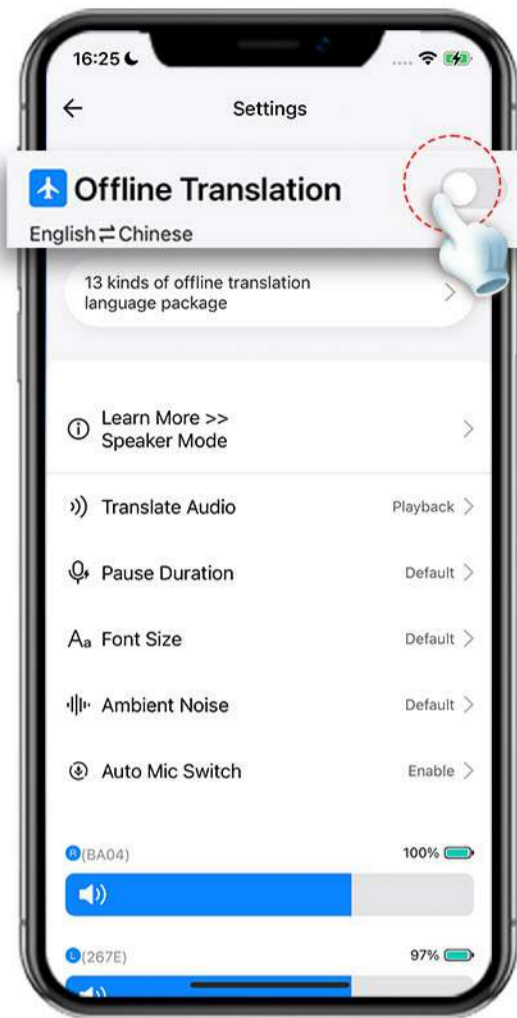

Offline Translation

Select the offline language package to be used and enable [Offline Translation] in Settings. The offline language package should be purchased and downloaded first before use.

Translate Audio

Enables or disables automatically played interpreting audio.

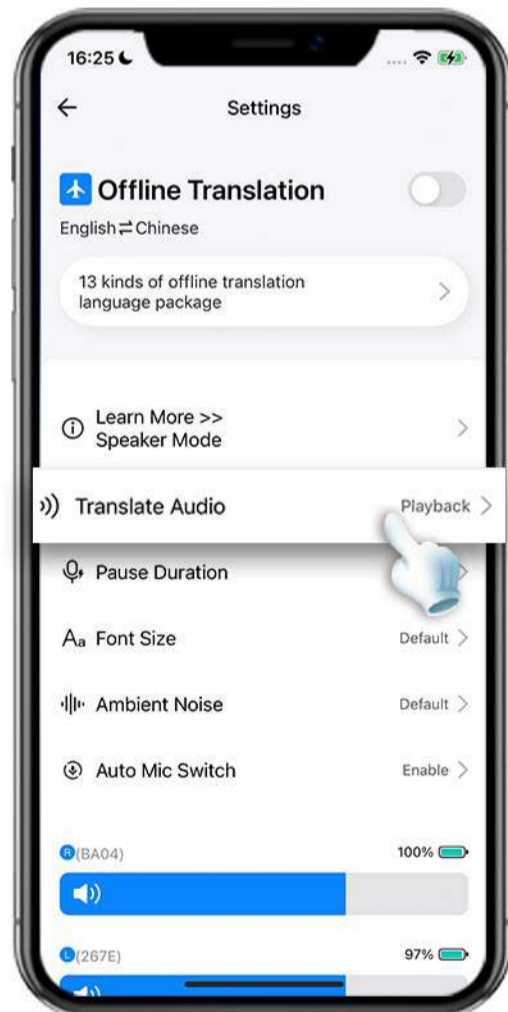



Pause Duration

Set the pause duration between sentences according to individual speaking habits so that the sentence segmentation can be more accurately recognized. If you habitually pause long between sentences, the pause duration can be increased, otherwise it can be decreased.

Font Size

Adjust the font size of interpreting mode pages, but not the font size of other pages.

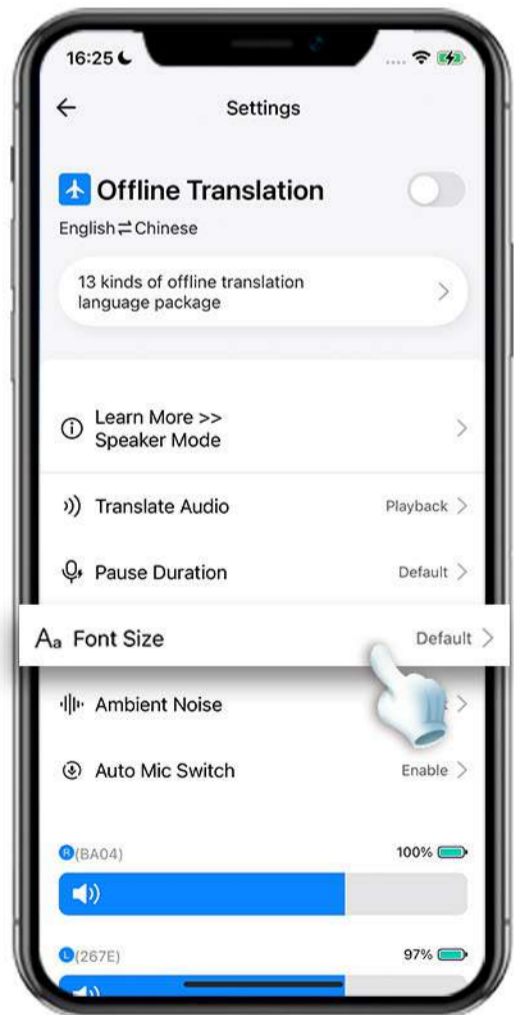



Font Size

Adjust the font size of interpreting mode pages, but not the font size of other pages.

Auto Mic Switch

The auto mic switch] can only be used in [Touch Mode] and [Speaker Mode] of WT2 Edge/W3. It is used to control the switching of the right to speak. When [Auto Mic Switch] is enabled, other people can switch the speaking right for their own benefit at any time. When [Auto Mic Switch] is disabled, anyone who wants to speak should wait for the current speaker to tap his/her earbud at the end of his/her turn before taking over.

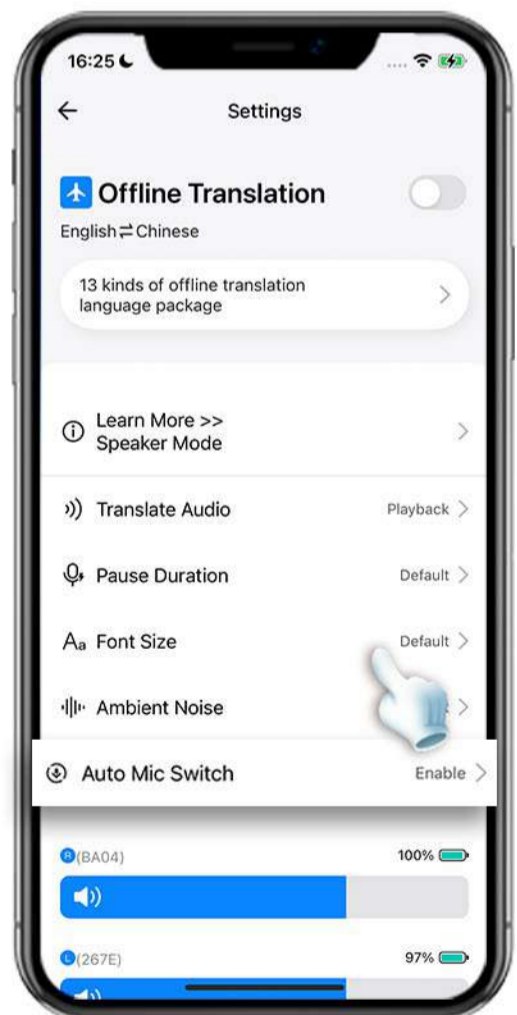

Purchasing Offline Translation Language Package

Top Up

The account should be topped up before making a purchase. You can top up the balance with a Fish card or via WeChat Pay / Google In-app Purchase / Apple In-app Purchase.

Top-up with Fish Card

1) Tap [Me] > [Redeem Fish Card] to enter the Fish Card redemption page.

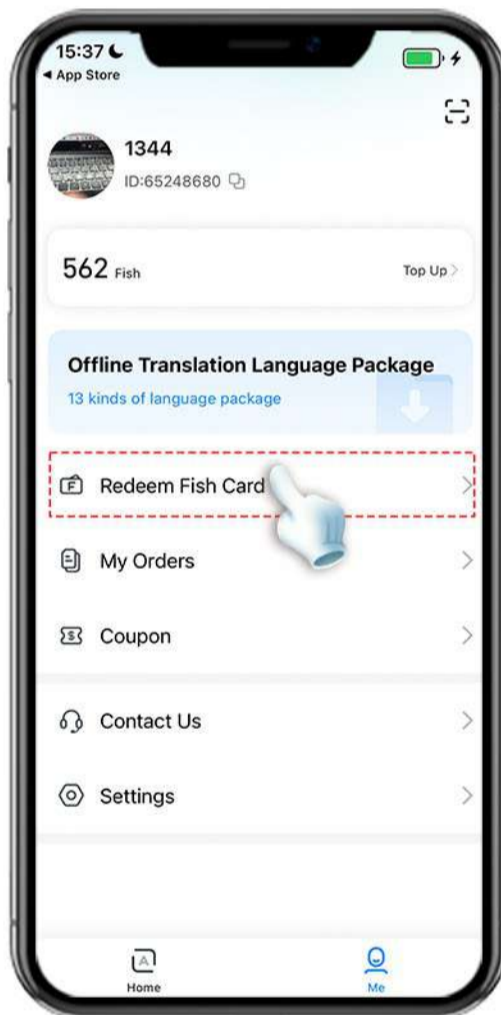

2) Scrape off the coating from the Fish card as shown in the animation. After entering the PIN code on the page, tap [Redeem]. Upon successful redemption, the Fish Coin balance in your account will be updated.

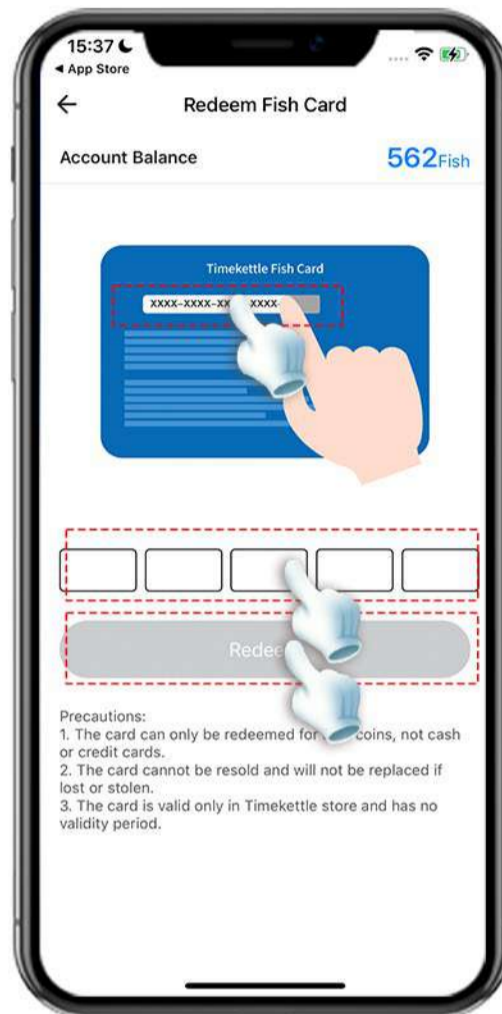

Top-up via WeChat Pay /Google In-app Purchase/Apple In-app Purchase

- 1) Tap [Me > [Top Up] to enter the top-up page.
- 2) Select the amount of credit you want to add and tap [Top Up].

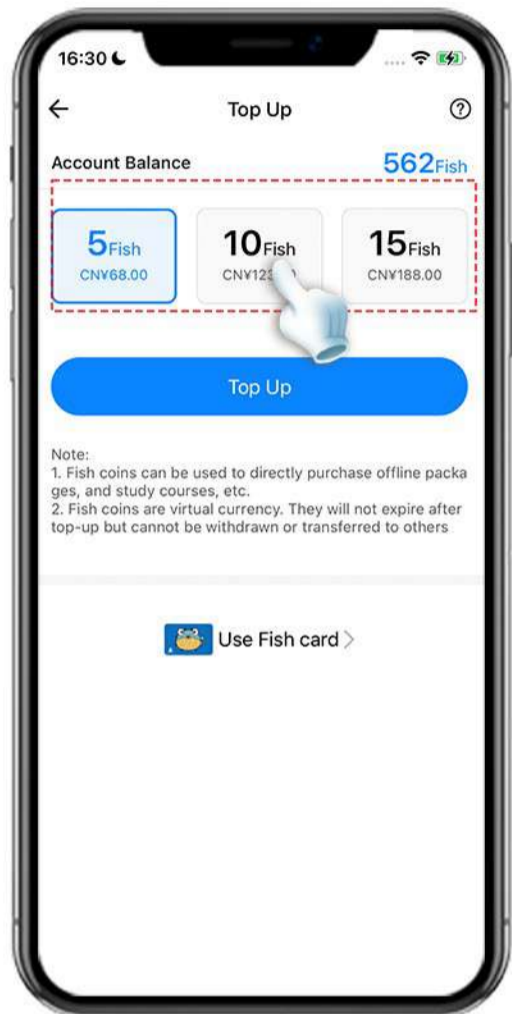
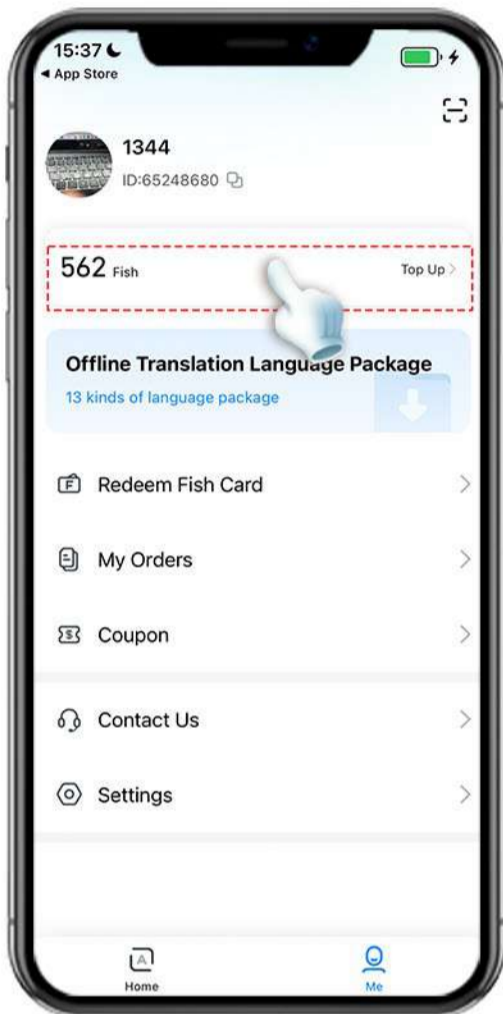

- 3) Tap [Purchase], enter the login password for your App Store account, and tap [Sign in].

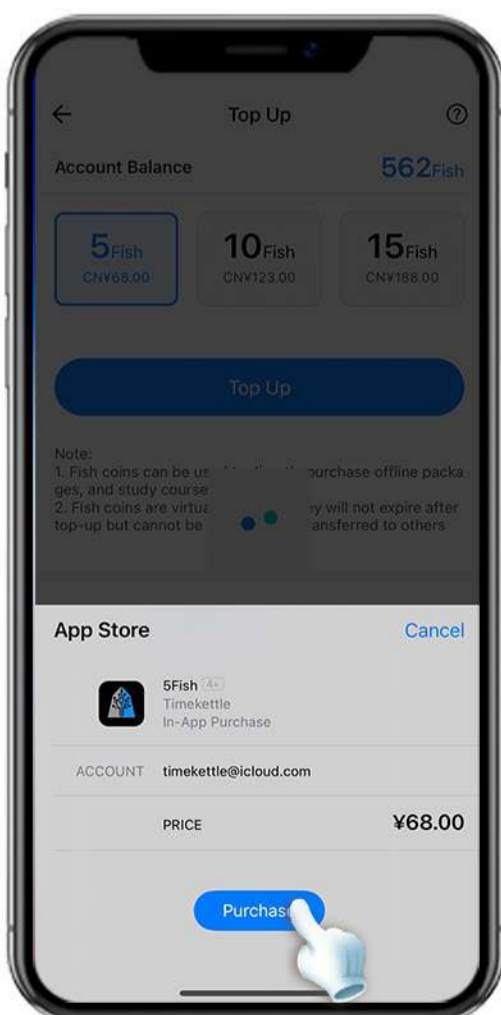

4) Upon successful redemption, a pop-up window will appear indicating that the transaction has been completed and the Fish Coin balance in your account will be updated.

Note:

1. When you enter the top-up page, the top-up amount will be loaded within a certain period of time. If the amount is not successfully loaded for a long time, please check the network connection or exit the top-up page and re-enter it.

2. If the account balance is not updated immediately after topping up, just wait a while; if it has not been updated for a long time, please reenter the balance page. If the balance cannot be updated after trying the above solutions, just contact our Customer Service.

Purchasing Offline Translation Language Package

You can use a sufficient balance to purchase an Offline Translation Language Package

1) Tap [Me] > [Offline Translation Language Package] to enter the purchase page.

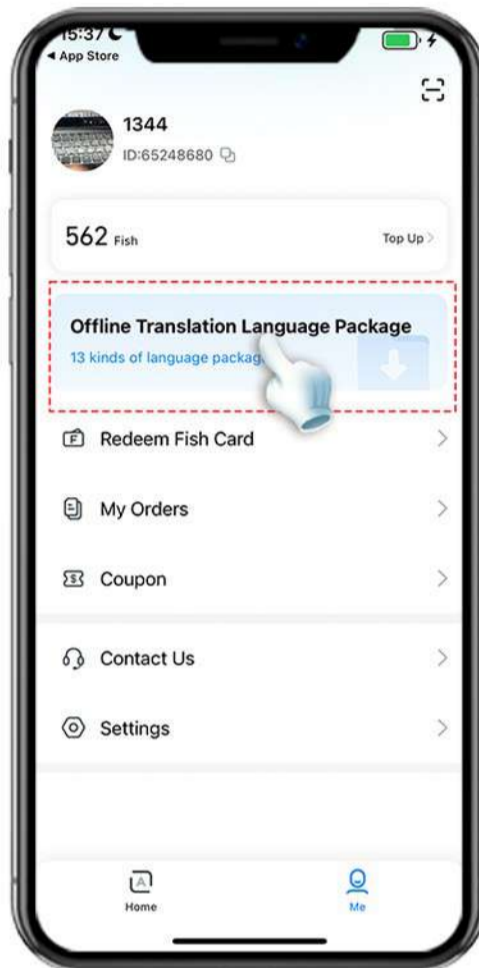

2) Check that the earbuds model shown on the page matches your earbud model. The offline package you purchased is bound to the model. If the model is changed, it will not work.



- 3) Tap the shopping cart icon to purchase the Offline Translation Language Package you want.
- 4) Check that the earbuds model and the Offline Translation Language Package you selected are what you want. After confirming, tap [OK] to complete the purchase.

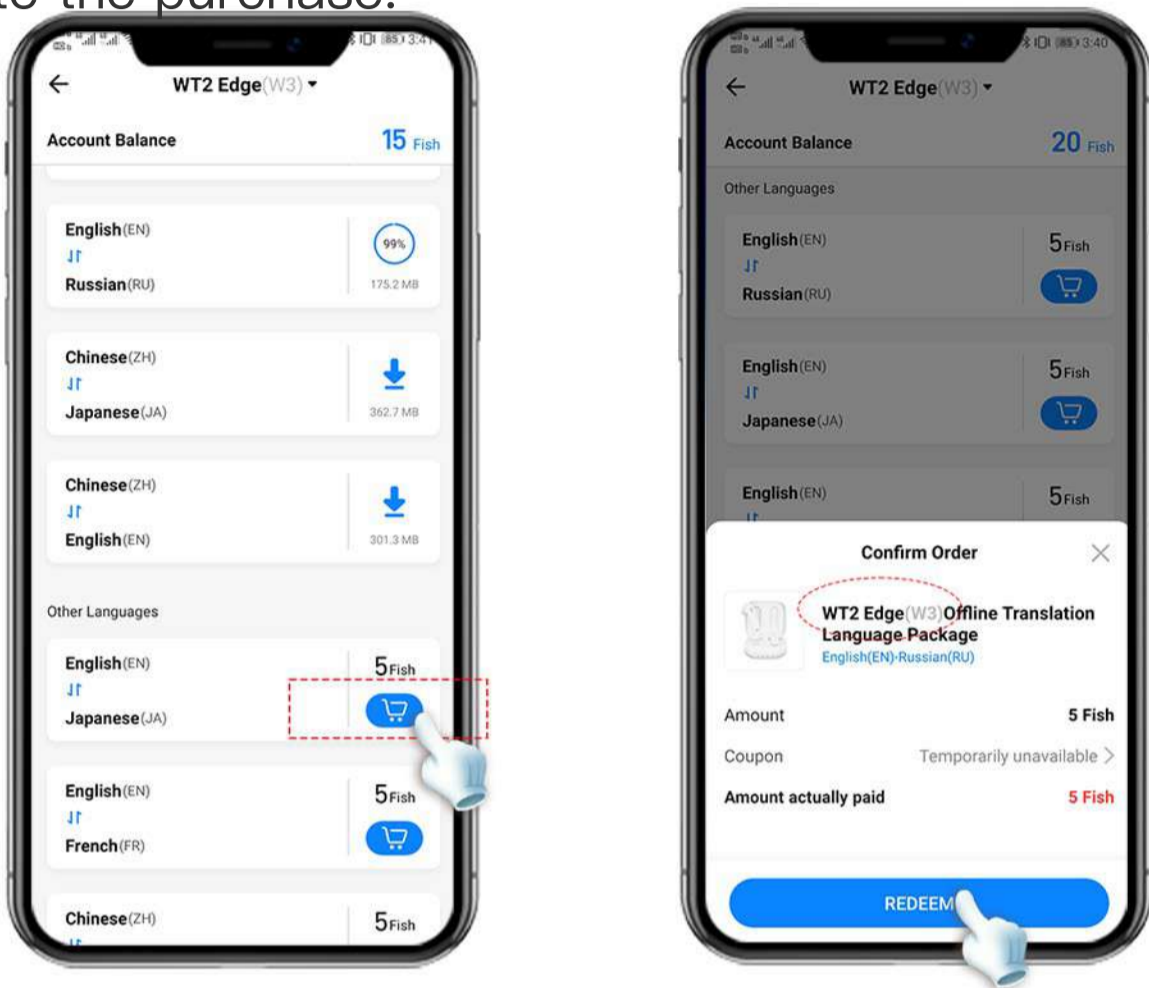

- 5) After a successful purchase, download the Offline Translation Language Package. Tap [Download Now].

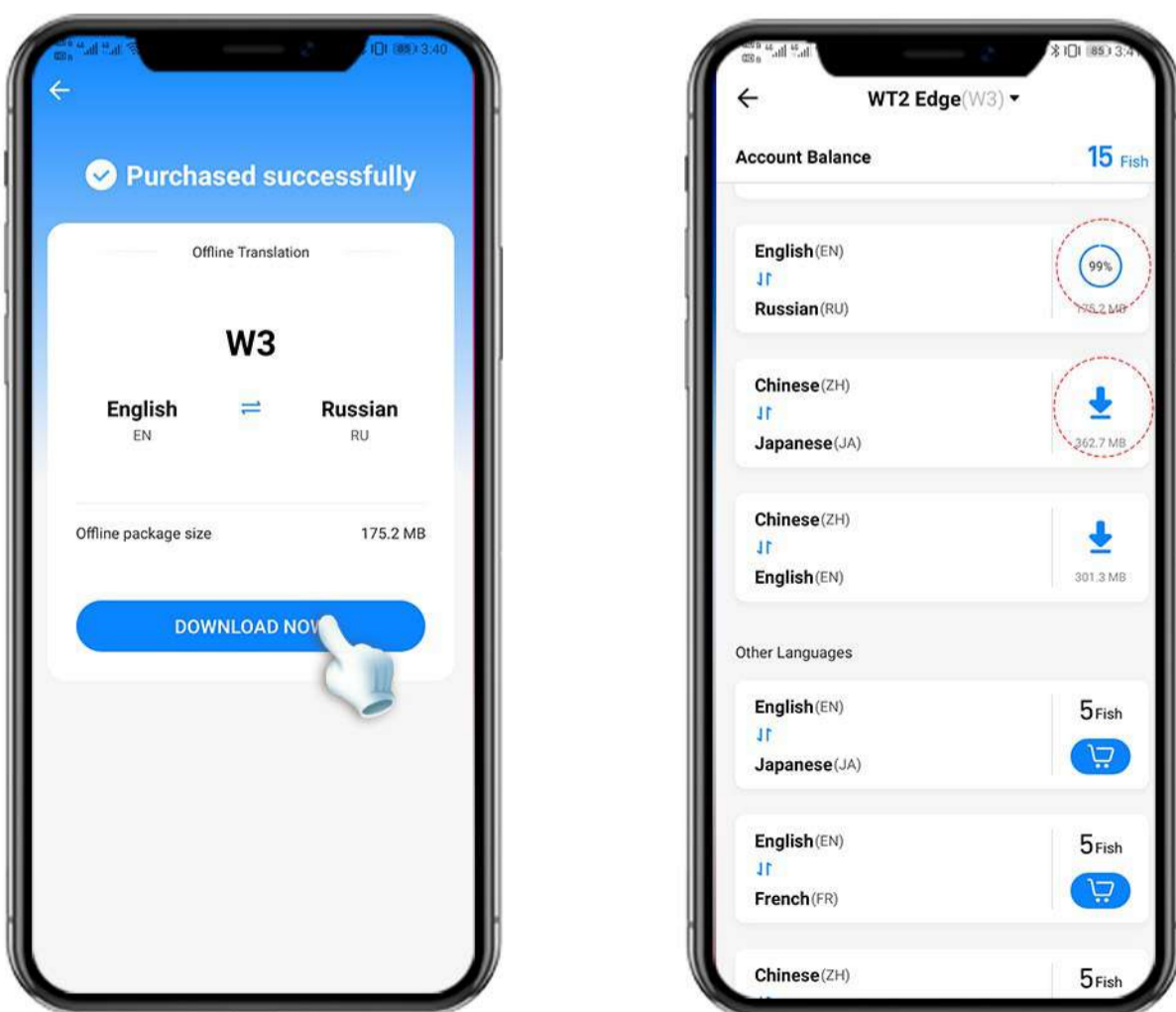

6) When the download icon changes to a check mark, it means the download is complete.

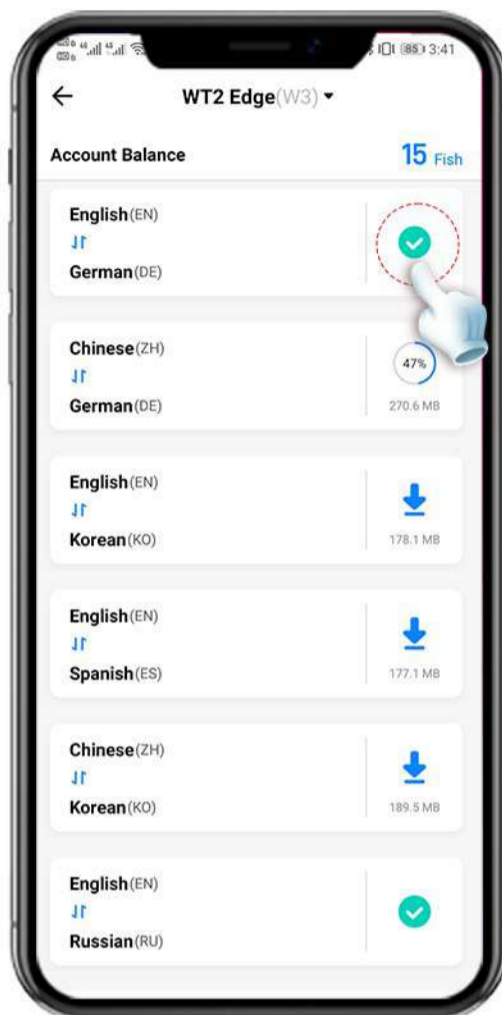

Enabling Offline Translation Language Package

After successfully purchasing and downloading the Offline Translation Language Package, enable the [Offline Translation] switch in [Settings] page of each mode.

1) Select the desired interpreting mode.

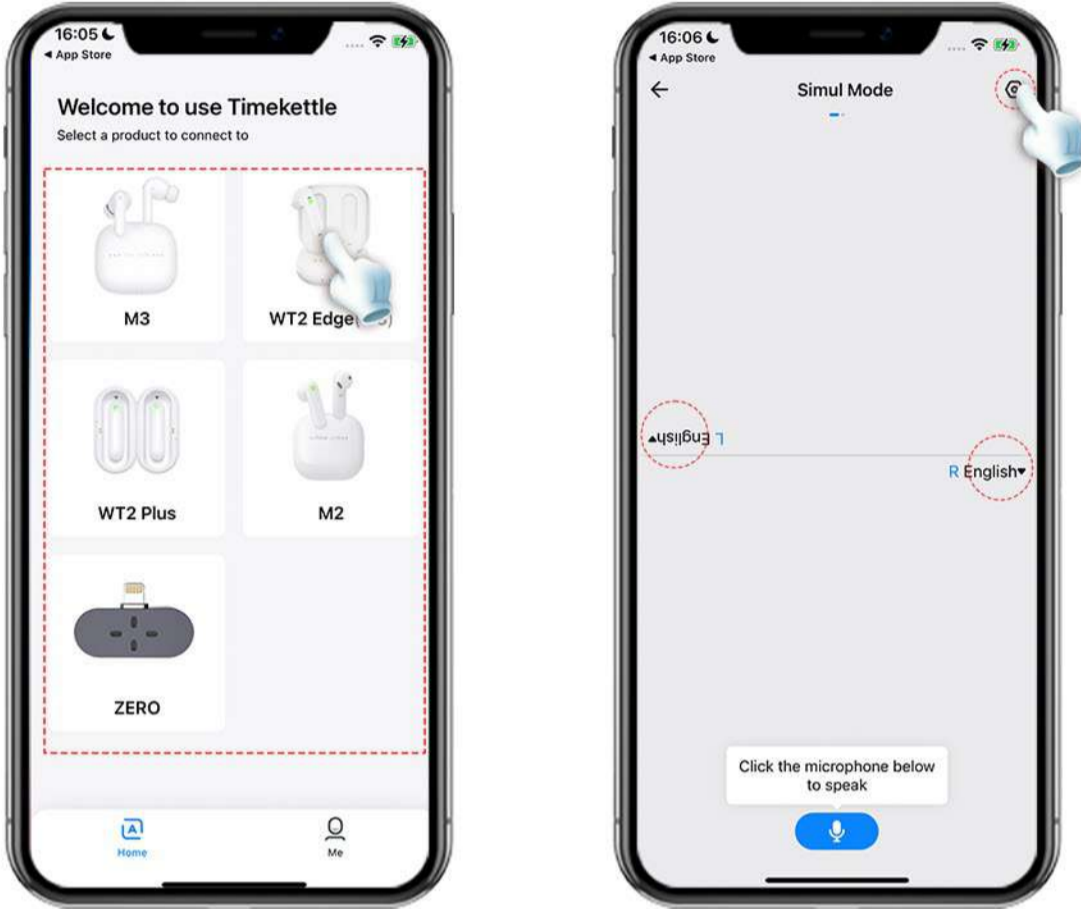

2) Enable [Offline Translation] to start offline interpreting.

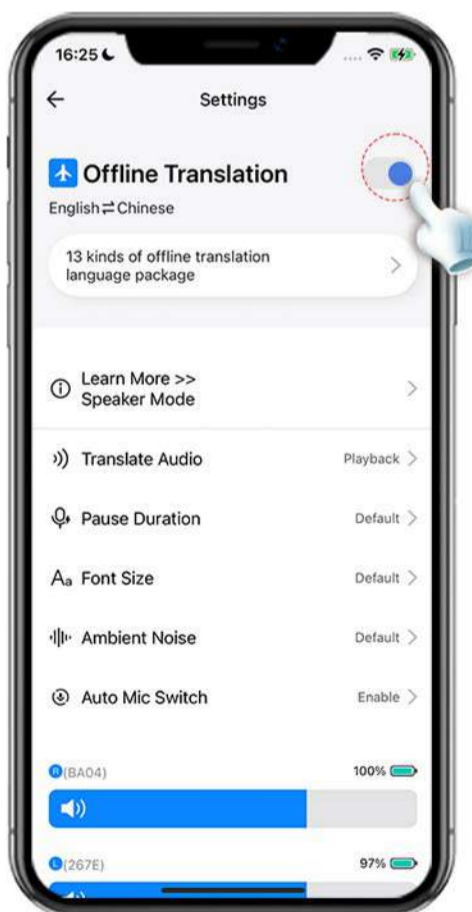

Note:

Before enabling [Offline Translation], you should set the source languages for the devices in the interpreting mode you'll be using.

Email: support@timekettle.co

Facebook Messenger: @TimekettleTech

Website: <https://www.timekettle.co>

Tel: 1-833-491-1328

