

Avid Power®

MODEL: ACSD368

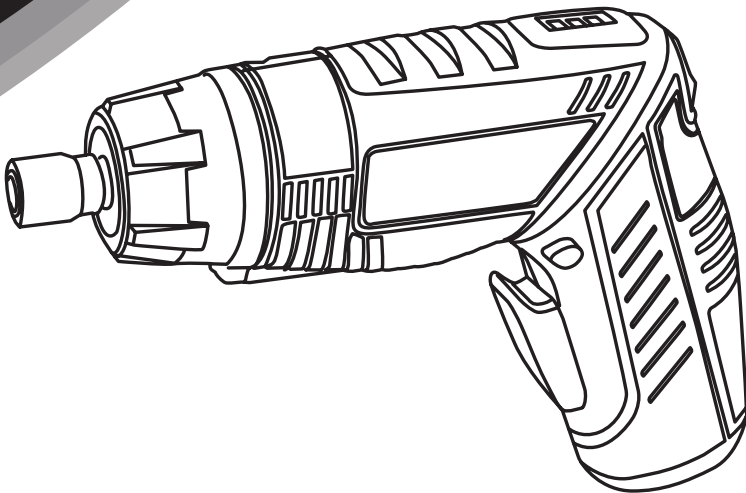

4V CORDLESS SCREWDRIVER

Operator's Manual

SAVE THIS MANUAL

You will need this manual for safety instructions, operating procedures and warranty.
Put this manual and the original sales receipt in a safe dry place for future reference.

TABLE OF CONTENTS

TABLE OF CONTENTS	2
IMPORTANT SAFETY INSTRUCTIONS	3
SPECIFICATIONS.....	4
FUNCTIONAL DESCRIPTION.....	4
OPERATION	5
MAINTENANCE.....	7
PARTS LIST	8
SCHEMATIC DRAWING.....	9

IMPORTANT SAFETY INSTRUCTIONS

The following recommendations should be strictly complied with before operating the tool in order to avoid damage to the equipment and hazard to the user.

- Wear individual protection equipment if necessary (gloves, shoes, eye protectors, breathing filters etc.). Do not wear jewelry; protect long hair wear close-fitting clothes.
- Don't charge when you replace a tool or maintain the equipment.
- Work in a clean and tidy room with sufficient lighting.
- Place and store the tool in a dry place far from heat or dangerous vapours (best temp is between 10 and 15°C). Do not operate the machine close to explosive substances or inflammable matter.
- This do-it-yourself equipment should be used as such and not be considered as heavy-duty equipment.
- Do not work close to people, in particular children if work is hazardous. Keep tools away from children during and after work.
- Make sure body position is steady as you work. Remember that falls constitute an important source of accident.
- Make sure you do not use the drill or screwdriver on live parts to avoid electric shock. (a metal detector may be used for that purpose). Do not touch the chuck, socket or drill bit, when the tool is working.
- Do not try to open or disassemble the tool, only a specialist using original parts and manufacturer's drawings is allowed to service the tool.
- Should the case be damaged (wires or plug) have it replaced immediately by the after-sales department.
- This tool does not require special maintenance. The same applies to the electric part of the tool.
- Plastic parts should be cleaned only after disconnecting the charger. Use a wet cloth and soft soap. Do not immerse the tool or the USB cable. The use of solvent, alcohol, petrol etc. is prohibited.

Please contact the after-sales department for complete cleaning of the tool.

SPECIFICATIONS

No Load Speed: 200rpm

Chuck Size: 1/4"

Max Torque: 50 in-lbs(5.65Nm)

With 1pc USB cable

44pcs accessories:

8pcs Sockets

1pc 1" Screw bit holder

1pc 2-3/8" Screw bit holder

28pcs 1" Screwdriver bits

6pcs HSS Drill bits

FUNCTIONAL DESCRIPTION

1. Chuck
2. Battery Capacity Indicator
3. Two Position Adjustment Button
4. Forward/Reverse Switch
5. On/Off Trigger Switch
6. Work Light

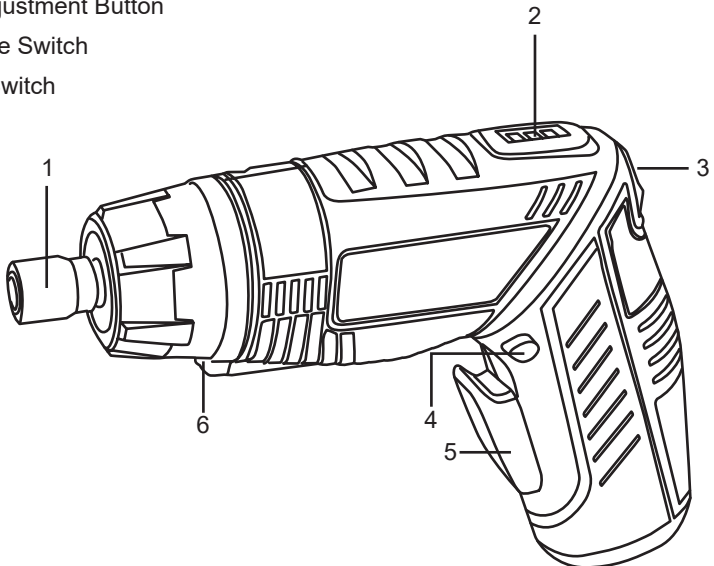

OPERATION

CAUTION: The safety instructions should be read carefully before operating the tool.

Power supply:

- Connect one end of the USB cable to the screwdriver and the other end to the usb charging port (such as power band, wall charger, notebook or car charger).
- After 3-5 hours, three indicated lights will turn on, which represents the tool is full charged.

LED Battery Capacity Indicator

The battery capacity is indicated by 3 lights:

- Red LED is on - <20%
- Red & yellow LED's are on - 20-70%
- Red & yellow& green 3 LED's are on - >70%
- Once only the red LED is lit, the screwdriver must be re-charged.

Two Position Adjustment

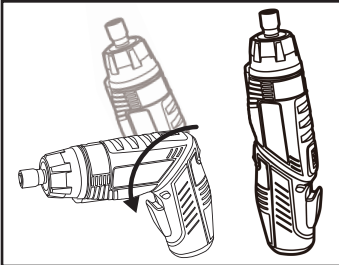

The driver can be used as one straight driver.

First press the rotation button, turn the front section in an anticlockwise direction and then release the button when can not turn it again.

NOTICE: Do not use screwdriver as a pry bar in either position.

CAUTION: To avoid screwdriver being turned on accidentally, keep switch locked in center position.

Installing/removing bits:

The 1/4" fast load chuck provides fast, easy one-handed bit loading and ejecting.

OPERATION

To install bits:

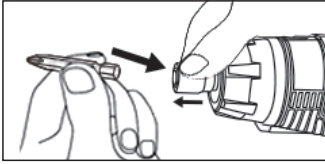

- Lock forward / neutral / reverse switch on the tool by placing the direction of rotation selector in neutral position. Pull the chuck sleeve away from the driver.
- Push the bit into the chuck, release the chuck sleeve to lock bit into place.
- Pull on the bit to make sure it is secured in the chuck. It's normal to have a small gap for bit installation.

NOTE: Only use bits with quick connecting locking groove.

To remove bits:

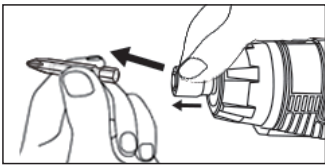

- Lock the trigger by placing the rotation selector in the neutral position.
- With the nose of the tool pointed away from you, pull the chuck sleeve away from the driver. Remove the bit from the chuck.

CAUTION: The screwdriver is not designed to be used as a drill.

Forward/Reverse switch & Trigger lock

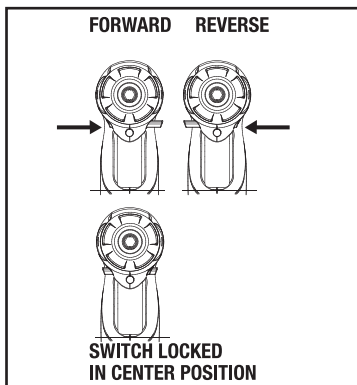

OPERATION

For forward rotation, (with chuck pointed away from you) move the lever to the far left.

For reverse rotation move the lever to the far right.

To activate trigger lock move lever to the center off position.



Do not change direction of rotation until the tool comes to a complete stop.

Shifting during rotation of the chuck can cause damage to the tool.

MAINTENANCE

This screwdriver does not require special maintenance. The repair of internal parts of the tool should be left with specialists (see safety instructions).

PARTS LIST

No.	Description	Qty.
1	Motor_RS380_3.6V	1
2	Motor gear	1
3	P_039_08A_Gearbox cover	1
4	ISO 7045- M2.5x 5-Z --- 5S	2
5	Washer	1
6	Back star gear_plastic	3
7	Back star gear holder	1
8	Front star gear_steel	3
9	Ring gear	1
10	Self lock block	1
11	Locking pin	6
12	Self lock ring	1
13	Lock washer	1
14	Self lock core	1
15	Bushing	1
16	Gearbox front	1
17	Pressure pin 3mm	3
18	Output axis	1
19	Pressure washer	1
20	Torque spring	1
21	Screw ring	1
22	P_039_10A_Adjusting ring_rear	1
23	P_039_11A_Adjusting ring_front	1
24	P_039_A03A_PCB batterybar	1
25	P_039_03A_Housing main_upside_left	1
26	P_039_12A_Index spring	1
27	LED_3mm	1
28	P_039_01A_Housing main_handle_left	1
29	Compression spring	2
30	Screw_DIN 7981_2.2x4.5	2
31	P-035_06A_Contacts-trigger	1
32	P_039_06A_Trigger main	1
33	P_039_07A_Switch direction	1
34	Switch_SS-23E26(2P3T)_Baohui	1
35	P-035_05B_PCB	1
36	Li-Ion Battery 18650	1
37	P_039_02A_Housing main_handle_right	1
38	Screw_GB845-1985_2.6x12	8
39	P_039_05A_Switch rotation	1
40	P_039_04A_Housing main_upside_right	1

SCHEMATIC DRAWING

