

**GOTRAX**

**ENDURA II**

Electric Bike



**USER MANUAL**



**GOTRAX**

## Congratulations on your purchase!

This user manual will help you assemble and operate your new electric bicycle. Be sure to read **ALL OF THE INFORMATION** in this manual before riding.

**NOTE TO ALL RIDERS UNDER THE AGE OF 18:**  
It's very important that you get parental permission before riding your electric bicycle.





# Don't Ride Until You Read This:



**ALWAYS** wear a helmet when riding your electric bike.



Make sure your electric bike has a **full battery** before taking it out to ride.



**Always** be aware of local road laws, and follow them.



**Do not** ride the bike under the influence of drugs or alcohol.



**Always** respect pedestrians.



**Do not** ride under wet conditions. The electric bike may slide from under your feet causing injury. Wet conditions may damage the electronics and void the warranty.



WARNING: Lithium-ion Batteries and/or products that contain Lithium-ion Batteries can expose you to chemicals including cobalt lithium nickel oxide, and nickel, which are known to the State of California to cause cancer and birth defects or other reproductive harm. For more information, go to [www.P65Warnings.ca.gov](http://www.P65Warnings.ca.gov)



# Warning Message

1. **Avoid water** - The electric bike is not waterproof. The electronics may be damaged due to water and water damage is not covered by our warranty. Riding in wet conditions is also very dangerous and may result in injury.
2. **Avoid prolonged exposure** to sun or rain and avoid storage in places with high temperatures or corrosive gas.
3. **Abuse** - We do not cover physical damage due to negligent care and extreme riding.
4. **Whenever you ride** the **GOTRAX** Electric Bike, you risk severe injury or even death from loss of control, collisions, and falls. Use caution and ride at your own risk.
5. **Do not modify** the product from the manufacturers original design.
6. **Do not exceed** the posted speed limit and obey all traffic laws.
7. **Avoid touching** the charging port directly and do not let it make contact with a metal object.
8. **Keep hands and all body parts away** from moving parts while operating the electric bike.
9. **Before riding** - be sure to check the electric bike over and make sure the electric bike is operating correctly before each use.
10. **Before riding** - be sure to check that the braking system is functioning properly; also be sure to check that all safety labels are in place and you understand the safety warnings.
11. **Before riding** - be sure that any and all axle guards, chain guards, or other covers or guards supplied by the manufacturer are in place and in serviceable condition.
12. **Before riding** - be sure to check that the tires are in good condition, inflated properly, and have sufficient tread remaining.

13. **Never exceed** the 264lbs (120 kg) maximum load rating.
14. **The electric bike should never** be used by children under the age of 16.
15. **Maximum Speed** - Your electric bike goes the maximum speed of 15.5mph.
16. **Make note that additional insurance may be required** to cover situations you encounter while riding an electric bike. It is recommended that you contact an insurance company or broker for advice and consultation.
17. **To conserve electricity**, use assist mode and avoid zero starting, frequent braking, driving against the wind, carrying heavy loads including other people and riding with insufficient air pressure.

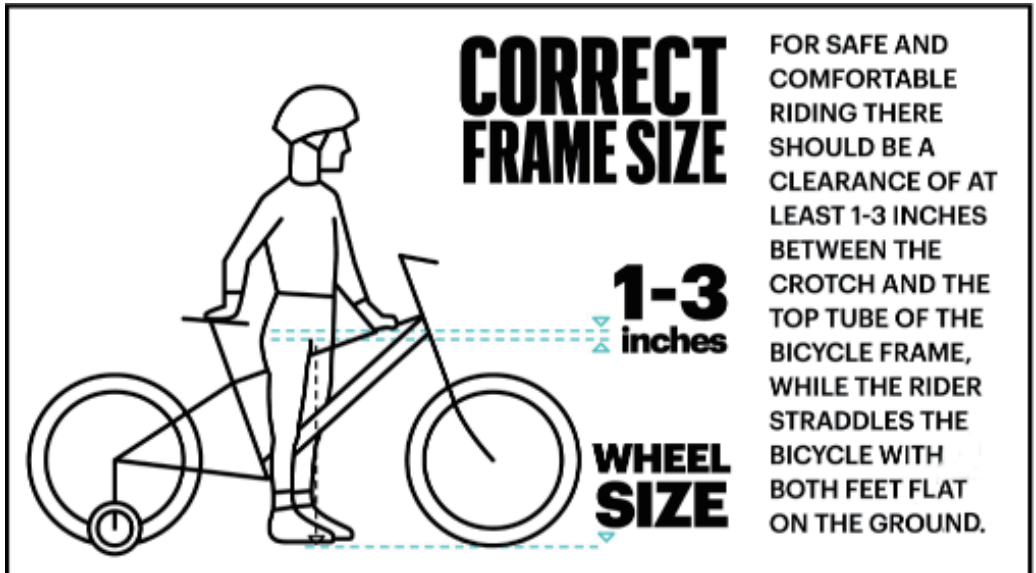



# Unpacking and Product Specs

Remove all packaging material, then inspect each item for any accidental damage that may have occurred during shipping. You should find each of item in your box:



**ELECTRIC BIKE**



**TOOLS: (2) LARGE WRENCH,  
(4) ALLEN WRENCHES,  
(1) SCREWDRIVER**



**BATTERY CHARGER**

ITEM	SPECIFICATIONS
Model	ENDURAIL
Product Dimensions	1760x610x1190 mm (69.2x24x46.8 in)
Package Dimensions	1450x240x800 mm (57x9.4x31.4 in)
Max Load	120 kg (264 lbs)
Package Weight	31 kg (67 lbs)
E Bike Weight	24.5 kg (54 lbs)
Max Speed	25 km (15.5 mph)
Battery Specifications	36V 7.8Ah
Battery/Charger	Input 100-240V 50/60Hz AC plug; output 42V 2A DC2.1
Pedal-Assist Mode	35-45 km (22-28 miles)
Pure Electric Mode	27 km (16.7 miles)
Max Angle of Climb	14 degrees
Charging Time	4-5hours
Tire Pressure	25-45P.S.I
Bell/Horn	Bell
Frame Material	6061 Aluminum Alloy
IP Level	IPX4



# Get to Know Your E-Bike

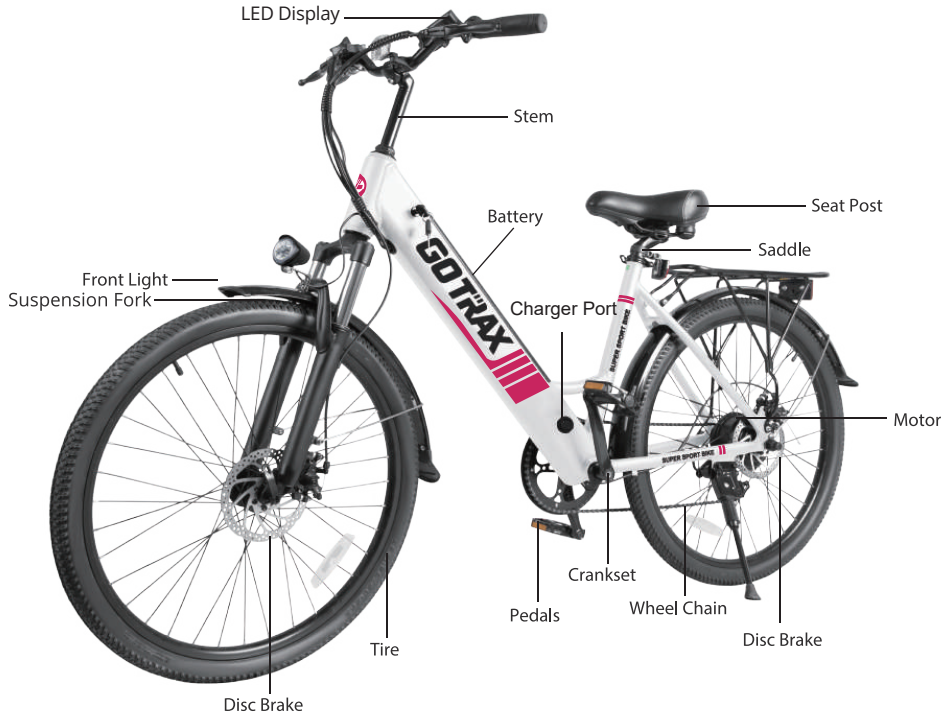



# Installing the Handlebar



Use tools to loosen screws from fasteners, Insert the handlebar into fork tube.



Adjust the handlebar to the appropriate Angle, and lock the screw fixing the handlebar. (The handle must be centered and fixed.)



Adjust the vertical Angle between the transverse handle and the front wheel, and lock the fixing rod screws.

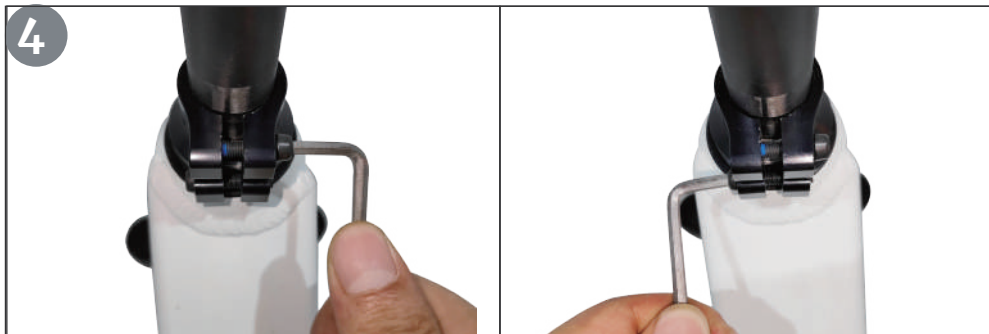

Use the tools to lock the rod retainer screws.

# Adjusting the Seat Tube



Push the saddle down.



Open the folder of the seat tube.

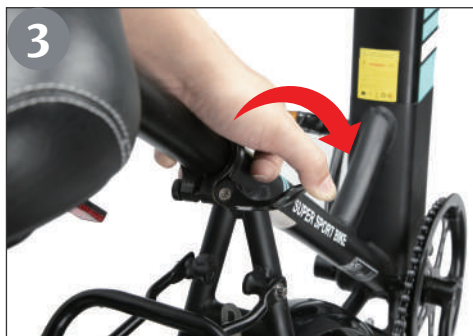

Adjusting and rotate the seat.



Finally lock the folder.

# Installing Pedals



Please check the L and R marks.



Take the wrench from the tool box.



R means it should be install in right side, L means it should be install in left side.



Tighten the nut counterclockwise.



# Installing Front Fender and Headlight

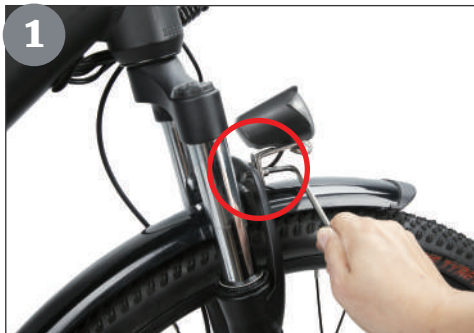

1 Use screw to lock the front fender and headlight.



2 Use screw to lock the left bracket of the front fender.



3 Use screw to lock the right bracket of the front fender.



# Installing the Front Wheel



Fixed wheel front fork.



The front fork is aligned to both ends of the bearing. The disc brake is on the left.



Install the quick release and then tighten well.



Twist the wrench upward check the operation of the wheel.



# Removing the Battery



Open the battery key.



Take the battery out.



After taking out the battery.



Remove the battery.

# Charge the Battery



Take out the battery.



You can take the battery to your company or home to charge it.



Plug one end of the charge into the battery and the other end into the power supply.



Red light shows the battery is charging green light is full.

# Charge Your E-Bike



---

# LED Console S810

## User Manual V.2014



**Model: 810-C**

**Operating Voltage: DC24V / DC36V / DC48V**

**Functions: Power Switch (Electric On/Off)**

**Battery Level Indicators**

**Three-Gear Motor Power Control**

**Light Switch**

**Auto-Hibernation after 10min Standby**

## 1. Exterior Parameters

**Shell Material:** ABS

**Working Temperature:** -20°C-60 °Cwith guaranteed mechanical performance.

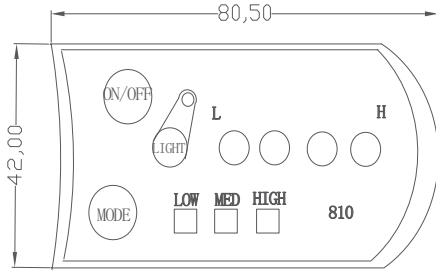

**Front View**

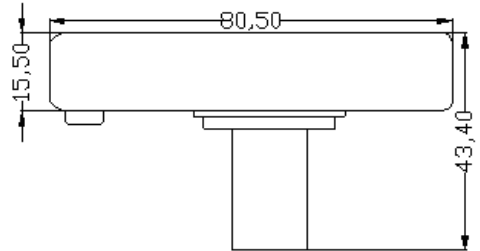

**Side View**

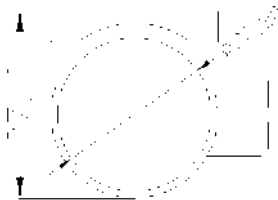



**Side View of the Supporter Ring**

### a. Start

Press and hold  for 2-3 seconds to power on/off.

### b. Battery Level Indicators

When the battery is fully charged , 4 power indicator lights are on (full power status), and the indicator lights will turn off one by one according to the power gradually decreasing. When the battery is low , the last indicator light will flash continuously, indicating that the battery needs to be charged in time.

### c. Gear Setting

Boot default 0 gear



Gear indicator has no light indication which means the motor has no power output.

After the power is turned on, press the  button for the first time, the gear indicator LOW will light up, representing the first gear (low speed mode).

Press the  button for the second time, the gear indicator will switch from LOW to MED, representing the second gear (medium speed mode).

Press the  button for the third time, the gear indicator will be switch from MED to HIGH, representing the 3rd gear (high speed mode).

Press the  button for the fourth time, the gear indicator will light off and switch to gear 0, the motor will have no power output. (This cycle sets the current desired gear).

#### **d. Light Control**

In the power-on state, press and hold  the button for 2-3 seconds to turn on the headlights.

Press and hold  the button again for 2-3 seconds to turn off the headlights.

#### **e. Turn on / off the battery power**

The battery is power off when receive. Please press the "Black Button" at the bottom of the battery to turn it on.





# Battery Information

Before using the charger locate the voltage selector switch (li-ion chargers only) on the back of the back of the charger. Select either 115 volts or 230 volts depending on your country of residence. Using the wrong voltage setting will permanently damage the charger and/or electrical components on the hybrid electric bicycle.

## **BATTERY ASSEMBLY**

1. Use the matching charger.
2. Insert the round plug into the E-Bike first and then insert the charger plug into the electrical socket.
3. A red light indicates the battery is charging.
4. A green light indicates the battery is fully charged.
5. The lock position will vary from model to model.
6. The Battery is removable, the battery can be charged attached to the e-bike or pulled out and charged separately.

## **CHARGING THE BATTERY**

1. When using the charger for the first time, carefully check whether the rated output voltage of the charger is consistent with the battery voltage and check whether the charger input voltage is consistent with the grid voltage.
2. When charging, first put the charger in a ventilated place, then insert the charger output plug into the charging port. Plug the electrical power plug into the 100-240V 50/60Hz AC Power Supply. Be sure to keep the input plug in contact with the AC outlet.
3. After charging, the input plug of the charger shall be pulled out first, and then the output plug connected with the electric bike shall be pulled out. Do not connect the charger to the charged power socket for a long time without charging.

## **PRECAUTIONS FOR BATTERY PROTECTION**

1. Do not place anything on the battery and charger when charging, otherwise the charger may overheat and cause serious consequences.
2. Please use the charger supplied by the original factory to charge the battery, if you use other than the original factory charger your battery will be disqualified from warranty.
3. You can charge your battery at any time if the battery loses power.
4. If you do not charge in time, your battery will gradually lose its performance and reduce its service life.
5. Protection can make your battery maintain about 80% of its capacity after more than 500 charges. But overall decline is inevitable.
6. If the battery remains in a state of power loss for a long time, it will lead to permanent loss of performance.
7. If you want to store your battery for a long time, please store and discharge it in a cool and dry place.
8. Keep the temperature between 10-21° C and avoid direct sunlight. Take the battery out for charging every 30 days.
9. Do not intentionally short-circuit the battery which will cause very serious consequences.
10. After the battery life has reached, do dispose of your batteries responsibly by researching local recycling regulations.
11. If you have questions about battery use, maintenance or storage, please contact customer service at anytime.



# Troubleshooting & Warranty

Please contact our customer service team if you are experiencing problems or need more detailed information.

US team after-sales email: **support@gotrax.com**

CA team after-sales email: **canada@gotrax.com**

1. Users should operate in accordance with the product manual. In case of any performance fault caused by production quality, the company shall perform the obligations of the three guarantees in accordance with the provisions of relevant laws and regulations of the state.
2. The company is still responsible for the after-sales service of the faults beyond three guarantees and the major components in the three guarantees, but there will be a cost for repair.
3. If the battery replacement is over the warranty time, our company will supply the battery at factory price. To ensure safety, and avoid pollution.





WWW.GOTRAX.COM

#RideGOTRAX





# **GOLABS, INC**

GOTRAX.com  
2201 Luna Rd.  
Carrollton, TX 75006