

CA 2022.4

Installation Instruction

Plain edge linear drain

Neodrain®

1. Please read this installation instructions carefully before proceeding.
2. Thoroughly inspect the product and components, contact our support team with support@neodrain.com to report any damaged or missing components for a replacement, return or repair.
3. Consult local building codes to ensure the installation complies with standards in your area. The warranty will be void if the product is installed with a conspicuous defect.
4. We recommend a flow rate no greater than 12 GPM for use with this product. **The load-grade allow pedestrian walking only.**
5. The information provided in this instruction are general guidelines and a licenced professional should always be used during installation.

Grating and Parts

Three styles of stainless steel grating options available: (NOTE : Pedestrian loading only.)

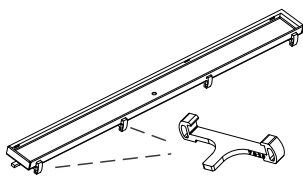
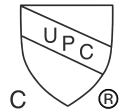

Tile tray clips

A. Tile insert tray

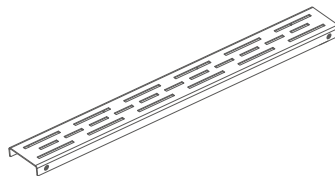

B. Patterned grating

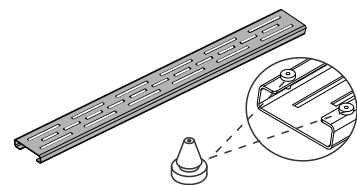

Cushion gaskets

C. Decorative finish grating

PARTS LIST

- 1 Stainless strainer / Hair catcher
- 2 Protective fabric
- 3 Drain body / Channel
- 4 Leveling feet / 2 PCS
(*12" do not use leveling feet.)
- 5 Threaded adaptor / Height adjustable
- 6 Grate & strainer lifting hook

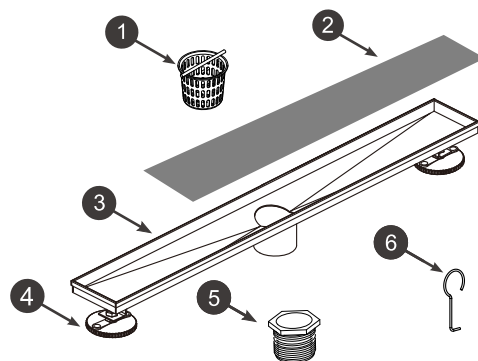

Preparation

The **substrate** should be smooth, level, clean and free of all dirt, oil, laitance, paint, concrete sealers or curing compounds. Dry dusty concrete slabs or masonry should be dampened and excess water swept off.

The following **tools and materials** maybe needed : Hole Saw, Crescent Wrench, Level, Utility Knife, Ruler or Tape measure, Pencil, Notched Trowel, Weep protectors, Silicone, Solvent Cement.

For the traditional type of waterproofing, the professional should build a **shower pan** in the wet /shower area with PVC, Vinyl, Lead or Fiberglass material, then the drain usually connect to the waste line with a mechanical clamp down drain flange (drain base), some model do not include such flange and need separately purchase before installation.

1

Please be sure to read carefully before installation.

Site & Placement

Whether for a renovation or new construction, choosing the drain location is contingent on the waste line location, which may be predetermined or already installed. Moving a waste line may be possible, depending on site conditions.

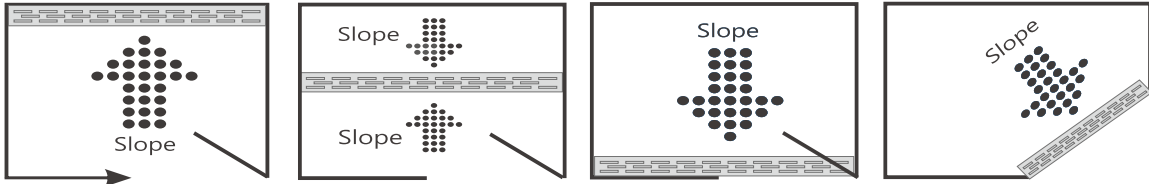

Tile insert process

If you don't buy Tile-insert design, just skip to next page.

Do not forget to cut the insert tile before complete the tiling.



Heat and peel off the protective film.

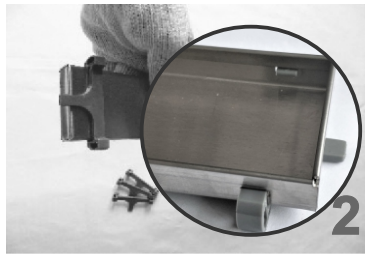

Assemble the supporters under the tray, ensure to be stuck in all location hole.



Carefully measure the tray, cut the insert-tile as required size, maximum tile thickness 10 mm.



Evenly apply adequate tile adhesive or silicone on the back and perimeter of tile.



Lay the insert tile into the tray, tile surface should be 1mm above the tray edge to avoid ponding water.

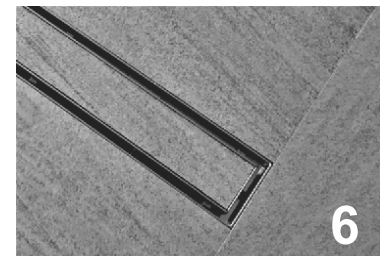

Screed off the excess tile adhesive, clean up the tile surface and the tray. Wait 24 hours before using.

If you choose 2 in 1 grate, the tray also can be used as stainless grate besides as tile tray, the regular tile-insert grate is **unavailable** in this way.



Heat and peel off the protective film.

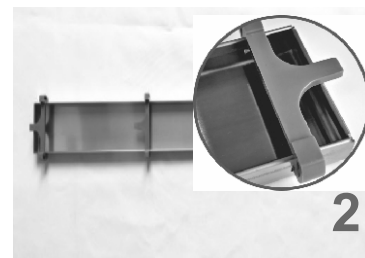

Assemble the supporter on the opening of the tray, ensure to be stuck in all location hole.



Turn the stainless side upwards, lay the tray into the channel.

2

Please be sure to read carefully before installation.

Installation

The following installation details do not cover every possible situation, some may not be appropriate for DIY. **Always consult with licenced professional during installation.**

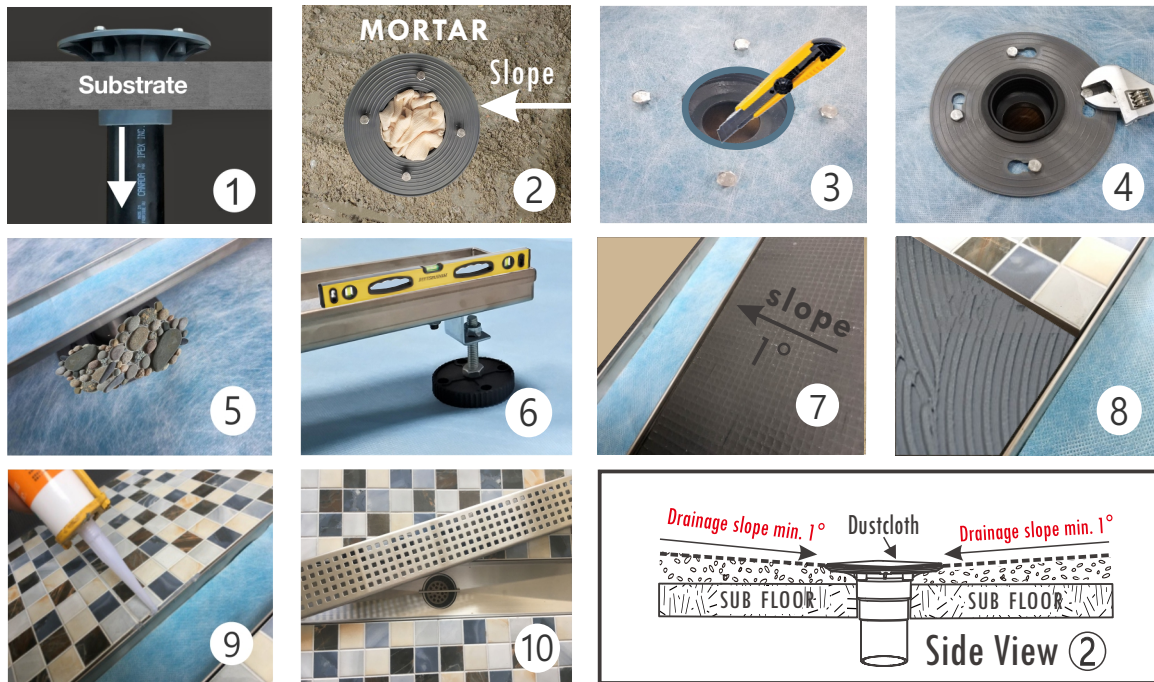

Installation Step:

1. Coupling the drain base outlet to 2" or 3" schedule 40 DWV pipe using correct solvent cement.
2. Block the drain opening with rag. Trowel mortar to build shower pan, reinforce around drain base to be flush with the floor, grade to create MIN 1% slope towards the drain.
3. Lay the waterproof membrane on whole shower pan, cut a slit for the bolts to poke through, then cut away the waste hole in the center. Bond the membrane around the waste hole with waterproof silicone.
4. Install the coupling plate, fasten the bolts. Perform leak testing be required before next step.
5. Push the drain outlet into the waste hole. Spread pea gravel or tile spacer around the drain base to protect the weep holes. Weep protector also be available.
6. Adjust drain body perpendicular to the slope direction, the top edge need to be flush with the height of tile surface, then level the drain body. (12" and less size can be adjusted and leveled without leveling feet.)
7. Trowel mortar onto the membrane, build up the shower floor allowing for thickness of tile and adhesive, grade to create MIN 1% slope towards the drain.
8. After the floor mortar has cured, install the floor tile with tile adhesive or thin set mortar, using notched trowel.
9. Fill the gap around the drain body with silicone bead or grout, sweep off the excess material.
10. Take away the protective fabric, finalize the installation by laying the grate into the channel.

Care & Maintenance

After installation, some aggressive substance such as sealant, adhesive, mortar maybe cause "yellow spot" on the channel, recommend using scour pad to remove such "spot", and always brushing in the direction of the grain. **Periodically clean** the fixture with non-abrasive cleaner or soft scrub.

For polished, matte black and oil rubber bronze finishes, we recommend cleaning with mild soap and soft cloth. **DO NOT USE** abrasive cleaners, ammoniated products, rubbing alcohol, detergents, astringents, bleach based cleaners, aggressive chemicals, abrasive cleaning pad, or harsh polishes on the fixture. Use of such substance may void the warranty.

3

Please be sure to read carefully before installation.



Installation Diagram

Install with drain base

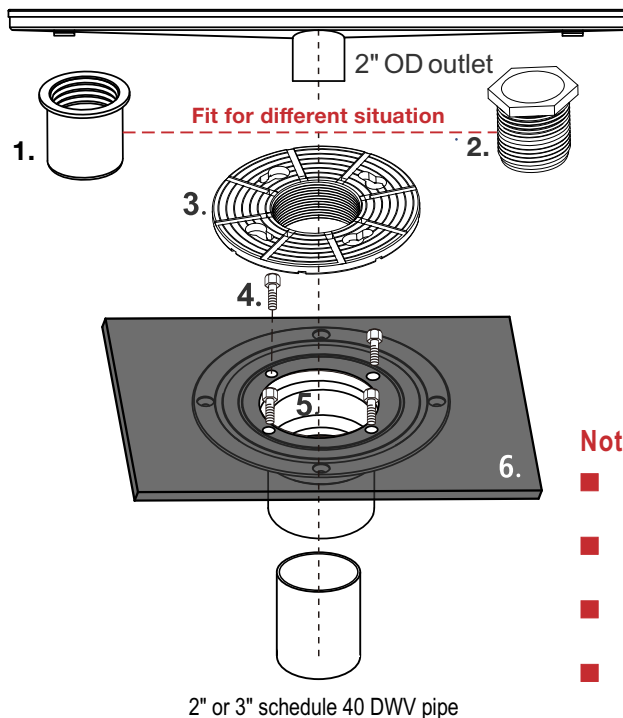
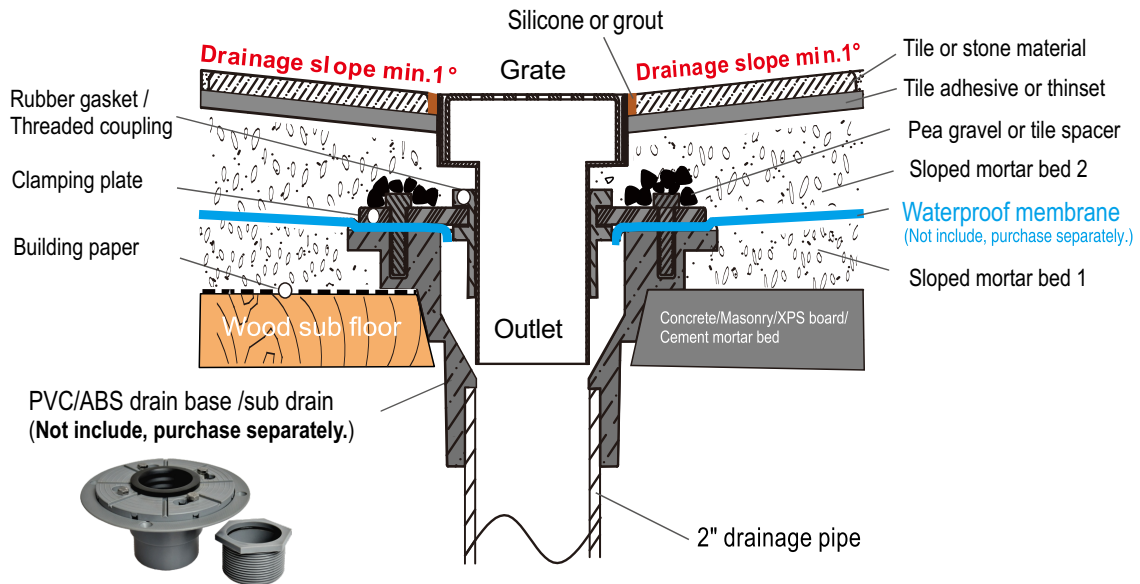

Drain base assembly

(Not include, purchase separately)

1. Rubber Coupling / Gasket
2. Threaded coupling
3. Membrane clamp
4. Stainless steel bolts
5. Drain flange/Drain base.
6. Waterproof membrane (not include)

Note:

- Solvent-weld (glue) to same material DWV pipe with correct solvent cement.
- The PVC drain base made of plastic, do not work with Hot-mop waterproofing.
- Mortar bed 2 plus tile and adhesive should be not less than 1-1/2"(40mm)
- Consider the drain base diameter when you install the drain against the wall .

© Jun 2021 Haizi Sanitary Ware Co.,Ltd.

All reasonable care have been taken in compiling the information in this document. All recommendations and suggestions on the use of Neodrain products are without guarantee since the conditions of use are beyond the control the Company. It is the customer's responsibility to ensure that each product is fit for its intended purpose and that the actual conditions of use are suitable. Neodrain Technologies Co.Ltd reserves the right to change products and specification without notice.