

USER MANUAL

VLOG Mobile screen sharing
device

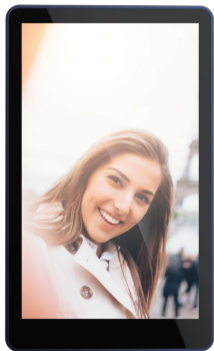

Contents

01、 Using Reminders	01
02、 Accessories List	02
03、 Functional Description	02
04、 Usage Guidelines	04
05、 Specifications	09
06、 Contact Us	10

01\Using Reminders

Notes before use:

1. Please read the instructions carefully before use to ensure the correct operation of the device.
2. Do not expose the selfie screen to extreme weather conditions (such as high temperature, low temperature, humidity, etc.) to avoid affecting the performance of the device.
3. Do not collide the selfie screen with sharp or hard objects to avoid scratching the screen or damaging the device.

Charging safety:

Try to use the DP-1 TYPE-C dedicated connection cable to charge the selfie screen, and avoid using incompatible chargers or data cables.

Maintenance and care:

1. Clean the screen: Use a soft dry cloth to gently wipe the screen. Avoid using detergents containing chemical ingredients to avoid damaging the screen surface.
2. Storage environment: Please store the selfie screen in a dry and cool environment. Avoid long-term exposure to high temperature or humidity to avoid affecting product performance.

02\Accessories List

01、Selfie screen	1 PCS	02、Magnetic patch	2 PCS
03、DP TYPE-C dedicated cable.....	1 PCS	04、user Manual	1 PCS
05、Bluetooth remote control.....	1 PCS		

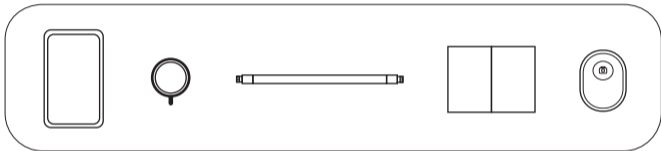

03\Functional Description

The product is suitable for live broadcasters and selfie enthusiasts who use the rear camera to watch the real-time screen of the mobile phone through the selfie screen. The machine supports the use of external headphones or live broadcast microphones, and supports DP multi-protocol reverse charging for mobile phones.

① -- Display

The selfie screen is equipped with a 480*800 resolution display and uses advanced screen projection technology to synchronize the screen images of the mobile phone and the selfie screen with zero delay, allowing you to preview and adjust the shooting effect in real time when taking selfies.

② --Side buttons

By pressing the side button, you can easily adjust the screen display ratio to suit different screen display needs.

③ -- Audio Interface

The product supports Type-C interface headphones or wireless live broadcast microphones, allowing you to enjoy high-quality audio experience during live

④ -- Charging port

This interface can not only provide power for the selfie screen, but also support charging the mobile phone, achieving uninterrupted power supply.

⑤ -- Data Interface

This interface is designed for audio and video transmission and sharing between the selfie screen and the mobile phone.

⑥ -- Display Light

The red light is the power indicator light. If it stays on, it means the power is successfully connected.

The green light is the screen projection status light. If it stays on, it means the screen projection operation is successful.

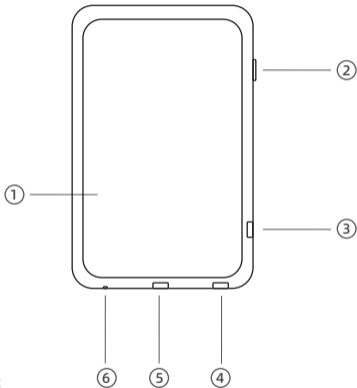

04\Usage Guidelines

01、Side button usage guide

Short press the side button to switch between the following three screen ratios:

1. The screen image ratio will be precisely adjusted to 1:1, perfectly restoring the original ratio.
2. The horizontal margins of the screen image will be reduced to fit closely to the left and right edges of the display.
3. The screen image will be stretched to full screen mode to make full use of every inch of the selfie screen display space.

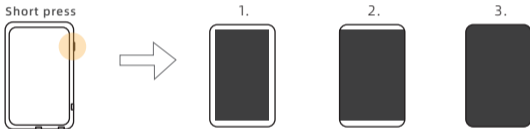

Long press the side button to realize the screen mirroring and recovery functions: instantly mirror the screen image, or switch back to normal display state.

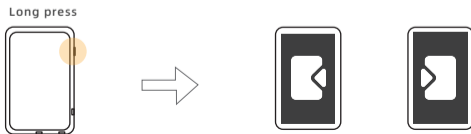

02、 Power on and off guide

Power on: Plug one end of the cable into the data port, and then plug the other end into the Type-C port of the phone. At this time, the device power supply will be used to power the machine and realize the sound and video synchronization functions.

Power off: Just disconnect all connections.

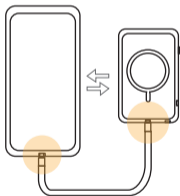

Power on

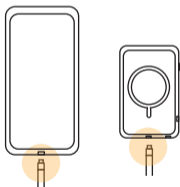

power off

03、 Installation Guide

Tear off the sticky tape on the back of the magnetic patch and stick it on the surface of the phone or phone case to achieve convenient magnetic connection of the selfie screen.

(Some phones do not require magnetic suction and can be directly connected to the built-in magnetic suction of the phone.)

1、



2、

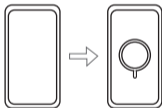

3、

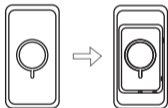

04、Live broadcast without sound

If one end of the cable is accidentally plugged into the charging port and the other end is normally connected to the Type-C port of the mobile phone, the device will only display the picture and the earphones will be silent. You need to plug the cable into the data port.

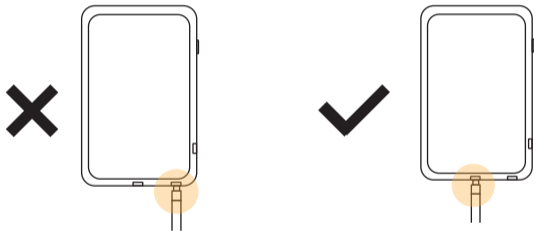

05、Bluetooth remote control usage guide

1. Turn the remote control switch to the on position. The LED light flashes blue to turn on the device; turn the switch to OFF to turn it off.
2. Turn on the Bluetooth of your mobile phone, search for the device name: **AB Shutter 3**, click pairing and connect.
3. Open the camera interface on your mobile phone, press the shooting button on the remote control to control the shooting.

1、

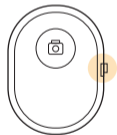

2、



3、

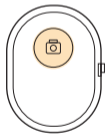

05\Specifications

Product model:	TF39
Product material:	ABS+PC
Product quality:	85g
Product size:	62*102*9MM
Screen brightness:	400 lumens
Viewing angle:	full viewing angle
Support touch:	not supported
Power input:	5V
Rated power:	2W
Display interface:	TYPE-C*1
Headphone interface:	TYPE-C*1
Reverse charging port:	TYPE-C*1
Button:	Touch*1
Red light display:	Power
Green light display:	Screen projection successful

06\Contact us

If you have any questions or need help, please contact our customer support team, we will be happy to serve you.

Contact information:

Email: ttq-vip@outlook.com