

Yansoo

3 CHANNEL DASHCAM

X88-3

User Manual

X88



YanSoo

Enjoy Your Smart Driving

Dear Customer,

We are truly grateful for you choosing YANSOO! We hope you will enjoy the quality of our products and services.

If you need assistance, or have any suggestions to improve it, please feel free to contact us. You can reach us via **AMAZON Platform** or **yansoo_service@163.com**, and we will have professional technical service personnel to serve and answer you at any time.

Our support team will respond you within 12 hours. You are an incredibly important customer, and serving you has been an honor.

We may not be the best, but we will always do our best to provide you the best service!

Kind Regards,

YANSOO TEAM

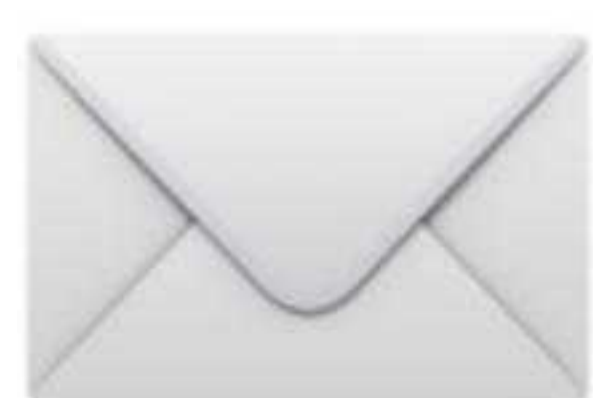

yansoo_service@163.com

Response in just 12 hours. Contact us before returning the item. We will help you resolve any issues asap.

Table of Contents

1. Important Notice.....	01
2. Camera Overview.....	03
3. Basic Operation.....	06
⦿ Device Power.....	06
⦿ Menu Settings.....	06
⦿ Video Recording Mode.....	07
⦿ Photo Taking Mode.....	10
⦿ Playback Mode.....	11
⦿ System Setting Menu.....	13
⦿ Button Tips.....	14
4. Installation.....	16
5. FAQ.....	21
6. After-Sales Service.....	26

1. Important Notice

- Please use the car charge and Type-C cable in the package to power this camera; The cable in package is only used as a power cord, can not transferring videos to your computer.
- If your purchase does not include a rear camera, please ignore the information about the rear camera.
- Before installing the camera, please power up the dash cam to test whether it can be used properly, including whether the display of the front, cabin and rear cameras is normal. (Please use the car charger to get power from the cigarette lighter)
- The camera cannot be operated while recording, so press the OK Button to pause recording before making function settings.
- Micro SD Card NOT included in package. Please kindly prepare a high speed Memory SD card, Class 10 or above, kindly format the card in the camera menu before use.(16GB / 32GB cards are recommended)
- The car camera has a built-in battery as an internal power source for emergency recording. If you want to keep the camera turned on for 24 hours, you need to power it continuously, just connect it to the Hardwire Kit. (need to purchase separately)

- Do not install the camera where it may obstruct the driver's view (including the rearview mirror) or the deployment of the airbag. Be sure the camera lens is clean and there is nothing blocking the lens.
- Do not leave the camera in direct sunlight for a long period of time or where the temperature could go above 158°F (70°C).
- We suggest some important function settings for your daily using: G-Sensor level choose "low", or turn off; loop recording choose "3 minutes"; motion detection choose "off"; parking monitor choose "ON", security camera for car.
- We suggest you format the SD card monthly to extend its life span.
- See the Frequently Asked Questions section for some other frequently asked questions. If these still don't solve your problem, drop us a message via the Amazon page, all setup issues are easily resolved and should get you up and running in no time. Rest assured, we will take 100% responsibility for our products. We just want our customers to be happy and proud of using Yansoo Dash Cam!

2. Camera Overview



1. Flashing while charging
2. Flashing while recording
3. Microphone
4. Button Guide Icons
5. Reset
6. Micro SD Card Slot (SD Card need to purchase separately)
7. Type-C Charging Port
8. Mount Connector
9. Rear Camera Port
10. Menu Button / Mode Button
11. Up Navigation Button / Quickly Turn Off the Night Vision Function Button / Screen Toggle Button /Switching between front and inside files Button
12. Power Button / Screensaver Button
13. Down Navigation Button / Switching microphone Button / Switching between Front, Cabin and Rear Files Button
14. OK (Confirm) Button / Record Button
15. Lens
16. Speaker

Screen Icons

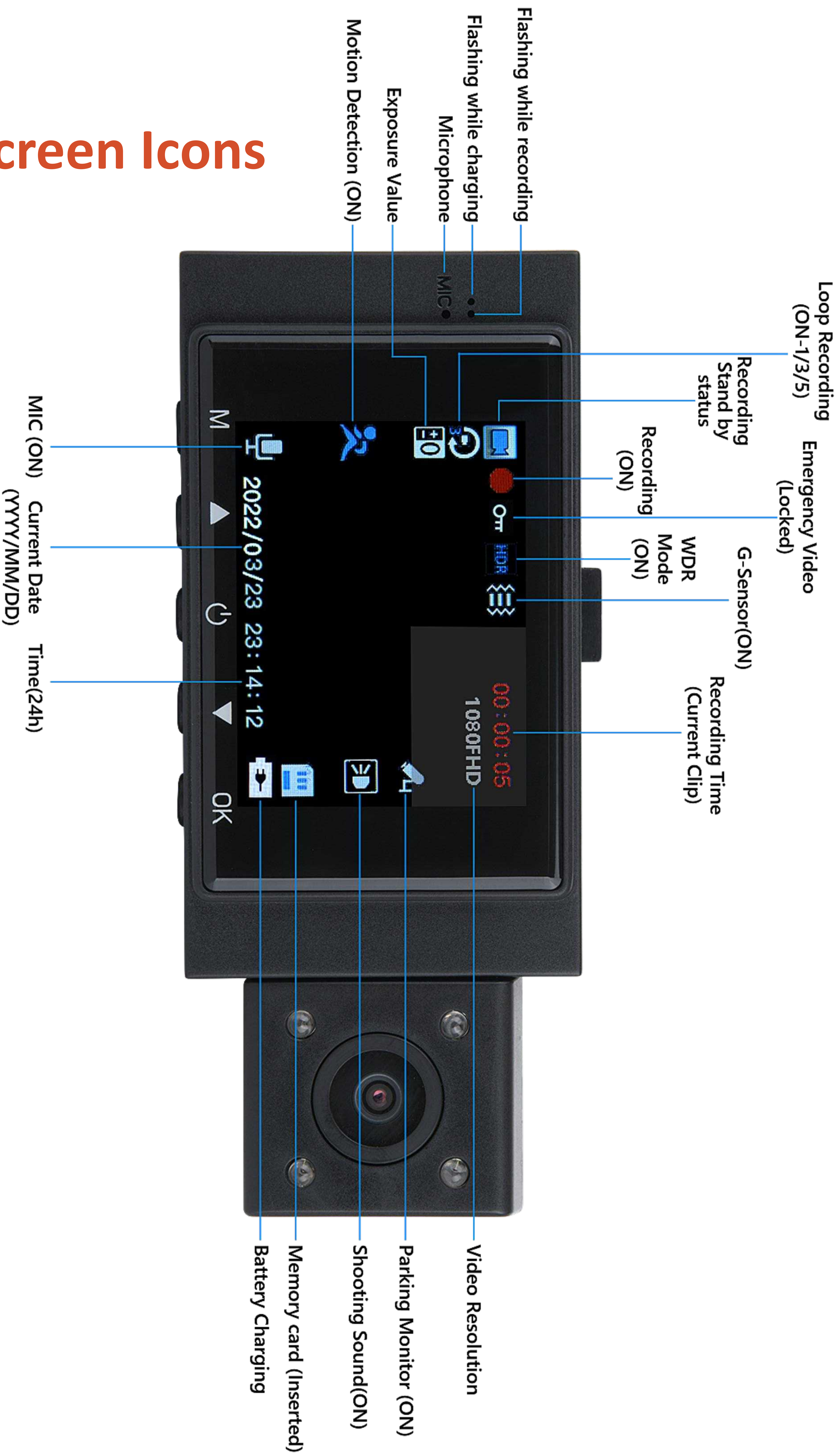

3. Basic Operation

Device Power

The device will be automatically powered on when it's plugged into a 12V accessory socket or cigarette lighter and receives power (i.e.: when the vehicle is started).

- To turn the device on manually, press and hold the **POWER Button** until the screen lights up.
- To quickly turn on the Screensaver when the Dashcam is on, use a short press on the **POWER Button** once. The display screen will go out (however the dashcam will still be running at this time). Use a short press on the power button again and the display screen will go back on.

Menu Settings

When the dash cam is turned on, you can press the **OK Button** to start recording, and also press the **OK Button** to stop recording.

- The X88 operates in 3 modes:
Video Recording Mode, Photo Mode and Playback Mode.

These modes also have menus to help you configure recording and taking photos. Long Press the **MENU Button** to access the mode you want. You can distinguish the different modes by the icons in the upper left corner.

- In all 3 operating mode, you can short press the **MENU** once to access the menu settings for that particular mode, and short press twice to display *System Setting Menu*.

Press the ▲ and ▼ Buttons to scroll through the various setup functions and press **OK Button** to select. Press **Menu Button** again to exit/return.

Video Recording Mode

After connecting the car charger and turning on the power, the camera will enter the screen, and you can choose to set the function or record. The blue LED lights up and the red dot in the upper left corner flashes to indicate recording. Press the **OK Button** to stop recording in standby mode, or to restart recording.

(Standby mode means that there is no ongoing operations)



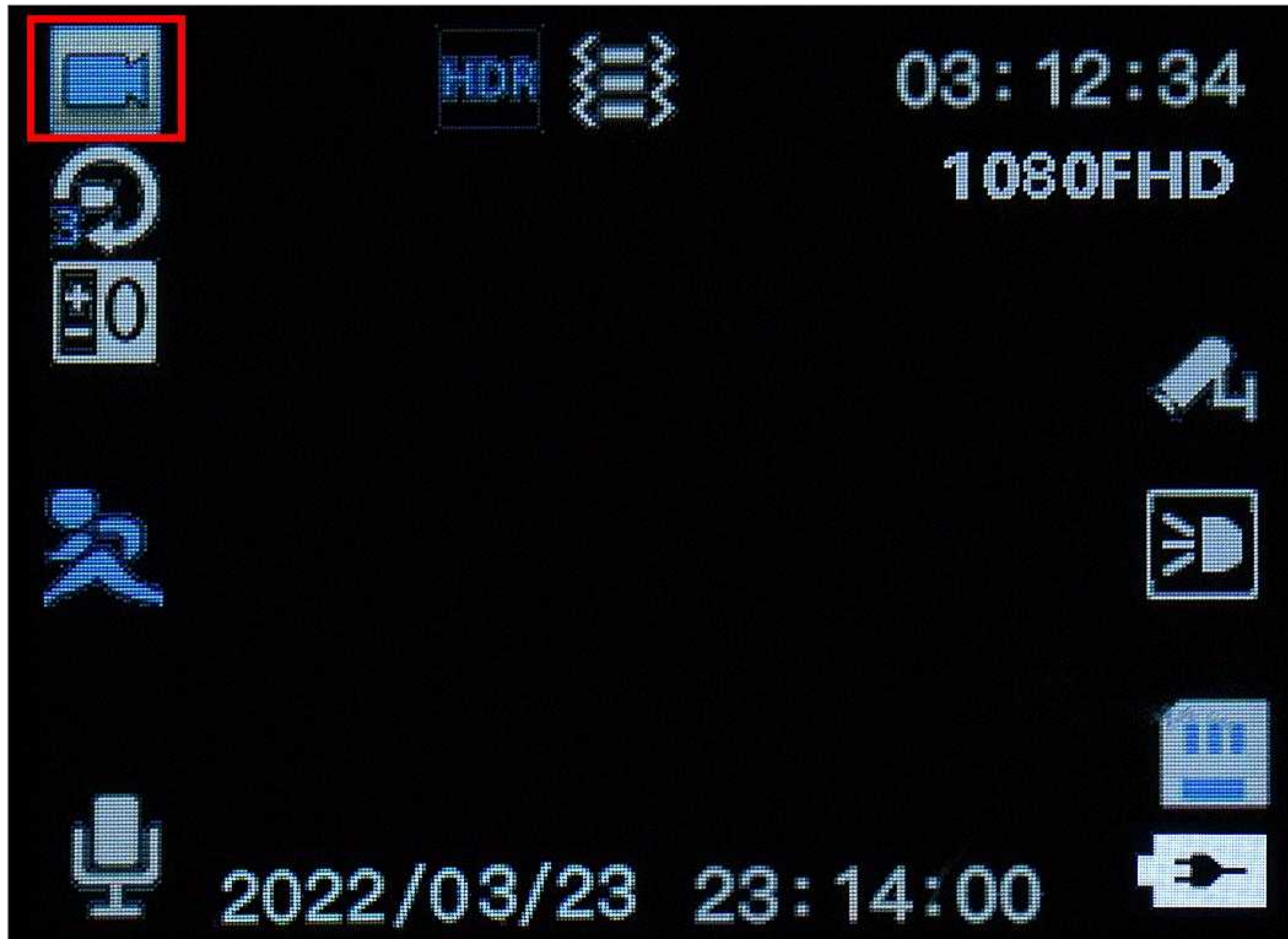

'Video Recording Mode'



'Video Recording Menu'

In **Video Recording Mode** press the **"MENU" Button** to enter the **setting menu of video recording mode**.

- **Resolution:** 1080FHD (1920*1080)/ 720P (1280*720)/ VGA
- **Loop Recording:** This function allows you to set video file length to 1/3/5 minutes, select a value to activate loop recording, so when storage fills up, it will automatically loop back to the earliest file and record over it. (Please note: Locked video files cannot be overwritten, you need to clear these locked files by manually deleting or formatting them)
- **WDR(Wide Dynamic Range):** After turning on this function, the camera will automatically fine-tune the exposure to maximize the clarity of the video when encountering low light or backlight conditions.
- **Exposure:** Adjustable exposure value, used to change the image brightness. (± 3.0)
-

- **Microphone:** Turn on/off audio recording in the video. You can achieve it in two ways, manually turn it on/off through the menu or short press the down button to quickly turn it on/off.
- **Date Stamp:** Enable/Disable the date and time marks in video files. (Recommended to turn on)
- **Motion Detection:** This function can automatically start recording in standby mode when a moving object is detected in front of the camera.
- **G-Sensor (Gravity Sensor):** G-sensor will detect significant or sudden shock and movement then automatically locks current recording from loop recording, Off/Low/Medium/High sensitivity available.
- **Parking Monitor:** It is used to protect your car after parking, with this function on, after you park the car and the camera powers off, it will stay in standby mode, when the camera detects shocking, it will automatically turn on and shoot 31 seconds of video, then then shut down automatically.

(It is recommended to turn off the motion detection and parking monitor functions during driving, otherwise it will automatically lock multiple files causing the memory card to be full)

Photo Taking Mode

To take a photo, stop video recording and long press the **Menu Button** to switch to Photo Taking Mode.

Press the **OK Button** to take a photo.

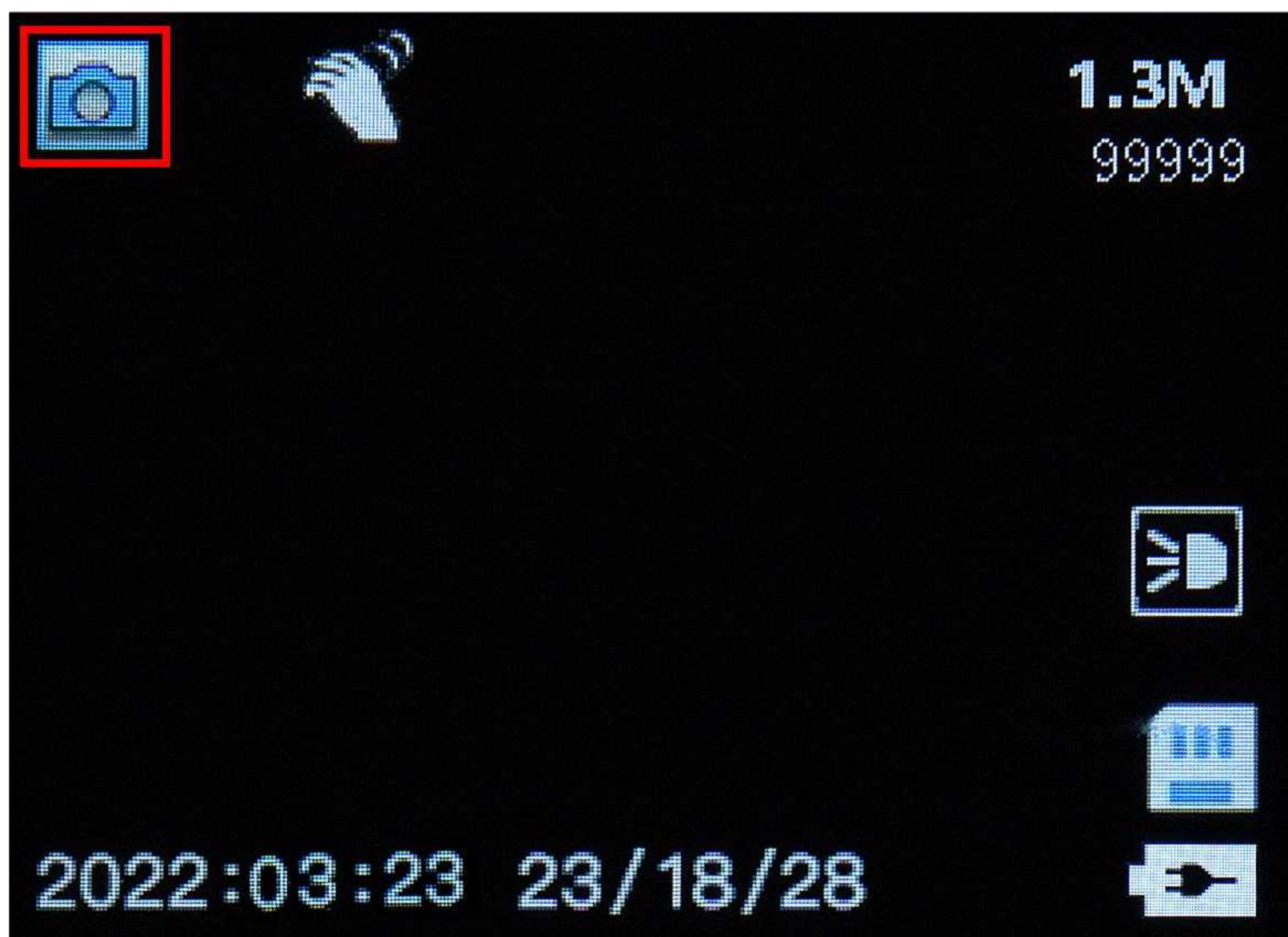

‘Photo Taking Mode’

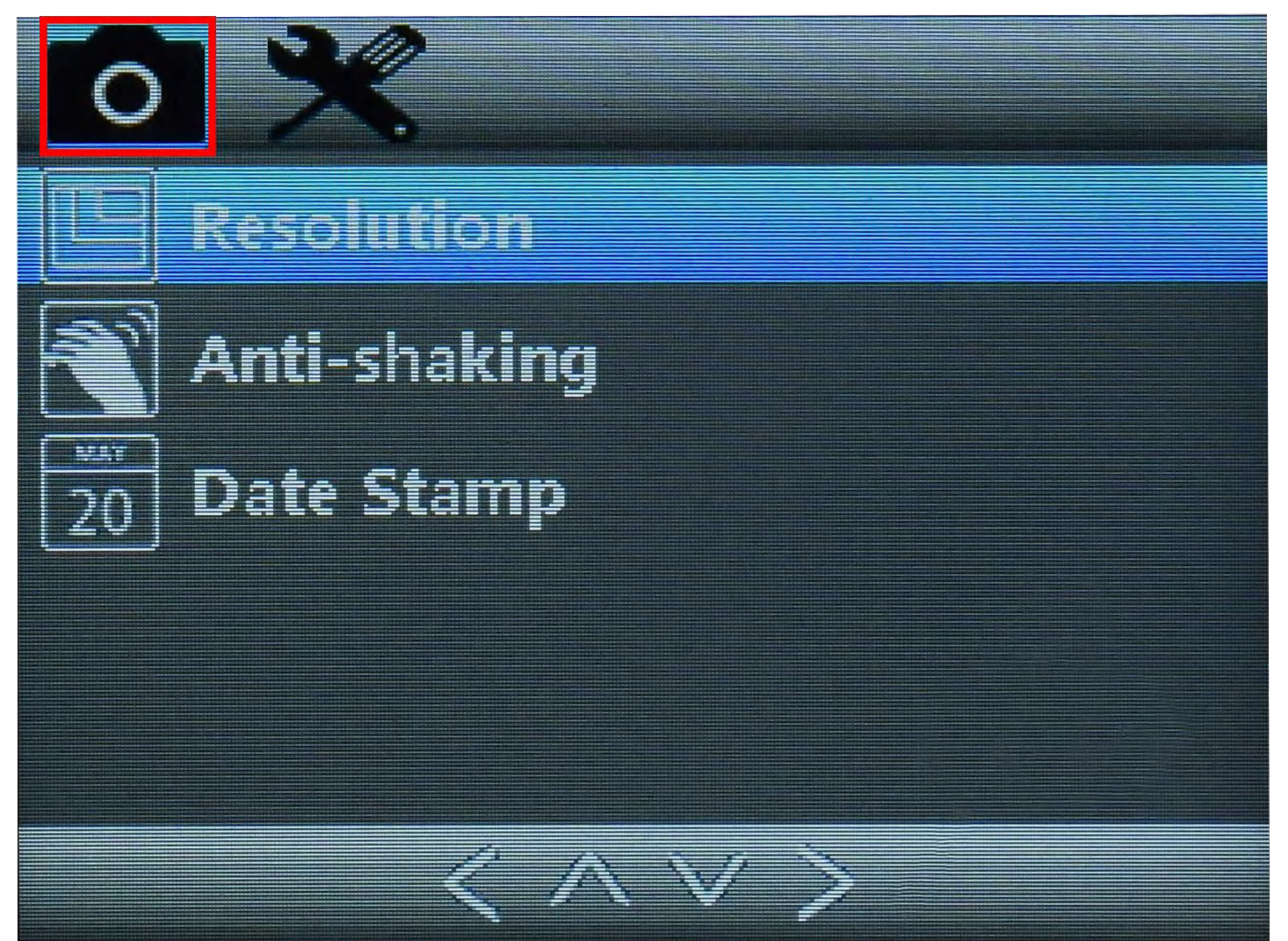

‘Photo Taking Menu’

In ***Photo Taking Mode*** press the "MENU" Button to enter the ***setting menu of photo mode***.

- **Capture Mode** : Single shot / 2s Delay / 5s Delay / 10s Delay
- **Resolution**: Set the photo resolution. (Optional: 10M 3648*2736 / 8M 3264*2448 / 5M 2592*1944/ 3M 2048*1536/2M 1920*1080/ 1M 1280*960/VAG)
- **Continuous shooting**: Off / On (After opening, you can take 3 photos in a row)
- **Quality**: Defines the quality of image you capture.(Optional: Fine / Normal / Economy)

- **Sharpness:** Defines the clarity of details in the photos. (Optional: Strong / Normal / Soft)
- **White Balance:** Establishes the condition to capture an image based on the option given. (Optional: Auto / Daylight / Cloudy / Tungsten / Fluorescent)
- **Color:** Normal / Black and White / Sepia
- **ISO:** Auto / 100 / 200 / 400
- **Exposure:** Adjust exposure value to adjust the brightness of the photo
- **Anti-shaking:** Off / On
- **Date Stamp:** Enable/Disable the date and time marks on photo.

Playback Mode

Playback of videos can be done on the device or a computer.

To review a photo / video on the device, press and hold the **MENU Button** twice to switch to Playback Mode. Use the ▲ and ▼ Buttons to toggle to the desired video. Press the **OK Button** to play.

In Playback Mode, Long press the ▲ Button to switch front and cabin, rear files. During playback use the OK (pause), ▲ (rewind) and ▼ (fast forward) Buttons to control the video playback.



'Playback Mode'

- **Delete:** Delete Current / Delete All
- **Protection:** Lock One / Unlock One / Lock All / Unlock All

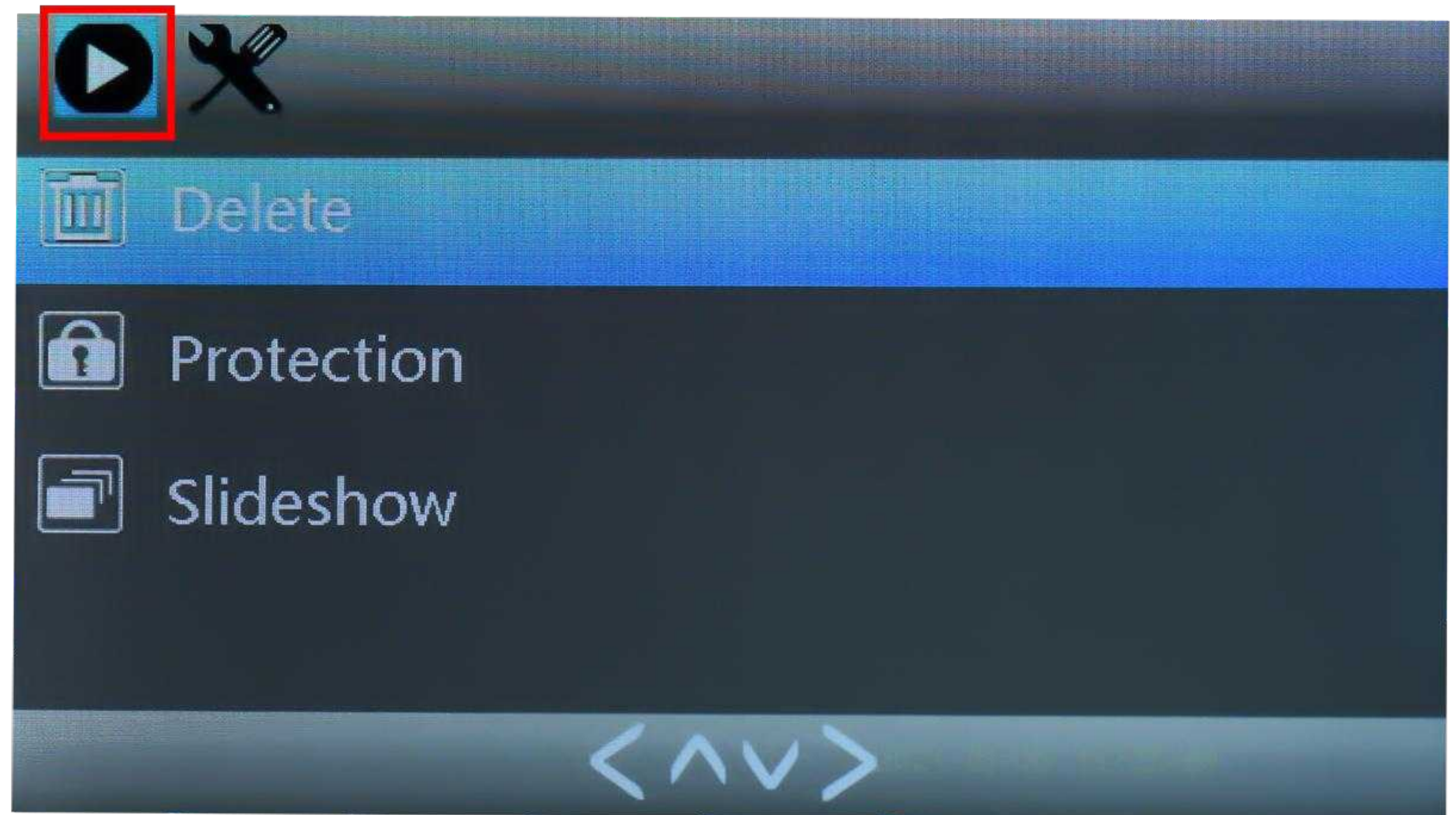

'Playback Menu'

To delete a photo / video, stop video recording and toggle to the Playback Mode and toggle through the videos and photos to the one you want to delete.

-To playback a photo / video on the computer, use the SD card adapter which is include in package and connect with computer.

- To playback a video using an *SD card adapter*, remove the memory card and insert it into an SD card adapter. Place the adapter in the computer.



System Setting Menu

Press **Menu Button** twice to access System Setting Menu in any mode. The  icon is highlighted in the upper left corner.



'System Setting Menu'

- **Screen Saver:** In order to guarantee safe driving, not to be effected by the light of recorder, you can set the screen saver to shut off the display, press any key to turn it back on. Set the time to automatically turn off the LCD display after no operation. (Optional: Off / 30 Seconds / 1 Minute / 2 Minutes / Quickly turn on the screen saver by tapping the power button)
- **Auto Power Off:** Set the time for the camera to automatically power to save energy. when the camera is not recording and without any operation, it will power off. (Optional: Off / 3 Minutes / 5 Minutes / 10 Minutes)
- **Frequency:** 50Hz / 60Hz
- **Key Sound:** Off / On

- **Language:** Japanese / English / German / French / Spanish / Italian/ Chinese
- **Date/Time:** Change the time and date by using the ▲ and ▼ , then press OK to confirm.
- **Fill Light:** Off / On / Auto
- **Boot Sound:** Off / On (Power-on and power-off sounds)
- **Format:** Format the Micro SD Card.
- **Default Setting:** Reset all settings back to factory default.
- **Version:** The current version of the machine

Button Tips

Menu Button:

1. Long press the **Menu Button** to switch between 3 modes (Video Recording Mode, Photo Taking Mode, Playback Mode).
2. After entering the mode setting, short press the **Menu Button** to enter the System Setting Menu, and press the **Menu Button** again to return to the screen.
3. During recording, short press the **Menu Button** to lock the video, and press again to unlock the video.

▲ Button

1. Short press ▲ Button to switch the display screen mode,

There are 4 modes:

1) The front camera is displayed at the bottom of the screen, the cabin camera is displayed at the top right of the screen, and the rear camera is displayed at the top left of the screen.

2) The front camera screen fills the full screen.

3) The cabin camera screen fills the full screen.

3) The rear camera screen fills the full screen.

2. Long press ▲ Button to turn on or off fill light.

▼ Button

1. During recording or in standby mode, short press ▼ Button to turn on or off the microphone.

2. In playback mode, long press the ▲ Button to enter the photo or video folder of the front, inside and rear cameras, then short press the ▲ Button or ▼ Button to switch the photos or videos recorded by the camera.

4. Installation

Step 1: Insert the Memory Card

Before installation, please check the camera's normal function, and make sure you are using a high speed Micro SD card (speed Class 10 or above.), and format the card before recording.

Gently push the memory card in until you hear a click, and allow the spring release to push the card in/out.



Step 2: Install the Camera onto the Windshield

Clean the front windshield before installation. Tear off the plastic protective film from the suction cup, press the suction cup to the suitable position on the inner windshield, and rotate the suction cup handle to ensure that the suction cup is fixed. Do not install the camera in a place where it may obstruct the driver's view.



Step 3: Connect the power

Connect the Type-C cable to the car charger and the camera and then plug in the car charger into cigarette lighter, hide the rest of the cable in the gap of the Interior trim board. The camera will auto-start recording once powered on.



(After connecting the car charger, the camera will automatically start recording when car start. Please feel free to contact us if you have any questions during the installation process.)

Step 4: Mount the Rear Cam

(If your purchase does not include a rear camera please ignore information in this section)

There are two ways to place the camera.

- **METHOD 1:** Mount on the rear windshield. There is a 3M glue in the package for the rear camera. Please clean the rear windshield and find a suitable position, then glue the rear camera on the windshield.



- **METHOD 2:** (Recommended!) Install it near the license plate. There are fixing screws inside the package to help you fix it.



2.1. Select a flat and central place that near the number plate lamp at the rear of the vehicle to mount camera.

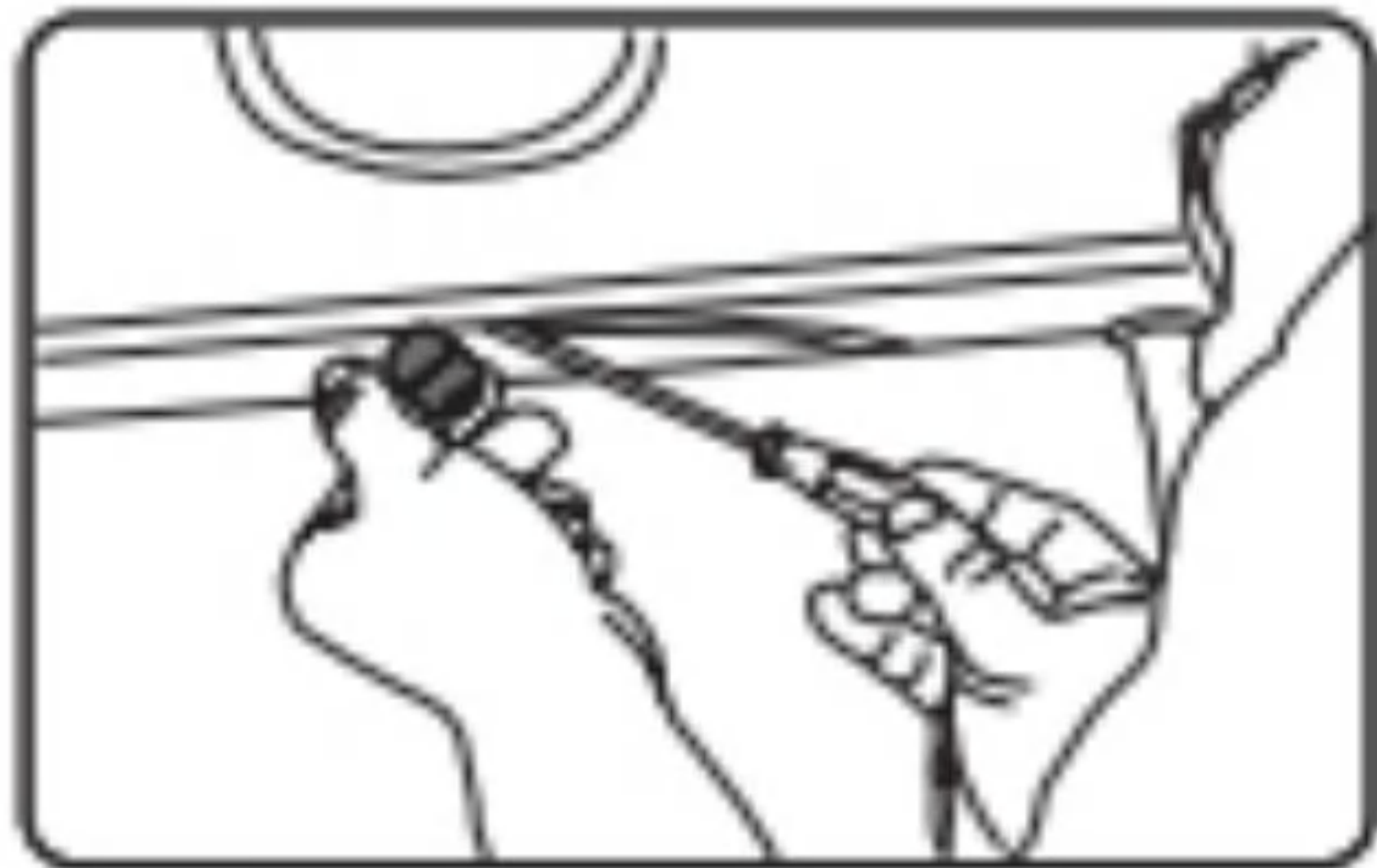
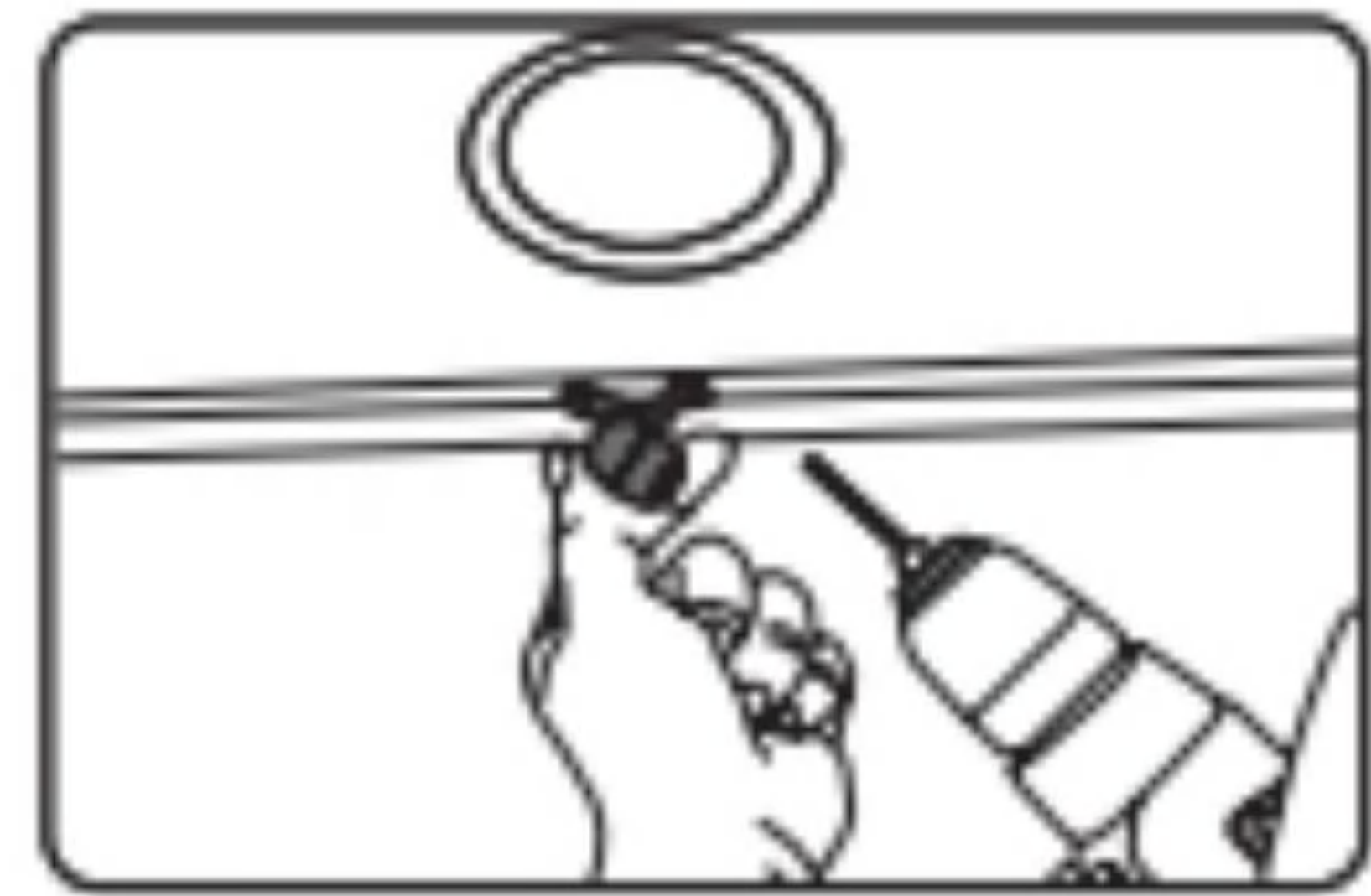

2.2. Attach tape to the bracket of the camera to hold the camera in position while installing, and drill two small holes, one for the first screw, the second to run the reverse camera cable through.

2.3. Use a screwdriver to fix the first screw, leaving the screw loose enough to adjust the camera.



2.4. Insert the camera wire through the intended drilled hole, checking the installation position.

2.5. Mark the place that suitable for the second screw and drill a small hole for it.



2. 6. Fix the second screw and s
ecurely tighten both screws.

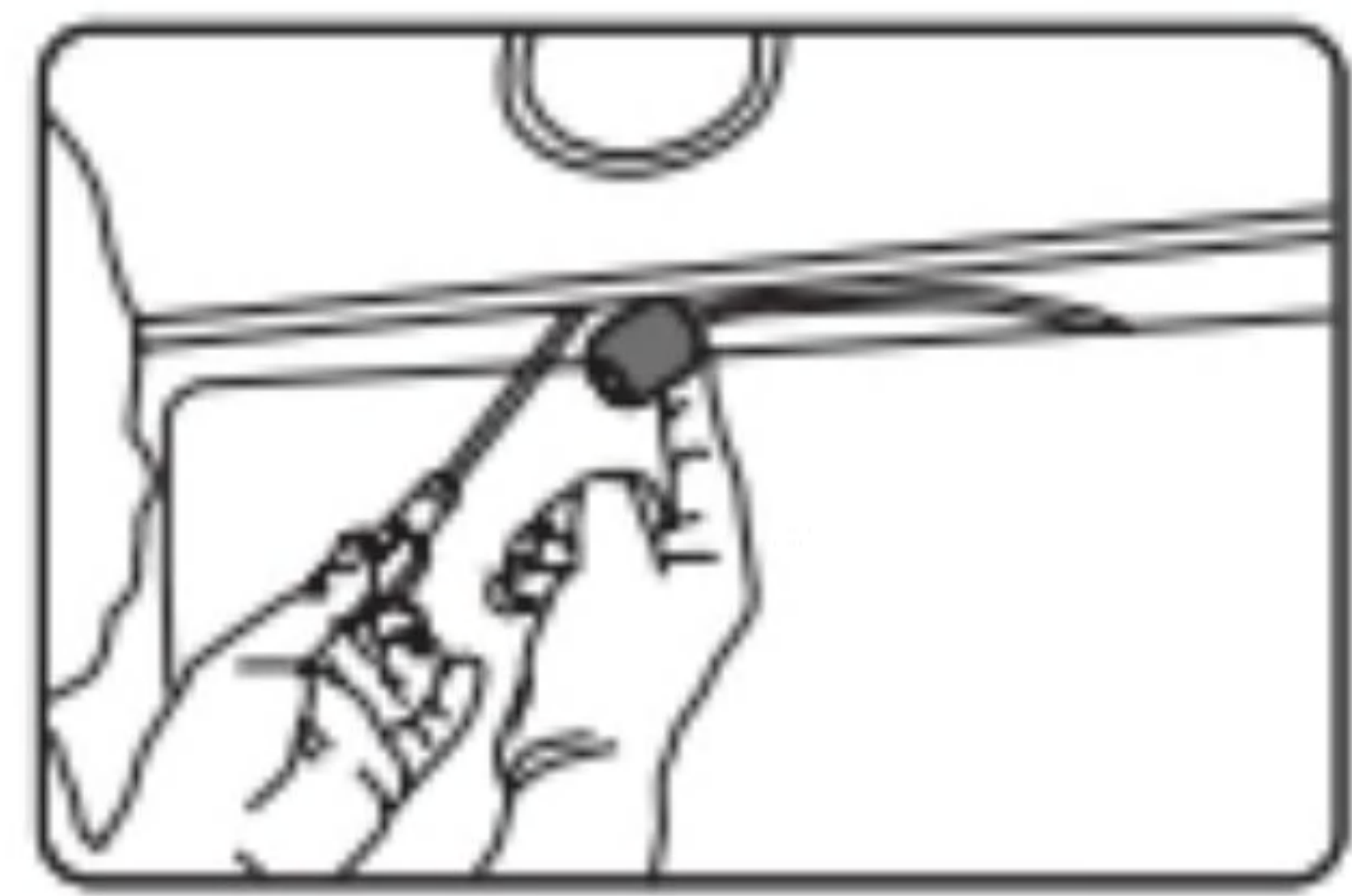

2.7. After the installation is completed, connect the rear plug to the rear camera interface of the recorder, and connect the red reverse line on the extension line of the rear camera to the positive pole on the reverse light.

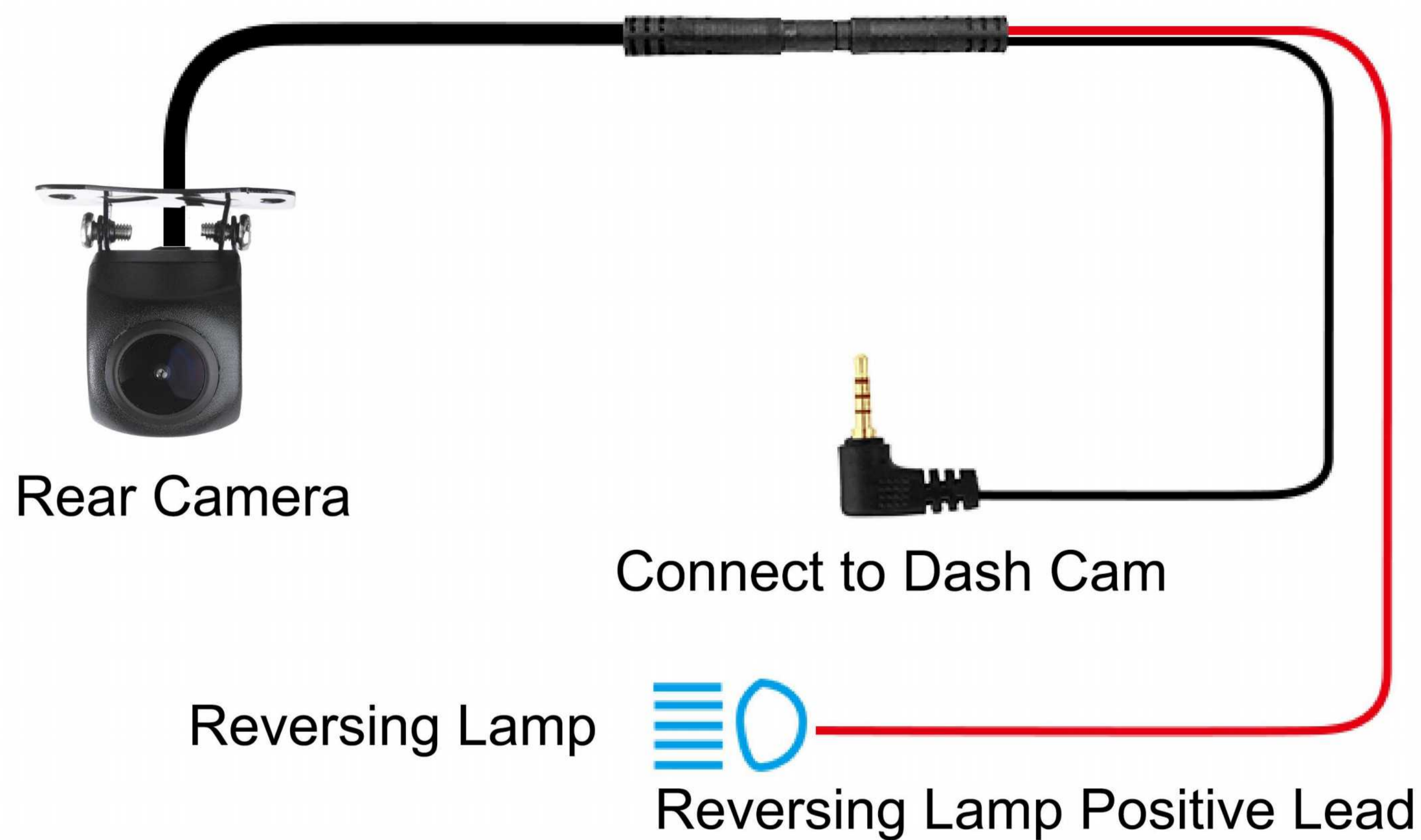

Step 5: Start the engine and have a test run.

If you encounter any problems during the installation process, please contact us in time we will do our best to solve them for you.



5. FAQ

Q1: Why can not found the inside camera file?

There are two situations here:

1) When you want to play back the video on the camera, enter the play mode and long press the ▲ button to switch the front and inside video files.

2) When you want to play the video on your computer, just open the folder "DCIM", there are 3 subfolders "FRONT", "BACK" and "INSIDE".

Q2: Camera turns ON / OFF frequently automatically?

First, make sure the power supply is well connected and format the SD card on the device. Second, please reset your camera by inserting a paper clip into the reset slot while the camera is turned ON. This will clear any software glitches. Restore settings to factory default by going into the camera's System Settings. Now, try recording and see if this solves the problem. Please make sure that "Motion Detection" "Parking Mode" and "Auto power off" are set to OFF. Contact us if the problem persists.

Q3: Camera Freezing/Lagging or Crashing?

Use a pin or an unfolded paper clip, press the RESET Button (Located at the side) to restart the camera. Now the dashcam should turn ON. If it still doesn't turn ON, then please CONTACT US.

Q4: I put an SD card in the dashcam and it only wants to recorded for a few hours then says sim card is full, why?

1. If the loop recording function is not turned on. Please turn on the loop recording function. Loop recording means the recorded video will be saved in sections for 1/3/5 minutes of your choice. When the SD card memory runs out, the previous video files will be overwritten except for the locked files.

2. If the loop recording function has been turned on. It may be that the locked files exceed the capacity memory of SD card, you can save the needed videos to your computer and then format the SD card. Also, it is recommended that you turn off the parking monitoring and motion detection functions and turn down the sensitivity of the G-sensor function when you are driving on the road, so that there will not be many useless videos being locked and taking up the memory of the SD card.

(If you choose too high a sensitivity setting, then even slight fluctuations will trigger the locking of video files)

Q5: The car camera could not turn on?

There are 3 reasons that can cause this problem: 1) The dashcam needs continuous power supply, just check if the power connection is normal. 2) The dashcam needs to be reset, just connect the power, click the reset button with a pin and start the camera. 3) A defective card can cause the camera not to turn on, just remove the card or get a new card and insert it into the camera.

Q6: Suction cups do not attach well to the windshield?

Please clean the windshield with a glass cleaning wipe, then remove the protective film from the suction cups, then soak them in warm water for a few moments. Finally, press the suction cups to the right position on the inner windshield and rotate the suction cup handle to make sure the suction cups are fixed. If it still does not work, please contact us for replacement.

Q7: There is nothing appeared on computer when connecting the dash cam and computer with the type-C cable.

The type-C cable in package is just for power charge which can only connect with the car charge, but can not use for data reading. If you need check the saved videos and photos, please use the SD card adapter to connect with computer.

Q8: The camera says "Please insert SD card" after inserting the card, why?

There are 2 reasons that can cause this problem: 1) The card is a low speed or bad quality card, just replace it with a high speed good quality card (speed over class 10, no more than 32GB), format your new SD card when you use it for the first time. 2) Insert the card when the camera is on, the camera can not recognize the card, just turn off the camera and insert the card, then turn on the camera.

Q9: Color screen or lines on the screen?

1. please check that you are using the proper memory card, SD card incompatibility can cause this. (We recommend using a class 10 high-speed micro card with no more than 32GB)
2. remove the SD card, reset the camera without inserting the SD card, and check if there are still lines on the screen.

Q10: The camera does not turn ON? (When you first use)

Please make sure you charge camera for 3 hours before first use. Make sure memory card is inserted properly. Then plug in power cable which should turn on the camera and it should start recording.

Q11: Oldest video files are missing?

The Yansoo Dashcam has split record mode. When it is set to either 1,3 or 5-min, it will delete the oldest video files over and over to continuously record seamlessly loop by loop without you having to delete old video files manually. This is the reason your old video files are missing. You can turn OFF loop cycle function to record one long continuous video file according to the capacity of your Micro SD card. Please note that if you select loop cycle function to OFF then the camera will give you message "Card Full" when it's out of memory and it will not record any further until you either insert a new memory card or delete/format existing memory card to make space to record again.

Q12: Is Video fuzzy?

Please make sure the lens of the camera is clean and there is no dirt or grease on the windshield also, try to adjust the angle to avoid blocks or glare or wind-shield reflecting. If the lens is out of focus, we are extremely sorry in advance. This can be a manufacturing defect. Please send us an email with a screenshot or a sample video so we can get this resolved for you ASAP.

Q13: The camera gets HOT?

It is normal for your camera to run slightly hot. Due to it is recording video at high speed, the dash cam maybe hot during using. (no more than 158°F/70°C)

Q14: What is the red wire on the rear camera cable for?

Your rear camera will appear as a "parking guide line" to help you park easily and safely when you connect the red wire of your rear camera. Therefore, if your car comes with a reverse system, you don't need to connect this red wire and only use it as a rear view camera.

- Situation 1: If your car already has a built-in reversing system monitor, without connecting the red cable to the positive terminal of the reversing lamp (12V), the reversing mode will not appear when you reverse (ie: using the car's own reversing system), and the rear camera will keep recording during this time.

- Situation 2: If connect, the cam will appear the reversing mode when you reversing, will not recording during that time. But the rear cam will keep recording normal when you driving.

6. After-Sales Service

Warranty

- All our products are covered by **one-year** warranty.

Customer Support

- For questions, support or warranty claims, please contact us via **Yansoo's** purchase page on Amazon and provide your order number. We will get back to you within 12 hours.
- If you can provide the photos or video to show your problem, we will be appreciated.
- **IMPORTANT:** Proof of original purchase (Online order receipts also accepted) is required for any warranty service.



Yansoo is firmly committed to continually improving our products, services and customer experience. As our VIP customer, if you have any thoughts on how we can do better, we would appreciate your constructive feedback and suggestions. Please contact us.

Thank you for choosing Yansoo!



