

TOZO[®]
www.tozostore.com

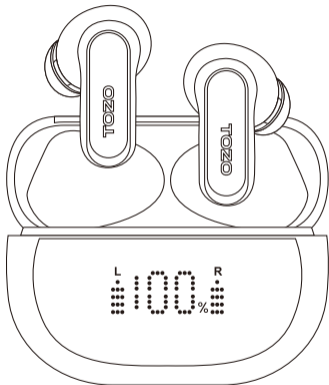

NC20

TRUE WIRELESS STEREO

User Manual

1.0 Product Diagrammatic Sketch

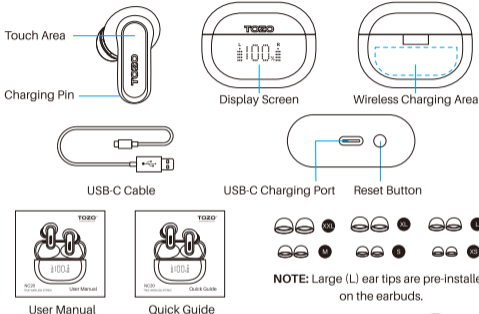

2.0 Wearing Steps

Step 1: Ensure the earbud tip is facing downward, then place the earbud into your ear.

Step 2: Rotate the earbud backward toward the auricle to fit snugly.



3.0 Pairing and Connectivity

Take the earbuds out of the charging case.

If previously paired, they will automatically reconnect to the last connected device. If not paired or pairing was canceled, the earbuds will enter pairing mode, indicated by a slow blinking white light.



Search for [TOZO NC20] on your phone's Bluetooth settings and connect.

4.0 Power On/Power Off

4.1 Earbuds Auto Power On

Open the lid, and the earbuds will automatically power on.



4.2 Earbuds Auto Power Off

Place the earbuds back into the charging case and close the lid to power them off automatically.

4.3 Manual Power On / Off

Tap and hold the "L" or "R" touch area for 3 seconds to power it on when it is off.

Tap and hold the "L" or "R" touch area for 5 seconds to power it off when not playing audio.

The earbuds will automatically power off if they remain disconnected in Normal Mode for more than 5 minutes.



5.0 Operation and Controls

5.1 Using Both Earbuds or a Single Earbud

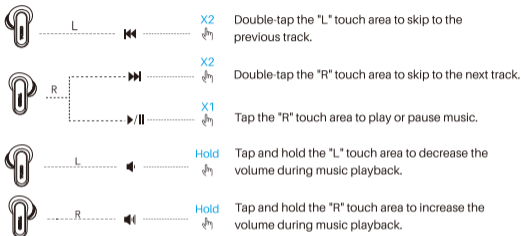

5.2 Call Controls

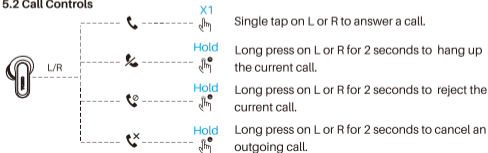

5.3 Active Noise Cancellation Control

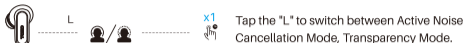

5.4 Voice Assistant



5.5 Reset

If only one earbud is functioning, follow these steps to reset:

1. Delete all [TOZO NC20] Bluetooth records from your phone and turn off Bluetooth.
2. Place the earbuds in the charging case with the lid open, then press and hold the RESET button for 10 seconds to complete the reset.

6.0 Active Noise Cancellation and Transparency Modes

6.1 Active Noise Cancellation Mode

TOZO NC20 earbuds use an feedforward microphone to detect external sounds and generate anti-noise signals to cancel them before they reach your ears.

A feedback microphone also detects internal sounds and reduces them through the same anti-noise system.



Active Noise Cancellation

6.2 Transparency Mode

Transparency Mode enhances the voice frequency range to help you stay aware of your surroundings. This allows you to hear ambient sounds clearly without removing your earbuds.

Note: For best performance, wear your TOZO NC20 earbuds properly to ensure a secure fit.



6.3 Adaptive Mode

Automatically adjusts noise cancellation intensity based on the surrounding environment.

7.0 Charging and Battery

7.1 Charging Case Indicators

1. When you open the lid or place the earbuds into the charging case, the display will show the battery levels of both the charging case and the earbuds. The screen turns off after 5 seconds.
2. When charging, the charging case's battery percentage will flash on the display.
3. Press the Reset button once to show the battery levels again. The display turns off after 5 seconds.



8.0 Wireless Charging

Place the charging case face-up at the center of the wireless charging pad. The battery indicator light on the charging case will turn on and begin flashing. Once fully charged, the light will stop flashing.

Note: Please remove any metal objects from the charging pad before charging. If the charging case overheats, charging will automatically pause.



9.0 Dual Device Connection

Note: This feature is disabled by default and must be enabled in the TOZO App.

1. Power on the earbuds and pair them with Device A.



Device A



2. Disconnect Device A, then enter pairing mode and connect to Device B.



3. Reconnect Device A by selecting it from your Bluetooth list. The earbuds will then be connected to both devices simultaneously.

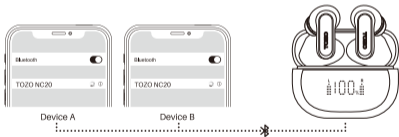

4. When the earbuds are connected to two devices simultaneously, if Device A is playing audio and you start playback on Device B, the earbuds will automatically pause playback on Device A and switch to play audio from Device B.

10.0 Wearing Detection

1. Enable or disable wearing detection via the TOZO App (disable by default).
2. When enabled, music pauses when you take off the earbuds and resumes when you put them back on.

Tips:

1. If playback was paused manually by tapping the right earbud, you must tap it again to resume.
2. Wear the earbuds correctly to avoid misdetection.

11.0 TOZO APP

Download the TOZO App for a fully personalized experience.

- UI Customization: Customize most control settings via the app.
- EQ Settings: Choose from a variety of EQ presets to match different music styles.
- Firmware Updates: Get the latest firmware updates for your earbuds through the app. You'll receive a notification when a new firmware version is available.



12.0 TOZO APP Pairing

Step 1:

Download the TOZO App from the App Store or Google Play.

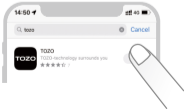

Step 2:

Connect the earbuds to your phone via Bluetooth.

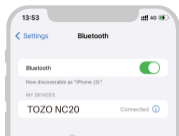
**Step 3:**

Pair the earbuds with the TOZO App.

