

## removing the fabric (continued):

Press the tab to unlock backrest support & lift out!

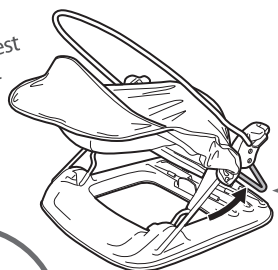
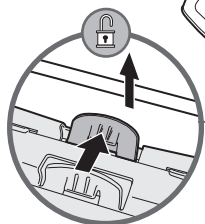

5

Release support legs from bather base by rotating the legs until key can slide out of slot!

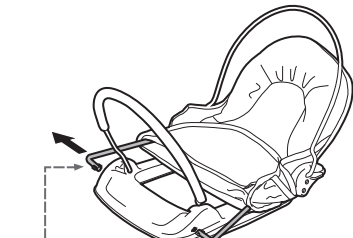
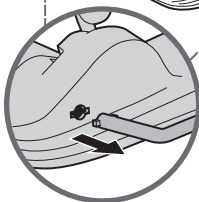

6

Slide the fabric off of the frame!

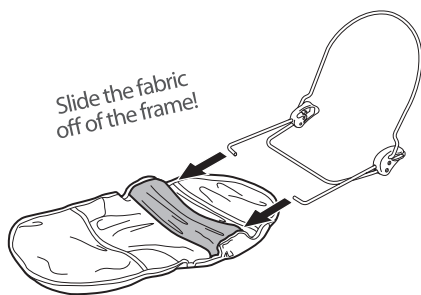

7

## cleaning & maintenance:

- Remove fabric cover. Machine wash on delicate cycle with no bleach. Wipe frame with a damp cloth and mild soap.
- Put fabric cover back on frame. Air dry.

Please check the following before each use:

- The seams in the fabric.
- Ensure the frame backrest support leg is properly snapped into one of the slots on the base.
- Do not use the bather if any components are damaged.

Summer Infant stands behind all of its products. If you are not completely satisfied or have any questions, please contact our Consumer Relations Team at 1-800-268-6237 or [www.summerinfant.com/contact](http://www.summerinfant.com/contact)

connect with us:    

  
summer  
infant®

Summer Infant, Inc.  
1275 Park East Drive  
Woonsocket, RI 02895 USA  
1-800-268-6237  
© 2016 Summer Infant, Inc.

Please retain information for future reference. Colors and styles may vary.  
**MADE IN CHINA.**  
8/16

09580/09585

Please read the following instructions and warnings carefully  
**KEEP THIS INSTRUCTION MANUAL FOR FUTURE REFERENCE.**

Product comes fully assembled, and folded flat for compact storage.

Fabric cover is machine washable.

For technical support, contact us at 1-800-268-6237

or [www.summerinfant.com/contact](http://www.summerinfant.com/contact)

For use with children from birth until sitting up unassisted.

  
summer  
infant®

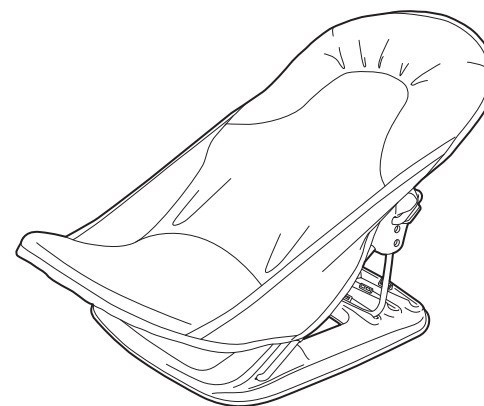

## Deluxe Baby Bather

### INSTRUCTION MANUAL

Thank you for buying the Deluxe Baby Bather from Summer Infant. The baby bather cradles newborns making bath time more calm and relaxed. Soft mesh fabric and a solid base give newborns extra support.

### ⚠ WARNING: IMPORTANT! KEEP FOR FUTURE REFERENCE!

#### ⚠ WARNING: DROWNING HAZARD

- Children have **DROWNED** when left unattended. **ALWAYS** keep child within adult's reach.
- **NEVER** lift or carry bather with child in it.
- **NEVER** bathe baby until you have tested the water temperature. **ALWAYS** check water temperature before placing child into tub.
- Bath water should be between 90°F and 100°F (32.2°C and 37.8°C).
- When using bather inside a sink or adult bath tub, **NEVER** allow water to collect in adult bath tub or sink. **ALWAYS** keep the drain open in the adult bath tub or sink.
- Infants can drown in as little as 1" (2.5 cm) of water. **ALWAYS** bathe your infant using as little water as necessary.
- Infants can drown even when other children are present near the bather. **NEVER** allow other children to substitute for adult supervision.
- This product is not a toy. **DO NOT** allow children to play with it.
- Suitable for babies from birth until they can sit up unassisted.

#### FALL HAZARD: Prevent serious injury from falling.

- Product can collapse if lifted or carried with your child in it. Your child can fall out and suffer a serious head injury.
- **NEVER** lift or carry bather with child in it.
- **DO NOT** use bather if child can sit up unassisted.
- **NEVER** change backrest position with child in bather.
- **NEVER** use bather on uneven or elevated surfaces.
- **NEVER** leave children unattended.
- Discontinue use of product if damaged, broken, or disassembled.

## bather set up:

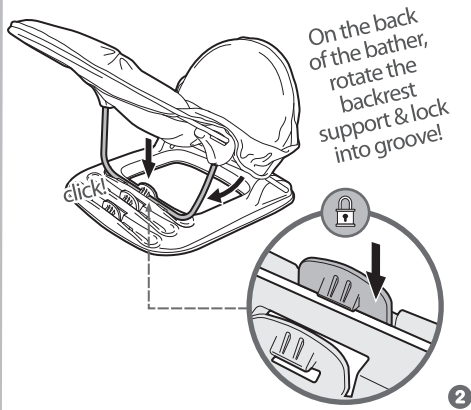
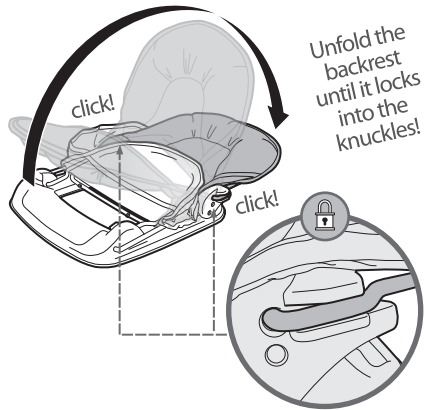

Rotate footrest down until it locks into place!

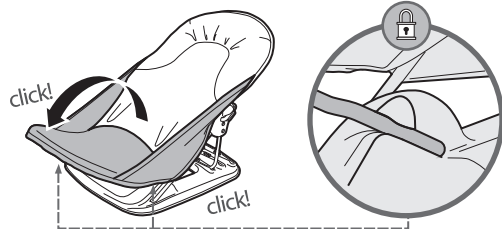

FINISHED!

## reclining the backrest:

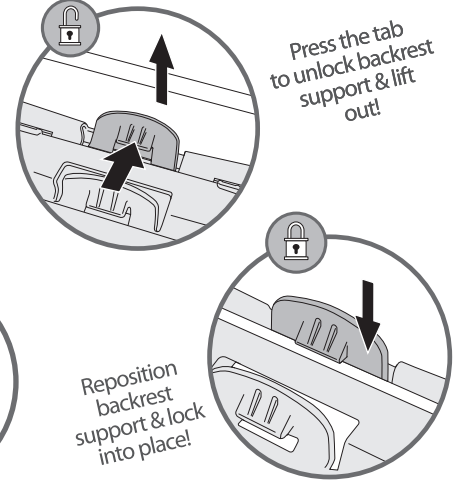
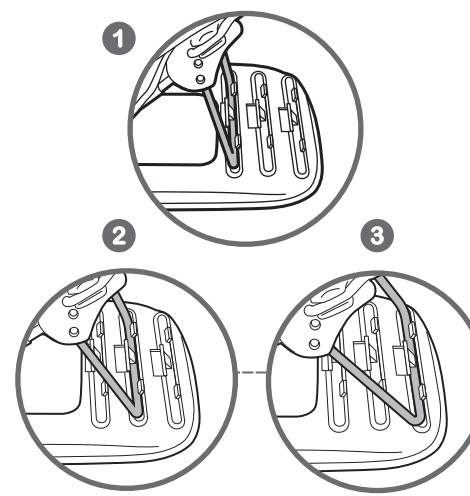

## removing the fabric:

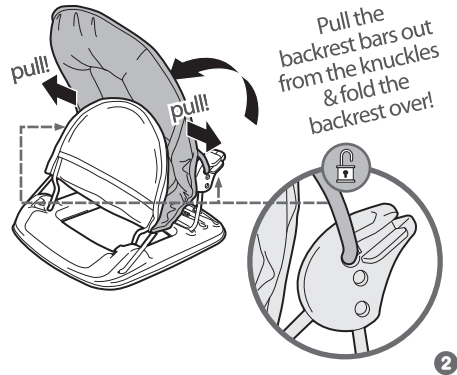
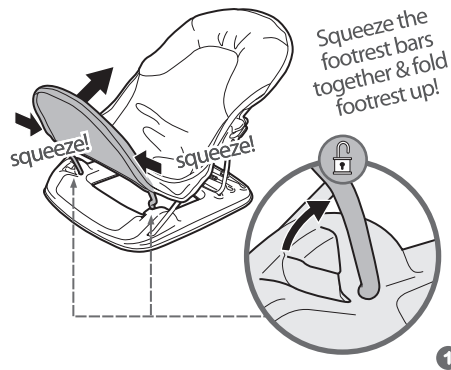
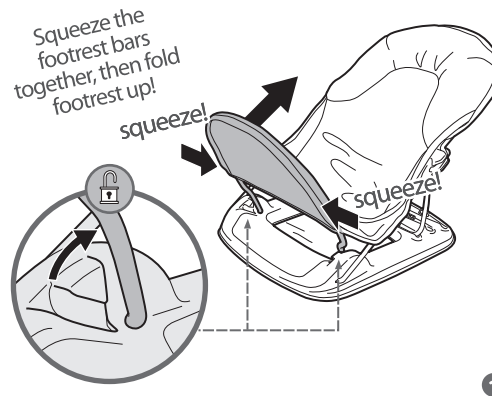

Unlock backrest support & rotate under!



Fold bather down!

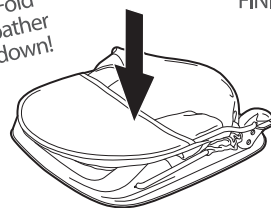

FINISHED!

