

Air Purifier

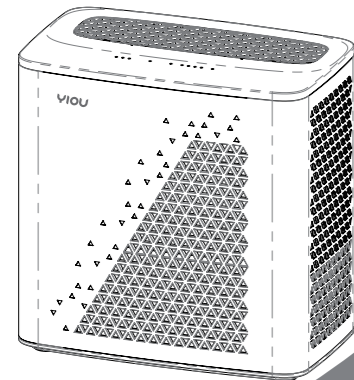

User Manual

Please read this manual carefully to ensure safe use and keep it on hand for future reference.

EN Safety Precautions

Please follow the precautions below. Failure to do so may result in personal injury or damage to the product. Improper use will invalidate the warranty.

- Untangle the power cord before use.
- Do not let children operate the device unsupervised.
- Do not use the air purifier if the power cord is damaged. Contact a qualified service center for repairs.
- Do not yank the power cord or use it to pull the air purifier.
- Do not use the device in a damp or dusty environment.
- Do not place the device close to heat sources, furniture, curtains, aerosols, etc. This may cause a fire hazard.
- This product is for indoor, domestic use only.
- Do not cover the air inlet or outlet.
- Do not touch the device with wet hands.
- Do not let moisture into the interior of the device.
- Do not place anything on top of the device.
- Do not insert foreign objects into the device.
- Only place the device on a sturdy, level surface.
- Do not tilt the device.
- Unplug the device before cleaning and assembly.
- Unplug the device if it will not be used for a long period of time.

Product Illustration

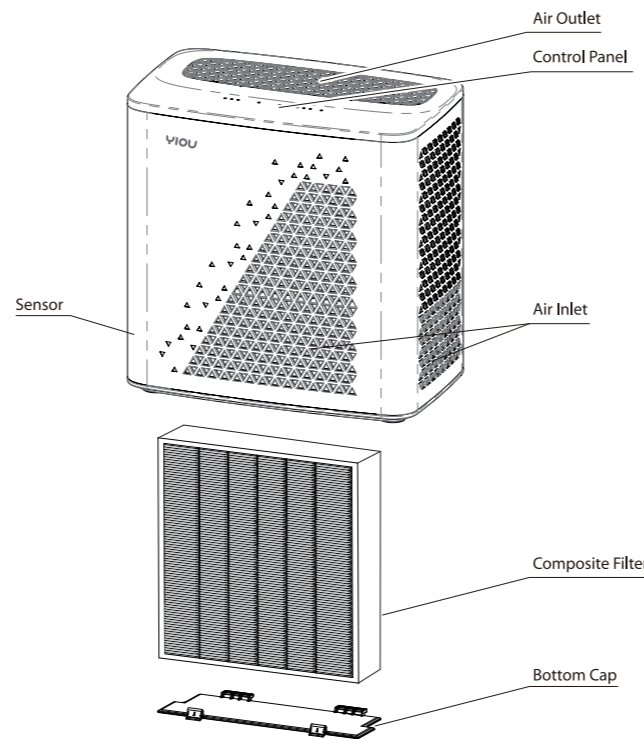

Instructions before use

Make sure to remove the filter packing bag before first use.

Please check the following details before using:

- The labeled voltage of the device is consistent with your local regulations.
- As a Class II appliance (with double insulation), this device can connect to a non-grounded electrical outlet.
- The air inlet and outlet are completely clear.
- The filter and bottom cap are correctly assembled (shown as below).
- If the bottom cap hasn't been correctly assembled, the air purifier won't work normally.
- See figures 1-6 below on how to remove the filter packing and replace the filter when necessary.

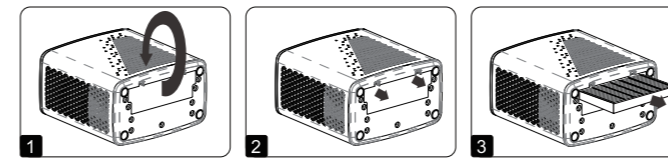

1 Turn the air purifier over and you will find the filter assembly mounted on the bottom.

2 Press the two switches on the mounting board simultaneously and pull it outward to remove the board.

3 Remove the filter assembly.

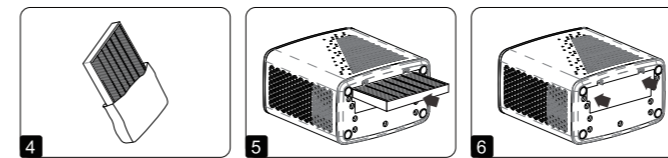

4 Remove all the packing bags of the composite filter

5 Mount the new composite filter into the air purifier.
Note: The blue/green/purple side of the filter should face the front shell.

6 Replace the bottom cap to finish.

Instructions for use

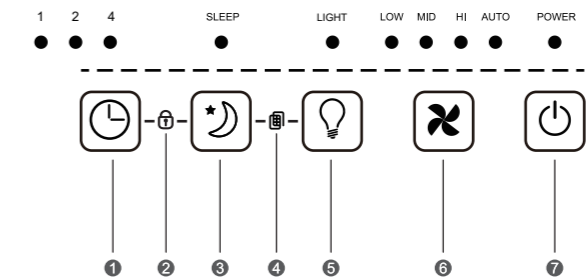

Control buttons		
1 TIMER	4 Filter Reset	7 ON/OFF
2 Child Lock	5 LAMP	
3 SLEEP	6 SPEED	

ON/OFF button

The device will beep once when connects to power. The purifier will enter standby mode and all indicators will be off.

- Press the ON/OFF button when in standby mode, then the on/off indicator, lamp indicator, and auto indicator will glow steady white. The air purifier will automatically enter Auto mode.
- Press the ON/OFF button while the unit is turned on to enter standby mode, and all the indicators will turn off.

Auto Mode

The device will enter Auto mode after you press the ON/OFF button or press the Speed button when in manual mode. The auto indicator will light up, and the device will automatically adjust its fan speed based on real-time air quality.

The PM2.5 value can reflect the level of air quality.

PM2.5	0-50	51-100	≧ 101
Air Quality	Excellent	Good	Poor
Air Quality Indicator	Green	Yellow	Red

If the air quality is **excellent**, the purifier will work in **Low Speed** mode.

If the air quality is **good**, the purifier will work in **Mid Speed** mode.

If the air quality is **poor**, the purifier will work in **High Speed** mode.

In Auto mode, press the Speed button to enter manual mode.

Speed button

While the unit is turned on, press the Speed button to switch between Low, Mid, High, and auto mode in a loop. The corresponding indicator will light up, and other indicators will turn off.

Lamp button

The indicator of Lamp button will glow white constantly while on. When you press the Lamp button, all the lights (including the air quality indicator and all indicators) will turn off except the half-lit Lamp indicator. At this time, you can still set other functions of the device and the corresponding indicators will light up for 3 seconds and then all turn off. Press the Lamp button again to go back to the normal mode.

Sleep button

While the unit is turned on, press the Sleep button to enter sleep mode. Then the fan will work in Low speed, the on/off indicator and sleep indicator will be half-lit, and the other indicators will turn off. In sleep mode, the device won't buzz even if you set a timer or child lock.

You can press any button (except child lock or timer) to exit sleep mode (the purifier will return to running at the default low speed.). Pressing the ON/OFF button will turn the device off completely.

