

Automatic Fish Feeder  
User Manual  
Model: FS-069(AL)

## FS-069(with AA Battery)

Manual button

Automatic button

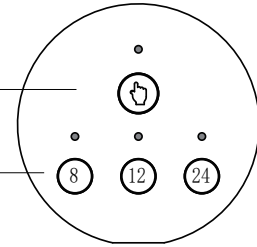

### Two feeding modes:

**Manual feeding:** Press the "⏸" and the feed bin turns around once. Complete a feeding. (It is recommended to use this mode to check whether the amount of feed is enough for a single feeding).

**Automatic feeding:** Three feeding cycles are available (8h, 12h, or 24h). For example, if you press the button "8", the feed bin will immediately turn around once for feeding. From the moment you press it, the feed bin will automatically feed again after every 8 hours. The same applies to other cycles.

## FS-069AL (with Rechargeable Battery)

Manual button  
(Switch)

Automatic button

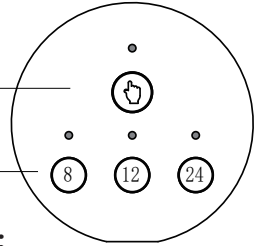

### Two feeding modes:

Long press the button "⏸" for 3 seconds to turn on or off the feeder.

**Manual feeding:** Press the "⏸" and the feed bin turns around once. Complete a feeding. (It is recommended to use this mode to check whether the amount of feed is enough for a single feeding).

**Automatic feeding:** Three feeding cycles are available (8h, 12h, or 24h). For example, if you press the button "8", the feed bin will immediately turn around once for feeding. From the moment you press it, the feed bin will automatically feed again after every 8 hours. The same applies to other cycles.

## What is the difference between FS-069 and FS-069AL?

### Power supply and charging mode:

The FS-069 is powered by two AA batteries, which are not rechargeable. Generally lasts 3-6 months. The batteries need to be replaced with new ones each time the power is depleted.

The FS-069AL is powered by internal lithium battery, which can be recharged repeatedly. Generally lasts 3-6 months. Requires recharging using USB Type-C each time the power is depleted.

## Product features:

1. **【Upgraded Feed Box】** Adopting upward opening baffle design, it is convenient and quick to add feed.
2. **【Settable Feeding Time】** This automatic fish feeder can set 3 feeding cycles. Each feeding 1 circle, to meet various feeding needs.
3. **【Two installation methods】** It is designed with a rotatable base, which can be fixed on the aquarium wall. And with stickers, it can be fixed on the fish tank lid.
4. **【Easy Adjustment of Feeding Amount】** You can control the amount of feed dispensed by easily adjusting the slider at the outlet of the fish feeder automatic dispenser.
5. **【Multiple Applications】** This fish food automatic dispenser is suitable for a wide range of fish food, such as flake feed, pellet feed, powder feed and stick feed.
6. **【Rechargeable internal lithium battery】** FS-069AL can charge with USB Type-C. Can be used for up to 3-6 months.

## Attention

**POWER SUPPLY REQUIREMENTS:** Before using the Automatic Fish Feeder, make sure you understand and follow the correct power supply requirements. Using the wrong power source may result in equipment damage or safety hazards.

**INSTALLATION LOCATION:** Choose a solid location away from a water source to install the Automatic Fish Feeder. Make sure it is installed above the fish tank to avoid equipment failure due to water splashing.

**Appropriate Fish Food:** Use suitable fish food to fill the feeder. Avoid using wet, spoiled or oversized fish food, which may cause clogging of the device.

**REGULAR CLEANING:** Regular cleaning of the automatic fish feeder is an important step to ensure its proper operation. Follow the cleaning guidelines in the instruction manual and avoid using chemical cleaners.

**Feeding Program Setup:** Set up an appropriate feeding program based on your fish's needs and specific feeding requirements. Make sure you follow the principle of feeding in moderation and avoid over or under feeding.

**TESTING AND ADJUSTMENT:** Test and adjust the feeder before official use. Make sure it works properly and adapts to your aquarium environment.

**SAFETY PRECAUTIONS:** make sure the automatic fish feeder is installed out of reach of children or pets and avoid putting fingers or other objects into the unit to prevent accidental injury.

# How To Use?

## FS-069(with AA Battery)

1. Open the battery cover
2. Install two AA batteries  
(Note the correct positive and negative poles)
3. Open the sliding cover
4. Pour in fish food
5. Adjusting the outlet

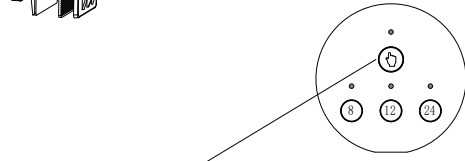

**! Important!** Both the food type and the size of the slide cover will affect the amount fed. It is necessary to press the manual feed button “” first to test if the amount fed is correct.

### Stick to the aquarium lid:

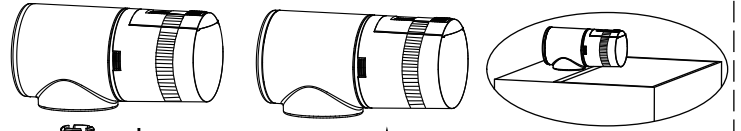

1. Remove the base
2. Apply adhesive stickers
3. Fixed on the aquarium lid

### Clamp to the aquarium wall:

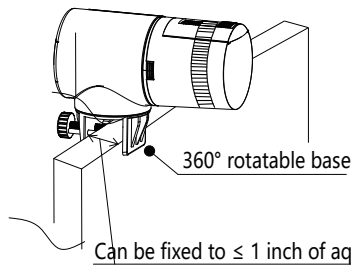

## FS-069AL (with Rechargeable Battery)

1. Plug in Type-C
  2. Plug in the power adapter
  3. Plug in socket
- NOTE:** Power adapter not included

4. Push the sliding cover open
5. Pour in fish feed
6. Adjust the Feeding Slider

7. Long press the button “” for 3 seconds to turn on the feeder.

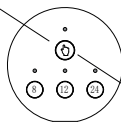

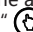
**! Important!** Both the food type and the size of the slide cover will affect the amount fed. It is necessary to press the manual feed button “” first to test if the amount fed is correct.

### Fixed to the aquarium lid:

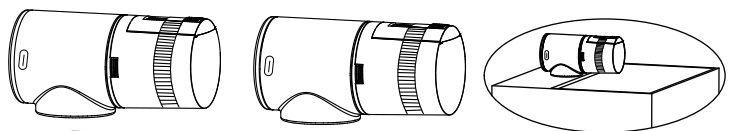

1. Remove the base
2. Apply adhesive stickers
3. Fixed on the aquarium lid

### Fixed to the aquarium wall:

