

User Manual of Product 1:

INTEX 67767ED Dura-Beam Deluxe Comfort-Plush Mid-Rise Air Mattress: Fiber-Tech – Full Size – Built-in Electric Pump – 13in Bed Height – 600lb Weight Capacity, Grey

User Manual of Product 2:

INTEX 64121EP Dura-Beam Plus Pillow Rest Air Mattress: Fiber-Tech – Twin Size – Built-in Electric Pump – 16.5in Bed Height – 300lb Weight Capacity, Navy

INTEX® OWNER'S MANUAL

Quickfill® Plus Internal Pump

Model AP619D 110 – 120 V~ 60 Hz 0.65 A

19PO

IMPORTANT SAFETY INSTRUCTIONS
READ AND FOLLOW ALL INSTRUCTIONS BEFORE USING THIS PRODUCT



DANGER

- To reduce the risk of electric shock: Always unplug this furnishing from the electrical outlet before cleaning.



WARNING

To reduce the risk of burns, fire, electric shock, or injury to persons:

- Infants have suffocated on inflatable mattresses. Never place infant aged birth to 15 months to sleep on this inflatable air mattress / air bed. Infants can suffocate on an underinflated or deflated mattress, on bedding, by co-sleeping with another person, and by entrapment between the mattress and bed frame or between the mattress and a vertical surface.
- Children can be entrapped between the inflatable mattress and an adjacent vertical surface. Provide at least a shoulder width space between the inflatable mattress/airbed and adjacent vertical surfaces such as walls, dressers or other objects.
- Always keep the inflatable mattress fully inflated when in use.
- Never introduce any flammable substance into the inflatable airbed, SUCH AS AEROSOL TIRE REPAIR PRODUCTS, as it may ignite or explode.
- For indoor household use only.
- Unplug from outlet before putting on or taking off parts.
- Close supervision is necessary when this furnishing is used by, or near children, invalids, or disable persons.
- Use this furnishing only for its intended use as described in these instructions. Do not use attachments not recommended by the manufacturer.
- Do not operate where aerosol (spray) products are being used or where oxygen is being administered.
- This is not a toy. Children must not be left unattended when using the airbed.
- Keep the storage bag away from babies and children. The storage bag is not a toy. When not in use, fold the bag and put it away out of the reach of children.
- Do not walk, stand on or jump on or use the airbed as a trampoline.
- Do not use on or near water. This is not a raft.
- Do not set up bed near stairs, doors, sharp edges or breakable objects. Provide adequate space between bed and objects to avoid entrapment.
- Make sure the area is flat, smooth, free of sharp objects that could puncture the bed and keep away from ledges.
- Keep pets away from the airbed. Pets may puncture the surface of the bed.
- Avoid sleeping on the edge of the airbed. Edges produce less support than the middle of the bed.
- Do not operate air pump for more than 5 minutes at a time. Let pump cool at least 15 minutes between use.
- Unplug electrical power cord when not in use. To disconnect, turn all controls to the off position, then remove plug from outlet.
- Never operate the furnishing with the air openings blocked. Keep the air openings free of lint, hair, and the like. Never drop or insert object into any opening.
- Never operate this furnishing if it has a damaged cord or plug, if it is not working properly, if it has been dropped or damaged, or dropped into water. Return the furnishing to a service center for examination and/or repair.
- If the AC supply cord is damaged, it must be replaced by the manufacturer or its service agent in order to avoid a hazard.
- Do not run cord under carpeting. Do not cover cord with throw rugs, runners, or similar coverings. Do not route cord under furniture or appliances. Arrange cord away from traffic area and where it will not be tripped over. Keep the cord away from heated surfaces.

FOLLOW THESE RULES AND ALL INSTRUCTIONS TO AVOID SUFFOCATION, PROPERTY DAMAGE, ELECTRIC SHOCK, BURNS OR OTHER INJURY.



CAUTION

- To reduce the risk of electric shock or injury, use indoors only, do not expose to rain. Store indoors.

READ AND SAVE THESE INSTRUCTIONS

SERVICING OF A DOUBLE-INSULATED PRODUCT:

In a double-insulated product, two systems of insulation are provided instead of grounding. No grounding means is provided on a double-insulated product, nor should a means for grounding be added to the product. Servicing of a double-insulated product requires extreme care and knowledge of the system, and should be done only by qualified service personnel. Replacement parts for a double-insulated product must be identical to those parts in the product. A double-insulated product is marked with the words "DOUBLE INSULATION" or "DOUBLE INSULATED" and with the symbol .

OPERATING INSTRUCTIONS**General**

- This appliance has a polarized plug (one blade is wider than the other). This plug will fit in a polarized outlet only one way. If the plug does not fit fully in the outlet, reverse the plug. If it still does not fit, contact a qualified electrician to install the proper outlet. Do not change the plug in any way.
- Airbeds are designed for temporary use and are NOT designed to be a replacement for a traditional mattress.
- Make sure the area is flat, level, clean and free from sharp objects, and within reach of an electrical outlet.
- To prevent puncture or damage to the airbed, never drag the airbed across the floor. Lift the inflated airbed when moving or changing location.

Maintenance instructions:

- No air pump maintenance is required. Pump is removable.
- For cleaning use only clean cloth with mild soapy solution. Do not use any chemicals.
- In case of repairs, use only common PVC repair glue and patches. For flocked surfaces: rub away the flocking material with an eraser first before applying the glue and/or patch.

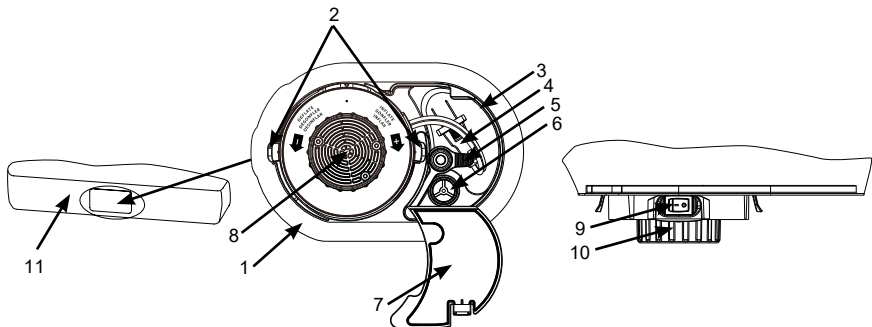
PARTS REFERENCE**Part Descriptions:**

- | | | |
|----------------------|------------------------------|------------------------|
| 1. Pump holder frame | 4. AC line cord | 8. Air passage |
| 2. Pump removal tab | 5. Manual inflation port cap | 9. Power switch |
| 3. Cord compartment | 6. Manual inflation port | 10. Valve control dial |
| | 7. Cord compartment cover | 11. Airbed |

NOTE: Drawings for illustration purpose only. May not reflect actual product. Not to scale. Due to a policy of continuous product improvement, Intex reserves the right to change specifications and appearance, which may result in updates to the instruction manual, without notice.

READ AND SAVE THESE INSTRUCTIONS

INFLATION

1. Open line cord compartment cover and remove line cord. Do not yank on the cord. See Fig (1).
2. Plug in the AC line cord into an AC electrical outlet. See Fig (2).

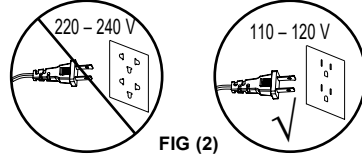
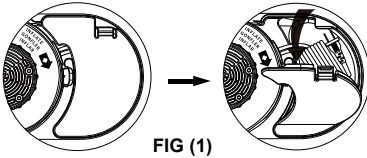

3. Switch ON the pump by pressing "I" on the switch located on top of pump. See Fig (3).
4. Turn valve control dial fully clockwise until it stops. The airbed is now inflating. See Fig (4).

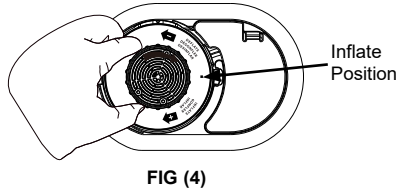
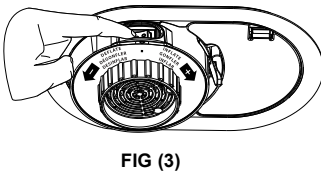

5. When the airbed is fully inflated, turn the valve control dial back (counterclockwise) to the center position closing the inflation valve. Then turn off the pump by pressing "O" on the switch. See Fig (5).

NOTE: Turning the valve control dial from the center/closed position will open the valve inside the pump and allow air to escape, even if pump is not running. Operate the valve control dial when inflating or deflating the airbed, or for firmness adjustment (see step #6).

Never disconnect the power line cord from the electrical outlet while the pump is operating. Switch off the pump first before disconnecting the power line cord.

Rotate Back to Close Valve

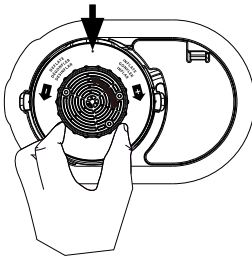
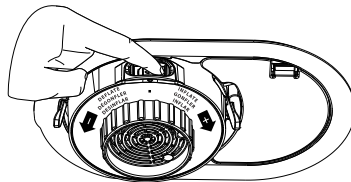

FIG (5)



6. If the airbed feels too firm, release some air by simply turning the valve control dial gradually in either direction to allow air to escape until desired firmness is achieved, then turn the valve control dial back to the center/closed position. If the bed feels too soft, repeat steps #3 to #6 as necessary.

READ AND SAVE THESE INSTRUCTIONS

IMPORTANT NOTE

Proper inflation of the airbed.

The ambient temperatures of air have an effect on the airbed internal pressure. At low ambient temperature the air will contract within the airbed and the airbed will feel softer: add air as necessary. At high ambient temperature the air within the airbed will expand significantly and the airbed will become hard and may burst: release air to avoid damage to the airbed or to soften the feel. **Do not** expose the airbed to extreme temperatures (hot or cold).

Stretching is a natural characteristic of new vinyl. During initial use, the airbed may become soft and require additional inflation to maintain desired firmness. This is normal for the first few days of use.

Dimensions shown are approximate and will vary due to the vinyl temperature and the air temperature.

In no event shall Intex, their authorized agents or employees be liable for damages (such as pin holes) to the airbed caused by negligence, ordinary wear and tear, abuse and carelessness, or external forces.

DEFLATION

1. Plug in the AC line cord into an AC electrical outlet. See Fig (2).
2. Switch ON the pump by pressing "I" on the switch located on top of pump. See Fig (3).
3. Turn valve control dial fully counterclockwise until it stops. The airbed is now deflating. See Fig (6).

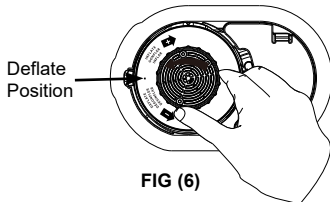

FIG (6)



FIG (7)

4. When all the air is removed from the airbed, turn the valve control dial back (clockwise) to the center position closing the valve. Then turn off the pump by pressing "O" on the switch. See Fig (5).
5. With the airbed fully deflated begin rolling the airbed from the end opposite of the pump towards the end where the pump is located. See Fig (7).
6. Disconnect the AC line cord from the electrical outlet, coil the line cord and place it inside the cord compartment, then close the cover. Make sure the line cord is free of twists, kinks or knots.

MANUAL INFLATION OPTION

If electrical power is not available, a conventional foot, manual, or battery-operated air pump can be used by connecting it to the manual inflation port located inside the line cord compartment. See Fig (8). Follow these steps:

READ AND SAVE THESE INSTRUCTIONS

19PO

1. Open line cord compartment cover and locate the manual inflation port.
2. Make sure the valve control dial of the internal electric pump is still in the center/*closed* position.
3. Remove the cap from the manual inflation port and insert the nozzle of the pump into the port. Inflate the airbed to desired firmness.

NOTE: Do not overinflate. The firmness should be approximately the same as the level achieved with the internal electric pump.

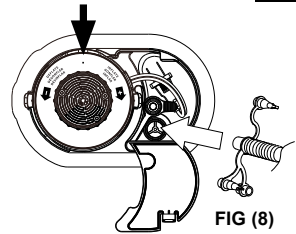

4. Remove nozzle from manual inflation port and close the cap and the line cord cover.

STORAGE INSTRUCTIONS

1. Deflate the airbed following the "DEFLATION" instructions.
2. Make sure the airbed is clean and dry.
3. Lay the airbed flat with the sleeping surface facing upwards and follow the folding steps on Figs (9 - 13). Fold the airbed loosely and avoid sharp bends, corners and creases which can damage the airbed.

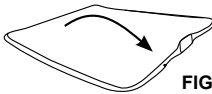

FIG (9)

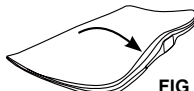

FIG (10)

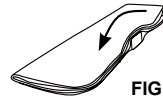

FIG (11)

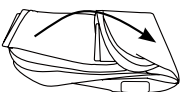

FIG (12)

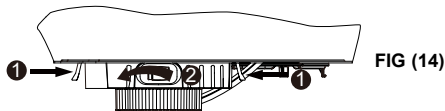

FIG (13)

REPLACING INTERNAL AIR PUMP OR THE AIRBED COMPONENT

If there is a need to replace either the internal air pump or the airbed portion, detach the internal pump from the airbed as follows:

1. While holding both lock tabs pressed inward (see Figure 14), turn the round body of the pump (the large outer rim, not the valve control dial) counterclockwise and pull the air pump body out of the holder frame.



2. Depending on which part is being replaced, keep the remaining component (either the airbed portion or the removed pump) in a safe place until the replacement part is received. Reattach the components when the new part is received: simply place the pump into the holder frame and turn clockwise until the lock tabs click into place.

NOTE: Make sure the rubber seal on the pump housing as well as the inside wall of the holder frame are clean and free from any lint, hair or dirt, to ensure a proper seal and avoid air leaks.

NOTE: Do not remove internal air pump from the holder frame other than for servicing, as this may introduce lint, hair or dirt into the seal area and cause air leaks. If air leak is experienced, check that the seal is clean before replacing the pump or the airbed.

READ AND SAVE THESE INSTRUCTIONS

TROUBLESHOOTING GUIDE

19PO

PROBLEM	CAUSE	SOLUTION
Air leakage between internal air pump and the pump holder frame	<ul style="list-style-type: none"> • Pump not securely attached. • Pump O-ring is dirty. • Internal airbed beam threads are caught between the internal air pump and the pump holder frame. • Pump O-ring is twisted and/or damaged. 	<ul style="list-style-type: none"> • While holding the pump outer rim, push in and turn the pump fully clockwise until the two side tabs lock into place. • Remove the pump from the airbed, remove the O-ring from the pump and clean it with water. Carefully replace the O-ring back to the pump as to prevent dust, lint from sticking onto the O-ring again. Also make sure the pump holder frame inner wall is free from dust, hair or lint. • Remove the internal air pump and carefully replace the pump back making sure the internal airbed beam threads are away from the pump holder frame. • Remove the pump from the airbed, make sure the O-ring is not damaged and/or twisted. Realign the O-ring or replace a new O-ring. Contact Intex service center for replacement.
Air pump does not work	<ul style="list-style-type: none"> • Not connected to an electrical outlet socket. • Pump motor thermo-protector activated. • Internal air pump defective. 	<ul style="list-style-type: none"> • Make sure the pump is plugged into the correct power outlet, then switch on the pump and turn the valve control dial fully clockwise to the inflation position. • Switch off and disconnect the line cord from the power outlet, let the pump rest for more than 30 minutes before resume the use of the pump. • Remove the internal air pump from the airbed and keep the airbed in a safe place. Contact Intex service center for an internal air pump replacement.
Pump motor is running but airbed is not inflating or deflating	<ul style="list-style-type: none"> • The inflation or deflation mode is not set yet. 	<ul style="list-style-type: none"> • Press "I" to switch on the pump and make sure there is air flowing. Then turn the valve control dial fully clockwise until it stops to inflate the airbed. Or turn the valve control dial fully counterclockwise until it stops to deflate the airbed.
After inflation air is escaping through the pump air passage or through the manual inflation port	<ul style="list-style-type: none"> • The pump air passage is not completely closed. • The manual inflation port cap is not securely closed. 	<ul style="list-style-type: none"> • Make sure the air passage is closed by turning the valve control dial to the center position. • Push the cap firmly into the manual inflation port.

©2020 Intex Marketing Ltd. - Intex Development Co. Ltd. - Intex Recreation Corp. All rights reserved/Tous droits réservés/Todos los derechos reservados/Alle Rechte vorbehalten. Printed in China/Imprimé en Chine/Impreso en China/Gedruckt in China.

®™ Trademarks used in some countries of the world under license from®™ Marques utilisées dans certains pays sous licence de/Marcas registradas utilizadas en algunos países del mundo bajo licencia de/Warenzeichen verwendet in einigen Ländern der Welt in Lizenz von/Intex Marketing Ltd. to/à/a/an Intex Development Co. Ltd., G.P.O Box 28829, Hong Kong & Intex Recreation Corp., P.O. Box 1440, Long Beach, CA 90801 • Distributed in the European Union by/Distribué dans l'Union Européenne par/Distribuido en la unión Europea por/Vertrieb in der Europäischen Union durch/Intex Trading B.V., Venneveld 9, 4705 RR Roosendaal - The Netherlands Consumer Service 1-800-234-6839

INTEX®

www.intexcorp.com

READ AND SAVE THESE INSTRUCTIONS

INTEX® OWNER'S MANUAL**17PO**

Quickfill® Plus Internal Pump
Model AP619D 110V – 120V~ 60Hz 0.65A
Model AP619DP 110V – 120V~ 60Hz 0.85A

IMPORTANT SAFETY INSTRUCTIONS**READ AND FOLLOW ALL INSTRUCTIONS BEFORE USING THIS PRODUCT****⚠ DANGER**

- To reduce the risk of electric shock: Always unplug this furnishing from the electrical outlet before cleaning.

⚠ WARNING

To reduce the risk of burns, fire, electric shock, or injury to persons:

- Infants have suffocated on inflatable mattresses. Never place infant aged birth to 15 months to sleep on this inflatable air mattress / air bed. Infants can suffocate on an underinflated or deflated mattress, on bedding, by co-sleeping with another person, and by entrapment between the mattress and bed frame or between the mattress and a vertical surface.
- Children can be entrapped between the inflatable mattress and an adjacent vertical surface. Provide at least a shoulder width space between the inflatable mattress / airbed and adjacent vertical surfaces such as walls, dressers or other objects.
- Always keep the inflatable mattress fully inflated when in use.
- Never introduce any flammable substance into the inflatable airbed, SUCH AS AEROSOL TIRE REPAIR PRODUCTS, as it may ignite or explode.
- For indoor household use only.
- Unplug from outlet before putting on or taking off parts.
- Close supervision is necessary when this furnishing is used by, or near children, invalids, or disable persons.
- Use this furnishing only for its intended use as described in these instructions. Do not use attachments not recommended by the manufacturer.
- Do not operate where aerosol (spray) products are being used or where oxygen is being administered.
- This is not a toy. Children must not be left unattended when using the airbed.
- If a storage bag is included, keep the storage bag away from babies and children. The storage bag is not a toy. When not in use, fold the bag and put it away out of the reach of children.
- Do not walk, stand on or jump on or use the airbed as a trampoline.
- Do not use on or near water. This is not a raft.
- Do not set up bed near stairs, doors, sharp edges or breakable objects. Provide adequate space between bed and objects to avoid entrapment.
- Make sure the area is flat, smooth, free of sharp objects that could puncture the bed and keep away from ledges.
- Keep pets away from the airbed. Pets may puncture the surface of the bed.
- Avoid sleeping on the edge of the airbed. Edges produce less support than the middle of the bed.
- Do not operate air pump for more than 5 minutes at a time. Let pump cool at least 15 minutes between use.
- Unplug electrical power cord when not in use. To disconnect, turn all controls to the off position, then remove plug from outlet.
- Never operate the furnishing with the air openings blocked. Keep the air openings free of lint, hair, and the like. Never drop or insert object into any opening.
- Never operate this furnishing if it has a damaged cord or plug, if it is not working properly, if it has been dropped or damaged, or dropped into water. Return the furnishing to a service center for examination and / or repair.
- If the AC supply cord is damaged, it must be replaced by the manufacturer or its service agent in order to avoid a hazard.
- Do not run cord under carpeting. Do not cover cord with throw rugs, runners, or similar coverings. Do not route cord under furniture or appliances. Arrange cord away from traffic area and where it will not be tripped over. Keep the cord away from heated surfaces.

FOLLOW THESE RULES AND ALL INSTRUCTIONS TO AVOID SUFFOCATION, PROPERTY DAMAGE, ELECTRIC SHOCK, BURNS OR OTHER INJURY.

⚠ CAUTION

- To reduce the risk of electric shock or injury, use indoors only, do not expose to rain. Store indoors.

READ AND SAVE THESE INSTRUCTIONS

SERVICING OF A DOUBLE-INSULATED PRODUCT:

In a double-insulated product, two systems of insulation are provided instead of grounding. No grounding means is provided on a double-insulated product, nor should a means for grounding be added to the product. Servicing of a double-insulated product requires extreme care and knowledge of the system, and should be done only by qualified service personnel. Replacement parts for a double-insulated product must be identical to those parts in the product. A double-insulated product is marked with the words "DOUBLE INSULATION" or "DOUBLE INSULATED" and with the symbol .

OPERATING INSTRUCTIONS**General**

- This appliance has a polarized plug (one blade is wider than the other). This plug will fit in a polarized outlet only one way. If the plug does not fit fully in the outlet, reverse the plug. If it still does not fit, contact a qualified electrician to install the proper outlet. Do not change the plug in any way.
- Airbeds are designed for temporary use and are NOT designed to be a replacement for a traditional mattress.
- Make sure the area is flat, level, clean and free from sharp objects, and within reach of an electrical outlet.
- To prevent puncture or damage to the airbed, never drag the airbed across the floor. Lift the inflated airbed when moving or changing location.

Maintenance instructions:

- No air pump maintenance is required. Pump is removable.
- For cleaning use only clean cloth with mild soapy solution. Do not use any chemicals.
- In case of repairs, use only common PVC repair glue and patches. For flocked surfaces: rub away the flocking material with an eraser first before applying the glue and/or patch.

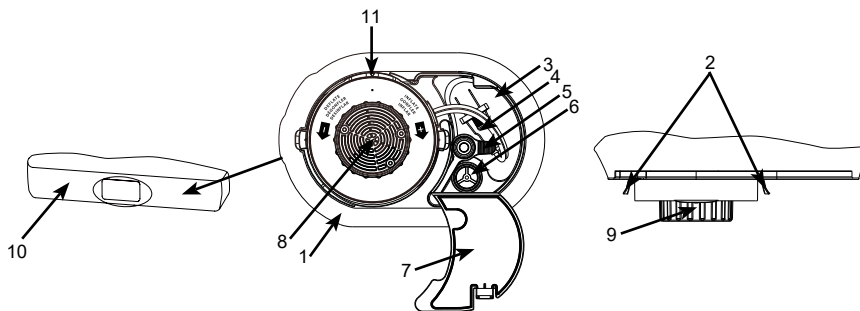
PARTS REFERENCE**Part Descriptions:**

- | | | |
|----------------------|------------------------------|--------------------------------|
| 1. Pump holder frame | 4. AC power cord | 8. Air passage |
| 2. Pump removal tab | 5. Manual inflation port cap | 9. Control dial |
| 3. Cord compartment | 6. Manual inflation port | 10. Airbed front |
| | 7. Cord compartment cover | 11. Closed / Pump Off Position |

NOTE: Drawings for illustration purpose only. May not reflect actual product. Not to scale. Due to a policy of continuous product improvement, Intex reserves the right to change specifications and appearance, which may result in updates to the instruction manual, without notice.

READ AND SAVE THESE INSTRUCTIONS

INFLATION

1. Open cord compartment cover and remove power cord. Do not yank on the cord. See Fig (1).
2. Plug in the AC power cord into an AC electrical outlet. See Fig (2).

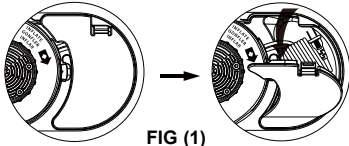

FIG (1)

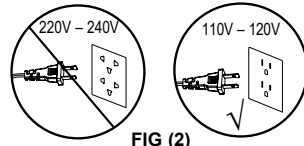

FIG (2)

3. Turn the control dial fully clockwise until it stops. The pump turns on automatically to inflate the airbed. See Fig (3).

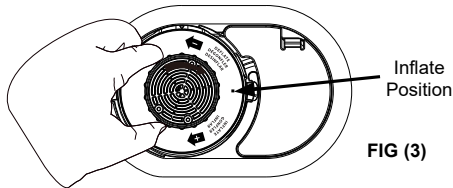

FIG (3)

4. When the airbed is fully inflated, turn the control dial back (counterclockwise) to the center position which closes the valve and turns the pump off. See Fig (4).

NOTE: Turning the control dial either direction while the pump is unplugged will let air escape from the airbed. See step #5 for firmness adjustment instructions.

Never disconnect the power cord from the electrical outlet while the pump is running. Rotate control dial to the closed / pump off position before disconnecting the power cord.

Rotate to Closed / Pump Off Position

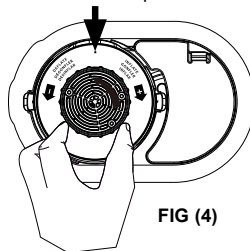

FIG (4)

5. If the airbed feels too firm, release some air by simply turning the control dial gradually counterclockwise until air begins to escape from the air passage. When the desired firmness is achieved, turn the control dial back to the center closed / pump off position. If the airbed feels too soft, repeat steps #3 to #5 as necessary.

READ AND SAVE THESE INSTRUCTIONS

IMPORTANT NOTE

Proper inflation of the airbed.

The ambient temperatures of air have an effect on the airbed internal pressure. At low ambient temperature the air will contract within the airbed and the airbed will feel softer: add air as necessary. At high ambient temperature the air within the airbed will expand significantly and the airbed will become hard and may burst: release air to avoid damage to the airbed or to soften the feel. **Do not** expose the airbed to extreme temperatures (hot or cold).

Stretching is a natural characteristic of new vinyl. During initial use, the airbed may become soft and require additional inflation to maintain desired firmness. This is normal for the first few days of use.

Dimensions shown are approximate and will vary due to the vinyl temperature and the air temperature.

In no event shall Intex, their authorized agents or employees be liable for damages (such as pin holes) to the airbed caused by negligence, ordinary wear and tear, abuse and carelessness, or external forces.

DEFLATION

1. Plug in the AC power cord into an AC electrical outlet. See Fig (2).
2. Turn the control dial fully counterclockwise until it stops. The pump is now deflating the airbed. See Fig (5).

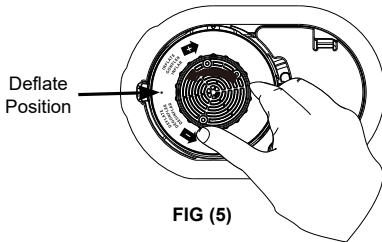

FIG (5)



FIG (6)

3. When all the air is removed from the airbed, turn the control dial back (clockwise) to the center position which closes the valve and turns the pump off.
4. Disconnect the AC power cord from the electrical outlet, coil the power cord and place it inside the cord compartment, then close the cover. Make sure the power cord is free of twists, kinks or knots.
5. With the airbed fully deflated begin rolling the airbed from the end opposite of the pump towards the end where the pump is located. See Fig (6).

MANUAL INFLATION OPTION

If electrical power is not available, a conventional foot, manual, or battery-operated air pump can be used by connecting it to the manual inflation port located inside the power cord compartment. See Fig (7). Follow these steps:

READ AND SAVE THESE INSTRUCTIONS

1. Open cord compartment cover and locate the manual inflation port.
2. Make sure the control dial of the internal electric pump is still in the closed / pump off position.
3. Remove the cap from the manual inflation port and insert the nozzle of the pump into the port. Inflate the airbed to desired firmness.

NOTE: Do not overinflate. The firmness should be approximately the same as the level achieved with the internal electric pump.

4. Remove nozzle from manual inflation port and close the cap and the cord compartment cover.

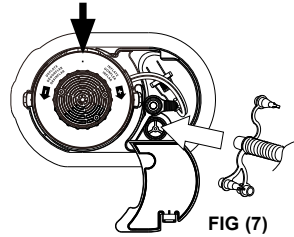

FIG (7)

STORAGE INSTRUCTIONS

1. Deflate the airbed following the "DEFLATION" instructions.
2. Make sure the airbed is clean and dry.
3. Lay the airbed flat with the sleeping surface facing upwards and follow the folding steps on Figs (8 - 12). Fold the airbed loosely and avoid sharp bends, corners and creases which can damage the airbed.



FIG (8)



FIG (9)



FIG (10)

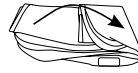

FIG (11)



FIG (12)

REPLACING INTERNAL AIR PUMP OR THE AIRBED COMPONENT

If there is a need to replace either the internal air pump or the airbed portion, detach the internal pump from the airbed as follows:

1. While holding both lock tabs pressed inward (see Figure 13), turn the round body of the pump (the large outer rim, not the control dial) counterclockwise and pull the air pump body out of the holder frame.

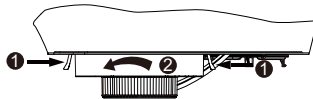

FIG (13)

2. Depending on which part is being replaced, keep the remaining component (either the airbed portion or the removed pump) in a safe place until the replacement part is received. Reattach the components when the new part is received: simply place the pump into the holder frame and turn clockwise until the lock tabs click into place.

NOTE: Make sure the rubber seal on the pump housing as well as the inside wall of the holder frame are clean and free from any lint, hair or dirt, to ensure a proper seal and avoid air leaks.

NOTE: Do not remove internal air pump from the holder frame other than for servicing, as this may introduce lint, hair or dirt into the seal area and cause air leaks. If air leak is experienced, check that the seal is clean before replacing the pump or the airbed.

READ AND SAVE THESE INSTRUCTIONS

TROUBLESHOOTING GUIDE

17PO

PROBLEM	CAUSE	SOLUTION
Air leakage between internal air pump and the pump holder frame	<ul style="list-style-type: none"> • Pump not securely attached. • Pump O-ring is dirty. • Internal airbed beam threads are caught between the internal air pump and the pump holder frame. • Pump O-ring is twisted and/or damaged. 	<ul style="list-style-type: none"> • While holding the pump outer rim, push in and turn the pump fully clockwise until the two side tabs lock into place. • Remove the pump from the airbed, remove the O-ring from the pump and clean it with water. Carefully replace the O-ring back to the pump as to prevent dust, lint from sticking onto the O-ring again. Also make sure the pump holder frame inner wall is free from dust, hair or lint. • Remove the internal air pump and carefully replace the pump back making sure the internal airbed beam threads are away from the pump holder frame. • Remove the pump from the airbed, make sure the O-ring is not damaged and/or twisted. Realign the O-ring or replace a new O-ring. Contact Intex service center for replacement.
Air pump does not work	<ul style="list-style-type: none"> • Not connected to an electrical outlet socket. • Pump motor thermo-protector activated. • Internal air pump defective. 	<ul style="list-style-type: none"> • Make sure the pump is plugged into the correct power outlet, then turn the control dial fully clockwise to the inflation position. • Turn off and disconnect the power cord from the power outlet, let the pump rest for more than 30 minutes before resume the use of the pump. • Remove the internal air pump from the airbed and keep the airbed in a safe place. Contact Intex service center for an internal air pump replacement.
Pump motor is running but airbed is not inflating or deflating	<ul style="list-style-type: none"> • The inflation or deflation mode is not set yet. 	<ul style="list-style-type: none"> • Turn the control dial fully clockwise until it stops to inflate the airbed. Or turn the control dial fully counterclockwise until it stops to deflate the airbed.
After inflation air is escaping through the pump air passage or through the manual inflation port	<ul style="list-style-type: none"> • The pump air passage is not completely closed. • The manual inflation port cap is not securely closed. 	<ul style="list-style-type: none"> • Make sure the air passage is closed by turning the control dial to the center closed / pump off position. • Push the cap firmly into the manual inflation port.

©2021 Intex Marketing Ltd. - Intex Development Co. Ltd. - Intex Recreation Corp. All rights reserved/Tous droits réservés/Todos los derechos reservados/Alle Rechte vorbehalten. Printed in China/Imprimé en Chine/Impreso en China/Gedruckt in China.

®™ Trademarks used in some countries of the world under license from®™ Marques utilisées dans certains pays sous licence de/Marcas registradas utilizadas en algunos países del mundo bajo licencia de/Warenzeichen verwendet in einigen Ländern der Welt in Lizenz von/Intex Marketing Ltd. to/a/a/an Intex Development Co. Ltd., Hong Kong & Intex Recreation Corp., P.O. Box 1440, Long Beach, CA 90801 • Distributed in the European Union by/Distribué dans l'Union Européenne par/Distribuido en la unión Europea por/Vertrieb in der Europäischen Union durch/Intex Trading B.V., Venneveld 9, 4705 RR Roosendaal - The Netherlands
www.intexcorp.com

INTEX®

READ AND SAVE THESE INSTRUCTIONS