

TC310 USB Condenser Mic Kit



FC

CE

RoHS

UK
CA





A. Pop filter

B. Tap-to-mute sensor

C. Gain control knob

D. Shock mount

E. RGB light

F. Light model touch sensor

G. Light level control knob

H. Mic stand

I. TypeC port

J. USB cable



US/GB: Usage Guideline

- ① Tap-to-mute with LED status indicator;
- ② Long press F to turn on/turn off LED light.
- ③ Rotate the top volume knob C to adjust the gain level of the microphone.
- ④ Touch light model button F to adjust light effect.
- ⑤ Rotate the bottom knob G to adjust the brightness of the light.

DE: Nutzungsrichtlinie

- ① Tap-to-Stummschaltung mit LED Statusanzeige.
- ② Lange Drücken Sie F, um LED-Licht ein-/auszuschalten.
- ③ Drehen Sie den oberen Lautstärkeregler C, um die Verstärkung des Mikrofons einzustellen.
- ④ Berühren Sie die Lichtmodelltaste F, um den Lichteffect einzustellen.
- ⑤ Drehen Sie den unteren Knopf G, um die Helligkeit des Lichts einzustellen.

FR: Guide d'utilisation

- ① Le toucher peut être silencieux à l'aide de l'indicateur d'état LED.
- ② appuyez longuement sur F pour allumer / éteindre la lumière LED.
- ③ rotation du bouton de volume supérieur C pour ajuster le niveau de gain du microphone.
- ④ touchez le bouton F du modèle de lumière pour ajuster l'effet de la lumière.
- ⑤ tournez le bouton inférieur G pour ajuster la luminosité de la lampe.

IT: Linee guida sull'uso

- ① Tap-to-mute con indicatore di stato LED.
- ② Long premere F per accendere / spegnere la luce LED.
- ③ Ruotare la manopola del volume superiore C per regolare il livello di guadagno del microfono.
- ④ Toccare il pulsante F del modello di luce per regolare l'effetto di luce.
- ⑤ Ruotare la manopola inferiore G per regolare la luminosità della luce.

ES: Guía de uso

- ① se puede usar el indicador de Estado LED para silenciar con un toque ligero.
- ② presione F durante mucho tiempo para encender / apagar la Luz LED.
- ③ girar la perilla de volumen superior C para ajustar el nivel de ganancia del micrófono.
- ④ toque el botón F del modelo de luz para ajustar el efecto de la luz.
- ⑤ girar la perilla inferior G para ajustar el brillo de la luz.

PL: Wytyczne dotyczące użycia

- ① Tap-to-Mute ze wskaźnikiem stanu LED.
- ② Długi nacisknij F, aby włączyć/wyłączyć światło LED.
- ③ Obróć górną pokrętkę głośności C, aby dostosować poziom wzmocnienia mikrofonu.
- ④ Dotknij przycisku modelu światła F, aby dostosować efekt światła.
- ⑤ Obróć dolne pokrętkę G, aby dostosować jasność światła.

NL: Gebruiksrichtsnoer

- ① Tap-to-mute met LED statusindicator.
- ② Lang druk op F om LED-licht in/uit te schakelen.
- ③ Draai de bovenste volumeknop C om het versterkingsniveau van de microfoon aan te passen.
- ④ Touch lichte modelknop F om lichteffect aan te passen.
- ⑤ Draai de onderste knop G om de helderheid van het licht aan te passen.

SE: Riktlinje för användning

- ① Tryck på för att stänga av ljudet med LED-statusindikator.
- ② Lång tryck på F för att slå på / stänga av LED-ljus.
- ③ Vrid den övre volymknappen C för att justera mikrofonens förstärkningsnivå.
- ④ Touch ljusmodell knapp F för att justera ljuseffekten.
- ⑤ Vrid nedersta ratten G för att justera ljusstyrkan på ljuset.

US/GB: Specification

Polar Pattern: Cardioid
Input Sample Rate: 96kHz
Bit Rate: 24Bit
Frequency Response: 50Hz-20kHz
Sensitivity: -40dB±3dB(0dB=1V/Pa, at 1kHz)
Output Impedance: 2.2kΩ
THD+N: <1%
S/N Ratio: 70dB
USB Cable Length: 2m

DE: Spezifikation

Polarmuster: Cardioid
Eingangssamplerate: 96kHz
Bitrate: 24Bit
Frequenzgang: 50Hz-20kHz
Empfindlichkeit: -40dB±3dB(0dB=1V/Pa, bei 1kHz)
Ausgangsimpedanz: 2.2kΩ
THD + N: <1%
S/N Verhältnis: 70dB
USB Kabellänge: 2m

FR: Spécifications

Motif polaire: cardioïde
Taux d'échantillonnage d'entrée: 96kHz
Débit binaire: 24Bit
Réponse en fréquence: 50hz-20kHz
Sensibilité: - 40db±3db (0db=1V/PA, 1khz)
Impédance de sortie: 2.2kΩ
THD+N: <1%
Rapport S/B: 70dB
Longueur du câble USB: 2m

IT: Specificazione

Modello polare: Cardioide
Frequenza di campionamento di ingresso: 96kHz
Velocità in bit: 24Bit
Risposta in frequenza: 50Hz-20kHz
Sensibilità: -40dB±3dB (0dB=1V/Pa, a 1kHz)
Impedenza di uscita: 2.2kΩ
THD+N: <1%
Rapporto S/N: 70dB
Lunghezza cavo USB: 2m

ES: Spécifications

Motif polaire: cardioïde
Taux d'échantillonnage d'entrée: 96 kHz
Débit binaire: 24Bit
Réponse en fréquence: 50hz-20khz
Sensibilité: - 40db±3db (0db=1V/PA, 1khz)
Impédance de sortie: 2.2kΩ
THD+N: <1%
Rapport signal / bruit: 70dB
Longueur du câble USB: 2m

PL: Specyfikacja

Polar pattern: cardioïde
Invoersamplesnelheid: 96kHz
Bitsnelheid: 24Bit
Frequentierespons: 50Hz-20kHz
Gevoeligheid: -40dB±3dB (0dB=1V/Pa, bij 1kHz)
Uitvoerimpedantie: 2.2kΩ
THD+N: <1%
S/N verhouding: 70dB
Lengte van de USB-kabel: 2m

NL: Specificatie

Polar patroon: cardioïde
Invoersamplesnelheid: 96kHz
Bitsnelheid: 24Bit
Frequentierespons: 50Hz-20kHz
Gevoeligheid: -40dB±3dB (0dB=1V/Pa, bij 1kHz)
Uitvoerimpedantie: 2.2kΩ
THD+N: <1%
S/N verhouding: 70dB
Lengte van de USB-kabel: 2m

SE: Specifikation

Polart mönster: kardioid
Inputprovsfrekvens: 96 kHz
Bithastighet: 24 bitar
Frekvenssvar: 50Hz-20kHz
Känslighet: -40dB±3dB (0dB=1V/Pa, vid 1kHz)
Utgångsimpedans: 2.2kΩ
THD+N: <1%
S/N-förhållande: 70dB
USB-kabellängd: 2m

FCC COMPLIANCE STATEMENT:

This device complies with part 15 of the FCC Rules. Operation is subject to the following two conditions:

(1) This device may not cause harmful interference, and (2) this device must accept any interference received, including interference that may cause undesired operation.

NOTE: This equipment has been tested and found to comply with the limits for a Class B digital device, pursuant to part 15 of the FCC Rules. These limits are designed to provide reasonable protection against harmful interference in a residential installation. This equipment generates, uses and can radiate radio frequency energy and, if not installed and used in accordance with the instructions, may cause harmful interference to radio communications. However, there is no guarantee that interference will not occur in a particular installation. If this equipment does cause harmful interference to radio or television reception, which can be determined by turning the equipment off and on, the user is encouraged to try to correct the interference by one or more of the following measures:

- Reorient or relocate the receiving antenna.
- Increase the separation between the equipment and receiver.
- Connect the equipment into an outlet on a circuit different from that to which the receive is connected.
- Consult the dealer or an experienced radio/TV technician for help.

Warning: Changes or modifications to this unit not expressly approved by the party responsible for compliance could void the user's authority to operate the equipment.

Special accessories or shielded cables must be used with this unit to ensure compliance with the Class B FCC limits.

Statement for IC:

This device contains licence-exempt transmitter(s)/receiver(s) that comply with Innovation, Science and Economic Development Canada's licence-exempt RSS(s). Operation is subject to the following two conditions:

- (1) This device may not cause interference.
- (2) This device must accept any interference, including interference that may cause undesired operation of the device.

L'émetteur/récepteur exempt de licence contenu dans le présent appareil est conforme aux CNR d'Innovation, Sciences et Développement économique Canada applicables aux appareils radio exempts de licence. L'exploitation est autorisée aux deux conditions suivantes :

- (1) L' appareil ne doit pas produire de brouillage;
- (2) L' appareil doit accepter tout brouillage radioélectrique subi, même si le brouillage est susceptible d' en compromettre le fonctionnement.

WINDOWS 7/8/10/11 INSTALLATION FOR USB MICROPHONE

Step 1: Plug the USB port of the microphone directly into your laptop or desktop computer.

Step 2: Right-click the Audio manager icon on the lower right of the desktop, then click the recording devices.

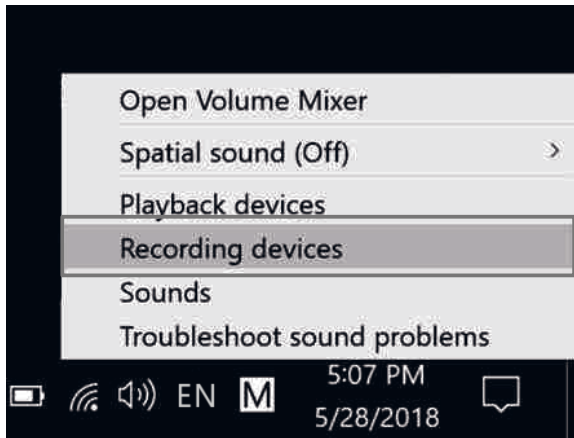

Step 3: You can see the microphone is set up and is on the default.



Step 4: Try to speak into the microphone, the volume bar of the TC310 USB Microphone will fluctuate, which means that the microphone has started to work normally.



MAC OS INSTALLATION FOR USB MICROPHONE

Step 1: Click the desktop menu, then click System Preferences.

Step 2: Find the sound button and click it.

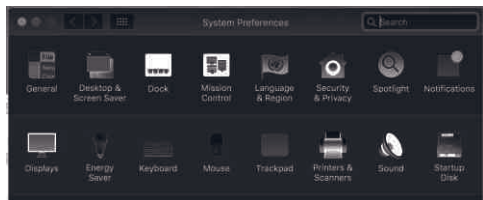
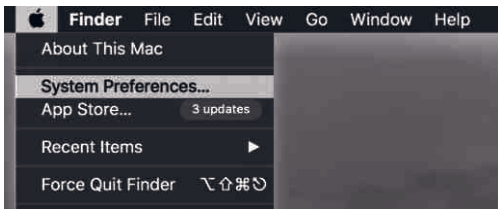

Step 3: Choose input. You will find an internal microphone.

Step4: Choose TONOR TC310 USB Mic , adjust input volume.
(General adjustment in the middle).

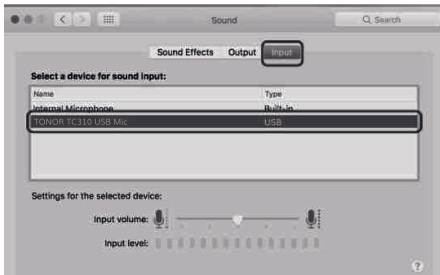
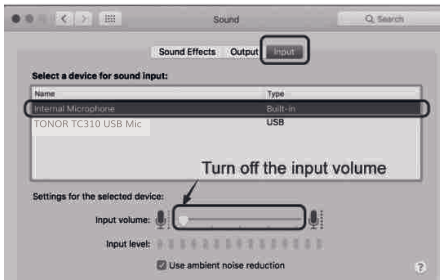

Step 5: Search the built-in software, QuickTime Player and the right click and select 'NEW Audio Recording'.

Step 6: After selecting the external USB microphone, click the recording button and you can record it with the mic.

