

Bwine[®]

14+
for age

Quick Start Guide

v1.0

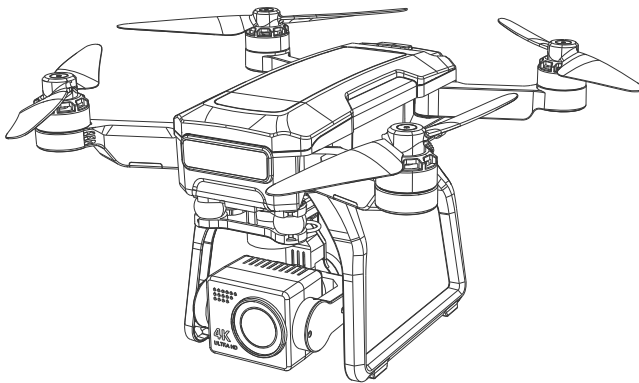

F7GB2

1

Download App

🔍 Bwine Drone



Bwine Drone App

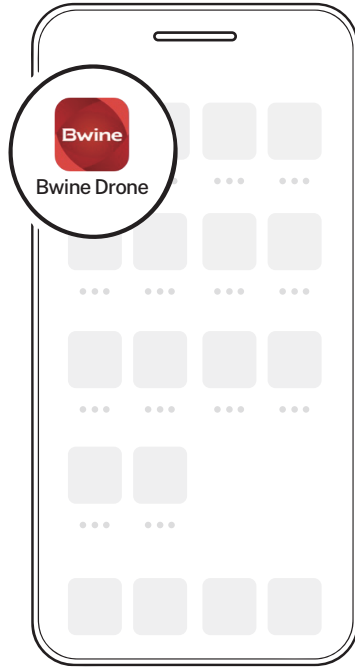

Charge the Batteries

(Not included in package)

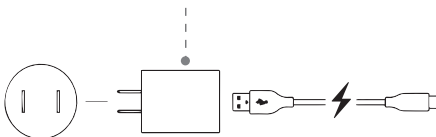

≤ 15W

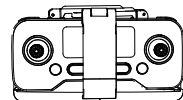
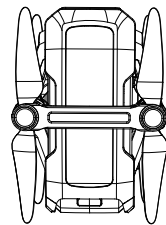

2

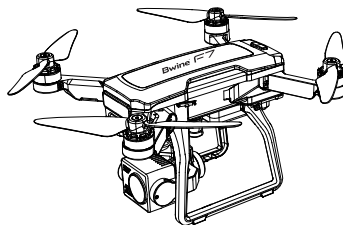
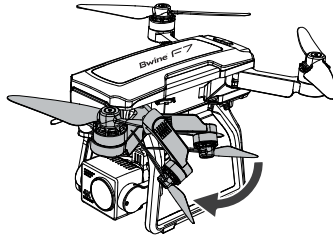
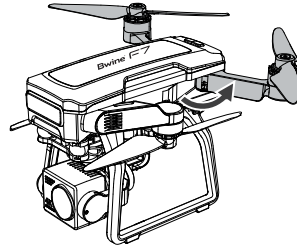
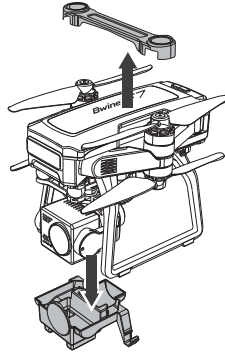

3

Unfold the antenna

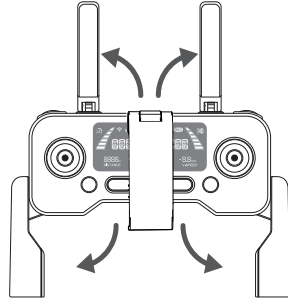
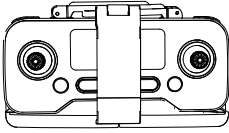

Unfold the handle

1

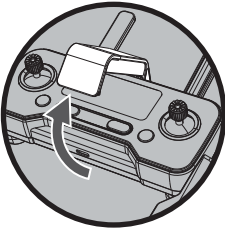

2

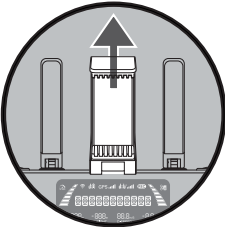

3

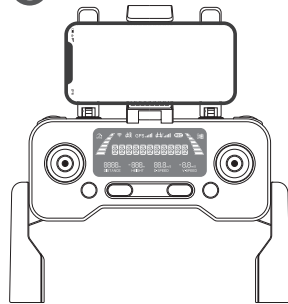

4

Select an Open Flight

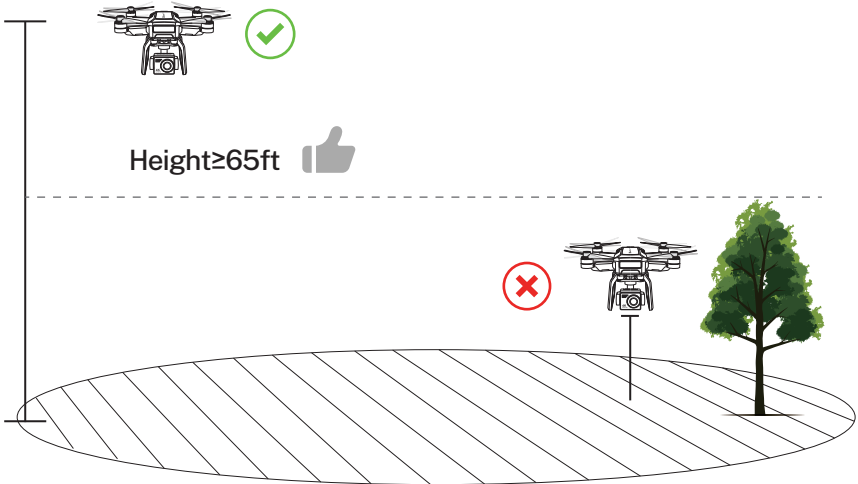

5

1

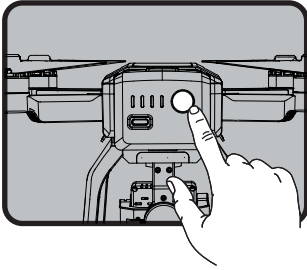

- Press and hold the button until the aircraft plays startup sound.



2

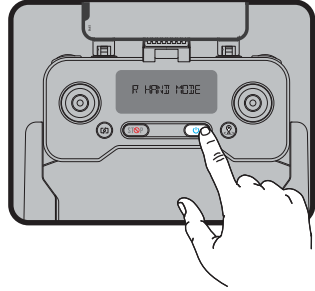

- Short-press 2 times to power on the transmitter.

Pair the Transmitter with the Aircraft

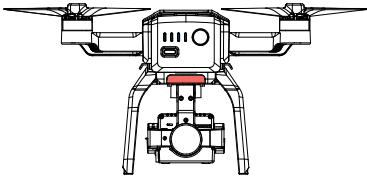

- The light on the back of the drone turns from red to green.
(About 40 seconds)

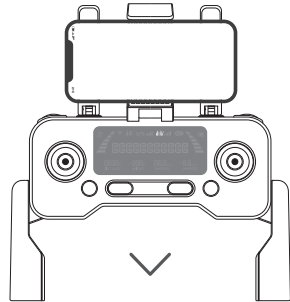

- The DI sounds of the transmitter stop and signal sign on the screen lights, pairing completed.

6

Connect to Wi-Fi

- Connect the mobile device to the aircraft's Wi-Fi and enter the App operation page. Please refer to user manual (page 34) for more details.

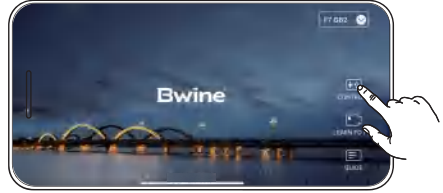

Tap "CONTROLS" icon

Calibrate the Compass

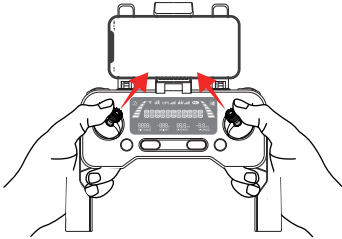

- Push joysticks to 1 & 11 o'clock position.

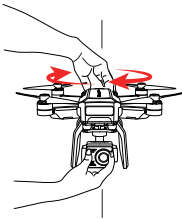

- Rotate the aircraft horizontally 360°.
(About 1-2 turns)

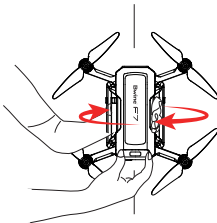

- Rotate the aircraft vertically 360°.
(About 1-2 turns)

7

Calibrate the Gyroscope

- Push joysticks to 11 & 1 o'clock position.
(About 2 seconds)

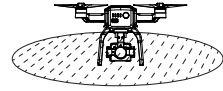
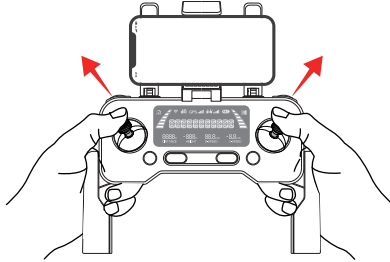

A level ground

Gimbal Self-inspection

- Put on a level surface.
(About 20 seconds)

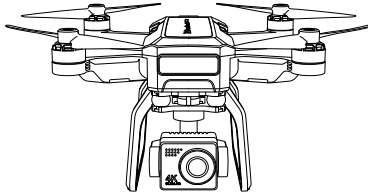

Search for GPS Automatically

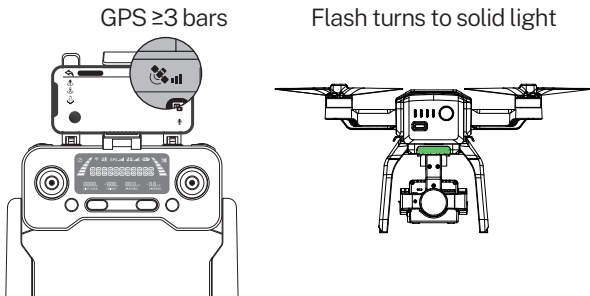

- ⚠ Tips: 1. The searching time depends on the flight environment.
2. If unsuccessful, the motors can't be started.
-

Start the Motors

- Push joysticks to 5 & 7 o'clock position.
(About 2 seconds)

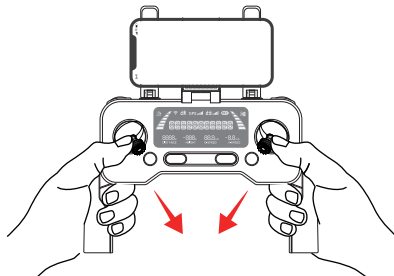

Take off

- Push the left stick.

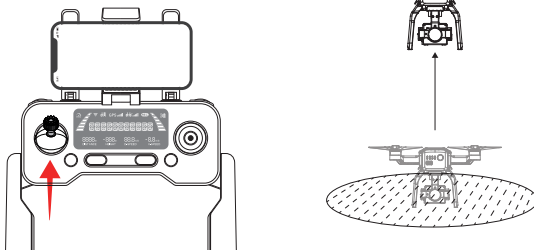



NEW TO FLYING DRONES?

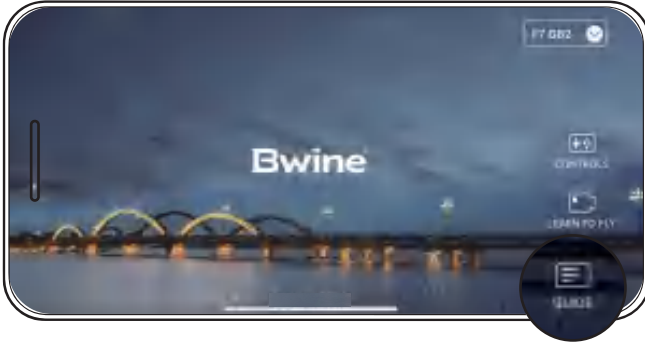

Check the Flight Guide in the App



Search **"Bwine F7 Quick Start"**
on YouTube for First Flight



Scan QR Code for More
Tech and Video Support

CONTACT US FOR MORE TECH SUPPORT

✉ Bwinedrone@gmail.com

Printed in China.

Common Problems and Solutions

Question	Reason	Solutions
The motors cannot be started	Weak GPS signal	Turn on the aircraft in an open area with strong GPS signal
	The red light stays on	The aircraft has low battery. Please charge the battery in time
	The pink light stays on	The compass is not calibrated. Please refer to the "Calibration Before Flight" section of the user manual
	The left and right joysticks are in place	Push the left and right joysticks simultaneously to 5 o'clock and 7 o'clock for 2 seconds
Unstable flight	Flying too low, affected by aircraft airflow	Please fly the aircraft above 9.84ft(3 meters)
	The gyroscope is not calibrated	Place the aircraft on a horizontal surface and conduct gyroscope/horizontal calibration. Please refer to the "Calibration Before Flight" section of the user manual
	The propellers become deformed and incomplete	Replace the propellers with new ones
	GPS signal is unstable. Flying near buildings and in obstructed places	Please fly the aircraft in an open area free of obstacles within the circle of radius 32.81 ft (10 meters)
The flying direction of the aircraft is opposite to or inconsistent with the remote control joystick when flying	The aircraft isn't placed correctly when it takes off	The side with the camera should be forward and the tail of aircraft towards the operator before it takes off
Aircraft falls suddenly	Emergency stop function is used	Please don't use it in non-emergency situations to avoid unnecessary losses
Out of control, spinning around on its own, abnormal sound	The Transmitter signal is interfered or the aircraft exceeds the range of remote control	Please fly the aircraft outdoors without interference, and ensure that it is within a controllable range
	Compass interference	Please manually land the aircraft in time and calibrate the compass. Please make sure to fly away from the buildings, trees, power lines, and signal towers
	The propellers become deformed and incomplete	Replace the propellers with new ones
Can't enter the compass calibration program	The position of the joysticks isn't right	Push joystick on the left into 1 O'clock position and the joystick on the right into 11 O'clock position at the same time
Need to calibrate compass each time	To reduce the situation of out of control, improve its stability and make it return more accurate	Calibrating it follows the user manual or APP commands

Question	Reason	Solutions
Gimbal doesn't work	The gimbal hits the grass when the aircraft takes off from the grass	Put the aircraft on the aircraft landing pad or cardboard to avoid hitting obstacles
	The gimbal of aircraft is interfered by man-made external forces, or the aircraft is picked up during the calibration process of gimbal	It takes about 40 seconds for gimbal self-checking and don't touch it during calibration
	The aircraft enters compass calibrations program	The gimbal doesn't work during calibration. Please place the aircraft on a level ground when calibrating and the gimbal will calibrate automatically
Video isn't clear	Saved it on APP. The video resolution is only 1280*720P when saved on APP	Please insert an SD card into the camera and save the video on it
Video freezes, image transmission distance is short	The joysticks are moved too fast when controlling the aircraft	Move the joysticks slowly Adjust the frame rate and pixel on the APP
	The aircraft is out of Wi-Fi range	Fly the aircraft within the range of the Wi-Fi
	WiFi image transmission signal interference	Fly the aircraft in an unobstructed open area free of buildings, high-voltage wires and signal towers
	The transmitter and the mobile phone are not pointed at the direction of the aircraft	Point the Transmitter and the mobile device at the flying direction of the aircraft to maintain the strongest signal connection
	Phone performance freezes	Close unused apps running in the background to maintain the best performance of the phone
	The remote control antennas aren't unfolded	Unfold the antenna and mobile phone holder and make the antennas aim at the flying direction of the aircraft
App does not display the interface	The phone is not connected to Wi-Fi	Connect your mobile device to the Wi-Fi : Bwine-F7-GB2-*****
	The phone version is too low	Android 6.0 and above, IOS 10.02 and above
	When connecting to the aircraft's WiFi, the network is not set or set incorrectly	Set the Wi-Fi correctly
		Turn the phone to airplane mode
	It's intercepted by mobile phone plug-in	Turn off the intercept function and modify permissions
VPN switch is turned on	Turn off the VPN switch	
APP crash or its functions are abnormal	Wrong app downloaded	Download the correct APP
	The phone version is old and not compatible with the APP	Give us your mobile phone version model and we will give you a corresponding solution
Phone cannot connect to Wi-Fi	It is the first time to connect your phone to the Wi-Fi	Try connecting a few more times or restart the phone

Question	Reason	Solutions
The WiFi name is not displayed in the list	The phone is a single band phone	Use the dual band devices that support both 2.4 GHz and 5 GHz/5.8 GHz
	WiFi has not been activated	Wait for about 30 seconds after turning on the aircraft and keep refreshing the Wi-Fi list while the Wi-Fi is activated
	The aircraft doesn't pair with the remote control	Turn on the aircraft and remote control and it takes about 40 seconds for the aircraft to connect to the remote control. And then you can find the Wi-Fi name in the list
GPS signal is weak	Turning on the aircraft indoors	GPS signals cannot be found indoors. Please search for GPS signals in an open place outdoors
	Under the tree, next to the building, in an obstructed place	Please stay away from obstacles for more than 32.81 feet(10 meters), and search for GPS signals in an open area
Unable to return home, drifting and flying away	GPS signal was turned off during the flight	Please don't turn off GPS suddenly during outdoor flight. Switch back to GPS mode in time
It takes too long for the aircraft to pair with the remote control	It takes about 40 seconds for the aircraft to connect to the remote control	Please wait for about 40 seconds patiently
Cannot charge battery/ Cannot fully charge battery	Using inferior charger or charging on the computer with unstable voltage output	Use a mobile USB charger that ensures constant stable voltage output(5V) and amperage output(2-3A)
	Using inferior charging cables	Please use the original factory charging cable to charge
Short battery life	Flying in windy weather	Flying in windy weather will accelerate power loss
	The battery is not fully charged	Please use a charger with 5V/3A to charge it
	Flying in cold weather	In low temperatures, the chemical reaction of the lithium battery is slowed down and the energy cannot be fully released
The product has slight marks	We tested all aircraft before shipping	In order to give you the best experience, we tested functions of all aircraft before shipping. Therefore, it is inevitable that there will be slight traces. However, it can be guaranteed that all aircraft are 100% brand new

Bwine[®]

Bwinedrone@gmail.com