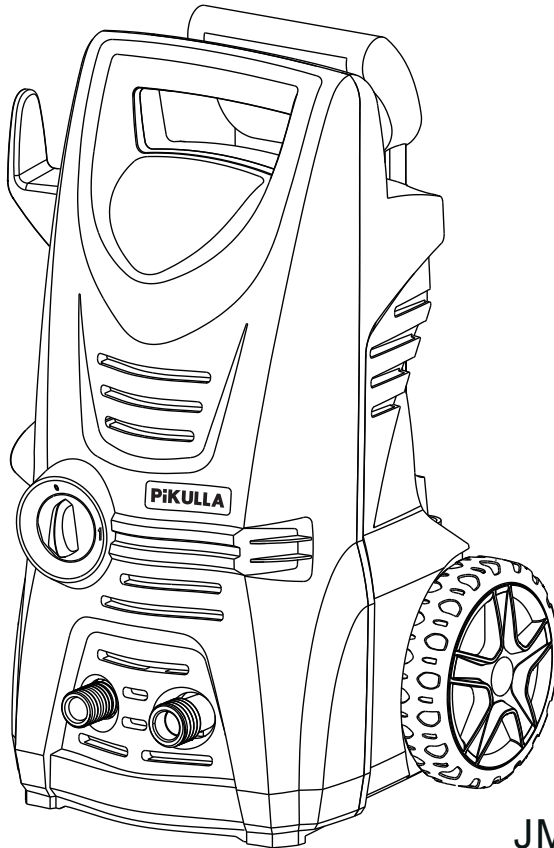


# PIKULLA

## ELECTRIC PRESSURE WASHER

### User Manual



JMG-60514M



#### **CUSTOMER SUPPORT:**

[pikulla-customer care@outlook.com](mailto:pikulla-customer care@outlook.com)

**⚠ WARNING:** Read the instruction before operation.

This machine is designed for domestic use only! Commercial or industrial use are prohibited.

## Contents

Product Description .....	01
Safety Instruction .....	01
Know Your Electric Pressure Washer .....	04
Assembly .....	05
Operation .....	08
Technical Specification .....	09
Maintenance and Care .....	09
Troubleshooting .....	10
Customer Support .....	11

## Product Description

This electric pressure washer is designed for versatile use, offering powerful cleaning capabilities for vehicles , machines, buildings , facades, driveways, decks, sidewalks, garden furniture, and various surfaces. It ensures efficient and thorough cleaning results , making it a valuable tool for a wide range of applications in residential settings.

## Safety Instruction

### All Operators Must Read These Instructions Before Use

- ⚠ **WARNING:** Indicates a hazardous situation which, if not avoided, could result in death or serious injury.
- ⚠ **CAUTION:** Indicates a hazardous situation which, if not avoided, might result in minor or moderate injury.
- ⚠ **DANGER:** Indicates an imminent hazardous situation which, if not avoided, will result in death or serious injury.

## General Safety:

**WARNING:** This appliance is not intended for use by children or individuals with reduced physical, sensory, or mental capabilities. Ensure supervision to prevent any mishandling. Before operation, inspect the machine for any defects. If defects are found, do not use the machine and contact customer service.

(pikulla-customer@outlook.com)

**WARNING:** Always follow basic safety precautions while operating the pressure washer to reduce the risk of fire, electric shock, and personal injury. This includes understanding the machine, keeping a safe distance, using appropriate attire, and maintaining a stable position.

## Operating Instructions:

- 1** Stay alert and sober. Operate the pressure washer away from bystanders, pets, and children.
- 2** Avoid unintentional starting. Ensure the machine is off before connecting to power.
- 3** Use safety gear, including glasses, gloves, and non-slip footwear.
- 4** Never use the machine with hot water. Only connect to a cold water supply.

**WARNING:** Do not operate the machine if the power cord or other important parts are damaged. Contact authorized service for repairs. Disconnect the machine from power supply before any maintenance or repair.

## Electrical Safety:

Ensure any extension cords are suitable for outdoor use and are in good condition. The machine must be connected to a power supply with residual current device (RCD) protection.

**WARNING:** Protect all electrical connections from water and moisture.

## Usage Precautions:

**WARNING:** Never direct the spray towards people, animals, or electrical devices. Use only detergents recommended for pressure washers.

**CAUTION:** Do not allow the unit to run dry or without a stable water supply. Ensure all connections are secure and free from damage before operation.

## Storage and Maintenance:

Store the machine in a frost-free area to prevent damage.

**CAUTION:** Use a pump protector for cold weather storage to avoid damage. Regularly inspect and maintain the machine to ensure safety and efficiency. Always turn off and disconnect the machine when not in use or before any maintenance.

## Shutting Down & Breaks:

To shut down, turn off the machine and disconnect the power and water supply. Release pressure from the system.

For breaks longer than five minutes, ensure the machine is off and disconnected.

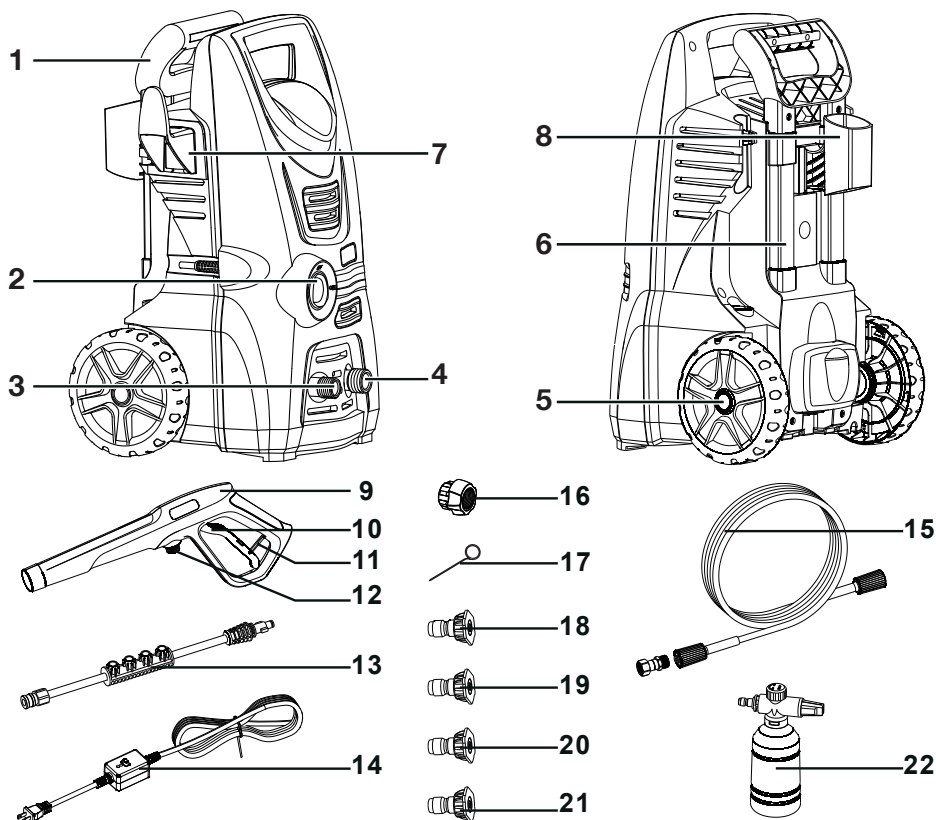
## Winterizing & Long-Term Storage:

Properly drain and protect the machine with non-toxic antifreeze if temperatures fall below freezing.

**WARNING:** Before re-use, ensure the system is thoroughly flushed of any antifreeze. By adhering to these instructions, operators will ensure a safer working environment and prolong the lifespan of the pressure washer. Always consult the full manual and contact customer service for any uncertainties or issues.

([pikulla-customer@outlook.com](mailto:pikulla-customer@outlook.com))

## Konw Your Electric Pressure Washer

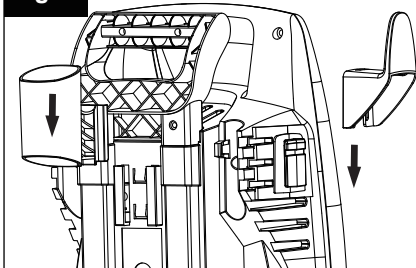


- 1. Transport handle
- 2. On/Off switch
- 3. Water outlet(high-pressure connection)
- 4. Water Inlet(garden hose connection)
- 5. Wheel\*2
- 6. Telescopic handle
- 7. Cord holder
- 8. Pressure water sprayer holder
- 9. Pressure water sprayer
- 10. Trigger
- 11. Safety lock
- 12. High-pressure hose connection
- 13. Stainless steel lance
- 14. Power cord with GFCI
- 15. High-pressure hose
- 16. Garden hose adapter
- 17. Needle clean-out tool
- 18. 0° Quick-Connect nozzle (red)
- 19. 15° Quick-Connect nozzle (yellow)
- 20. 25° Quick-Connect nozzle (green)
- 21. 40° Quick-Connect nozzle (white)
- 22. Foam Cannon

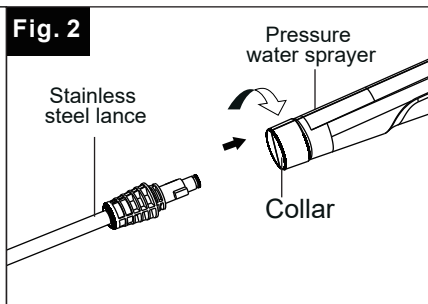
# Assembly

1. Position the washer as CLOSE as possible to the water supply.
2. Slide the pressure water sprayer holder and cord holder into the positions (Fig.1).
3. Insert the Stainless steel lance into the pressure water sprayer and ensure both parts are fully locked together (Fig.2).

**Fig. 1**

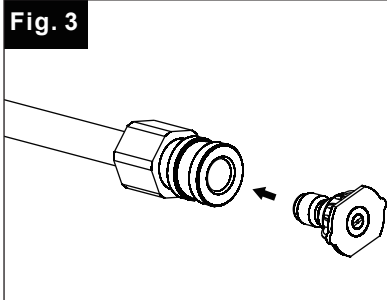


**Fig. 2**

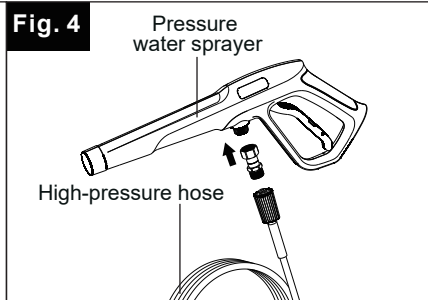


4. Insert the desired nozzle onto the spray wand (Fig.3).
5. Connect the high-pressure hose to the pressure water sprayer (Fig.4).

**Fig. 3**



**Fig. 4**



## Tips: 1.Nozzle Type

<p>  0°</p>	<p>The 0° intense-jet nozzle (red) is a powerful nozzle designed for concentrated, high-pressure cleaning. It's ideal for removing tough stains like tar and grease from concrete and for cleaning hard-to-reach areas, such as 2-story building facades and the undersides of lawn equipment.</p> <p><b>NOTE:</b> Care should be used when choosing the right nozzle to avoid permanently gouging wood or damaging fragile surfaces.</p>
<p>∨ 15°</p>	<p>Use the 15° fan-tip nozzle (yellow) for tough cleaning jobs on hard surfaces, such as paint stripping, oil stain removal, grease cleaning, tackling heavy mildew stains, and rust removal from steel. Ensure it is only used in areas that can handle the high-pressure output of this nozzle.</p>
<p>∨ 25°</p>	<p>Use the 25° fan-tip nozzle (green) to clean home siding, brick patios, wood decks, driveways, or sidewalks. Prior to full use, conduct a small area test to avoid surface damage.</p>
<p>∨ 40°</p>	<p>Use the 40° wide-spray tip nozzle (white) to clean items such as cars, trucks, boats, patio furniture, or lawn equipment.</p>

## TIPS: 2.Install The Foam Cannon

6. Remove the foam cannon cap and then fill the foam cannon with detergent designed specifically for use with pressure washers (Fig.5).

7. Recap the foam cannon and attach it to pressure water sprayer (Fig.6).

Fig. 5

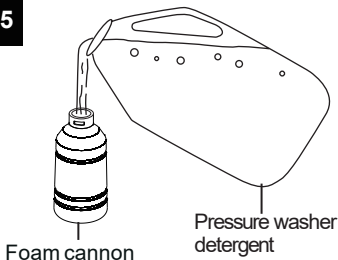
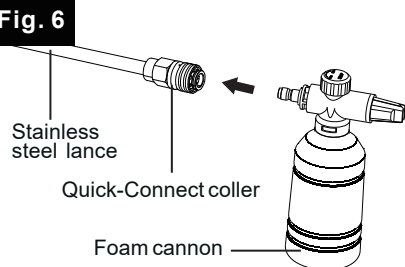
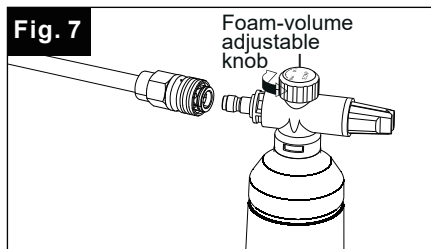


Fig. 6

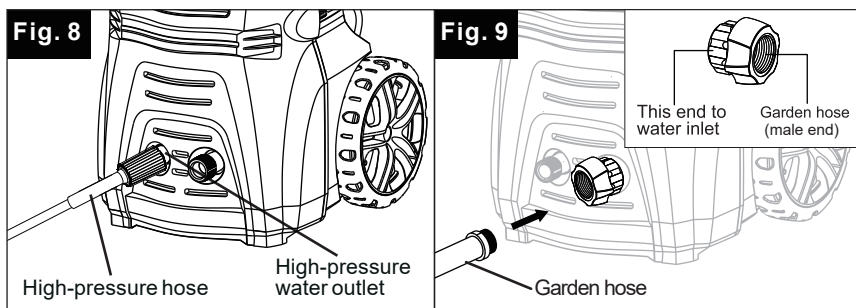


**8.** The foam cannon is featured with a foam-volume adjustable knob. Follow the instructions as shown to use the foam-volume adjustable knob (Fig.7).



**9.** Connect the high-pressure hose to the water outlet on the washer (Fig.8).

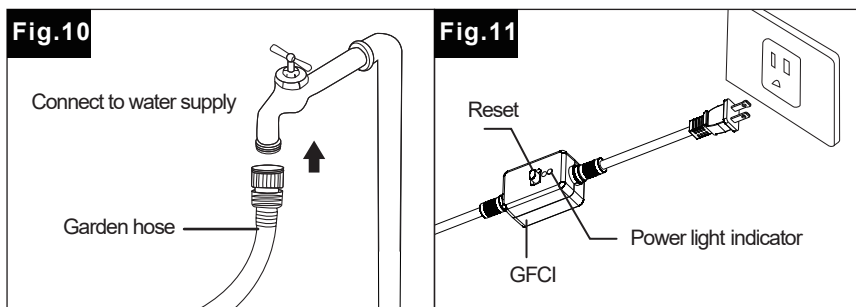
**10.** Connect the garden hose adapter (female coupler) to the water inlet of the pressure washer, then thread your garden hose (male end) into the garden hose adapter ( Fig. 9 ) .



**11.** Connect the garden hose to the water supply ( Fig. 10 ) .

**12.** Plug the power cord into the power source ( Fig. 11 ) .

**Note:** The GFCI may need to be reset when first plugged into the electric outlet. Press the "Reset" button until the power light indicator on the GFCI illuminates .





# Operation

## Start Up

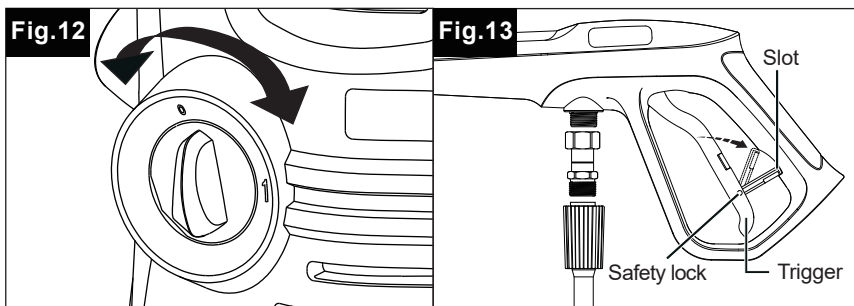
**1** Turn the water supply tap on completely

**2** Turn on the switch.

**Note:** Ensure that the switch is in the OFF position before plugging the unit into the power outlet (Fig.12).

**3** Press the trigger and start pressure water sprayer (Fig.13). When the flow is steady, Engage the safety lock on the trigger handle by pushing up on the safety lock until it clicks into the slot.

**Note:** Before start , please make sure the safety lock is in the original position, then press the trigger for a few seconds until water flow is steady. This will allow air to escape and discharge any residual pressure in the hose.



## Shutting Down

**1** Turn the switch to the OFF position and unplug the power cord from the outlet.

**2** Turn off the water source.

**3** Hold the trigger to release water pressure.

**4** Disconnect the garden hose from the water inlet on the unit.

**5** Disconnect the high-pressure hose connection on the pressure water sprayer handle .

**6** Release the trigger and engage the sprayer safety lock.

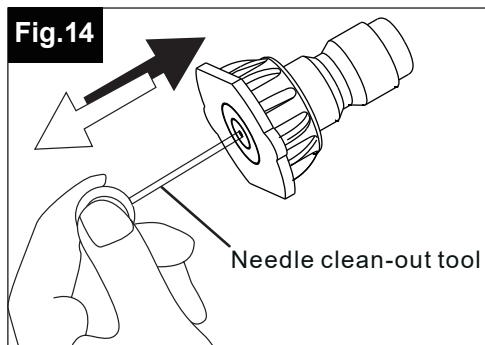
# Technical Specification

Rated Voltage	120V ~ 60 Hz
Motor	14.5 amp
Water Inlet Temperature	32°F-104°F/0- 40°C
Max Water Inlet Pressure	0.4 MPa
Maximum Pressure	2030 PSI
Maximum Flow Rate	2.5 GPM
Hose Length	26 ft(8 m)
Power Cord Length	16 ft (GFCI Protected)
Foam Cannon Capacity	0.5L
Net Weight	16.76 LB

## Maintenance and Care

**CAUTION!** Before working on the pressure washer, disconnect the plug from the power supply socket.

1. Clean the nozzle using the needle clean-out tool provided (Fig. 14). Remove the spray wand from the sprayer, clear any debris from the nozzle hole, and rinse it.
2. Remove any remaining debris by back flushing water through the nozzle and spray wand. To do this, position the end of your garden hose (with water running) against the nozzle's tip, expelling water and debris from the rear opening of the nozzle and spray wand.



# Troubleshooting

**Notice:** Disconnect the unit from power before performing maintenance or checking its parts.

Problems	Possible Cause	Possible Solution
Machine refuses to start	<ol style="list-style-type: none"> <li>1.power cord is not plugged in.</li> <li>2.Defective socket.</li> <li>3.Fuse has blown.</li> <li>4.Defective extension cord.</li> </ol>	<ol style="list-style-type: none"> <li>1.Connect the power cord to the power supply.</li> <li>2.Check the power cord and reset the GFCI or try a different outlet.</li> <li>3.Replace fuse. Switch off any other machines that are using the same circuit.</li> <li>4.Try the unit without an extension cord.</li> </ol>
Fluctuating pressure	<ol style="list-style-type: none"> <li>1.Pump sucking air.</li> <li>2.Valves dirty, worn out, or stuck.</li> <li>3.Pump seals worn out.</li> </ol>	<ol style="list-style-type: none"> <li>1.Check the hoses and connections are airtight.</li> <li>2.Clean or replace valves/seals.</li> </ol>
Machine stops	<ol style="list-style-type: none"> <li>1.Fuse has blown.</li> <li>2.Incorrect mains voltage.</li> <li>3.Thermal sensor activated.</li> <li>4.Nozzle partially blocked.</li> </ol>	<ol style="list-style-type: none"> <li>1.Replace fuse. Power down other machines on the same circuit.</li> <li>2.Verify the mains voltage matches the model specifications.</li> <li>3.Allow the washer to cool for 5 minutes.</li> <li>4.Clean the nozzle.</li> </ol>
Fuse blows	<ol style="list-style-type: none"> <li>1.Air in inlet hose.</li> <li>2.Inadequate supply of mains water.</li> <li>3.Nozzle partially blocked.</li> <li>4.Water filter blocked.</li> <li>5.Hose kinked.</li> </ol>	<ol style="list-style-type: none"> <li>1.Keep holding the trigger until normal working pressure returns.</li> <li>2.Ensure the water supply matches the required specifications.</li> <li>3.<b>WARNING!</b> Avoid using long, thin hoses.</li> <li>4.Clean the nozzle.</li> <li>5.Clean the water inlet filter.</li> <li>6.Straighten the hose to clear any kinks or blockages.</li> </ol>

Problems	Possible Cause	Possible Solution
Machine often starts and stops by itself	1.Pump/sprayer is leaking. 2.Trigger mechanism is broken.	Please mail: <a href="mailto:pikulla-customer care@outlook.com">pikulla-customer care@outlook.com</a> for assistance.
Machine starts, but no water comes out	1.Pump/ hoses or accessories frozen . 2.No water supply. 3.Water inlet filter blocked. 4.Nozzle blocked.	1.Allow pump, hoses, or accessories to thaw. 2.Connect inlet water. 3.Clean the water inlet filter. 4.Clean the nozzle.

## Customer Support



**Email:**

[pikulla-customer care@outlook.com](mailto:pikulla-customer care@outlook.com)



**Hours:**

Monday - Sunday,  
 Response within 12 hours