

SWM

Instruction manual

**CAR STEREO MP5 PLAYER WITH
7 INCH HD DISPLAY PANEL
FM STEREO RADIO
USB / MICRO SD READER
BLUETOOTH
REAR VIEW
CARPLAY**



Before installation

Thank you very much for purchasing and using our products, when you receive the product, please do not take the product directly to the car for installation, because the product is in the after a long journey, it may affect the product. Please try the machine before installing.

Test method: Take the machine to the battery of the car and test it. This car stereo applies to a power supply voltage at 12V DC. Connect the red and yellow wires of the power cord of the machine together and connect it to the positive pole of the battery. The black wire of the power cord is connected to the negative pole of the battery. Wait for 10 seconds after connecting, press each button of the machine to see if the machine can boot normally. If it can be turned on, it means there is no problem, you can install it. If the test machine can not start normally, please again Confirm that you follow the steps of our test method in strict accordance with the operation. If the problem is still not solved, please contact our work in time. Thank you for your cooperation.

REAR INTERFACE DESCRIPTION

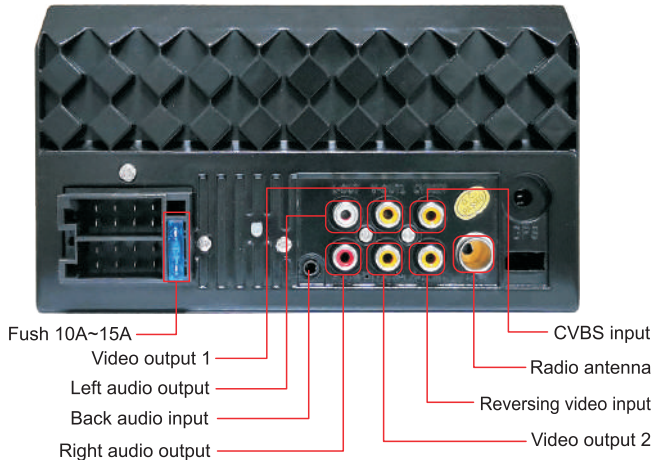

CAME video input interface on the back of the unit. The red line coming out of the video line is connected to the reversing control line of the power line.

- The camera is broken. If the lamp that is properly wired to the camera is not lit, it will be broken and replaced with a new one.

10> USB flash disk can not be played, the card with the map can not be recognized, the card slot does not enter the card, the map card folder has no content?

--- USB flash disk can not play:

Format the USB flash disk, and the file system is selected as: FAT32, re-download on or two songs and try again. If it still doesn't work, please replace the USB flash drive.

--- The map card cannot be recognized(Only for GPS models):

Insert the card into the computer to format, re-download the map or change the memory card to download the map software.

--- The card slot does not enter the card:

Check whether the memory card is inserted, the plug is broken.

--- There is no content in the map card folder(Only for GPS models):

Insert the card into the computer to view it. If there is no content, you need to download it again.

11> FM does not receive the program

--- Can not receive the station check the 2 points

- The antenna plug is not fully inserted, the antenna is disconnect or the line is disconnect.
- Search channel, hold AMS does not let go for 2 seconds The unit will automatically search or press the up and down button to perform a channel search. Can't solve the above 2 points, Please unplug the antenna plug and find a screwdriver or a metal strip to insert it instead of the antenna.

12> Just installed no sound

--- Dear customers, the unit has been tested before shipment. If there is no sound, it is usually a wiring error or the original car speaker wire is short-circuited with iron. Please do not doubt the unit. According to the steps to check it.

- Check if the speaker cable is short-circuited and connected. Please reconnect if you have any short circuit.
- Check how many speaker cables according to the original speaker cable if there are only 2 speaker cables to prove that the original car line does not match our unit, you need to re-route the original car line. One speaker must lead to 2 speaker wires. 2 speakers must have 4 speaker cables to available.

13> After a while there is no sound

--- Disconnect all the speaker cable from the unit (do not remove all of them), and then find an external speaker to receive the gray and purple of the tail line of the unit. Green any group, and then try to see if there is any sound. If there is a sound, it is proved that the car's speaker line is short-circuited with iron or the speaker is damaged. If there is no sound, the unit is broken.

4> Remote control cannot be used

--- Check if the battery of the remote control has power

1. Test method: Turn on the camera of the mobile phone and align the light of the remote control, then press the button of the remote control to see if the phone will light up. If it is not lit, there will be no power. Replace the battery; That is, there is electricity, which proves that there is no problem with the remote control.

5> Settings cannot be saved (no memory)

--- There is no memory function, there is only 2 points in memory

1. The yellow line and the red line are connected together (separate yellow to positive, red to key control).
2. Yellow and red are reversed (just change position).

6> Car audio with Bluetooth but if can't work

--- Check the phone to see if you can search for the unit code or no.

Operation steps: turn on the unit, use the phone Bluetooth search, search for CAR-MP5, then click the connection, after connecting, you can answer the phone or Bluetooth to play the song.

PIN Code: 0000 .

7> The product smoke has proved that the internal circuit has been burned and change the insurance FUSE can not solve the problem

--- In this case, the unit needs to be repaired.

8> How to adjust the sound, where is the equalizer set, the sound can not be adjusted

--- Adjust the sound: please turn the volume to adjust.

--- Equalizer settings: In general, press the volume knob to display the equalizer SEL, and rotate the volume button to adjust each sound effect.

--- The sound cannot be adjusted: 1.Please reset the unit or unplug the power cord and plug it in. 2.The Volume knob is broken, and the knob can be replaced.

9> Support no image of reversing camera

--- Generally two situations

1. Connect the wrong line or less wiring. Camera connection method:

- a> The first step is to find accessories (accessory: one camera + one power cord + one video cable).
- b> The second step is to find the port of the wiring. First find the reversing control line on the power line of the unit. The control line is a pink line or brown line, connect this line to the positive pole of 12V and the screen will turn blue. Find the back of the unit the CAME video input interface, find the positive and negative of the backup light. The third step is to connect: there are two sockets on the camera, the red socket is connected to the power cable, the yellow is inserted into the video cable, the red wire of the power cable and the wire of the video cable are screwed together on the positive pole of the reverse lamp, and the black wire of the power cable is not used, connected, the other end of the video cable is connected to the

REAR INTERFACE DESCRIPTION

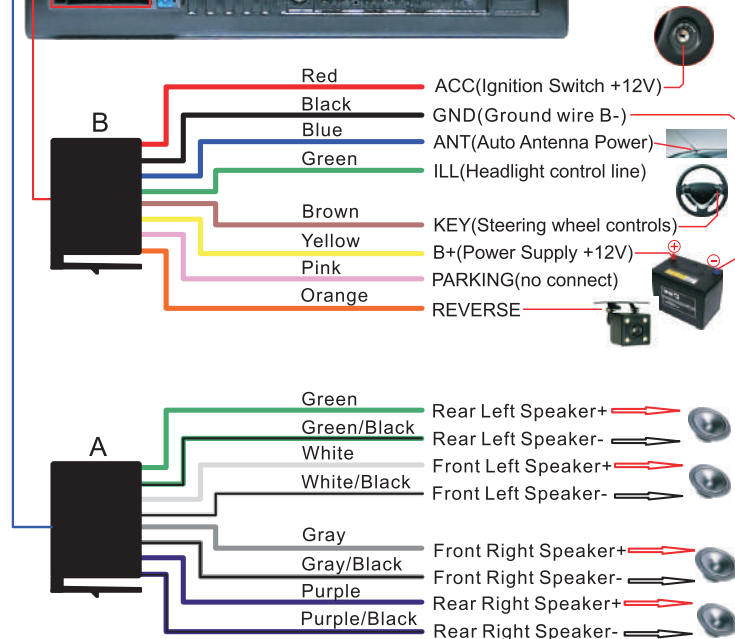

REVERSING CAMERA INSTALLATION METHOD

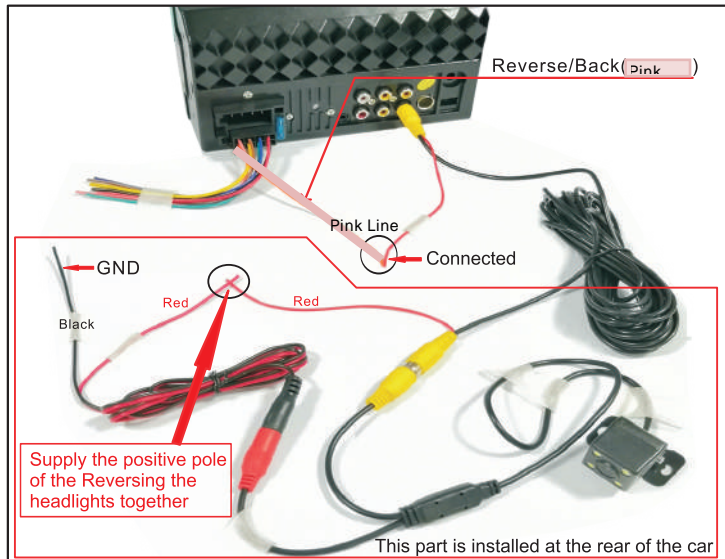

Note:

If the reversing camera is not installed, please do not connect the REVERSE/BACK cable to any place. Please leave the cable unconnected, otherwise the machine will not display properly, or it will automatically enter the reverse mode when working irregularly, which will cause the machine to fail normal work. In case of such a situation, please disconnect the REVERSE/BACK line as soon as possible to avoid affecting the normal use of the user.

MACHINE FIXED REFERENCE METHOD

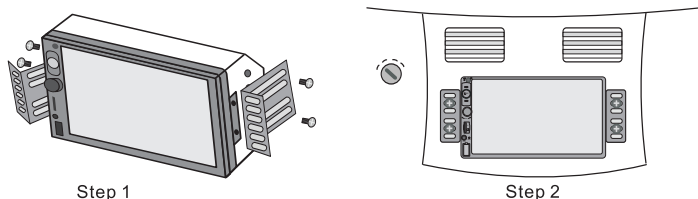

COMMON PROBLEMS AND SIMPLE TROUBLESHOOTING

1> Unable to boot normally

--- Reason for not booting

1. "Yellow" "Red" "Black" this 3 lines only connected 2 line of them, so it will not start, it should be that the yellow line is connected to the positive pole, red line to the key control line, black to the negative pole, less connection or wrong connection does not boot.
2. The original car line and unit wiring can not be connected to the color, the color of the original car line is not standard, if you connect like that it can not only be turned on but also may burn.
3. The original car plug can't be plugged directly into the new unit, even if it just plugs in, it can't be used, otherwise it won't be turned on or burned.
4. The 3 wires are connected right, but it does not boot. Check if the fuse on the yellow line is broken. If there is no problem with the fuse, twist the yellow and red wires together. Turn on the key and press the unit's power button to see if it can be turned on.
5. Every time you change the fuse, it burns. Please don't change it again. The reason is that when you first connect the positive and negative poles, the protection circuit of the unit is short-circuited. The unit can be repaired under the guidance of our master. No basis can only be returned to the after-sales or new unit. If these are no problem, or also don't boot, please make the final step to confirm, find a 12V battery or 12V power supply "yellow" and "red" twist together with the positive, black to the negative pole, press the button check if it can boot or no, if you can boot, it showed that the original car line is not right connect, or there is a problem with the car line. If it can't be boot, the unit is broken. Does not boot unit, check the line carefully, do not blindly suspect the unit problem.

2> Automatic shut-down

--- Automatic shutdown usually has these following conditions

1. The cable error connect: If the blue cable (automatic antenna power supply) is connected to the power cable of the unit, an automatic shutdown will occur. Please follow the correct wiring method to solve the problem.
2. The voltage is unstable: please find a 12V-5A which one is the power supply and re-tested to see if it will automatically shut down or no. If it does not automatically shut down after the test, please replace the power supply. If it will automatically shut down, it is problem with the unit.

3> Having noise

--- The general situation of noise is caused by two reasons

1. The original speaker power is too small. When the volume of the unit is turned up, there will be noise.
Solution: When replacing the speaker or listening to the song, the volume should not be too large.
2. The speaker cable is grounded.
Solution: Take the iron speaker cable. Directly connected to the speaker cable of the unit.

[AUTO PLAY FUNCTION]

Android Auto for android phone.

1. Download and install the Android Auto APP on your phone.
2. Use the original USB cable to connect the USB interface of the machine to the USB port of the phone.
3. After the connection is successful, some functions on the phone can be operated in the Auto Play mode of the machine.

Carplay for iphone.

1. Open Carplay on your phone.
2. Use the original USB cable to connect the USB interface of the machine to the USB port of the phone.
3. After the connection is successful, some functions on the phone can be operated in the Auto Play mode of the machine.

[VIDEO WARNING]

When you are playing a video, if you are prompted on the screen, you are not allowed to watch the video. This is a function for security considerations that does not allow watching videos while driving. If you do not need this function, please adjust the value of the Parking Video Disp item to: OFF in the system settings.

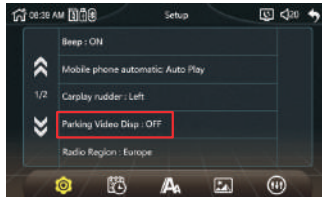
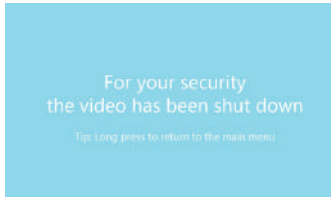

FUNCTIONAL DESCRIPTION



1. **Auto Play:** The Apple system phone uses the CarPlay function, the Android system phone uses the Android Auto function, and uses the USB data cable to connect with the car to allow the phone to communicate with the car.
2. **USB:** USB2.0 interface for playing music/video/pictures in a USB flash drive, or connecting to a mobile phone using a USB data cable.
3. **CARD:** Micro SD card interface for playing music/video/pictures inside the card.
4. **RADIO:** Touch to enter the radio mode to listen to the radio station.
5. **SETUP:** Touch to enter system settings.
6. **BT:** Touch to enter Bluetooth mode.
7. **AV IN:** Touch to enter AV IN mode.
8. **A-Link:** Phone link function, connect the machine and mobile phone with USB cable, you can project the display on the mobile phone to the machine for display. Only after the connection is successful, touch the icon to enter.

[RADIO FUNCTION]



1. Press the button repeatedly to fine tune the radio frequency point to the desired position of the user.
2. Store the station number of the station 1~6 display area, and touch the number to select the corresponding station to listen to. Press and hold the number key to store the current frequency point (displayed in area 10) to the corresponding station number.

- When the button is touched, the machine automatically scans the full-band frequency and stores the effective station on the stations 1~6 of FM1~FM3. Up to 18 stations can be stored. During the scanning process, touch this button again to stop scanning.
- Touch the button to scan the station forward from the current frequency point. When scanning to a valid station, stop and play for 10 seconds, continue scanning the next station, and so on.
- Touch the button to scan the station backwards from the current frequency. When scanning to a valid station, stop and play the current station.
- The radio band can be switched by touching the button.
- Touch the button to scan the station forward from the current frequency. When scanning to a valid station, stop and play the current station.
- Touch the button to switch between local signals and distant signals. A criterion for judging the signal strength of an effective station during the scanning process.
- Touch the button to browse the stations 1~6 of FM1~FM3 in turn. Each station plays for 10 seconds. Touch the button again to stop browsing and turn to the currently playing station.
- Radio frequency display area.

[USB / CARD PLAY FUNCTION]

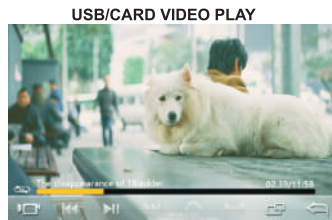
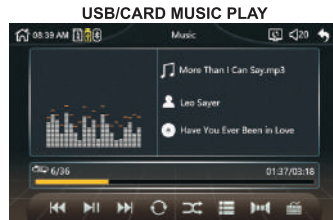
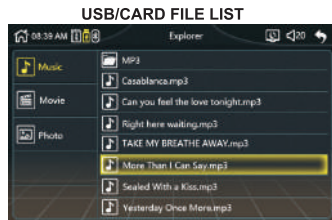

5

- On the Development Options page, set the Select USB configuration to Media Transfer Protocol (MTP). Connect the phone and the machine with the USB cable, and the dialog box "Allow USB debugging" will pop up on the phone. Click the "OK" button.

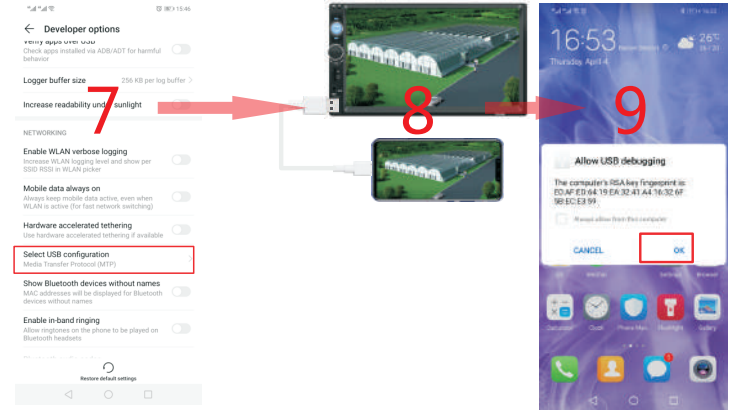

A-Link for iPhone

* For iOS, X series and higher versions of mobile phones do not support mobile "phone link" with this machine.

- Connect the machine and mobile phone with the original data cable.
- When the phone pops up a dialog box: Trust This Computer? Select Trust to enter the interconnect mode.



14

- Find the "About phone" and click Enter. Click on the "Build number" continuously until the phone screen displays "You are already a developer".

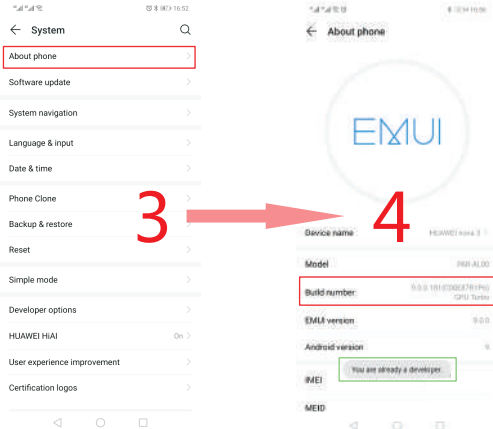

- Go back to the "System" interface, find "Developer options", and click Go to find "USB debugging" and turn this feature on.

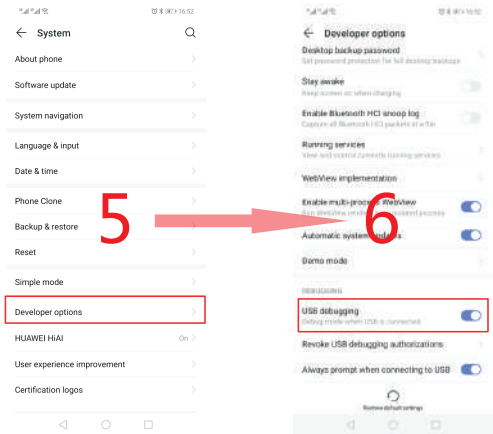

- USB/CARD FILE LIST** : The USB/CARD list interface allows you to select audio/video/photo files for playback, provided that there is a corresponding file in the USB/CARD memory that supports playback.
- USB/CARD MUSIC PLAY** : The music player interface can display the ID3 information of the song.



Touch to play the previous song.



Touch button to switch play/pause.



Touch to play the next song.



By repeatedly touching the button, you can switch between the current directory sequential playback/all track sequential playback/single loop playback/current directory loop playback/all track loop playback.



Touch the button to switch the random play/all tracks to loop.



Touch the button to switch the ID3 display or song list display.



Touch the button to switch left channel/right channel/stereo.



Touch the button to call up the keyboard icon, input the corresponding track number through the keyboard icon, and quickly switch to the corresponding song for playback.



By repeatedly touching the button, you can set the different sections to play back quickly.



By repeatedly touching the buttons, you can set the fast forward playback of different sections.

- USB/CARD VIDEO PLAY** : The video player interface.



Touch the button to output the video screen to the external display. The display on the unit does not display the screen. Touch the display again, the display will be restored to the display of the unit, and the external display will not display the screen.



Touch to play the previous video.





Touch button to switch play/pause.









Touch to play the next video.



By repeatedly touching the button, you can switch between the current directory sequential playback/all track sequential playback/single loop playback/current directory loop playback/all track loop playback.

-  Touch the button to switch left channel/right channel/stereo.
-  You can switch between different screen display ratios by touching repeatedly.
-  Touch the button to return to the playlist interface.

4. USB/CARD PHOTO PLAY

-  Touch to play the previous photo.
-  Touch the button to switch between automatic playback and stop auto-playing photos.
-  Touch to play the next photo.
-  You can switch between different modes by repeatedly touching the button. During the picture playback, different effects are displayed when cutting to the next picture.
-  Touch the button to zoom in on the picture being played.
-  Touch the button to zoom out of the picture being played.
-  Touch the button to rotate the picture being played clockwise.

[AV IN FUNCTION]

In AV IN mode, users can simultaneously input video and sound through the CVBSIN connector and the 3.5mm AUX input connector, or they can be input separately.

[BLUETOOTH FUNCTION]

Device Name: CAR-KIT(89D)

PIN Code: 0000

Connection Method:

1. Power on the machine and turn it on.
2. Turn on the Bluetooth function on the mobile phone, click Search Device, when the mobile device list searches for the Bluetooth device name of the current machine, click the device name to connect, and when the display is successful, you can use it.
3. The BT icon on the main interface of the machine points to enter the Bluetooth mode, which can operate more functions.

** If some parts cannot be operated or used properly, it may be that the connection is not perfect. Please delete (unpair) the connected Bluetooth name of the mobile phone, and then search for the device again and connect it. Generally, the problem can be solved.*

SYSTEM VERSION INFORMATION DISPLAY.

FACTORY MODE

The factory mode is the setting of some core components of the machine. It is generally not recommended to set the internal information to avoid causing the machine to not work properly.

*Factory setting password: 8800.

[A-LINK FUNCTION]

*In the system settings, set the Mobile phone automatic to A-Link.

A-Link for Android

1. Go to Settings on your phone, find System and click to enter

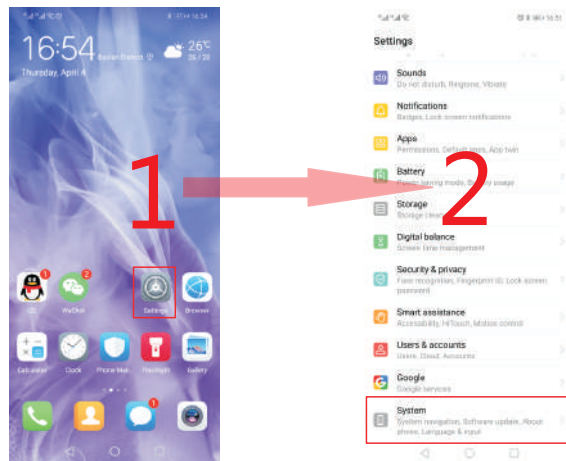



STEERING WHEEL CONTROLS

Instructions:

1. Connect the line of the original steering wheel controller to the machine.
2. On the steering wheel control interface of the machine, press the button to learn.
3. Exit the button learning interface and use the buttons that have been successfully learned.

Wiring method:

1. Locate the positive pole of the original car steering wheel button control line and connect it to the KEY line on the machine's output line.
2. Locate the negative pole of the original steering wheel button control line and connect it to the ground (power negative) line on the machine's output line.

Study method:

1. Enter the steering wheel control interface, press a button on the steering wheel, and a voltage value corresponding to the button will be displayed on the machine display [Voltage:]. At this time, find on the display and just press on the steering wheel. The button below corresponds to the icon of the function, and touch this icon, then touch the icon on the screen to save the button. The value of [Set Count:] on the screen is +1, indicating that the button has been successfully learned. You can learn the next button in the same way.
2. Touching the icon on the screen will clear all previously learned keys.

DISPLAY SETTING

1. **Brightness:** Screen brightness adjustment.
2. **Contract:** Screen contrast adjustment.
3. **Saturation:** Screen saturation adjustment.
4. **Hue:** Screen hue adjustment.
5. **Reset:** Touch the button to restore all settings of the current page to their original state.



1. Touch the button to enter the Bluetooth music player interface, in this interface you can play the music inside the phone through Bluetooth, and you can control the previous song, next song, play/pause through the machine.
2. Touch the button to enter the phone book interface.
3. Touch the button to enter the dialing interface.
4. When the Bluetooth connection of the mobile phone is successful, touching this button will disconnect the connected Bluetooth mobile phone. Touching this button again will automatically connect the Bluetooth of the last disconnected mobile phone.
5. Touch the button to enter the help interface, this interface will display the Bluetooth name of the machine. If the phone is connected successfully, the connected phone Bluetooth name will also be displayed.
6. In the dialing interface, dial the keyboard area.
7. In the dialing interface, when you are in a Bluetooth call, touch this button to pause the call.
8. In the dialing interface, Touch this button to dial the phone number entered by the user. When there is an incoming call, touch this button to answer.
9. In the dialing interface, When there is an incoming call, touch this button to reject the call. While on a call, touch this button to hang up the call.
10. In the phone book interface, the phone number list display area.
11. In the phone book interface, After selecting a number in the phone list, touch this button to dial the selected phone number.
12. Touch the button to download a list of all incoming call numbers.
13. Touch the button to download a list of all the dialed phone numbers.
14. Touch the button to download a list of all phone numbers for unanswered calls.
15. Touch the button to download the phone book inside the phone.

[SETUP]



GENERAL SETTINGS

1. **Beep:** When the button is turned on, every time you touch a button, it will make a “beep” sound. If you don’t need the button sound, you can choose to turn it off.
2. **Mobile phone automatic:** This switch can choose to communicate with the phone as: Auto Play/A-Link/OFF.
3. **Carplay rudder:** This switch can set the Carplay rudder to the left or right.
4. **Parking Video Disp:** Normally this switch is set to OFF, otherwise the machine will pop up a warning when you watch the video, prompting you not to watch the video while driving.
5. **Radio Region:** Users can select the corresponding radio area according to the area they are in. The available areas are: USA1 / Europe / China / Brazil1 / Brazil2 / OIRT / Japan / USA2.
6. **BT Auto Connect:** This switch can be set to the connected Bluetooth device. If it is within the valid range after disconnection, it is necessary to automatically connect the Bluetooth device again.
7. **BT Auto Answer:** This switch can be set to answer automatically when there is an incoming call during a Bluetooth call.
8. **Key light:** Button light setting: It can be set to automatically change the period of the seven-color lamp, or it can be set to a single fixed color lighting effect.
9. **Restore Default:** Touching this option and selecting “YES” in the dialog box will restore all the settings in the common settings to the initial state.

DATE AND TIME SETTINGS

1. **Time Format:** Users can choose the time format as 12-hour or 24-hour.
2. The user can set the time and time on this interface. After the setting is completed, touch the “OK” button to save the settings.
3. Touch the “Reset” button to return all settings of this interface to their original state.

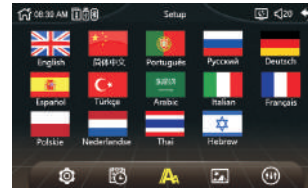

SYSTEM LANGUAGE SETTING

Users can set the system language according to the language they use. Due to the memory limitations of the system, the system only enters some of the more commonly used languages.

BACKGROUND REPLACEMENT

Users can change the background image of the system according to their own needs. They can only choose from 4 different background images preset by the system. User-defined background images are not supported.

AUDIO SETTINGS

1. **LOUD:** Equal loudness setting, you can turn on or off the loudness.
2. **EQ:** With the equalizer setting, the user can switch the non-EQ mode by touching the  button to achieve a different sound experience. The EQ modes that can be used are: CUSTOM/DBB/CLASS/ROCK/JAZZ/POP.
3. **BASS:** When the EQ mode is selected as: CUSTOM, you can manually set the value of the BASS item to adjust the bass effect. Manual setting of BASS values is not supported in other EQ modes.
4. **TRE:** When the EQ mode is selected as: CUSTOM, you can manually set the value of the TRE item to adjust the treble effect. Manual setting of TRE values is not supported in other EQ modes.
5. Touch the “+” and “-” symbols on the display to adjust the focus of the four speakers, front, back, left and right. If the adjusted value is shifted to which side, it will cause the speaker output sound in the opposite direction to become smaller or no sound output.