

Energizer®

**SMART WIFI
LED BULB**



TM

QUICK START GUIDE

v2.0



Thank you for choosing the ***Energizer***® Smart LED Bulb. This Quick Start Guide will help you with setup and installation.

Package Includes:

- 1 – Smart LED Bulb
- 1 – Quick Start Guide



A19



BR30



Note: ***Energizer***® Connect devices must be set up initially with your **2.4GHz WiFi network**. Please note that many home WiFi networks are set to 5GHz by default. (Ex: AT&T, Verizon) Please contact your Internet Service Provider for assistance with 2.4GHz network setup.

Search: Energizer Connect
or Scan the QR code

For video tutorials,
check out our
YouTube channel



Pair the Smart LED Bulb.

1

Download the **Energizer**® Connect app from the App Store (for iPhones) or Google Play Store (for Android phones).

Before opening the app, make sure your phone is connected to the **2.4GHz WiFi network** that your bulb will be placed on.

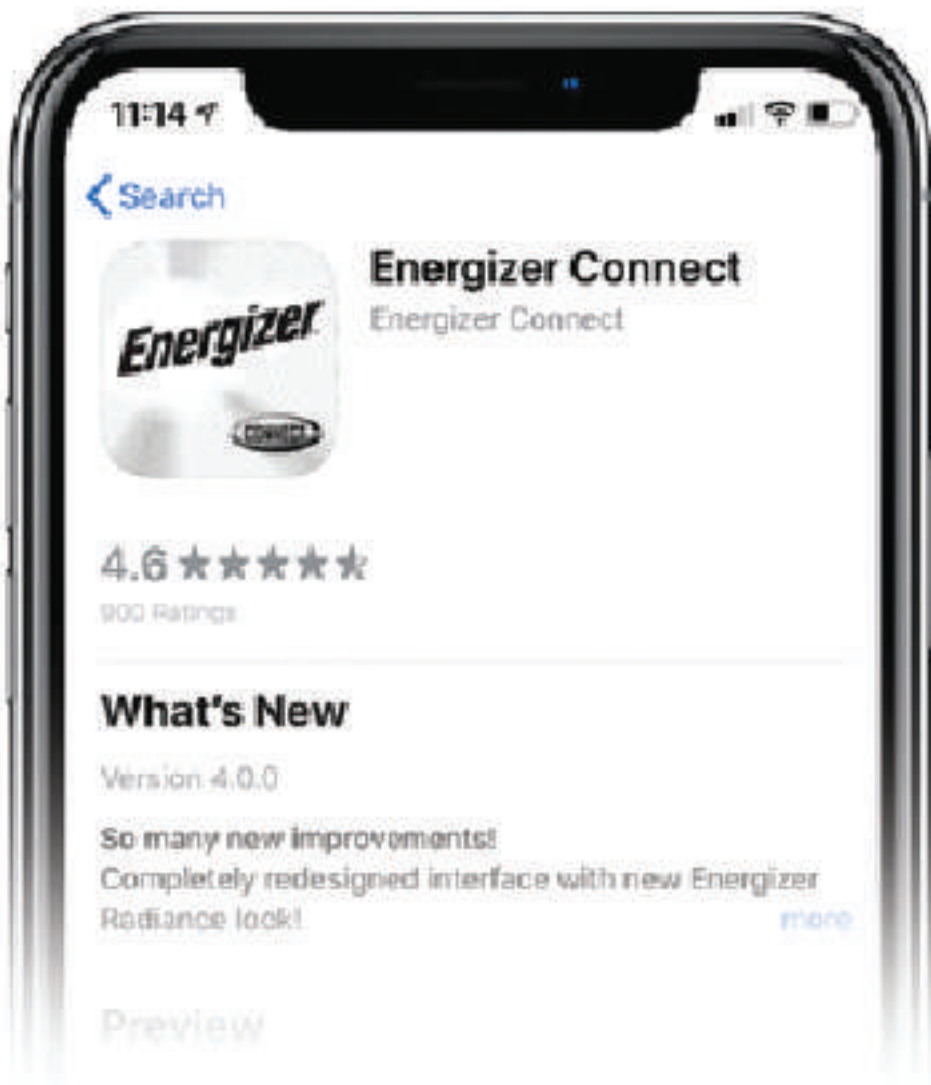

Energizer®



1

2

Open the app and create an account by following the on-screen instructions.

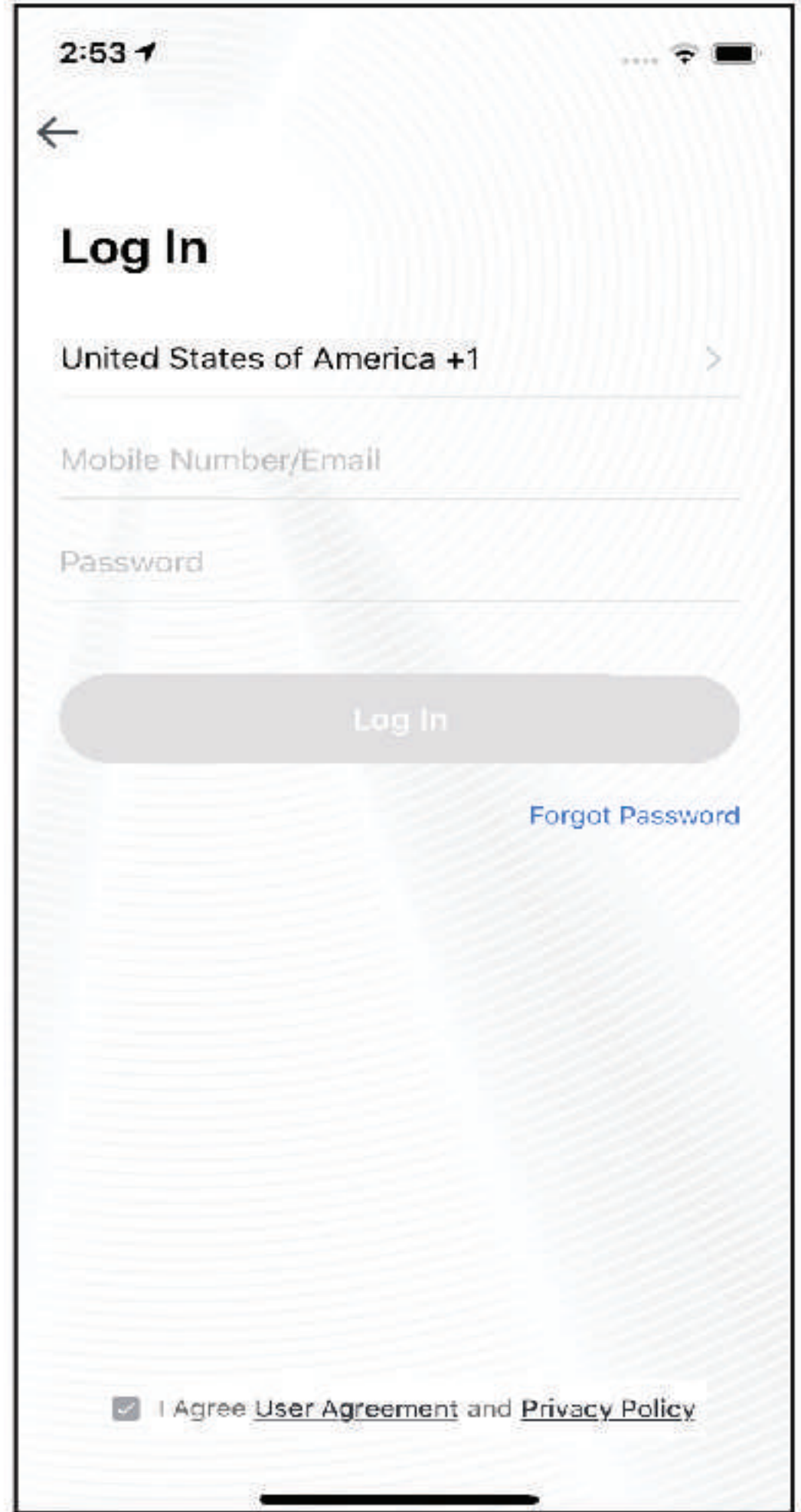

Energizer



2

3

Turn off power to the light socket. Screw the bulb into the light socket. Turn power back on.

The bulb should start blinking rapidly (about 4 times per second) for EZ pairing mode.

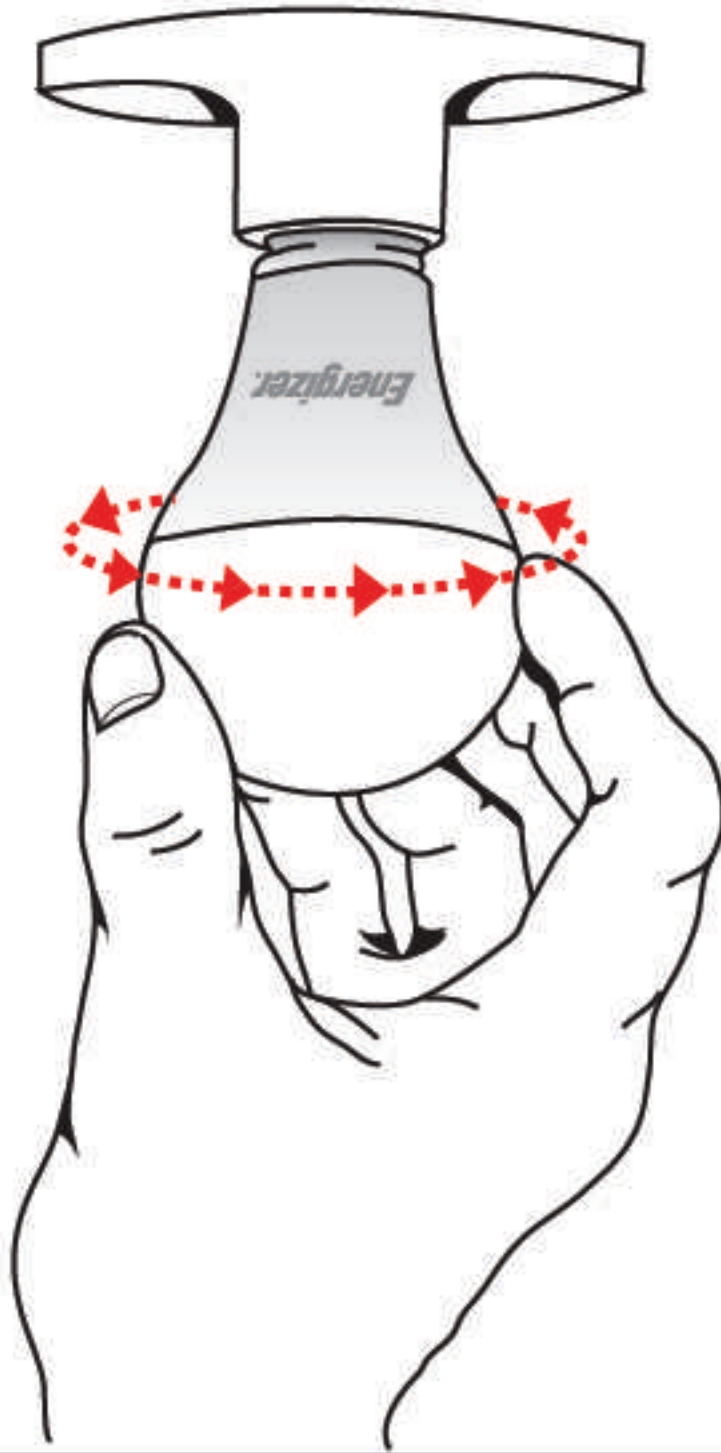

Note: If your bulb is not rapidly blinking you will need to reset it. See the troubleshooting instructions on page 9.

Blinking Definitions

EZ MODE	Rapidly blinking (about 4 times per sec)
AP MODE	Slowly blinking (about 2 times per sec)

4

After logging in, click “+” on the top right of the screen and select "Add Device".

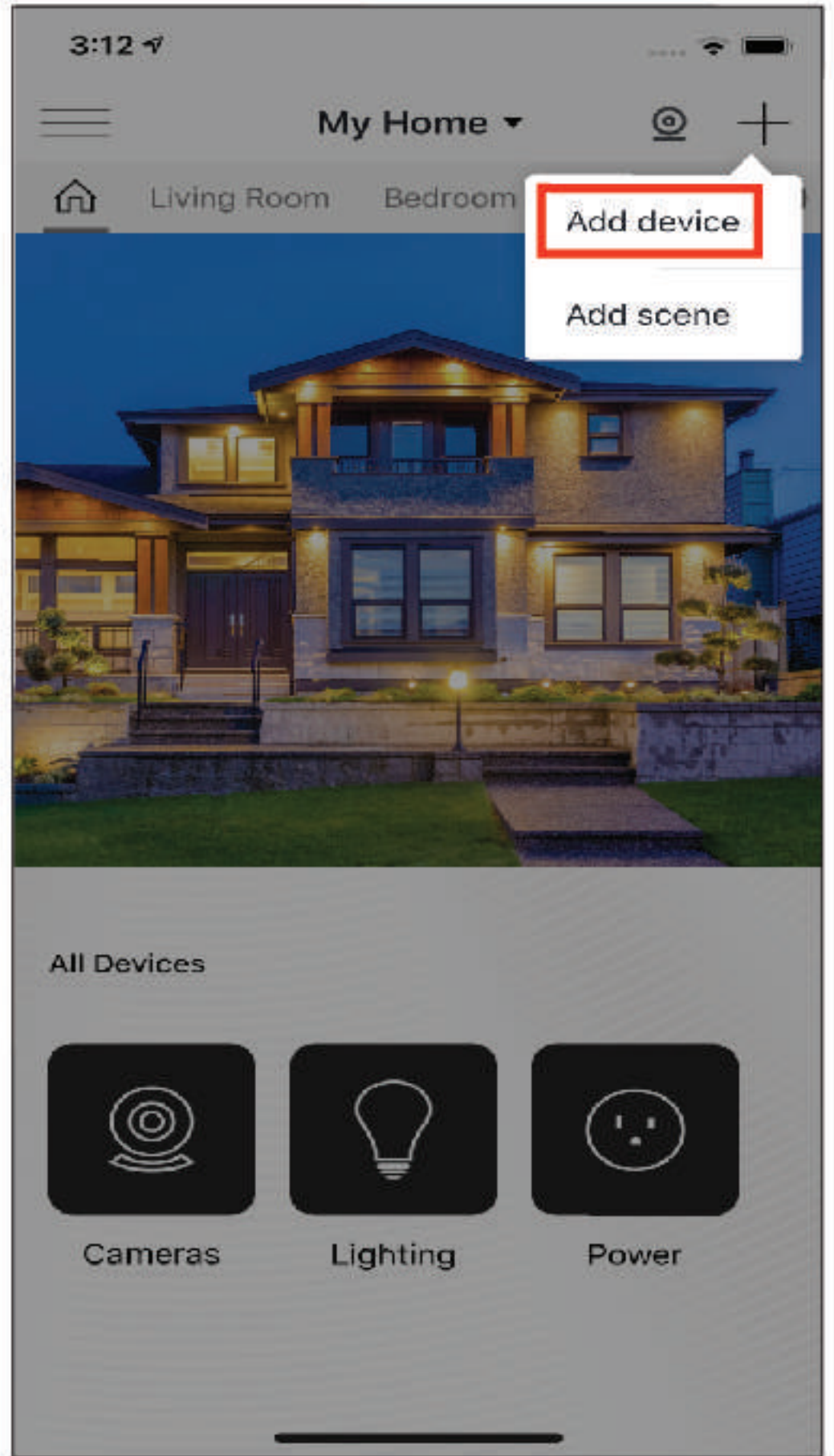
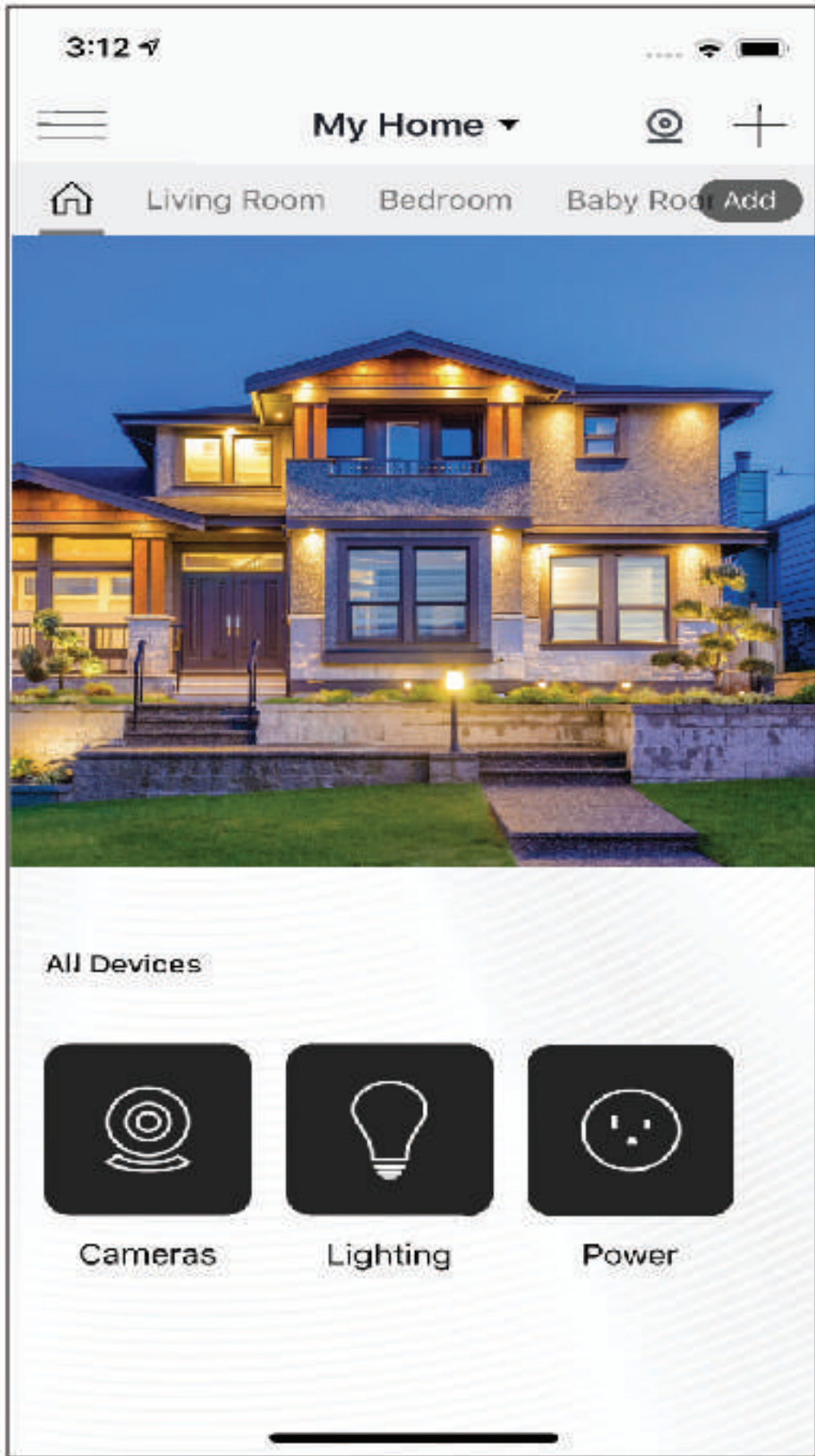

5

Select "Lighting".

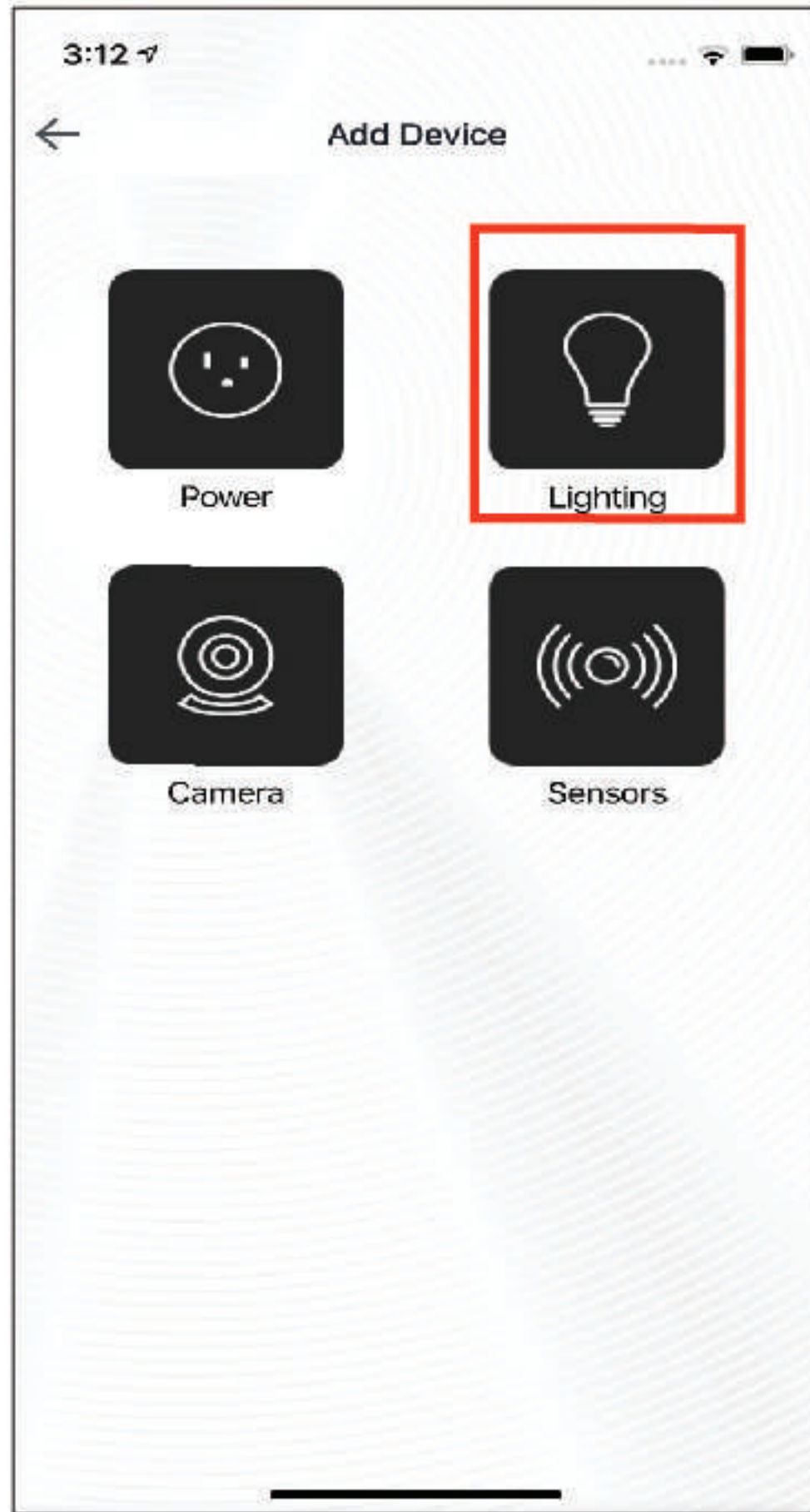

Confirm that the bulb is still rapidly blinking.



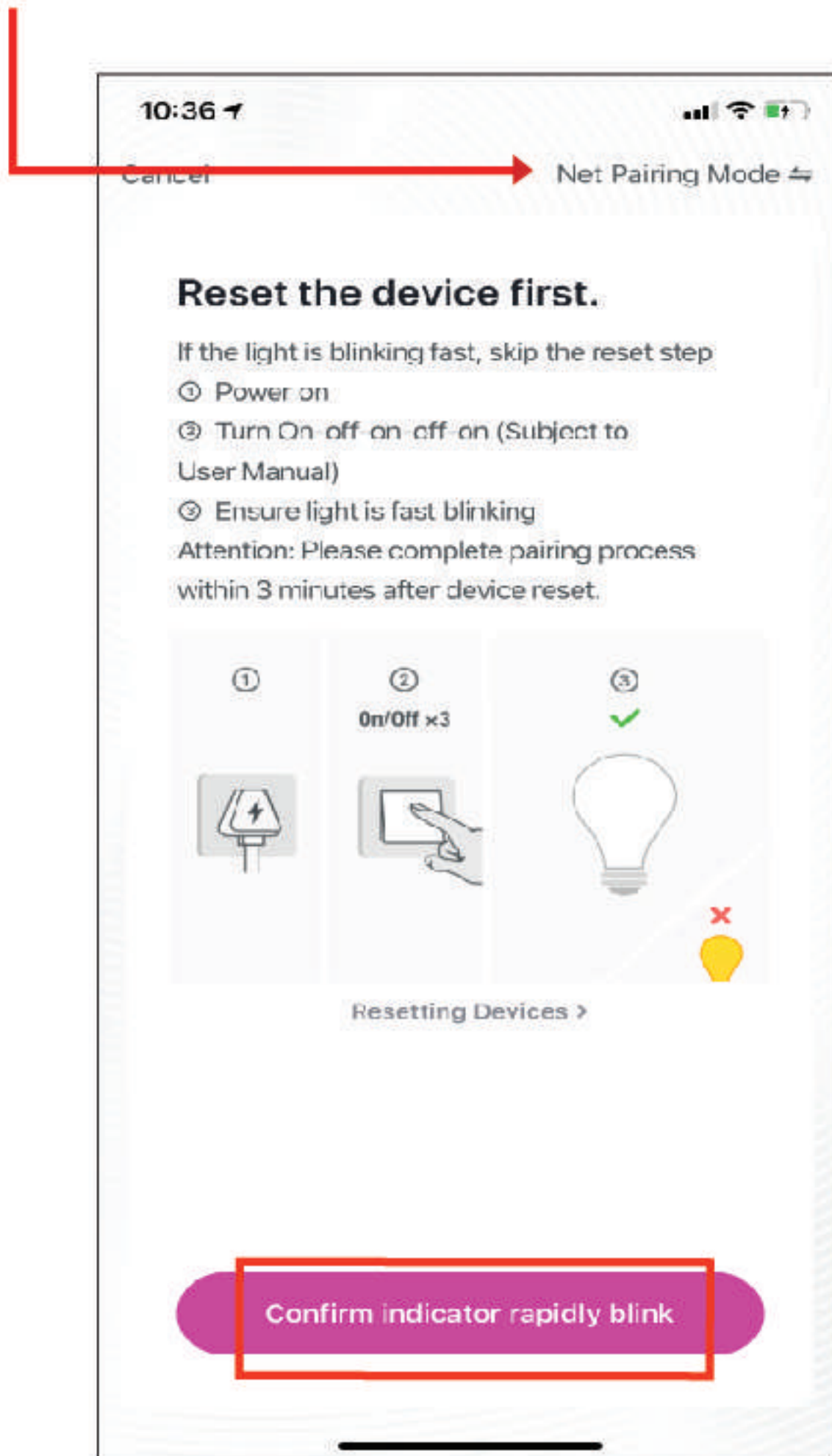

Hint: This is for switching between pairing modes. See page 9 for more details.



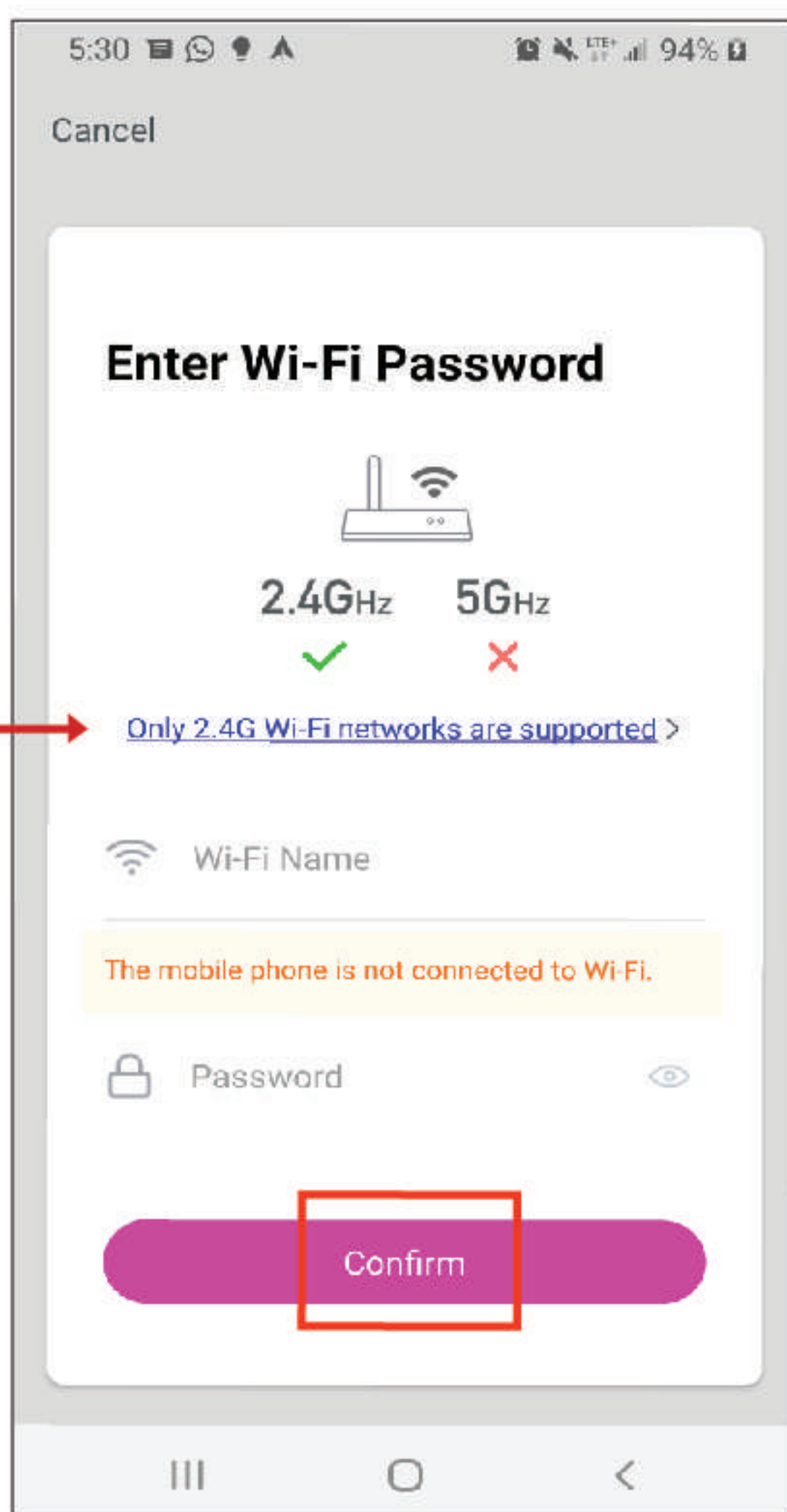

7

Confirm that the network WiFi displayed is your **2.4GHz WiFi** network, enter your WiFi password and click confirm.



 **Hint:** If you are not sure about your network, click on this link to go to our Connection FAQ on our website.

Your bulb will now be connected to the network.

 **Hint:** You can put your smart bulb directly in a room by selecting one of the available rooms. Click button  to change the name of the product.

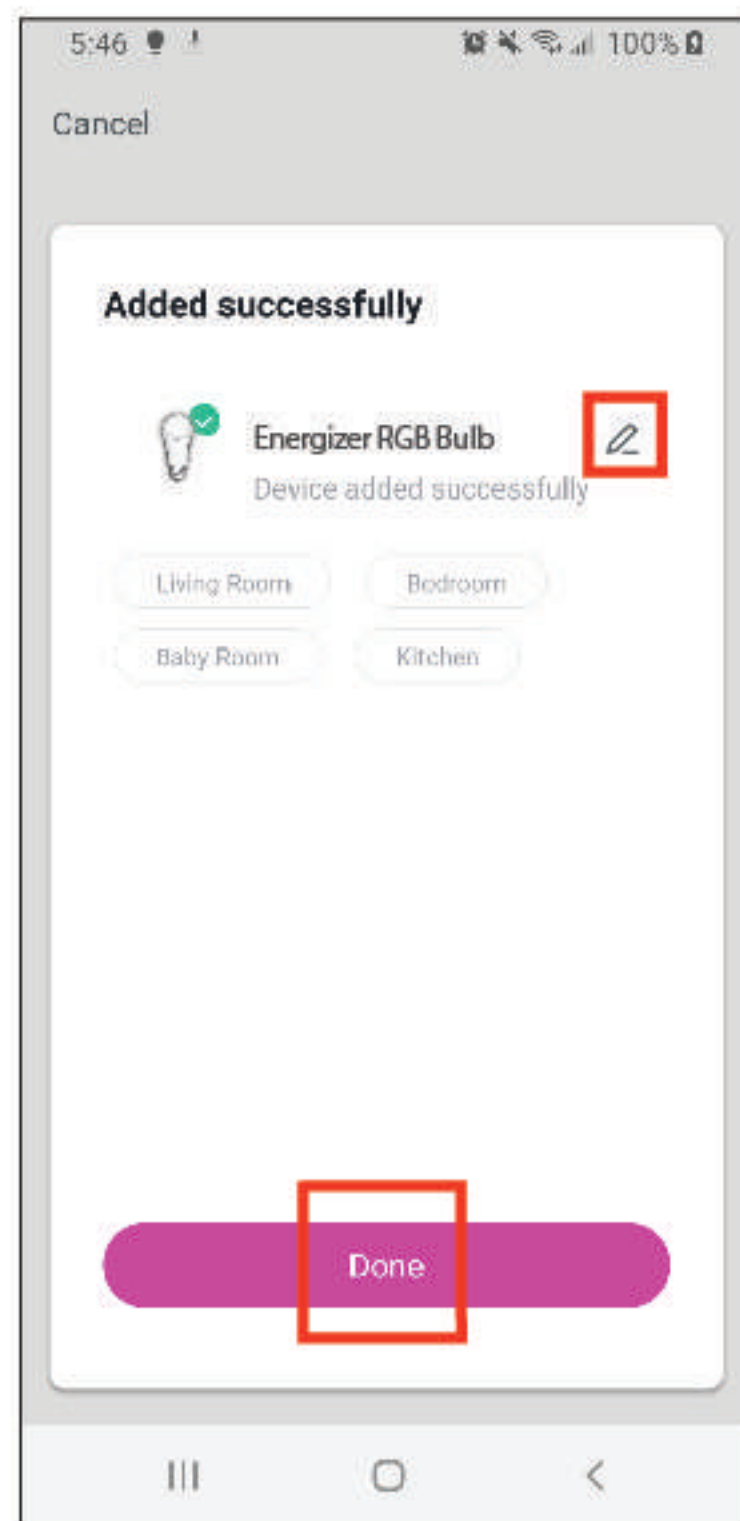
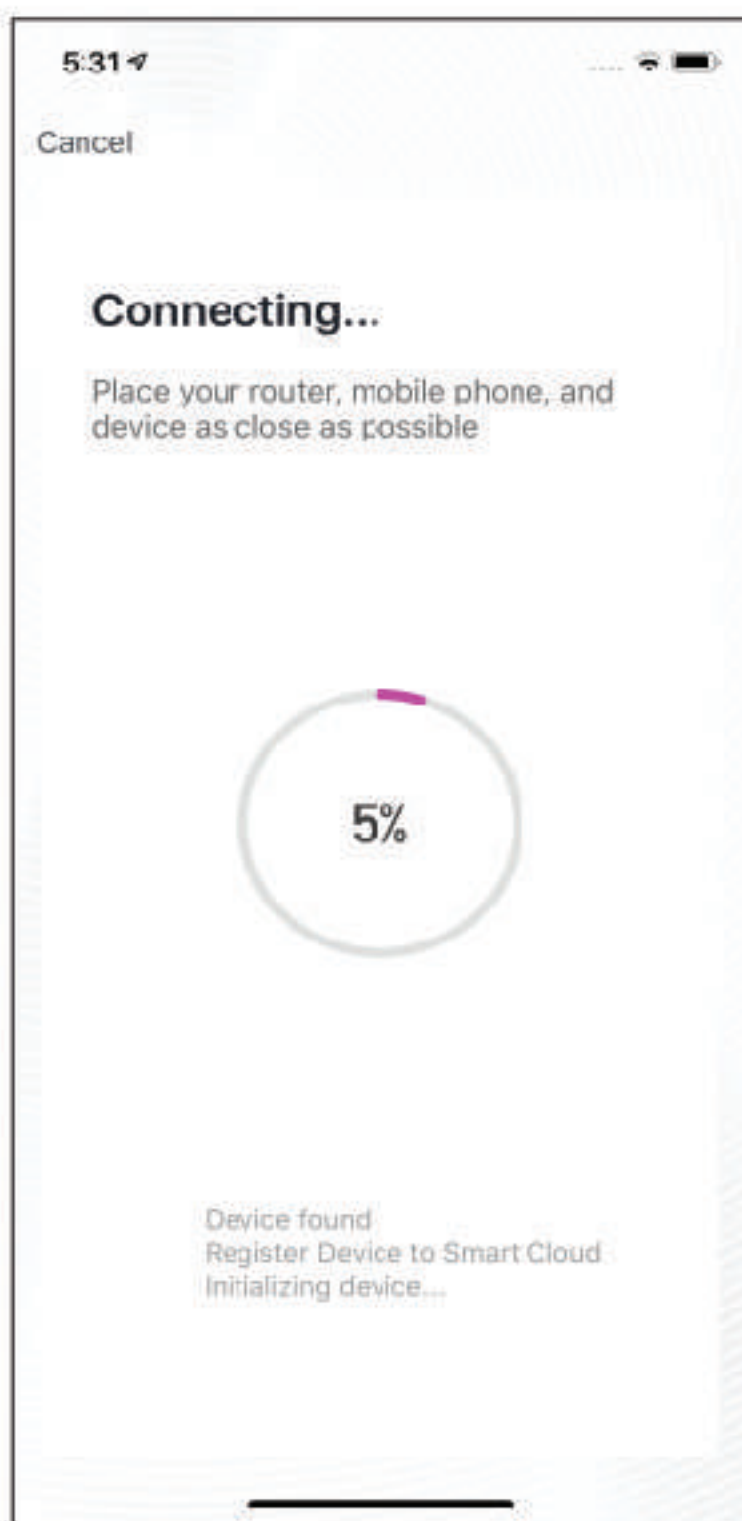

Your **Energizer**[®] Smart LED Bulb is now ready to use. You can now change color temperature*, dimness and set schedules.

We hope you enjoy using your **Energizer**[®] Smart LED Bulb. For frequently asked questions and instruction videos, please visit our website at www.energizerconnect.com.

*Note: Multi-color and multi-white capable bulbs only.

Troubleshooting

If you need to reset your bulb, simply turn the bulb on/off 3-5 times.

NOTE: Once the smart bulb is fully set up, turning the light switch off and on multiple times in a row may cause the bulb to go back into reset mode. If this happens, please delete the bulb from your app and re-add it normally.

Pairing Modes:

EZ mode: The device's light is rapidly blinking for easy, quick pairing setup.

AP Mode: Access Point mode is a secondary setup process in which the bulb is slowly blinking and requires multiple steps for pairing. Follow the on-screen step by step instructions.

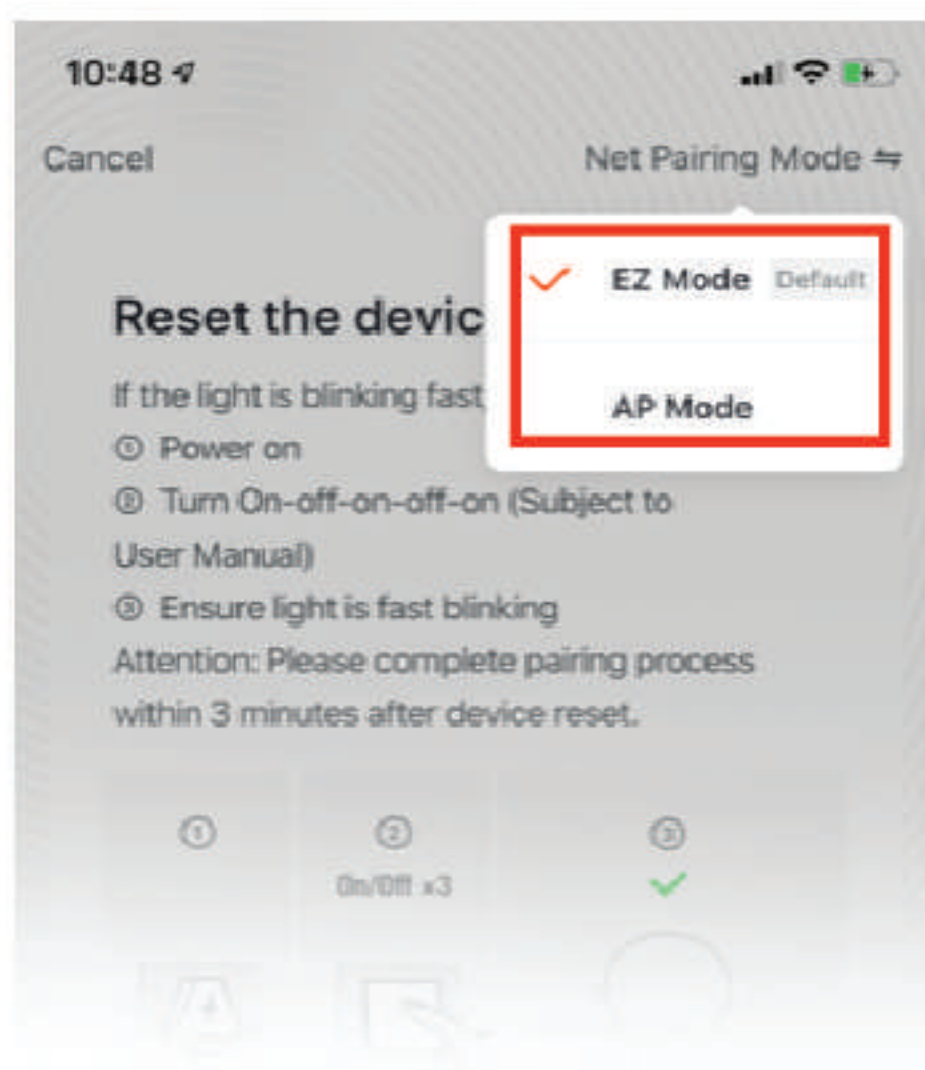

To enable voice access for your Smart LED Bulb, you will need to link the **Energizer**® Connect skill with your choice of voice assistant.

Voice Activation for Alexa

Make sure your Alexa device is installed and set up first.

- 1 Open your Alexa app.
- 2 Open the menu to search for Skills.
- 3 Search for & choose **Energizer**® Connect.

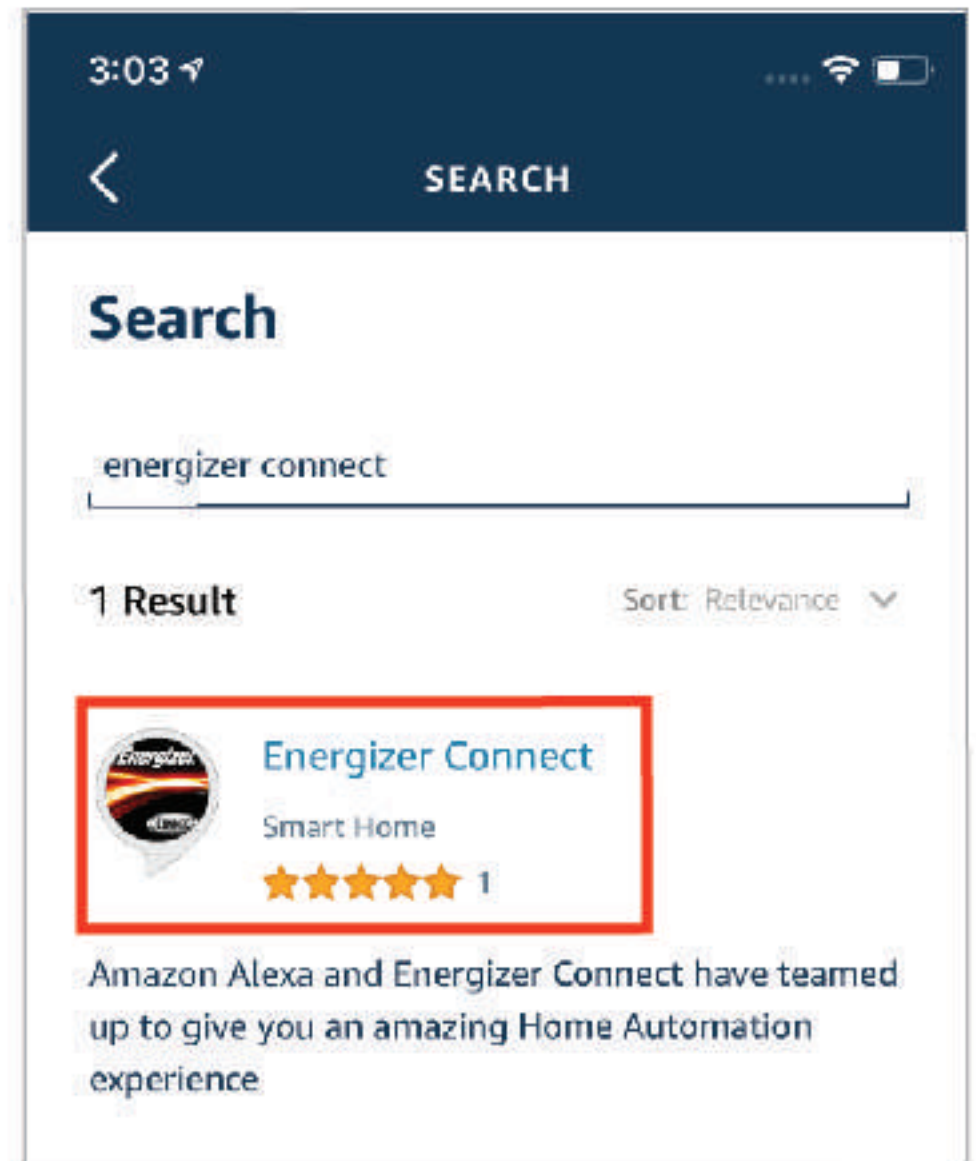
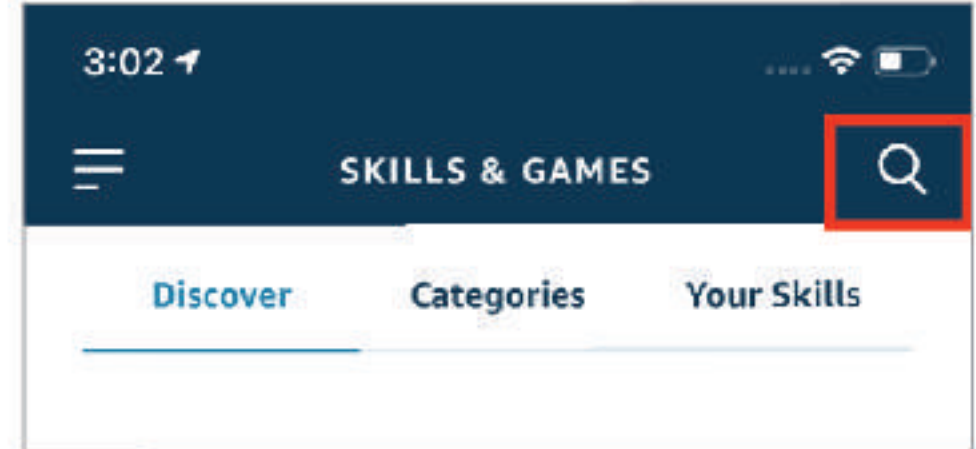
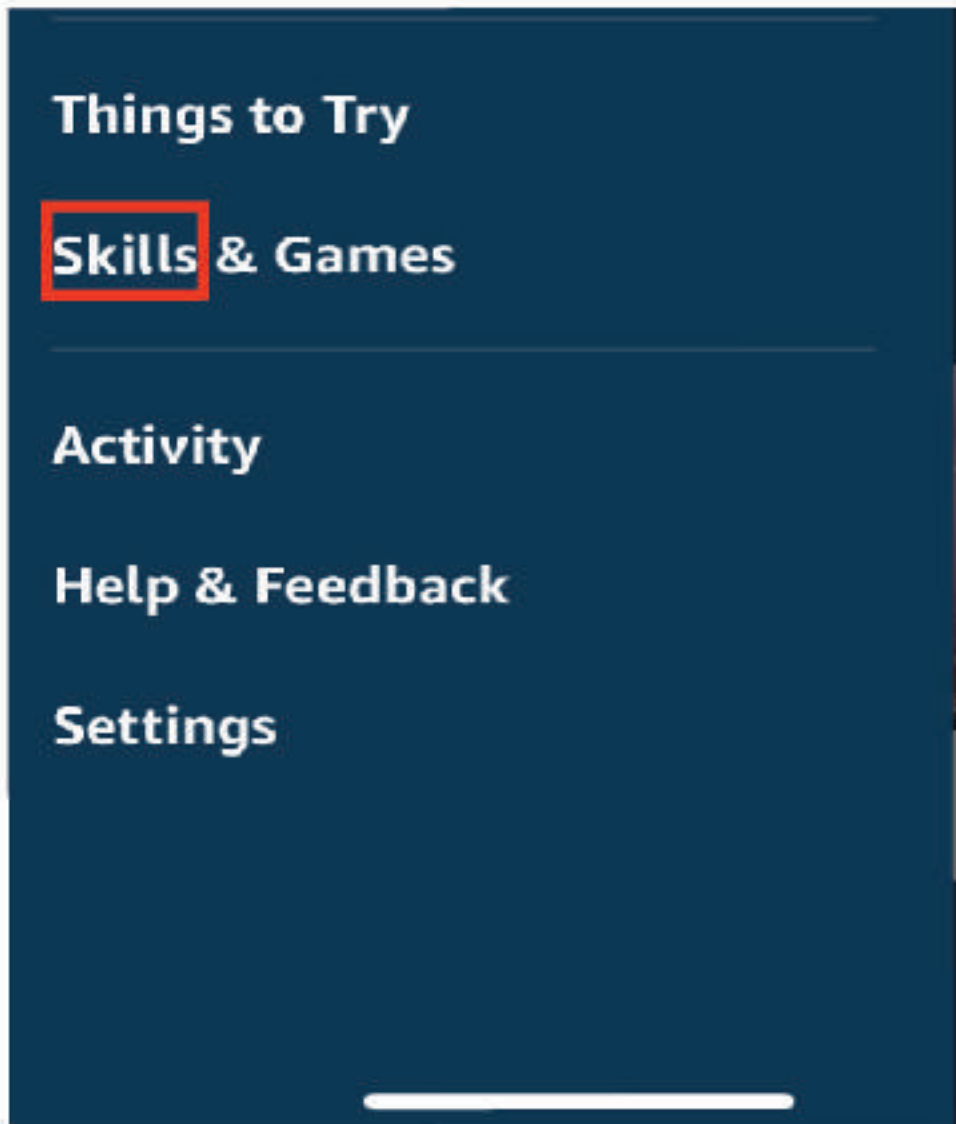

- 4 Authorize your account with the Alexa skill using the username and password from your **Energizer**® Connect app.
- 5 Using the name you assigned your bulb, you can ask Alexa to turn on/off, dim or brighten and change colors of your lights.
Ex: "Alexa, change bedroom light to red".

Voice Activation for the Google Assistant

Make sure your Google Assistant device is installed and set up first.

1 Open your Google Home app.

2 Click the “+” to add a new device

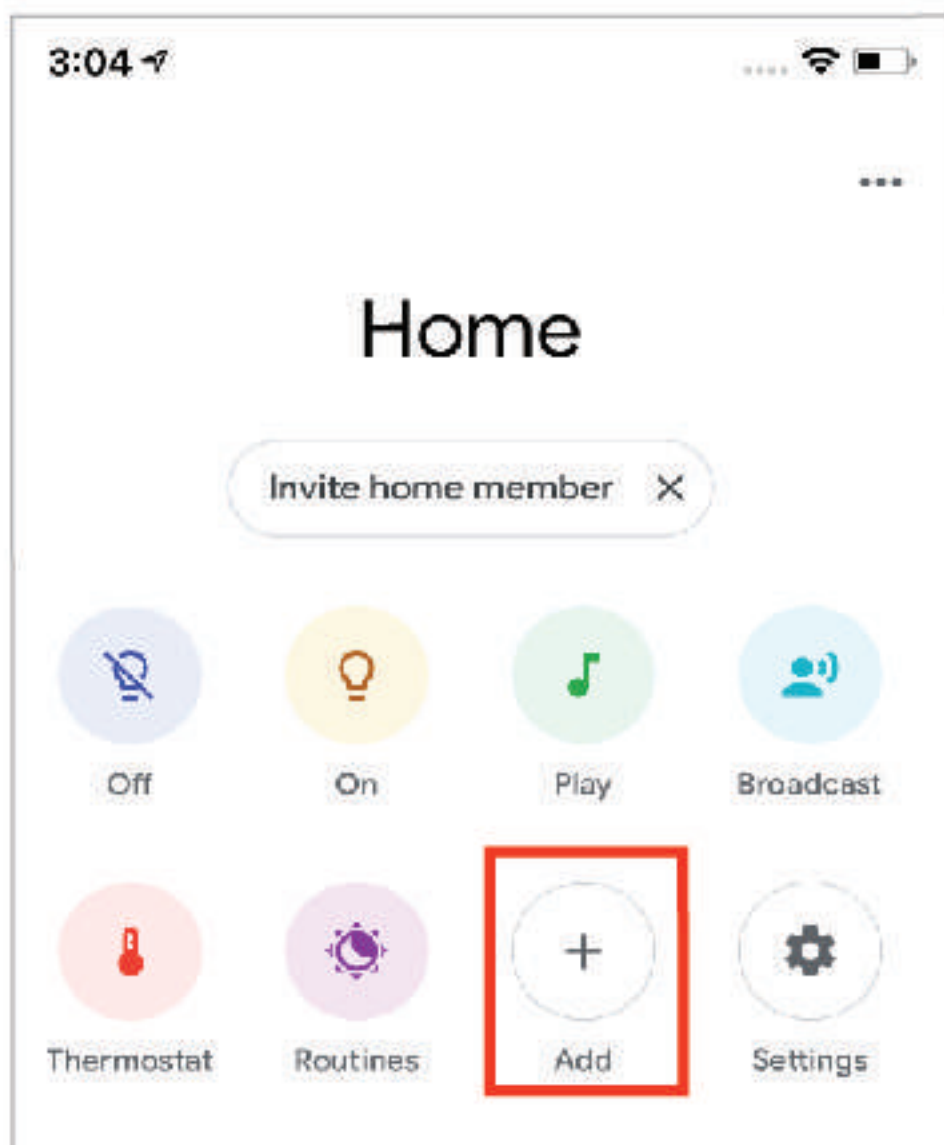

3 Click “Set up a device”

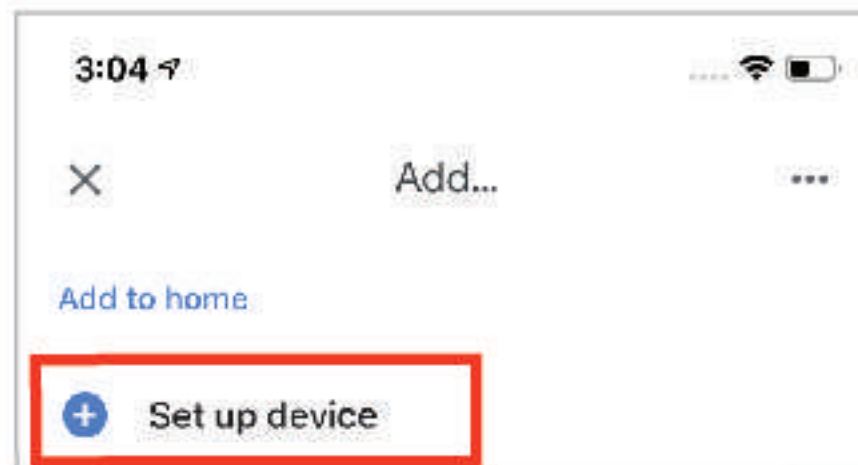

4 Click “Have something already set up?”

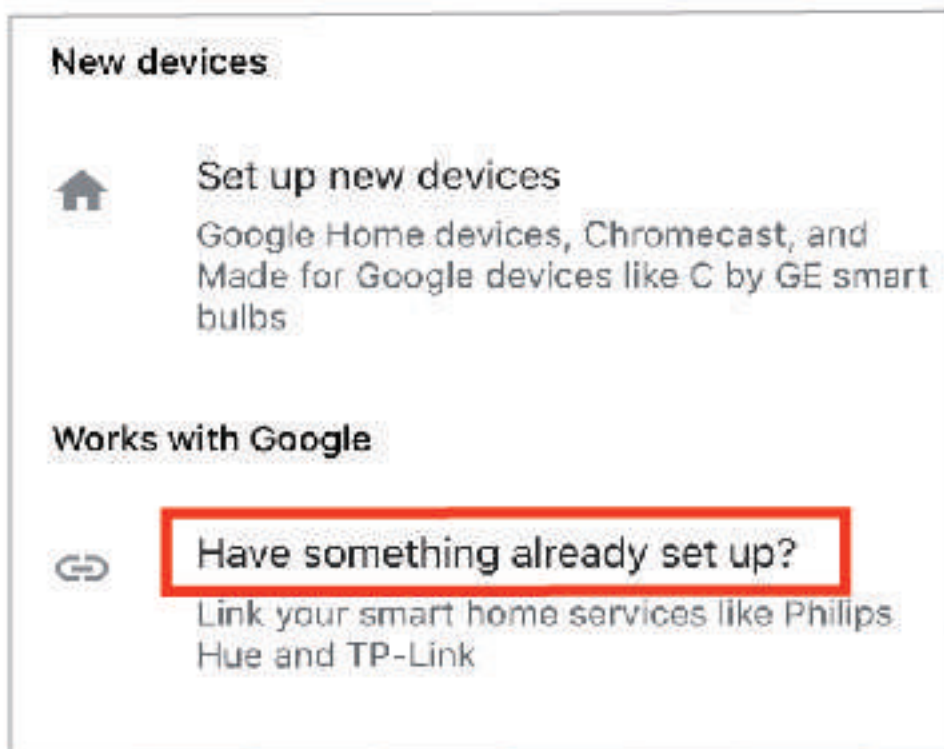

5 Search for & choose **Energizer®** Connect.

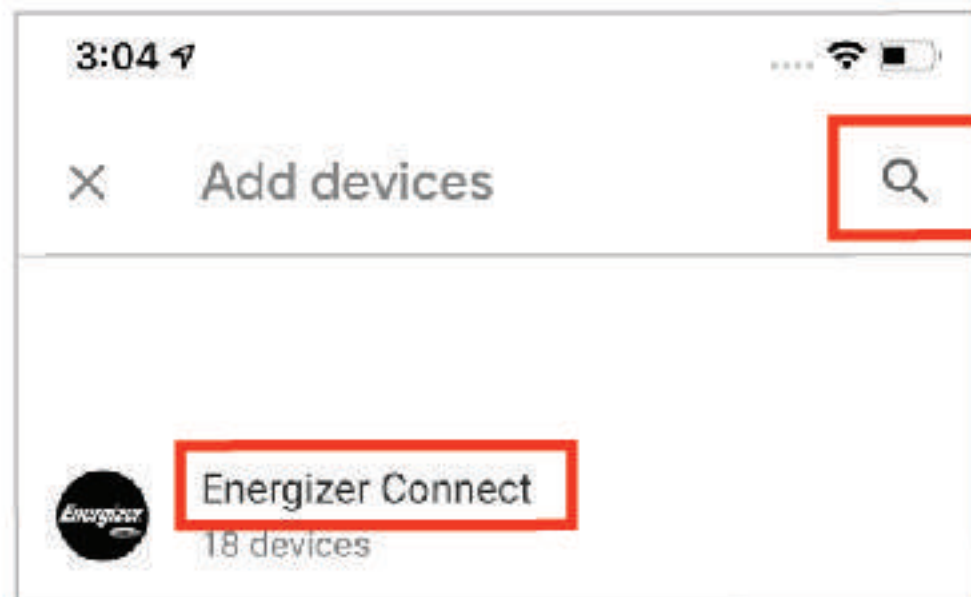

6 Authorize your account with the Google Assistant skill using the username and password from your **Energizer®** Connect app.

7 Using the name you assigned your bulb, you can ask the Google Assistant to turn on/off, dim or brighten and change colors of your lights. Ex: “Ok Google, change bedroom light to red”.

CAUTION: Changes or modifications not expressly approved by the manufacturer could void the user's authority to operate the equipment.

This device complies with Innovation, Science, and Economic Development Canada license-exempt RSS standard(s). Operation is subject to the following two conditions:

(1) this device may not cause interference, and

(2) this device must accept any interference, including interference that may cause undesired operation of the device.

Le présent appareil est conforme aux CNR d'Innovation, Sciences et Développement économique Canada applicables aux appareils radio exempts de licence. L'exploitation est autorisée aux deux conditions suivantes :

(1) l'appareil ne doit pas produire de brouillage, et

(2) l'utilisateur de l'appareil doit accepter tout brouillage radioélectrique subi, même si le brouillage est susceptible d'en compromettre le fonctionnement.

The device is compliance with RF exposure guidelines, users can obtain Canadian information on RF exposure and compliance. The minimum distance from body to use the device is 20cm.

Le présent appareil est conforme Après examen de ce matériel aux conformité ou aux limites d'intensité de champ RF, les utilisateurs peuvent sur l'exposition aux radiofréquences et la conformité and compliance d'acquérir les informations correspondantes. La distance minimale du corps à utiliser le dispositif est de 20cm.

This applies to **Energizer**® Connect smart bulbs with model numbers EAC2-1002-RGB, EAW2-1001-MWT, EAW2-1001-SWT, EBW2-1001-MWT, EBC2-1001-RGB, EAC2-1003-RGB and EAC2-1004-RGB.

THIS DEVICE IS NOT INTENDED FOR USE WITH EMERGENCY EXITS.

RISK OF ELECTRICAL SHOCK - USE IN DRY LOCATION ONLY

DO NOT USE WITH DIMMERS

NOT FOR USE IN TOTALLY ENCLOSED LUMINAIRES

©2020 Energizer. Energizer and certain graphic designs are trademarks of Energizer Brands, LLC and related subsidiaries and are used under license by Jem Connected IOT, Inc. All other brand names are trademarks of their respective owners. Neither Jem Connected IOT, Inc. nor Energizer Brands, LLC is affiliated with the respective owners of their trademarks.

Apple and the Apple logo are trademarks of Apple Inc., registered in the U.S. and other countries.

App store is a service mark of Apple Inc.

Google and Google Play are trademarks of Google LLC. All rights reserved.

Amazon, Alexa and all related logos are trademarks of Amazon.com, Inc. or its affiliates.

Energizer®



branded hardware products, even if packaged or sold with Jem Connected IOT hardware. This Limited Warranty does not cover consumable parts, including batteries, unless damage is due to defects in materials or workmanship of the Product, or software (even if packaged or sold with the product). Jem Connected IOT recommends that you use only authorized service providers for maintenance or repair. Unauthorized use of the Product or software can impair the Product's performance and may invalidate this Limited Warranty.

5. DISCLAIMER OF WARRANTIES Except as stated above in this limited warranty, and to the maximum extent permitted by applicable law, Jem Connected IOT disclaims all express, implied, and statutory warranties and conditions with respect to the product, including the implied warranties of merchantability and fitness for a particular purpose. To the maximum extent permitted by applicable law, Jem Connected IOT also limits the duration of any applicable implied warranties or conditions to the duration of this limited warranty.

6. LIMITATION OF DAMAGES In addition to the above warranty disclaimers, in no event will Jem Connected IOT be liable for any consequential, incidental, exemplary, or special damages, including any damages for lost data or lost profits, arising from or relating to this limited warranty or the product, and Jem Connected IOT's total cumulative liability arising from or related to this limited warranty or the product will not exceed the amount actually paid for the product by the original purchaser.

7. LIMITATION OF LIABILITY The Jem Connected IOT online services at energizerconnect.com ("services") provide you information ("product information") regarding your Jem Connected IOT products or other peripherals connected to your products ("product peripherals"). The type of product peripherals that may be connected to your product may change from time to time. Without limiting the generality of the disclaimers above, all product information is provided for your convenience, "as is", and "as available". Jem Connected IOT does not represent, warrant, or guarantee that product information will be available, accurate, or reliable or that product information or use of the services or product will provide safety in your home. You use all product information, the services, and the product at your own discretion and risk. You will be solely responsible for (and Jem Connected IOT disclaims) any and all loss, liability, or damages, including to your wiring, fixtures, electricity, home, product, product peripherals, computer, mobile device, and all other items and pets in your home, resulting from your use of the product information, services, or product. Product information provided by the services is not intended as a substitute for direct means of obtaining the information. For example, a notification provided through the service is not intended as a substitute for audible and visible indications in the home and on the product, nor for a third party monitoring service that monitors alarm state.

8. YOUR RIGHTS AND THIS LIMITED WARRANTY This Limited Warranty gives you specific legal rights. You may also have other legal rights that vary by state, province, or jurisdiction. Likewise, some of the limitations in this Limited Warranty may not apply in certain states, provinces or jurisdictions. The terms of this Limited Warranty will apply to the extent permitted by applicable law. For a full description of your legal rights you should refer to the laws applicable in your jurisdiction and you may wish to contact a relevant consumer advisory service.

If you need to start a warranty claim for your Energizer Connect IOT device, please reach out to Customer Support by emailing customerservice@energizerconnect.com or calling our support number (855)-999-8041.

Please allow 7-10 business days to process warranty claims. Customers located outside of U.S. will be responsible for all shipping costs.

Energizer[®]

